

# DUFOUR 405 GL

Daphne-S (2010)

Sailing yacht Dufour 405 GL Daphne-S, built in 2010 is anchored in the **Göcek Mucev Marina, Aegean, Turkey**. It has **3 cabins**, can accommodate **6 people** and has **2 toilets**. Bed linen and kitchen equipment are included in the price.

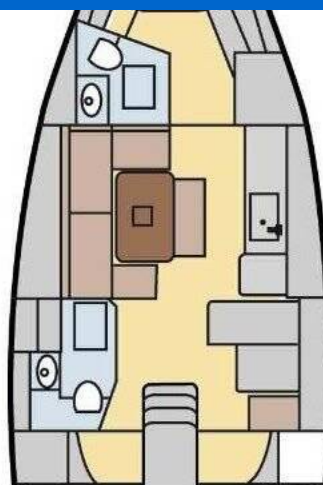

## YACHT SPECIFICATIONS

Yacht Base

**Göcek Mucev Marina, Turkey**

Yacht ID

**9963**

Brands

**Dufour**

Yacht name

**Daphne-S**

Production year

**2010**

Length

**40 ft**

Cabins

**3**

Berths

**6**

WC

**2**

Engine

**1 x 55 HP**

Fuel tank

**200 l**



**WEBSITE**

[www.plujeme.cz](http://www.plujeme.cz)



**PHONE**

+420 720 755 085



**MOBILE**

+420 777 170 276



**E-MAIL**

[info@plujeme.cz](mailto:info@plujeme.cz)



**PLUJEME RÁDI S.R.O.**

Dlouhá 730/35, 11000 Praha 1 – Staré Město, Czech Republic

## STANDARD YACHT EQUIPMENT

Comfort	<b>Bed linen, Blankets, Cockpit cushions, Deck cushions, Pillows, Towels</b>
Deck	<b>Anchor winch remote control, Anchor with chain, Bathing platform, Bimini top, Boat hook, Bosun's chair (Safe seat) (boatswain's chair), Cockpit table, Cockpit/stern, outside shower, Deck brush, Dinghy, Dinghy (byboat) pump, Dinghy with outboard engine, Electric anchor windlass, Fenders, Floating rope, Fuel funnel, Gangway, Jerry cans for diesel, Jerry cans for fuel, Mooring ropes, Plastic bucket, Reserve motor oil, Ropes, Round/globular fender, Spare anchor (Reserve, Auxiliary anchor), Sprayhood, Sun awning (aft), Swimming ladder, Water hose, Winch handles</b>
Entertainment	<b>Indoor speakers, LED TV, Outdoor speakers, Radio CD mp3 player + USB, Bluetooth</b>
Galley	<b>Gas bottles, Gas cookers, Kitchen utensils (Galley equipment, cutlery), Microwave, Oven, Refrigerator, Sink</b>
Interior	<b>Convertible table in salon, Electric fans in cabins, Yacht keys</b>
Navigation	<b>Autopilot, Binoculars, Compass, GPS chart plotter, Hand bearing compass, List of lights, Log/speed instrument, Nautical charts, Navigation (Nautical) charts and nautical guide, Navigation set, Navigation/position Lights, Pilot book, Radar reflector, Wind/speed/depth instruments</b>
Safety	<b>Distress flare box, Distress signals, Emergency tiller, Fire blanket, Fire extinguisher, First aid kit, Flashlight, Floating light, Fog horn, Horseshoe lifebuoy, Life belts (Safety harness), Life jackets, Liferaft, Oars (Paddles), Search light, Set of tools, Signal flags, Spare parts, Torch, VHF radio, Wire (shroud) cutter</b>
Sails	<b>Lazy bag, Lazy jacks</b>
Yacht electrics	<b>Battery charger, Bilge pump - Electric, Heating, Inverter, Service batteries, Shore connection 220 V, Shore power cable, Shore power connection, Solar panels, Start battery, Water heater</b>



**WEBSITE**

[www.plujeme.cz](http://www.plujeme.cz)



**PHONE**

+420 720 755 085



**MOBILE**

+420 777 170 276



**E-MAIL**

[info@plujeme.cz](mailto:info@plujeme.cz)



**PLUJEME RÁDI S.R.O.**

Dlouhá 730/35, 11000 Praha 1 - Staré Město, Czech Republic

## SERVICES

SELECTED SERVICES	OBLIGATORY	PAYMENT TYPE	PRICE
<b>Charter package</b> (Payable at the base) <b>Season: 2026.</b> Includes outboard engine, transit log, final cleaning, towels & bed linen, cooking gas, snorkel	Yes	per booking	<b>400,00 €</b>
<b>Special diet</b> (Payable at the base) <b>Season: 2026.</b> Free Wi-Fi & SUP & Snorkel & Late Check-Out for Check-in periods: 8.11.2025-18.4.2026 & 4.7.2026-22.8.2026	Yes	per booking	<b>0,00 €</b>
<b>Special offer</b> (Payable at the base) <b>Season: 2026.</b> Free Wi-Fi & SUP & Snorkel & Late Check-Out for Check-in periods: 8.11.2025-18.4.2026 & 4.7.2026-22.8.2026	Yes	per booking	<b>0,00 €</b>
<b>Cook</b> (Payable at the base) <b>Season: 2026.</b>	No	per day	<b>160,00 €</b>
<b>Crew change</b> (Payable at the base) <b>Season: 2026.</b>	No	per crew change	<b>100,00 €</b>
<b>Early Check in</b> (Payable at the base) <b>Season: 2026.</b> from 13:30	No	per booking	<b>150,00 €</b>
<b>Hostess</b> (Payable at the base) <b>Season: 2026.</b>	No	per day	<b>150,00 €</b>
<b>Late check out</b> (Payable at the base) <b>Season: 2026.</b> By 10:30 AM	No	per booking	<b>50,00 €</b>
<b>One way fee</b> (Payable at the base) <b>Season: 2026.</b> Bodrum/Marmaris	No	one-way	<b>600,00 €</b>
<b>Pet on board</b> (Payable at the base) <b>Season: 2026.</b> limited to 1 pet	No	per booking	<b>100,00 €</b>
<b>Provisioning</b> (Payable at the base) <b>Season: 2026.</b> Shopping & delivery to boat on check in day + receipts	No	per service	<b>30,00 €</b>
<b>Regatta charge</b> (Payable at the base) <b>Season: 2026.</b>	No	per booking	<b>650,00 €</b>

<b>Skipper</b> (Payable at the base) <b>Season: 2026.</b>	No	per day	<b>180,00 €</b>
<b>Transfer</b> (Payable at the base) <b>Season: 2026.</b> Dalaman-Fethiye/Göcek (1-6 person)	No	one-way	<b>90,00 €</b>
<b>Transfer</b> (Payable at the base) <b>Season: 2026.</b> Dalaman-Fethiye/Göcek (7-12 person)	No	one-way	<b>150,00 €</b>
<b>WI-FI Internet connection on boat</b> (Payable at the base) <b>Season: 2026.</b> Unlimited	No	per booking	<b>80,00 €</b>



**WEBSITE**  
www.plujeme.cz



**E-MAIL**  
info@plujeme.cz



**PHONE**  
+420 720 755 085



**PLUJEME RÁDI S.R.O.**  
Dlouhá 730/35, 11000 Praha 1 – Staré Město, Czech Republic



**MOBILE**  
+420 777 170 276

## ADDITIONAL EXTRAS

EXTRA	OBLIGATORY	PAYMENT TYPE	PRICE
<b>Beach towel</b> (Payable at the base) <b>Season: 2026.</b> Payable at the base	No	per person	<b>10,00 €</b>
<b>Canoe</b> (Payable at the base) <b>Season: 2026.</b> Payable at the base	No	per week	<b>60,00 €</b>
<b>Coffee machine</b> (Payable at the base) <b>Season: 2026.</b> Payable at the base	No	per booking	<b>30,00 €</b>
<b>Extra bedlinen</b> (Payable at the base) <b>Season: 2026.</b> includes: one linen, 2 pillowcases, 1 bed cover - Payable at the base	No	per set	<b>20,00 €</b>
<b>Extra towels</b> (Payable at the base) <b>Season: 2026.</b> includes: one head, one body towel - Payable at the base	No	per person	<b>15,00 €</b>
<b>Fishing equipment</b> (Payable at the base) <b>Season: 2026.</b> Payable at the base	No	per week/ person	<b>25,00 €</b>
<b>Gennaker/Spinnaker</b> (Payable at the base) <b>Season: 2026.</b> Payable at the base	No	per week	<b>350,00 €</b>
<b>Railing net (Safety net)</b> (Payable at the base) <b>Season: 2026.</b> Payable at the base	No	per booking	<b>80,00 €</b>
<b>Stand up paddle (SUP)</b> (Payable at the base) <b>Season: 2026.</b> Payable at the base	No	per week	<b>100,00 €</b>



**WEBSITE**  
www.plujeme.cz



**PHONE**  
+420 720 755 085



**MOBILE**  
+420 777 170 276



**E-MAIL**  
info@plujeme.cz



**PLUJEME RÁDI S.R.O.**  
Dlouhá 730/35, 11000 Praha 1 - Staré Město, Czech Republic

## PRICE AND AVAILABILITY

13.06. - 20.06.2026 NOT AVAILABLE	20.06. - 27.06.2026 NOT AVAILABLE	27.06. - 04.07.2026 NOT AVAILABLE	04.07. - 11.07.2026 NOT AVAILABLE
11.07. - 18.07.2026 NOT AVAILABLE	18.07. - 25.07.2026 1.400 € 2.000 €	25.07. - 01.08.2026 NOT AVAILABLE	01.08. - 08.08.2026 NOT AVAILABLE
08.08. - 15.08.2026 NOT AVAILABLE	15.08. - 22.08.2026 1.600 € 2.000 €	22.08. - 29.08.2026 1.600 € 2.000 €	29.08. - 05.09.2026 2.116 € 2.645 €
05.09. - 19.09.2026 NOT AVAILABLE	19.09. - 26.09.2026 2.248 € 2.645 €	26.09. - 03.10.2026 2.248 € 2.645 €	03.10. - 10.10.2026 2.248 € 2.645 €
10.10. - 17.10.2026 1.700 € 2.000 €	17.10. - 24.10.2026 1.466 € 1.725 €	24.10. - 31.10.2026 1.466 € 1.725 €	31.10. - 07.11.2026 1.466 € 1.725 €
07.11. - 14.11.2026 NOT AVAILABLE	14.11. - 21.11.2026 1.466 € 1.725 €	21.11. - 28.11.2026 1.466 € 1.725 €	28.11. - 05.12.2026 1.466 € 1.725 €
05.12. - 12.12.2026 1.466 € 1.725 €	12.12. - 19.12.2026 1.466 € 1.725 €	19.12. - 26.12.2026 1.466 € 1.725 €	



WEBSITE

[www.plujeme.cz](http://www.plujeme.cz)



E-MAIL

[info@plujeme.cz](mailto:info@plujeme.cz)



PHONE

+420 720 755 085



MOBILE

+420 777 170 276



PLUJEME RÁDI S.R.O.

Dlouhá 730/35, 11000 Praha 1 – Staré Město, Czech Republic