

SUN ODYSSEY 479

Anna (2018)

Sailing yacht Sun Odyssey 479 Anna, built in 2018 is anchored in the Marina Frapa, Rogoznica, Šibenik region, Croatia. It has 4 cabins, can accommodate 8 + 2 people and has 4 toilets. Bed linen and kitchen equipment are included in the price.

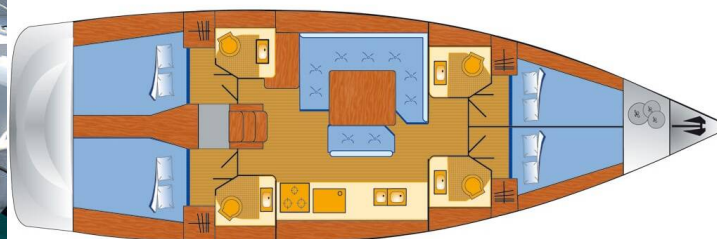
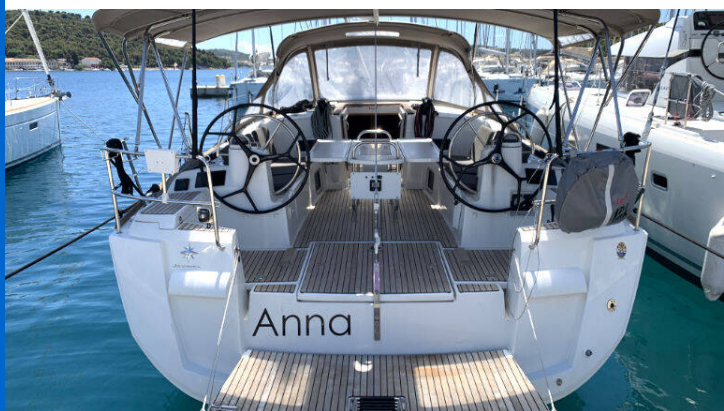

YACHT SPECIFICATIONS

Yacht Base

Marina Frapa, Rogoznica, Croatia

Yacht ID

995

Brands

Jeanneau

Yacht name

Anna

Production year

2018

Length

47 ft

Cabins

4

Berths

8 + 2

Max Persons

10

WC

4

Engine

1 x 57 HP

Fuel tank

250 l



WEBSITE

www.plujeme.cz



PHONE

+420 720 755 085



MOBILE

+420 777 170 276



E-MAIL

info@plujeme.cz



PLUJEME RÁDI S.R.O.

Dlouhá 730/35, 11000 Praha 1 – Staré Město, Czech Republic

STANDARD YACHT EQUIPMENT

Comfort	Blankets, Cockpit cushions, Pillows
Deck	Bathing platform, Bilge pump - Mechanic, Bimini top, Boat hook, Cockpit table, Cockpit/stern, outside shower, Dinghy, Electric anchor windlass, Fenders, Gangway, Main anchor, Mooring ropes, Round/globular fender, Spare anchor (Reserve, Auxiliary anchor), Sprayhood, Swimming ladder, Teak cockpit, Water hose, Winch handles
Entertainment	Indoor speakers, Outdoor speakers, Radio CD/MP3 player, AUX input, TV, Wi-Fi Internet
Galley	Freezer, Gas bottles, Gas cookers, Hot water, Kitchen utensils (Galley equipment, cutlery), Oven, Refrigerator
Interior	Barometer, Clock, Electric fans in cabins, Electric toilet, Lowerable salon table, Safe
Navigation	AIS, Autopilot, Binoculars, Bow thruster, Compass, Composite steering wheels, GPS chart plotter - cockpit, Hand bearing compass, Harbour guides, Navigation (Nautical) charts and nautical guide, Navigation set, Radar reflector, Tridata, Wind instrument/Anemometer
Safety	Black Water Tank, Fire extinguisher, First aid kit, Flashlight, Fog horn, Life belts (Safety harness), Life buoy + Flashing light, Liferaft, Repair kit, Self inflating life vest, Signal rockets and torches, VHF radio
Sails	Gennaker-device
Yacht electrics	12V Socket, Batteries, Battery charger, Bilge pump - Electric, Converter 220V/12V, Heating, Inverter, Pump, Service batteries, Shore connection 220 V, Shore power cable, Solar panels



WEBSITE

www.plujeme.cz



PHONE

+420 720 755 085



MOBILE

+420 777 170 276



E-MAIL

info@plujeme.cz



PLUJEME RÁDI S.R.O.

Dlouhá 730/35, 11000 Praha 1 – Staré Město, Czech Republic

SERVICES

SELECTED SERVICES	OBLIGATORY	PAYMENT TYPE	PRICE
Basic package for accommodation (Payable at the base) Season: 2026. Cleaning, made Bed linen, Permit, WiFi, Cooking gas, Rinsing set, Dinghy / in Cash or with credit card (VISA, MASTER)	Yes	per booking	290,00 €
Deposit insurance (Payable at the base) Season: 2026. Cash / The customers still have to deposit 100,00 €. If there is no damage, they get the 100,00 € back. We do not require any prior information. The customer can take out insurance at check-in.	No	per booking	200,00 €
Early Check in (Payable at the base) Season: 2026. On request; from 13:00; Payable in cash at the base	No	per booking	150,00 €
Hostess (Payable at the base) Season: 2026. + own cabin	No	per day + food	150,00 €
Pet on board (Payable at the base) Season: 2026. ONLY ON REQUEST!; Payable in cash at the base	No	per booking	140,00 €
Skipper (Payable at the base) Season: 2026. On request; Free food, own cabin; Payable in cash at the base	No	per day	200,00 €
Transfer (Payable at the base) Season: 2026. Transfer to Marina Frapa (Split Airport) 1-2 people €60 Shopping stop for 1 hour: If you arrive by taxi from the airport and would like to stop at the supermarket, this is possible, but the driver will have to charge you for it: From June 1st to September 30th, the stop costs €50, and €20 during the off-season (applies to transfers booked through us).	No	one-way	60,00 €
Transfer (Payable at the base) Season: 2026. Transfer to Marina Frapa (Split Airport) 3-4 people €75 Shopping stop for 1 hour: If you arrive by taxi from the airport and would like to stop at the supermarket, this is possible, but the driver will have to charge you for it: From June 1st to September 30th, the stop costs €50, and €20 during the off-season (applies to transfers booked through us).	No	one-way	75,00 €

Transfer (Payable at the base)

No

one-way

85,00 €

Season: 2026. Transfer to Marina Frapa (Split Airport) 5-8 people €85

Shopping stop for 1 hour: If you arrive by taxi from the airport and would like to stop at the supermarket, this is possible, but the driver will have to charge you for it: From June 1st to September 30th, the stop costs €50, and €20 during the off-season (applies to transfers booked through us).

Transfer (Payable at the base)

No

one-way

140,00 €

Season: 2026. Transfer to Marina Frapa (Split Airport) 9-15 people €140

Shopping stop for 1 hour: If you arrive by taxi from the airport and would like to stop at the supermarket, this is possible, but the driver will have to charge you for it: From June 1st to September 30th, the stop costs €50, and €20 during the off-season (applies to transfers booked through us).



WEBSITE

www.plujeme.cz



PHONE

+420 720 755 085



MOBILE

+420 777 170 276



E-MAIL

info@plujeme.cz



PLUJEME RÁDI S.R.O.

Dlouhá 730/35, 11000 Praha 1 – Staré Město, Czech Republic

ADDITIONAL EXTRAS

EXTRA	OBLIGATORY	PAYMENT TYPE	PRICE
Gennaker (Payable at the base) Season: 2026. on request, more weeks 50% Rabatt, Cash - Payable at the base	No	per week	250,00 €
Grill/Barbecue/Plancha (Payable at the base) Season: 2026. Danish Cobb Gas Grill, 50% discount on 2nd week, Cash - Payable at the base	No	per week	100,00 €
Grill/Barbecue/Plancha (Payable at the base) Season: 2026. Danish Cobb Gas Grill, 50% discount on 2nd week, Cash - Payable at the base	No	per week	100,00 €
Outboard engine (Payable at the base) Season: 2026. 50% second week; in Cash or with credit card (VISA, MASTER) - Payable at the base	No	per week	100,00 €
Stand up paddle (SUP) (Payable at the base) Season: 2026. 50% second week; Payable in cash at the base - Payable at the base	No	per week	100,00 €
Towels (Payable at the base) Season: 2026. 1x big one, 1x small one; Payable in cash at the base - Payable at the base	No	per set	10,00 €



WEBSITE

www.plujeme.cz



PHONE

+420 720 755 085



MOBILE

+420 777 170 276



E-MAIL

info@plujeme.cz



PLUJEME RÁDI S.R.O.

Dlouhá 730/35, 11000 Praha 1 - Staré Město, Czech Republic

PRICE AND AVAILABILITY

25.04. - 02.05.2026 NOT AVAILABLE	02.05. - 09.05.2026 1.295 € 1.850 €	09.05. - 16.05.2026 1.960 € 2.800 €	16.05. - 23.05.2026 1.960 € 2.800 €
23.05. - 30.05.2026 2.590 € 3.700 €	30.05. - 06.06.2026 NOT AVAILABLE	06.06. - 13.06.2026 2.800 € 4.000 €	13.06. - 20.06.2026 NOT AVAILABLE
20.06. - 27.06.2026 NOT AVAILABLE	27.06. - 04.07.2026 3.120 € 4.000 €	04.07. - 11.07.2026 3.510 € 4.500 €	11.07. - 18.07.2026 3.510 € 4.500 €
18.07. - 25.07.2026 3.510 € 4.500 €	25.07. - 01.08.2026 3.510 € 4.500 €	01.08. - 08.08.2026 NOT AVAILABLE	08.08. - 15.08.2026 NOT AVAILABLE
15.08. - 22.08.2026 ON OPTION	22.08. - 29.08.2026 3.510 € 4.500 €	29.08. - 12.09.2026 NOT AVAILABLE	12.09. - 19.09.2026 3.354 € 4.300 €
23.09. - 03.10.2026 ON OPTION	03.10. - 10.10.2026 2.184 € 2.800 €	10.10. - 17.10.2026 1.443 € 1.850 €	17.10. - 24.10.2026 1.443 € 1.850 €
24.10. - 31.10.2026 1.443 € 1.850 €	31.10. - 07.11.2026 1.443 € 1.850 €	07.11. - 14.11.2026 1.443 € 1.850 €	14.11. - 21.11.2026 1.850 €
21.11. - 28.11.2026 1.850 €	28.11. - 05.12.2026 1.850 €		



WEBSITE

www.plujeme.cz



E-MAIL

info@plujeme.cz



PHONE

+420 720 755 085



MOBILE

+420 777 170 276



PLUJEME RÁDI S.R.O.

Dlouhá 730/35, 11000 Praha 1 – Staré Město, Czech Republic

PRICE AND AVAILABILITY

05.12. - 12.12.2026 1.850 €	12.12. - 19.12.2026 1.850 €	19.12. - 26.12.2026 1.850 €	01.01. - 26.03.2027 NOT AVAILABLE
27.03. - 03.04.2027 1.388 € 1.850 €	03.04. - 10.04.2027 1.388 € 1.850 €	10.04. - 17.04.2027 1.388 € 1.850 €	17.04. - 24.04.2027 1.388 € 1.850 €
24.04. - 01.05.2027 1.388 € 1.850 €	01.05. - 08.05.2027 1.388 € 1.850 €	08.05. - 15.05.2027 2.100 € 2.800 €	15.05. - 22.05.2027 2.100 € 2.800 €
22.05. - 29.05.2027 2.775 € 3.700 €	29.05. - 05.06.2027 3.150 € 4.200 €	05.06. - 12.06.2027 3.150 € 4.200 €	12.06. - 19.06.2027 3.150 € 4.200 €
19.06. - 26.06.2027 3.150 € 4.200 €	26.06. - 03.07.2027 3.150 € 4.200 €	03.07. - 10.07.2027 3.525 € 4.700 €	10.07. - 17.07.2027 3.525 € 4.700 €
17.07. - 24.07.2027 3.525 € 4.700 €	24.07. - 31.07.2027 3.525 € 4.700 €	31.07. - 07.08.2027 3.525 € 4.700 €	



WEBSITE

www.plujeme.cz



E-MAIL

info@plujeme.cz



PHONE

+420 720 755 085



MOBILE

+420 777 170 276



PLUJEME RÁDI S.R.O.

Dlouhá 730/35, 11000 Praha 1 – Staré Město, Czech Republic

PRICE AND AVAILABILITY

07.08. - 14.08.2027 3.525 € 4.700 €	14.08. - 21.08.2027 3.525 € 4.700 €	21.08. - 28.08.2027 3.525 € 4.700 €	28.08. - 04.09.2027 3.525 € 4.700 €
04.09. - 11.09.2027 3.375 € 4.500 €	11.09. - 18.09.2027 3.375 € 4.500 €	18.09. - 25.09.2027 3.150 € 4.200 €	25.09. - 02.10.2027 2.775 € 3.700 €
02.10. - 09.10.2027 2.100 € 2.800 €	09.10. - 16.10.2027 1.388 € 1.850 €	16.10. - 23.10.2027 1.388 € 1.850 €	23.10. - 30.10.2027 1.388 € 1.850 €
30.10. - 06.11.2027 1.388 € 1.850 €	07.11. - 24.03.2028 NOT AVAILABLE		



WEBSITE

www.plujeme.cz



E-MAIL

info@plujeme.cz



PHONE

+420 720 755 085



MOBILE

+420 777 170 276



PLUJEME RÁDI S.R.O.

Dlouhá 730/35, 11000 Praha 1 – Staré Město, Czech Republic