

BALI 4.4

Breeze (2025)

Catamaran Bali 4.4 Breeze, built in 2025 is anchored in the Sukosan, D-Marin Dalmacija Marina, Zadar region, Croatia. It has **4 + 1 cabins**, can accommodate **8 + 2 + 1 people** and has **4 + 1 toilets**. Bed linen and kitchen equipment are included in the price.

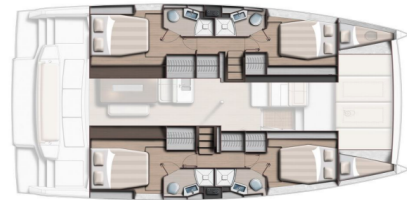

YACHT SPECIFICATIONS

Yacht Base

**Sukosan, D-Marin Dalmacija Marina,
Croatia**

Yacht ID

9863

Brands

Catana

Yacht name

Breeze

Production year

2025

Length

44 ft

Cabins

4 + 1

Berths

8 + 2 + 1

Max Persons

11

WC

4 + 1

Engine

2 x 57 HP

Fuel tank

800 l



WEBSITE

www.plujeme.cz



PHONE

+420 720 755 085



MOBILE

+420 777 170 276



E-MAIL

info@plujeme.cz



PLUJEME RÁDI S.R.O.

Dlouhá 730/35, 11000 Praha 1 – Staré Město, Czech Republic

STANDARD YACHT EQUIPMENT

Comfort	Bed linen, Cockpit cushions, Sundeck cushions
Deck	Bathing platform, Bimini top, Cockpit table, Cockpit/stern, outside shower, Dinghy, Fly sunbathing area, Forward cockpit, Grill/Barbecue/Plancha, Teak cockpit
Entertainment	Outdoor speakers, Radio CD player, TV
Galley	Coffee machine, Freezer, Hot water, Kitchen utensils (Galley equipment, cutlery), Microwave, Oven, Refrigerator, Stove
Interior	Convertible table in salon, Electric fans in cabins, Electric toilet, Table
Navigation	Autopilot, GPS chart plotter - cockpit, Navigation (Nautical) charts and nautical guide, Pilot book, Tridata
Safety	VHF radio
Sails	Electric halyard winch
Yacht electrics	Air Conditioning, Battery charger, Generator, Heating, Inverter, Solar panels



WEBSITE

www.plujeme.cz



E-MAIL

info@plujeme.cz



PHONE

+420 720 755 085



MOBILE

+420 777 170 276



PLUJEME RÁDI S.R.O.

Dlouhá 730/35, 11000 Praha 1 – Staré Město, Czech Republic

SERVICES

SELECTED SERVICES	OBLIGATORY	PAYMENT TYPE	PRICE
Charter pack (Payable at the base) Season: 2026. includes final cleaning, bedlinen, towels - 1 set/person, cooking gas	Yes	per booking	470,00 €
Outboard engine (Payable at the base) Season: 2026. Free of charge for bookings in May	Yes	per booking	0,00 €
Comfort Pack (Payable at the base) Season: 2026. includes outboard 2,5 HP, WiFi routers	No	per week	105,00 €
Deposit insurance (Payable at the base) Season: 2026. + 450 EUR refundable deposit	No	per booking	380,00 €
Early Check in (Payable at the base) Season: 2026. Saturdays between 13hr - 14hr. Early check in can be confirmed only on embarkation day in the charter base.	No	per booking	250,00 €
Flexible booking (Payable now) Season: 2026. allows you to cancel or rebook your charter up to 30 days before the embarkation for no specific reason. You can reschedule your holiday at no cost for unlimited number of times or use a credit note if you are uncertain of new charter dates. With our FLEX PLAN your rebooking costs are completely eliminated while cancellation costs with refund option are reduced to a minimum (15% of the charter fee, min 350 EUR). Extra bonus: free cancellation and FULL REFUND granted in case of closed state borders within 7 days before the embarkation. Notes: FLEX PLAN costs 7% of the final charter price, can be added to booking up to 72hr after booking confirmation and is not available for bookings confirmed within 30 days before the embarkation.	No	per booking	0,00 €
Hostess (Payable now) Season: 2026. + own cabin 50% cancellation fee in case of cancellation up to 15 days prior to embarkation 100% cancellation fee in case of cancellation within 14 days prior to embarkation	No	per day + food	220,00 €
Late check out (Payable at the base) Season: 2026. Saturdays till 10hr Late check-out can be confirmed only on Friday before the embarkation day.	No	per booking	350,00 €

One way fee (Payable at the base)	No	per booking	250,00 €
Season: 2026. Suk - Ši / Ši - Suk On request only. One-way conditions: one way fee + skipper service obligatory for the whole booking period + mooring fee in port of disembarkation/embarkation			
One way fee (Payable at the base)	No	per booking	490,00 €
Season: 2026. Suk - Seg / Seg - Suk On request only. One-way conditions: one way fee + skipper service obligatory for the whole booking period + mooring fee in port of disembarkation/embarkation			
One way fee (Payable at the base)	No	per booking	490,00 €
Season: 2026. Suk - Kas / Kas - Suk On request only. One-way conditions: one way fee + skipper service obligatory for the whole booking period + mooring fee in port of disembarkation/embarkation; check-out on Friday until 12:00 in Kaštela			
Pet on board (Payable at the base)	No	per booking	150,00 €
Season: 2026. Small or medium pet, up to 25 kg			
Provisioning (Payable now)	No	per booking	0,00 €
Season: 2026. upon request + price of groceries, to be done online			
Skipper (Payable now)	No	per day + food	240,00 €
Season: 2026. + own cabin 50% cancellation fee in case of cancellation up to 15 days prior to embarkation 100% cancellation fee in case of cancellation within 14 days prior to embarkation			



WEBSITE

www.plujeme.cz



E-MAIL

info@plujeme.cz



PHONE

+420 720 755 085



MOBILE

+420 777 170 276



PLUJEME RÁDI S.R.O.

Dlouhá 730/35, 11000 Praha 1 – Staré Město, Czech Republic

ADDITIONAL EXTRAS

EXTRA	OBLIGATORY	PAYMENT TYPE	PRICE
Beach towel (Payable at the base) Season: 2026. Payable at the base	No	per piece	8,00 €
eFoil (Payable now) Season: 2026. Loft Foil / Awake Vinga Security deposit: 1000 EUR Cancellation policy: 50% cancellation fee in case of cancellation within 2 weeks prior to embarkation. Delivery fee – 310,00 EUR - Payable now	No	per week	2.000,00 €
Extra bedlinen (Payable at the base) Season: 2026. Payable at the base	No	per set	15,00 €
Floating Water Hammock (Payable at the base) Season: 2026. Partyzone - Payable at the base	No	per week	220,00 €
JetBoard (Payable now) Season: 2026. Awake Security deposit: 1000 EUR Cancellation policy: 50% cancellation fee in case of cancellation within 2 weeks prior to embarkation. Delivery fee – 310,00 EUR - Payable now	No	per week	2.200,00 €
Outboard engine 2,5 HP (Payable at the base) Season: 2026. Payable at the base	No	per week	100,00 €
Outboard engine 5 HP (Payable at the base) Season: 2026. on request - Payable at the base	No	per week	150,00 €
Railing net (Safety net) (Payable at the base) Season: 2026. Rental without mounting - Payable at the base	No	per booking	20,00 €
RIB 3,8m with console + 20 HP outboard (Payable at the base) Season: 2026. Highfield + deposit raise € 500 50% cancellation fee in case of cancellation within 2 weeks prior to embarkation RIB has to be towed. - Payable at the base	No	per week	790,00 €
Seabob (Payable now) Season: 2026. Seabob F5 Security deposit: 500 EUR Cancellation policy: 50% cancellation fee in case of cancellation within 2 weeks prior to embarkation. Delivery fee – 310,00 EUR - Payable now	No	per week	1.000,00 €

Seabob (Payable now)	No	per week	1.200,00 €
Season: 2026. Seabob F5S Security deposit: 500 EUR Cancellation policy: 50% cancellation fee in case of cancellation within 2 weeks prior to embarkation. Delivery fee – 310,00 EUR – Payable now			
Seabob (Payable now)	No	per week	1.300,00 €
Season: 2026. Seabob F9 Security deposit: 500 EUR Cancellation policy: 50% cancellation fee in case of cancellation within 2 weeks prior to embarkation. Delivery fee – 310,00 EUR – Payable now			
Seabob (Payable now)	No	per week	1.500,00 €
Season: 2026. Seabob F5SR Security deposit: 500 EUR Cancellation policy: 50% cancellation fee in case of cancellation within 2 weeks prior to embarkation. Delivery fee – 310,00 EUR – Payable now			
Seabob (Payable now)	No	per week	1.500,00 €
Season: 2026. Seabob F9S Security deposit: 500 EUR Cancellation policy: 50% cancellation fee in case of cancellation within 2 weeks prior to embarkation. Delivery fee – 310,00 EUR – Payable now			
Snorkeling equipment (Payable at the base)	No	per week	10,00 €
Season: 2026. Payable at the base			
Stand up paddle (SUP) (Payable at the base)	No	per week	120,00 €
Season: 2026. Payable at the base			
Towels (Payable at the base)	No	per set	8,00 €
Season: 2026. 2 psc/set (1 x 50x100cm + 1 x 70x140cm) – Payable at the base			
Wi-Fi Internet (Payable at the base)	No	per week	25,00 €
Season: 2026. Payable at the base			



WEBSITE

www.plujeme.cz



E-MAIL

info@plujeme.cz



PHONE

+420 720 755 085



MOBILE

+420 777 170 276



PLUJEME RÁDI S.R.O.

Dlouhá 730/35, 11000 Praha 1 – Staré Město, Czech Republic

PRICE AND AVAILABILITY

25.04. - 02.05.2026 2.896 € 3.620 €	02.05. - 09.05.2026 2.896 € 3.620 €	13.05. - 17.05.2026 NOT AVAILABLE	23.05. - 30.05.2026 NOT AVAILABLE
30.05. - 06.06.2026 NOT AVAILABLE	06.06. - 13.06.2026 NOT AVAILABLE	13.06. - 20.06.2026 NOT AVAILABLE	20.06. - 27.06.2026 NOT AVAILABLE
27.06. - 04.07.2026 NOT AVAILABLE	04.07. - 11.07.2026 NOT AVAILABLE	11.07. - 18.07.2026 9.328 € 11.660 €	18.07. - 25.07.2026 9.792 € 12.240 €
25.07. - 08.08.2026 NOT AVAILABLE	08.08. - 15.08.2026 NOT AVAILABLE	15.08. - 22.08.2026 8.976 € 11.220 €	22.08. - 29.08.2026 NOT AVAILABLE
29.08. - 05.09.2026 8.112 € 10.140 €	05.09. - 12.09.2026 NOT AVAILABLE	12.09. - 19.09.2026 NOT AVAILABLE	19.09. - 26.09.2026 NOT AVAILABLE
26.09. - 03.10.2026 4.656 € 5.820 €	03.10. - 10.10.2026 3.776 € 4.720 €	10.10. - 17.10.2026 3.248 € 4.060 €	17.10. - 24.10.2026 3.088 € 3.860 €
24.10. - 31.10.2026 2.928 € 3.660 €	31.10. - 07.11.2026 2.928 € 3.660 €	07.11. - 14.11.2026 2.928 € 3.660 €	14.11. - 21.11.2026 2.928 € 3.660 €
21.11. - 28.11.2026 2.928 € 3.660 €	28.11. - 05.12.2026 2.928 € 3.660 €		



WEBSITE

www.plujeme.cz



E-MAIL

info@plujeme.cz



PHONE

+420 720 755 085



MOBILE

+420 777 170 276



PLUJEME RÁDI S.R.O.

Dlouhá 730/35, 11000 Praha 1 – Staré Město, Czech Republic

PRICE AND AVAILABILITY

05.12. - 12.12.2026

2.928 € 3.660 €

12.12. - 19.12.2026

2.928 € 3.660 €

19.12. - 26.12.2026

2.928 € 3.660 €



WEBSITE

www.plujeme.cz



E-MAIL

info@plujeme.cz



PHONE

+420 720 755 085



MOBILE

+420 777 170 276



PLUJEME RÁDI S.R.O.

Dlouhá 730/35, 11000 Praha 1 – Staré Město, Czech Republic