

# BALI CATSPACE OW

Playtime - OW (2025)

Catamaran Bali Catspace OW Playtime - OW, built in 2025 is anchored in the **Sukosan, D-Marin Dalmacija Marina, Zadar region, Croatia**. It has **3 cabins**, can accommodate **6 + 2 people** and has **3 toilets**. Bed linen and kitchen equipment are included in the price.

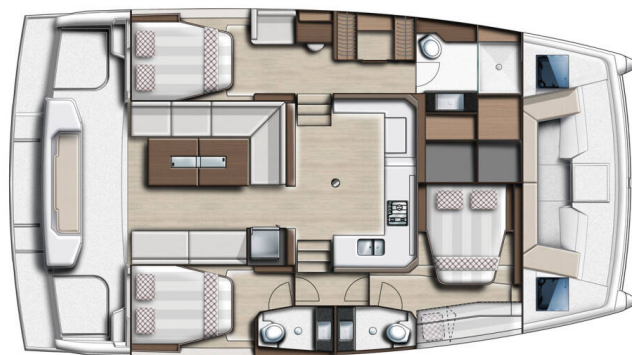

## YACHT SPECIFICATIONS

Yacht Base

**Sukosan, D-Marin Dalmacija Marina,  
Croatia**

Yacht ID

**9859**

Brands

**Catana**

Yacht name

**Playtime - OW**

Production year

**2025**

Length

**40 ft**

Cabins

**3**

Berths

**6 + 2**

WC

**3**

Engine

**2 x 37 HP**

Fuel tank

**400 l**



**WEBSITE**

[www.plujeme.cz](http://www.plujeme.cz)



**PHONE**

+420 720 755 085



**MOBILE**

+420 777 170 276



**E-MAIL**

[info@plujeme.cz](mailto:info@plujeme.cz)



**PLUJEME RÁDI S.R.O.**

Dlouhá 730/35, 11000 Praha 1 - Staré Město, Czech Republic

## STANDARD YACHT EQUIPMENT

Comfort	<b>Bed linen, Cockpit cushions, Sundeck cushions</b>
Deck	<b>Bathing platform, Bimini top, Cockpit table, Cockpit/stern, outside shower, Dinghy, Fly sunbathing area, Forward cockpit</b>
Entertainment	<b>Outdoor speakers, Radio mp3 player</b>
Galley	<b>Freezer, Hot water, Kitchen utensils (Galley equipment, cutlery), Oven, Refrigerator, Stove</b>
Interior	<b>Convertible table in salon, Electric fans in cabins</b>
Navigation	<b>Autopilot, GPS chart plotter - cockpit, Navigation (Nautical) charts and nautical guide, Pilot book, Tridata</b>
Safety	<b>VHF radio</b>
Sails	<b>Electric halyard winch</b>
Yacht electrics	<b>Air Conditioning, Battery charger, Heating, Inverter, Solar panels</b>



**WEBSITE**

[www.plujeme.cz](http://www.plujeme.cz)



**E-MAIL**

[info@plujeme.cz](mailto:info@plujeme.cz)



**PHONE**

+420 720 755 085



**MOBILE**

+420 777 170 276



**PLUJEME RÁDI S.R.O.**

Dlouhá 730/35, 11000 Praha 1 – Staré Město, Czech Republic

## SERVICES

SELECTED SERVICES	OBLIGATORY	PAYMENT TYPE	PRICE
<b>Charter pack</b> (Payable at the base) <b>Season: 2026.</b> includes final cleaning, bedlinen, towels - 1 set/person, cooking gas	Yes	per booking	<b>390,00 €</b>
<b>Outboard engine</b> (Payable at the base) <b>Season: 2026.</b> Free of charge for bookings in May	Yes	per booking	<b>0,00 €</b>
<b>Comfort Pack</b> (Payable at the base) <b>Season: 2026.</b> includes outboard 2,5 HP, WiFi routers	No	per week	<b>105,00 €</b>
<b>Deposit insurance</b> (Payable at the base) <b>Season: 2026.</b> + 400 EUR refundable deposit	No	per booking	<b>320,00 €</b>
<b>Early Check in</b> (Payable at the base) <b>Season: 2026.</b> Saturdays between 13hr - 14hr. Early check in can be confirmed only on embarkation day in the charter base.	No	per booking	<b>200,00 €</b>
<b>Flexible booking</b> (Payable now) <b>Season: 2026.</b> allows you to cancel or rebook your charter up to 30 days before the embarkation for no specific reason. You can reschedule your holiday at no cost for unlimited number of times or use a credit note if you are uncertain of new charter dates. With our FLEX PLAN your rebooking costs are completely eliminated while cancellation costs with refund option are reduced to a minimum (15% of the charter fee, min 350 EUR). Extra bonus: free cancellation and FULL REFUND granted in case of closed state borders within 7 days before the embarkation. Notes: FLEX PLAN costs 7% of the final charter price, can be added to booking up to 72hr after booking confirmation and is not available for bookings confirmed within 30 days before the embarkation.	No	per booking	<b>0,00 €</b>
<b>Hostess</b> (Payable now) <b>Season: 2026.</b> + own cabin 50% cancellation fee in case of cancellation up to 15 days prior to embarkation 100% cancellation fee in case of cancellation within 14 days prior to embarkation	No	per day + food	<b>220,00 €</b>
<b>Late check out</b> (Payable at the base) <b>Season: 2026.</b> Saturdays till 10hr Late check-out can be confirmed only on Friday before the embarkation day.	No	per booking	<b>300,00 €</b>

<b>One way fee</b> (Payable at the base)	No	per booking	<b>200,00 €</b>
<b>Season: 2026.</b> Suk - Ši / Ši - Suk On request only. One-way conditions: one way fee + skipper service obligatory for the whole booking period + mooring fee in port of disembarkation/embarkation			
<b>One way fee</b> (Payable at the base)	No	per booking	<b>420,00 €</b>
<b>Season: 2026.</b> Suk - Seg / Seg - Suk On request only. One-way conditions: one way fee + skipper service obligatory for the whole booking period + mooring fee in port of disembarkation/embarkation			
<b>One way fee</b> (Payable at the base)	No	per booking	<b>420,00 €</b>
<b>Season: 2026.</b> Suk - Kas / Kas - Suk On request only. One-way conditions: one way fee + skipper service obligatory for the whole booking period + mooring fee in port of disembarkation/embarkation; check-out on Friday until 12:00 in Kaštela			
<b>Pet on board</b> (Payable at the base)	No	per booking	<b>150,00 €</b>
<b>Season: 2026.</b> Small or medium pet, up to 25 kg			
<b>Provisioning</b> (Payable now)	No	per booking	<b>0,00 €</b>
<b>Season: 2026.</b> upon request + price of groceries, to be done online			
<b>Skipper</b> (Payable now)	No	per day + food	<b>220,00 €</b>
<b>Season: 2026.</b> + own cabin 50% cancellation fee in case of cancellation up to 15 days prior to embarkation 100% cancellation fee in case of cancellation within 14 days prior to embarkation			



**WEBSITE**

[www.plujeme.cz](http://www.plujeme.cz)



**E-MAIL**

[info@plujeme.cz](mailto:info@plujeme.cz)



**PHONE**

+420 720 755 085



**MOBILE**

+420 777 170 276



**PLUJEME RÁDI S.R.O.**

Dlouhá 730/35, 11000 Praha 1 – Staré Město, Czech Republic

## ADDITIONAL EXTRAS

EXTRA	OBLIGATORY	PAYMENT TYPE	PRICE
<b>Beach towel</b> (Payable at the base) <b>Season: 2026.</b> Payable at the base	No	per piece	<b>8,00 €</b>
<b>Extra bedlinen</b> (Payable at the base) <b>Season: 2026.</b> Payable at the base	No	per set	<b>15,00 €</b>
<b>Floating Water Hammock</b> (Payable at the base) <b>Season: 2026.</b> Partyzone - Payable at the base	No	per week	<b>220,00 €</b>
<b>Outboard engine 2,5 HP</b> (Payable at the base) <b>Season: 2026.</b> Payable at the base	No	per week	<b>100,00 €</b>
<b>Outboard engine 5 HP</b> (Payable at the base) <b>Season: 2026.</b> on request - Payable at the base	No	per week	<b>150,00 €</b>
<b>Railing net (Safety net)</b> (Payable at the base) <b>Season: 2026.</b> Rental without mounting - Payable at the base	No	per booking	<b>20,00 €</b>
<b>RIB 3,8m with console + 20 HP outboard</b> (Payable at the base) <b>Season: 2026.</b> Highfield + deposit raise € 500 50% cancellation fee in case of cancellation within 2 weeks prior to embarkation RIB has to be towed. - Payable at the base	No	per week	<b>790,00 €</b>
<b>Snorkeling equipment</b> (Payable at the base) <b>Season: 2026.</b> Payable at the base	No	per week	<b>10,00 €</b>
<b>Stand up paddle (SUP)</b> (Payable at the base) <b>Season: 2026.</b> Payable at the base	No	per week	<b>120,00 €</b>
<b>Towels</b> (Payable at the base) <b>Season: 2026.</b> 2 psc/set (1 x 50x100cm + 1 x 70x140cm) - Payable at the base	No	per set	<b>8,00 €</b>
<b>Wi-Fi Internet</b> (Payable at the base) <b>Season: 2026.</b> Payable at the base	No	per week	<b>25,00 €</b>



**WEBSITE**  
www.plujeme.cz



**PHONE**  
+420 720 755 085



**MOBILE**  
+420 777 170 276



**E-MAIL**  
info@plujeme.cz



**PLUJEME RÁDI S.R.O.**  
Dlouhá 730/35, 11000 Praha 1 – Staré Město, Czech Republic

## PRICE AND AVAILABILITY

25.04. - 02.05.2026 1.776 € 2.220 €	02.05. - 09.05.2026 NOT AVAILABLE	09.05. - 16.05.2026 1.984 € 2.480 €	16.05. - 23.05.2026 2.528 € 3.160 €
23.05. - 30.05.2026 NOT AVAILABLE	30.05. - 06.06.2026 NOT AVAILABLE	06.06. - 13.06.2026 4.368 € 5.460 €	13.06. - 27.06.2026 NOT AVAILABLE
27.06. - 04.07.2026 5.456 € 6.820 €	04.07. - 11.07.2026 NOT AVAILABLE	11.07. - 18.07.2026 NOT AVAILABLE	18.07. - 25.07.2026 6.256 € 7.820 €
25.07. - 01.08.2026 6.256 € 7.820 €	01.08. - 08.08.2026 6.256 € 7.820 €	08.08. - 29.08.2026 NOT AVAILABLE	29.08. - 05.09.2026 5.056 € 6.320 €
05.09. - 12.09.2026 5.056 € 6.320 €	12.09. - 19.09.2026 NOT AVAILABLE	19.09. - 26.09.2026 4.096 € 5.120 €	26.09. - 03.10.2026 3.056 € 3.820 €
03.10. - 10.10.2026 2.448 € 3.060 €	10.10. - 17.10.2026 2.192 € 2.740 €	17.10. - 24.10.2026 2.096 € 2.620 €	24.10. - 31.10.2026 1.984 € 2.480 €
31.10. - 07.11.2026 1.984 € 2.480 €	07.11. - 14.11.2026 1.984 € 2.480 €	14.11. - 21.11.2026 1.984 € 2.480 €	21.11. - 28.11.2026 1.984 € 2.480 €
28.11. - 05.12.2026 1.984 € 2.480 €			



WEBSITE

[www.plujeme.cz](http://www.plujeme.cz)



E-MAIL

[info@plujeme.cz](mailto:info@plujeme.cz)



PHONE

+420 720 755 085



MOBILE

+420 777 170 276



PLUJEME RÁDI S.R.O.

Dlouhá 730/35, 11000 Praha 1 – Staré Město, Czech Republic

## PRICE AND AVAILABILITY

05.12. - 12.12.2026

**1.984 €** 2.480 €

12.12. - 19.12.2026

**1.984 €** 2.480 €

19.12. - 26.12.2026

**1.984 €** 2.480 €



**WEBSITE**

[www.plujeme.cz](http://www.plujeme.cz)



**E-MAIL**

[info@plujeme.cz](mailto:info@plujeme.cz)



**PHONE**

+420 720 755 085



**MOBILE**

+420 777 170 276



**PLUJEME RÁDI S.R.O.**

Dlouhá 730/35, 11000 Praha 1 – Staré Město, Czech Republic