

DUFOUR 390 GL

MAYBE TOMORROW (2023)

Sailing yacht Dufour 390 GL MAYBE TOMORROW, built in 2023 is anchored in the Nassau, Palm Cay Marina, New Providence, Bahamas. It has 3 cabins, can accommodate 6 + 2 people and has 2 toilets. Bed linen and kitchen equipment are included in the price.

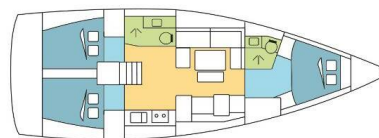

YACHT SPECIFICATIONS

Yacht Base

Nassau, Palm Cay Marina, Bahamas

Yacht ID

9826

Brands

Dufour

Yacht name

MAYBE TOMORROW

Production year

2023

Length

39 ft

Cabins

3

Berths

6 + 2

Max Persons

8

WC

2

Engine

1 x 50 HP

Fuel tank

200 l



WEBSITE

www.plujeme.cz



PHONE

+420 720 755 085



MOBILE

+420 777 170 276



E-MAIL

info@plujeme.cz



PLUJEME RÁDI S.R.O.

Dlouhá 730/35, 11000 Praha 1 – Staré Město, Czech Republic

STANDARD YACHT EQUIPMENT

Comfort	Mosquito nets
Deck	Bimini top, Cockpit table, Cockpit/stern, outside shower, Electric anchor windlass, Outboard engine, Sprayhood, Swimming ladder
Entertainment	Outdoor speakers, Radio CD mp3 player
Galley	Oven, Wine cellar
Interior	Convertible table in salon, Electric toilet
Navigation	AIS, Autopilot, Depthsounder, GPS chart plotter, LED Navigation lights, Wind instrument/Anemometer
Safety	VHF radio
Sails	Lazy bag, Lazy jacks
Yacht electrics	Air Conditioning, Battery charger, Inverter, Service batteries



WEBSITE

www.plujeme.cz



PHONE

+420 720 755 085



MOBILE

+420 777 170 276



E-MAIL

info@plujeme.cz



PLUJEME RÁDI S.R.O.

Dlouhá 730/35, 11000 Praha 1 – Staré Město, Czech Republic

SERVICES

SELECTED SERVICES	OBLIGATORY	PAYMENT TYPE	PRICE
Bahamas foreign charter tax (Payable now) Season: 2026 Exotic.	Yes	per booking	0,00 €
Essentials pack (Payable now) Season: 2026 Exotic. INCLUDED: Damage waiver (covering damages) with reduced security deposit addressed specifically to blocked toilets, unpaid fuel, lost equipment, unpaid fees & fines, and returning the boat in an extremely dirty state. // starter pack – (1 gallon water or 4 bottles of 1.5L, 1 bottle of disinfectant, 1 small bottle of washing up liquid, 1 dish cloth, 1 sponge, garbage bags, 1 roll of paper towels, 1 box of matches, 1 roll of toilet paper in each head) // final cleaning // 1 set of bed sheets & towels, dinghy, outboard engine & initial supply of fuel, gas and water tanks // DYC assistance guarantee // 1st & last night in the marina /// NOT INCLUDED: refuelling, gas & water consumption at end of charter, taxes if any, handling fees & additional equipment deposit.	Yes	per booking	745,00 €
Handling fees (Payable now) Season: 2026 Exotic.	Yes	per booking	35,00 €
Preparation fee (Payable now) Season: 2026 Exotic. INCLUDED: starter pack – (1 gallon water or 4 bottles of 1.5L, 1 bottle of disinfectant, 1 small bottle of washing up liquid, 1 dish cloth, 1 sponge, garbage bags, 1 roll of paper towels, 1 box of matches, 1 roll of toilet paper in each head) // final cleaning // 1 set of bed sheets / cabin & 1 set of towels / pax, dinghy, outboard engine & initial supply of fuel, gas and water tanks // DYC assistance guarantee // 1st & last night in the marina // NOT INCLUDED: refuelling, gas & water consumption at end of charter, taxes if any, handling fees & additional equipment deposit.	Yes	per booking	345,00 €
Crew change (Payable now) Season: 2026 Exotic. Any crew change during the charter is subject to € 250.- additional cost. The charge includes administration cost, change of bed linen and towels and one night at DYC ponton (marina fee included only if the same base than start base). It doesn't include cleaning, nor new transit log where applicable.	No	per booking	250,00 €

Damage waiver (Payable now)	No	per night	70,00 €
Season: 2026 Exotic. Damage waiver limits your liability to the reduced Security Deposit . Mandatory when skipper is added. Price is per night of the charter (minimum value of 7 nights & a maximum value of 21 nights) Not applicable for 4+ weeks charters , nor Regattas/Races.			
Early boarding/check-in (Payable now)	No	per booking	300,00 €
Season: 2026 Exotic. EB (boat only) - 14:00 h / 2 PM starting time of boat's delivery // limited number of early boardings on same departure day			
Early boarding/check-in (Payable now)	No	per booking	585,00 €
Season: 2026 Exotic. EB boat + extra fee skipper - 14:00 h / 2 PM starting time of boat's delivery // limited number of early boardings on same departure day			
Early boarding/check-in (Payable now)	No	per booking	810,00 €
Season: 2026 Exotic. EB + extra fee Skipper & Hostes - 14:00 h / 2 PM starting time of boat's delivery // limited number of early boardings on same departure day			
Electric & Water consumption in the Marinas (Payable at the base)	No	per booking	16,00 €
Season: 2026 Exotic. Electric & Water consumption based on 2 nights on our dock (base will confirm the amount to pay locally depending on nights spent on dock)			
Extra cleaning (Payable now)	No	per booking	265,00 €
Season: 2026 Exotic. Optional Additional cleaning			
Extra set of linen (choose how many) (Payable now)	No	per booking	15,00 €
Season: 2026 Exotic. Extra set of linen : 15 € 1 set of linen (2 sheets & 2 pillow case) - to be updated manually			
Extra set of towels (choose how many) (Payable now)	No	per booking	10,00 €
Season: 2026 Exotic. Extra set of towels: 10 € 1 set of towels (1 face & 1 bath towel) - to be updated manually			
Final cleaning (Payable now)	No	per booking	265,00 €
Season: 2026 Exotic. included in Essentials pack			
Final cleaning (Payable now)	No	per booking	265,00 €
Season: 2026 Exotic. included in Essentials pack			
Full board 1-4 pax (number of guests to update manually) (Payable now)	No	per guest/day	75,00 €
Season: 2026 Exotic. only available if cook is booked on board as the cook will do the provisioning based on client's preference. Includes breakfast, lunch & dinner + the crew's food. Does not included alcoholic drinks			

<p>Full board 5-12 pax (number of guests to update manually) (Payable now)</p> <p>Season: 2026 Exotic. only available if cook is booked on board as the cook will do the provisioning based on client's preference. Includes breakfast, lunch & dinner + the crew's food. Does not included alcoholic drinks</p>	No	per guest/day	70,00 €
<p>Hostess/Cook (Payable now)</p> <p>Season: 2026 Exotic. + provisioning, Crew on board must have their own toilets/ showers. If either a skipper or a hostess/cook is on board, 1 double cabin will be required for him/her. If both a skipper and a hostess/cook are on board, 1 double cabin and 1 forepeak cabin will be required for them. Exceptions exists for specific layouts, Sales Agents will provide more details about the different boat models</p>	No	per night	230,00 €
<p>Hostess/Cook (Payable now)</p> <p>Season: 2026 Exotic. + provisioning, Crew on board must have their own toilets/ showers. If either a skipper or a hostess/cook is on board, 1 double cabin will be required for him/her. If both a skipper and a hostess/cook are on board, 1 double cabin and 1 forepeak cabin will be required for them. Exceptions exists for specific layouts, Sales Agents will provide more details about the different boat models</p>	No	per night	230,00 €
<p>Hostess/Cook (Payable now)</p> <p>Season: 2026 Exotic. + provisioning, Crew on board must have their own toilets/ showers. If either a skipper or a hostess/cook is on board, 1 double cabin will be required for him/her. If both a skipper and a hostess/cook are on board, 1 double cabin and 1 forepeak cabin will be required for them. Exceptions exists for specific layouts, Sales Agents will provide more details about the different boat models</p>	No	per night	255,00 €
<p>Regatta surcharge (Payable now)</p> <p>Season: 2026 Exotic. all the regattas apart of ASW (different regatta surcharge for ASW) // A special race deposit need to be doubled manually once the regatta surcharge is added.</p>	No	per booking	0,00 €
<p>Same day briefing (Payable now)</p> <p>Season: 2026 Exotic. Same day briefing starting between 5 & 5.30pm (departure following morning)</p>	No	per booking	120,00 €
<p>Skipper (Payable now)</p> <p>Season: 2026 Exotic. + provisioning, Crew on board must have their own toilets/ showers. If either a skipper or a hostess/cook is on board, 1 double cabin will be required for him/her. If both a skipper and a hostess/cook are on board, 1 double cabin and 1 forepeak cabin will be required for them. Exceptions exists for specific layouts, Sales Agents will provide more details about the different boat models</p>	No	per night	300,00 €

<p>Skipper (Payable now)</p> <p>Season: 2026 Exotic. + provisioning, Crew on board must have their own toilets/ showers. If either a skipper or a hostess/cook is on board, 1 double cabin will be required for him/her. If both a skipper and a hostess/cook are on board, 1 double cabin and 1 forepeak cabin will be required for them. Exceptions exists for specific layouts, Sales Agents will provide more details about the different boat models</p>	No	per night	300,00 €
<p>Skipper (Payable now)</p> <p>Season: 2026 Exotic. + provisioning, Crew on board must have their own toilets/ showers. If either a skipper or a hostess/cook is on board, 1 double cabin will be required for him/her. If both a skipper and a hostess/cook are on board, 1 double cabin and 1 forepeak cabin will be required for them. Exceptions exists for specific layouts, Sales Agents will provide more details about the different boat models</p>	No	per night	330,00 €
<p>Starter pack (Payable now)</p> <p>Season: 2026 Exotic. included in Essentials pack (The pack includes: 1 gallon water (or 4 bottles of 1.5L), 1 bottle of disinfectant, 1 small bottle of washing up liquid, 1 dish cloth, 1 sponge, garbage bags, 1 roll of paper towels, 1 box of matches, 1 roll of toilet paper in each head</p>	No	per booking	50,00 €
<p>Transfer (Payable now)</p> <p>Season: 2026 Exotic. OW- airport - marina -1-2 pax + 6€ each additional pax (up to 6 pax)</p>	No	one-way	100,00 €
<p>Transfer (Payable now)</p> <p>Season: 2026 Exotic. OW- airport/marina - includes grocery stop (1 hour max) 1-2 pax + 6€ each additional pax (up to 6 pax)</p>	No	one-way	153,00 €
<p>Transfer (Payable now)</p> <p>Season: 2026 Exotic. OW- 7-9 pax: airport - marina</p>	No	one-way	177,00 €
<p>Transfer (Payable now)</p> <p>Season: 2026 Exotic. RT - airport - marina - airport 1-2 pax + 12€ each additional pax (up to 6 pax)</p>	No	round trip	200,00 €
<p>Transfer (Payable now)</p> <p>Season: 2026 Exotic. OW - 7-9 pax: airport/marina- includes grocery stop (1 hour max)</p>	No	one-way	230,00 €
<p>Transfer (Payable now)</p> <p>Season: 2026 Exotic. OW- 10-12 pax: airport - marina</p>	No	one-way	236,00 €

Transfer (Payable now)	No	one-way	290,00 €
Season: 2026 Exotic. OW - 10-12 pax: airport/marina- includes grocery stop (1 hour max)			
Transfer (Payable now)	No	round trip	306,00 €
Season: 2026 Exotic. RT- airport/marina/airport - includes grocery stop (1 hour max) 1-2 pax + 12€ each additional pax (up to 6 pax)			
Transfer (Payable now)	No	round trip	355,00 €
Season: 2026 Exotic. RT - 7-9 pax: airport - marina - airport			
Transfer (Payable now)	No	round trip	460,00 €
Season: 2026 Exotic. RT- 7-9 pax: airport/marina/airport - includes grocery stop (1 hour max)			
Transfer (Payable now)	No	round trip	473,00 €
Season: 2026 Exotic. RT - 10-12 pax: airport - marina - airport			
Transfer (Payable now)	No	round trip	580,00 €
Season: 2026 Exotic. RT- 10-12 pax: airport/marina/airport - includes grocery stop (1 hour max)			
WI-FI Internet connection on boat (Payable now)	No	per night	21,00 €
Season: 2026 Exotic. Unlimited data			



WEBSITE

www.plujeme.cz



E-MAIL

info@plujeme.cz



PHONE

+420 720 755 085



MOBILE

+420 777 170 276



PLUJEME RÁDI S.R.O.

Dlouhá 730/35, 11000 Praha 1 – Staré Město, Czech Republic

ADDITIONAL EXTRAS

EXTRA	OBLIGATORY	PAYMENT TYPE	PRICE
Fishing equipment (Payable now) Season: 2026 Exotic. Additional deposit 100 EUR (subject to availability) - Payable now	No	per day	15,00 €
Kayak single (Payable now) Season: 2026 Exotic. price per day - Payable now	No	per night	15,00 €
Kayak tandem (Payable now) Season: 2026 Exotic. price per day - Payable now	No	per night	15,00 €
Railing net (Safety net) (Payable now) Season: 2026 Exotic. net is supplied but not installed - Payable now	No	per booking	220,00 €
Stand up paddle (SUP) (Payable now) Season: 2026 Exotic. Price per day - Payable now	No	per night	15,00 €

**WEBSITE**www.plujeme.cz**E-MAIL**info@plujeme.cz**PHONE**

+420 720 755 085

**MOBILE**

+420 777 170 276

**PLUJEME RÁDI S.R.O.**

Dlouhá 730/35, 11000 Praha 1 – Staré Město, Czech Republic

PRICE AND AVAILABILITY

25.04. - 02.05.2026 5.860 €	02.05. - 09.05.2026 4.195 €	09.05. - 16.05.2026 4.355 €	16.05. - 23.05.2026 NOT AVAILABLE
23.05. - 30.05.2026 3.390 €	30.05. - 06.06.2026 3.440 €	06.06. - 13.06.2026 3.415 €	13.06. - 20.06.2026 3.415 €
20.06. - 27.06.2026 3.196 € 3.760 €	27.06. - 04.07.2026 3.196 € 3.760 €	04.07. - 11.07.2026 3.392 € 3.990 €	11.07. - 18.07.2026 3.052 € 3.590 €
18.07. - 25.07.2026 2.975 € 3.500 €	25.07. - 01.08.2026 2.678 € 3.150 €	01.08. - 08.08.2026 2.763 € 3.250 €	08.08. - 15.08.2026 2.159 € 2.540 €
15.08. - 22.08.2026 2.159 € 2.540 €	22.08. - 29.08.2026 2.159 € 2.540 €	29.08. - 05.09.2026 2.540 €	05.09. - 12.09.2026 2.540 €
12.09. - 19.09.2026 2.540 €	19.09. - 26.09.2026 2.540 €	26.09. - 03.10.2026 2.540 €	03.10. - 10.10.2026 2.540 €
10.10. - 17.10.2026 2.540 €	17.10. - 24.10.2026 2.540 €	24.10. - 31.10.2026 2.241 € 2.490 €	31.10. - 07.11.2026 2.849 € 3.165 €
07.11. - 14.11.2026 2.862 € 3.180 €	14.11. - 21.11.2026 4.275 € 4.750 €	27.11. - 06.12.2026 NOT AVAILABLE	



WEBSITE

www.plujeme.cz



E-MAIL

info@plujeme.cz



PHONE

+420 720 755 085



MOBILE

+420 777 170 276



PLUJEME RÁDI S.R.O.

Dlouhá 730/35, 11000 Praha 1 – Staré Město, Czech Republic

PRICE AND AVAILABILITY

12.12. - 19.12.2026 4.064 € 4.515 €	19.12. - 26.12.2026 5.342 € 5.935 €	02.01. - 09.01.2027 4.464 € 4.960 €	09.01. - 16.01.2027 4.739 € 5.265 €
16.01. - 23.01.2027 5.009 € 5.565 €	23.01. - 30.01.2027 5.018 € 5.575 €	30.01. - 06.02.2027 5.553 € 6.170 €	06.02. - 13.02.2027 5.567 € 6.185 €
13.02. - 20.02.2027 5.022 € 5.580 €	20.02. - 27.02.2027 5.567 € 6.185 €	27.02. - 06.03.2027 5.549 € 6.165 €	06.03. - 13.03.2027 5.558 € 6.175 €
13.03. - 20.03.2027 6.192 € 6.880 €	20.03. - 27.03.2027 6.399 € 7.110 €	27.03. - 03.04.2027 6.404 € 7.115 €	03.04. - 10.04.2027 6.129 € 6.810 €
10.04. - 17.04.2027 5.567 € 6.185 €	17.04. - 24.04.2027 6.458 € 7.175 €	24.04. - 01.05.2027 5.864 € 6.515 €	01.05. - 08.05.2027 4.662 € 5.180 €
08.05. - 15.05.2027 4.203 € 4.670 €	15.05. - 22.05.2027 4.050 € 4.500 €	22.05. - 29.05.2027 4.037 € 4.485 €	29.05. - 05.06.2027 4.046 € 4.495 €
05.06. - 12.06.2027 4.041 € 4.490 €	12.06. - 19.06.2027 4.041 € 4.490 €	19.06. - 26.06.2027 3.758 € 4.175 €	26.06. - 03.07.2027 4.824 € 5.360 €
03.07. - 10.07.2027 5.387 € 5.985 €	10.07. - 17.07.2027 5.387 € 5.985 €	17.07. - 24.07.2027 4.595 € 5.105 €	24.07. - 31.07.2027 4.136 € 4.595 €
31.07. - 07.08.2027 3.348 € 3.720 €			



WEBSITE

www.plujeme.cz



E-MAIL

info@plujeme.cz



PHONE

+420 720 755 085



MOBILE

+420 777 170 276



PLUJEME RÁDI S.R.O.

Dlouhá 730/35, 11000 Praha 1 – Staré Město, Czech Republic

PRICE AND AVAILABILITY

07.08. - 14.08.2027 2.286 € 2.540 €	14.08. - 21.08.2027 2.286 € 2.540 €	21.08. - 28.08.2027 2.286 € 2.540 €	28.08. - 04.09.2027 2.286 € 2.540 €
04.09. - 11.09.2027 2.286 € 2.540 €	11.09. - 18.09.2027 2.286 € 2.540 €	18.09. - 25.09.2027 2.286 € 2.540 €	25.09. - 02.10.2027 2.286 € 2.540 €
02.10. - 09.10.2027 2.286 € 2.540 €	09.10. - 16.10.2027 2.286 € 2.540 €	16.10. - 23.10.2027 2.286 € 2.540 €	23.10. - 30.10.2027 2.241 € 2.490 €
30.10. - 06.11.2027 2.849 € 3.165 €	06.11. - 13.11.2027 3.182 € 3.535 €	13.11. - 20.11.2027 4.073 € 4.525 €	20.11. - 27.11.2027 4.473 € 4.970 €
27.11. - 04.12.2027 3.483 € 3.870 €	04.12. - 11.12.2027 4.266 € 4.740 €	11.12. - 18.12.2027 4.064 € 4.515 €	18.12. - 25.12.2027 5.342 € 5.935 €



WEBSITE

www.plujeme.cz



E-MAIL

info@plujeme.cz



PHONE

+420 720 755 085



MOBILE

+420 777 170 276



PLUJEME RÁDI S.R.O.

Dlouhá 730/35, 11000 Praha 1 – Staré Město, Czech Republic