

OCEANIS 40.1

Roza (2022)

Sailing yacht Oceanis 40.1 Roza, built in 2022 is anchored in the Athens, Alimos marina, Athens area/Saronic/Peloponese, Greece. It has 4 cabins, can accommodate 10 people and has 2 toilets. Bed linen and kitchen equipment are included in the price.

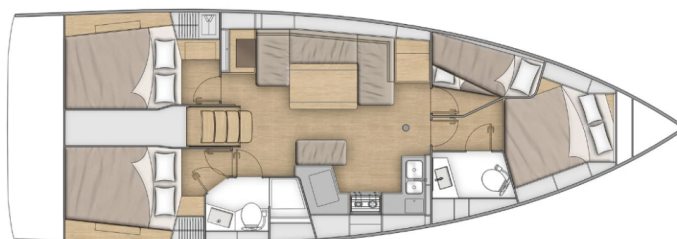

YACHT SPECIFICATIONS

Yacht Base

Athens, Alimos marina, Greece

Yacht ID

9794

Brands

Beneteau

Yacht name

Roza

Production year

2022

Length

42 ft

Cabins

4

Berths

10

Max Persons

10

WC

2

Engine

1 x 0 HP

Fuel tank

0 l



WEBSITE

www.plujeme.cz



PHONE

+420 720 755 085



MOBILE

+420 777 170 276



E-MAIL

info@plujeme.cz



PLUJEME RÁDI S.R.O.

Dlouhá 730/35, 11000 Praha 1 – Staré Město, Czech Republic

STANDARD YACHT EQUIPMENT

Comfort	Cockpit cushions
Deck	Bathing platform, Bimini Top - Mini, Gangway, Sprayhood
Entertainment	Outdoor speakers
Galley	Additional fridge, Kitchen utensils (Galley equipment, cutlery)
Interior	Convertible table, Electric fans in cabins, Electric toilet
Navigation	Autopilot, Bow thruster, Echosounder/Depthsounder, GPS chart plotter - cockpit, Wind instrument/Anemometer
Yacht electrics	220V socket, Batteries, Solar panels, USB charger for mobile phone and laptop



WEBSITE

www.plujeme.cz



E-MAIL

info@plujeme.cz



PHONE

+420 720 755 085



MOBILE

+420 777 170 276



PLUJEME RÁDI S.R.O.

Dlouhá 730/35, 11000 Praha 1 – Staré Město, Czech Republic

SERVICES

SELECTED SERVICES	OBLIGATORY	PAYMENT TYPE	PRICE
Starter pack (Payable at the base) Season: 2026. End cleaning, 1x Cooking gas, Water, Linen 1 set (2 sheets, 1 pillow case, 1 bath towel, 1 face towel) per person, Harbour fees for the first & last night. * If there is pet on board, then double cleaning will be applied.; Payable on the spot with cash 🎒 bag with Greek Local Products is offered to all of our charters as a welcome gift.	Yes	per booking	300,00 €
Cook (Payable at the base) Season: 2026. (Crew require their own cabin); Only responsible for daily cooking / provisioning and cleaning relevant to kitchen area; Payable on the spot with cash; Crew Cancellation Policy A Down payment of 25% is required upon confirmation, and the rest are payable on the spot with cash. Crew cancelled 4 weeks prior to embarkation will have 25% of total crew fee applicable. Crew cancelled less than 14 days prior to embarkation will have 100% of the total crew fee applicable.	No	per day + food	200,00 €
Crew change (Payable at the base) Season: 2026. Payable on the spot with cash Applicable only at one of our bases: Included : Formalities (contract, crew list, etc.) and one day of mooring fees. Not included: Yachts cleaning and laundry.	No	per booking	150,00 €
Early boarding/check-in (Payable at the base) Season: 2026. Access to the yacht by 14:00 In the event of delay beyond our control refunds will be made.; Payable on the spot with cash	No	per booking	200,00 €
Hostess (Payable at the base) Season: 2026. *crew require their own cabin; Payable on the spot with cash Crew Cancellation Policy A Down payment of 25% is required upon confirmation, and the rest are payable on the spot with cash. Crew cancelled 4 weeks prior to embarkation will have 25% of total crew fee applicable. Crew cancelled less than 14 days prior to embarkation will have 100% of the total crew fee applicable.	No	per day + food	190,00 €
Internet pack (Payable at the base) Season: 2026. +20 € per week after the 1st (WiFi hotspot for up to 5 devices and unlimited usage of internet); Payable on the spot with cash	No	per booking	70,00 €
Linen Pack (Payable at the base) Season: 2026. 1 Extra set of linen (2 sheets, 1 pillow case, 1 bath towel, 1 face towel); Payable on the spot with cash	No	per set	10,00 €

<p>Non refundable deposit/ insurance (Payable at the base)</p> <p>Season: 2026. + refundable deposit 600 EUR; non refundable payable on spot in cash and refundable payable by credit card on spot * Non-Refundable Deposit is mandatory on all skippered charters.</p>	No	per booking	300,00 €
<p>Skipper (Payable at the base)</p> <p>Season: 2026. (Crew require their own cabin); Payable on the spot with cash Crew Cancellation Policy A Down payment of 25% is required upon confirmation, and the rest are payable on the spot with cash. Crew cancelled 4 weeks prior to embarkation will have 25% of total crew fee applicable. Crew cancelled less than 14 days prior to embarkation will have 100% of the total crew fee applicable. Damage waiver is obligatory for skippered charters.</p>	No	per day + food	210,00 €
<p>Welcome package (Payable at the base)</p> <p>Season: 2026. Toilet and Kitchen rolls, matches, Plastic bags for rubbish, 1 Dish Sponge, 1 Dish, Soap, Sugar, Salt and Pepper, Coffee, 6 bottles of Water, 1 bottle of wine, 6 cans of Coke, 6 cans of Beer, Milk, Orange Juice; Payable on the spot with cash</p>	No	per booking	70,00 €



WEBSITE
www.plujeme.cz



PHONE
+420 720 755 085



MOBILE
+420 777 170 276



E-MAIL
info@plujeme.cz



PLUJEME RÁDI S.R.O.
Dlouhá 730/35, 11000 Praha 1 – Staré Město, Czech Republic

ADDITIONAL EXTRAS

EXTRA	OBLIGATORY	PAYMENT TYPE	PRICE
Automatic Inflatable Life Jacket (Payable at the base) Season: 2026. Payable on the spot with cash - Payable at the base	No	per piece	30,00 €
Beach towel (Payable at the base) Season: 2026. Payable on the spot with cash - Payable at the base	No	per piece	5,00 €
Bed linen (Payable at the base) Season: 2026. Payable on the spot with cash - Payable at the base	No	per set	10,00 €
Blister (Payable at the base) Season: 2026. + additional security deposit 500EUR; Payable on the spot with cash - Payable at the base	No	per week	200,00 €
Electric outboard engine (Payable at the base) Season: 2026. 3 HP; Subject to availability, payable on the spot with cash - Payable at the base	No	per week	110,00 €
Grill/Barbecue/Plancha (Payable at the base) Season: 2026. Gas - Payable at the base	No	per week	100,00 €
Kayak (Payable at the base) Season: 2026. Payable on the spot with cash - Payable at the base	No	per week	130,00 €
Life jacket (children) (Payable at the base) Season: 2026. for children under 25 kg, one included in every yacht free of charge; Payable on the spot with cash - Payable at the base	No	per week/ person	20,00 €
Outboard engine (Payable at the base) Season: 2026. Payable on the spot with cash - Payable at the base	No	per week	100,00 €
Railing net (Safety net) (Payable at the base) Season: 2026. 200 € for yachts up to 46 ft., 300 € per week for yachts above 46ft & catamarans (Half price if the railing net is supplied uninstalled). Payable on the spot with cash - Payable at the base	No	per week	200,00 €
SEA-D00 underwater scooter (Payable at the base) Season: 2026. Payable on the spot with cash - Payable at the base	No	per week	150,00 €

Snorkeling equipment (Payable at the base)

No

per week/ person

10,00 €

Season: 2026. The set contains mask, inhalator and flippers; Payable on the spot with cash - Payable at the base

Stand up paddle (SUP) (Payable at the base)

No

per week

130,00 €

Season: 2026. Payable on the spot with cash - Payable at the base



WEBSITE

www.plujeme.cz



PHONE

+420 720 755 085



MOBILE

+420 777 170 276



E-MAIL

info@plujeme.cz



PLUJEME RÁDI S.R.O.

Dlouhá 730/35, 11000 Praha 1 – Staré Město, Czech Republic

PRICE AND AVAILABILITY

25.04. - 02.05.2026 NOT AVAILABLE	02.05. - 09.05.2026 NOT AVAILABLE	09.05. - 16.05.2026 NOT AVAILABLE	16.05. - 23.05.2026 NOT AVAILABLE
23.05. - 30.05.2026 NOT AVAILABLE	30.05. - 06.06.2026 NOT AVAILABLE	06.06. - 13.06.2026 NOT AVAILABLE	13.06. - 20.06.2026 3.350 € 4.600 €
20.06. - 27.06.2026 NOT AVAILABLE	27.06. - 04.07.2026 3.660 € 4.600 €	04.07. - 11.07.2026 3.660 € 4.600 €	11.07. - 25.07.2026 NOT AVAILABLE
25.07. - 01.08.2026 NOT AVAILABLE	01.08. - 08.08.2026 NOT AVAILABLE	08.08. - 15.08.2026 4.160 € 5.300 €	15.08. - 22.08.2026 NOT AVAILABLE
22.08. - 29.08.2026 3.730 € 4.600 €	29.08. - 05.09.2026 NOT AVAILABLE	05.09. - 12.09.2026 3.680 € 4.600 €	12.09. - 19.09.2026 4.250 €
19.09. - 26.09.2026 NOT AVAILABLE	26.09. - 03.10.2026 NOT AVAILABLE	03.10. - 10.10.2026 2.730 € 2.800 €	10.10. - 17.10.2026 2.730 € 2.800 €
17.10. - 24.10.2026 NOT AVAILABLE	24.10. - 31.10.2026 ON OPTION	31.10. - 07.11.2026 1.970 € 2.800 €	07.11. - 14.11.2026 1.970 € 2.800 €
14.11. - 21.11.2026 1.970 € 2.800 €	21.11. - 28.11.2026 1.970 € 2.800 €	28.11. - 03.04.2027 NOT AVAILABLE	



WEBSITE

www.plujeme.cz



E-MAIL

info@plujeme.cz



PHONE

+420 720 755 085



MOBILE

+420 777 170 276



PLUJEME RÁDI S.R.O.

Dlouhá 730/35, 11000 Praha 1 – Staré Město, Czech Republic

PRICE AND AVAILABILITY

03.04. - 10.04.2027 2.800 €	10.04. - 17.04.2027 2.800 €	17.04. - 24.04.2027 3.300 €	24.04. - 01.05.2027 3.300 €
01.05. - 08.05.2027 3.300 €	08.05. - 15.05.2027 3.300 €	15.05. - 22.05.2027 4.250 €	22.05. - 29.05.2027 4.250 €
29.05. - 05.06.2027 4.250 €	05.06. - 12.06.2027 4.250 €	12.06. - 19.06.2027 4.600 €	19.06. - 26.06.2027 4.600 €
26.06. - 03.07.2027 4.600 €	03.07. - 10.07.2027 4.600 €	10.07. - 17.07.2027 4.600 €	17.07. - 24.07.2027 4.600 €
24.07. - 31.07.2027 5.300 €	31.07. - 07.08.2027 5.300 €		



WEBSITE

www.plujeme.cz



E-MAIL

info@plujeme.cz



PHONE

+420 720 755 085



MOBILE

+420 777 170 276



PLUJEME RÁDI S.R.O.

Dlouhá 730/35, 11000 Praha 1 – Staré Město, Czech Republic

PRICE AND AVAILABILITY

07.08. - 14.08.2027 5.300 €	14.08. - 21.08.2027 4.600 €	21.08. - 28.08.2027 4.600 €	28.08. - 04.09.2027 4.600 €
04.09. - 11.09.2027 4.600 €	11.09. - 18.09.2027 4.250 €	18.09. - 25.09.2027 4.250 €	25.09. - 02.10.2027 3.300 €
02.10. - 09.10.2027 2.800 €	09.10. - 16.10.2027 2.800 €	16.10. - 23.10.2027 2.800 €	23.10. - 30.10.2027 2.800 €
30.10. - 06.11.2027 2.800 €	06.11. - 13.11.2027 2.800 €	13.11. - 20.11.2027 2.800 €	20.11. - 27.11.2027 2.800 €
27.11. - 04.12.2027 2.800 €	04.12. - 11.12.2027 2.800 €	11.12. - 18.12.2027 2.800 €	18.12. - 25.12.2027 2.800 €



WEBSITE

www.plujeme.cz



E-MAIL

info@plujeme.cz



PHONE

+420 720 755 085



MOBILE

+420 777 170 276



PLUJEME RÁDI S.R.O.

Dlouhá 730/35, 11000 Praha 1 – Staré Město, Czech Republic