

HANSE 410

Señorita (2025)

Sailing yacht Hanse 410 Señorita, built in 2025 is anchored in the Dubrovnik, Komolac, ACI Marina Dubrovnik, Dubrovnik region, Croatia. It has 3 cabins, can accommodate 6 + 2 people and has 2 toilets. Bed linen and kitchen equipment are included in the price.

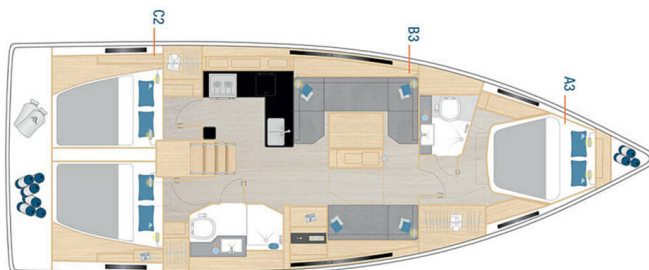

YACHT SPECIFICATIONS

Yacht Base

**Dubrovnik, Komolac, ACI Marina
Dubrovnik, Croatia**

Yacht ID

9735

Brands

Hanse Yachts

Yacht name

Señorita

Production year

2025

Length

41 ft

Cabins

3

Berths

6 + 2

Max Persons

8

WC

2

Engine

1 x 39 HP

Fuel tank

160 l



WEBSITE

www.plujeme.cz



PHONE

+420 720 755 085



MOBILE

+420 777 170 276



E-MAIL

info@plujeme.cz



PLUJEME RÁDI S.R.O.

Dlouhá 730/35, 11000 Praha 1 – Staré Město, Czech Republic

STANDARD YACHT EQUIPMENT

| | |
|-----------------|--|
| Comfort | Bed linen, Cockpit cushions |
| Deck | Bathing platform, Bimini top, Cockpit table, Cockpit/stern, outside shower, Dinghy, Sprayhood, Teak cockpit |
| Entertainment | Outdoor speakers, Radio CD mp3 player + USB |
| Galley | Hot water, Kitchen utensils (Galley equipment, cutlery), Oven, Refrigerator, Stove |
| Interior | Salon |
| Navigation | Autopilot, Bow thruster, GPS chart plotter - cockpit, Nautical charts, Pilot book, Tridata |
| Safety | VHF radio |
| Yacht electrics | Battery charger, Inverter |



WEBSITE

www.plujeme.cz



PHONE

+420 720 755 085



MOBILE

+420 777 170 276



E-MAIL

info@plujeme.cz



PLUJEME RÁDI S.R.O.

Dlouhá 730/35, 11000 Praha 1 – Staré Město, Czech Republic

SERVICES

| SELECTED SERVICES | OBLIGATORY | PAYMENT TYPE | PRICE |
|---|------------|----------------|-----------------|
| Charter pack (Payable at the base) Season: 2026. includes final cleaning, bedlinen, towels - 1 set/person, cooking gas | Yes | per booking | 290,00 € |
| Outboard engine (Payable at the base) Season: 2026. Free of charge for bookings in May | Yes | per booking | 0,00 € |
| Comfort Pack (Payable at the base) Season: 2026. includes outboard 2,5 HP, WiFi routers | No | per week | 105,00 € |
| Deposit insurance (Payable at the base) Season: 2026. + 350 EUR refundable deposit | No | per booking | 240,00 € |
| Early Check in (Payable at the base) Season: 2026. Saturdays between 13hr - 14hr. Early check in can be confirmed only on embarkation day in the charter base. | No | per booking | 200,00 € |
| Flexible booking (Payable now) Season: 2026. allows you to cancel or rebook your charter up to 30 days before the embarkation for no specific reason. You can reschedule your holiday at no cost for unlimited number of times or use a credit note if you are uncertain of new charter dates. With our FLEX PLAN your rebooking costs are completely eliminated while cancellation costs with refund option are reduced to a minimum (15% of the charter fee, min 350 EUR). Extra bonus: free cancellation and FULL REFUND granted in case of closed state borders within 7 days before the embarkation. Notes: FLEX PLAN costs 7% of the final charter price, can be added to booking up to 72hr after booking confirmation and is not available for bookings confirmed within 30 days before the embarkation. | No | per booking | 0,00 € |
| Hostess (Payable now) Season: 2026. + own cabin 50% cancellation fee in case of cancellation up to 15 days prior to embarkation 100% cancellation fee in case of cancellation within 14 days prior to embarkation | No | per day + food | 220,00 € |
| Late check out (Payable at the base) Season: 2026. Saturdays till 10hr Late check-out can be confirmed only on Friday before the embarkation day. | No | per booking | 300,00 € |

| | | | |
|--|----|----------------|-----------------|
| One way fee (Payable at the base) | No | per booking | 480,00 € |
| Season: 2026. Du - Kas / Seg On request only. One-way conditions: one way fee + skipper service obligatory for the whole booking period + mooring fee in port of disembarkation/embarkation | | | |
| Pet on board (Payable at the base) | No | per booking | 150,00 € |
| Season: 2026. Small or medium pet, up to 25 kg | | | |
| Provisioning (Payable now) | No | per booking | 0,00 € |
| Season: 2026. upon request + price of groceries, to be done online | | | |
| Skipper (Payable now) | No | per day + food | 220,00 € |
| Season: 2026. + own cabin 50% cancellation fee in case of cancellation up to 15 days prior to embarkation 100% cancellation fee in case of cancellation within 14 days prior to embarkation | | | |



WEBSITE

www.plujeme.cz



E-MAIL

info@plujeme.cz



PHONE

+420 720 755 085



MOBILE

+420 777 170 276



PLUJEME RÁDI S.R.O.

Dlouhá 730/35, 11000 Praha 1 – Staré Město, Czech Republic

ADDITIONAL EXTRAS

| EXTRA | OBLIGATORY | PAYMENT TYPE | PRICE |
|---|------------|--------------|-----------------|
| Beach towel (Payable at the base) Season: 2026. Payable at the base | No | per piece | 8,00 € |
| Extra bedlinen (Payable at the base) Season: 2026. Payable at the base | No | per set | 15,00 € |
| Floating Water Hammock (Payable at the base) Season: 2026. Partyzone - Payable at the base | No | per week | 220,00 € |
| Gennaker (Payable at the base) Season: 2026. deposit raise + 750 EUR - Payable at the base | No | per week | 200,00 € |
| Kayak (Payable at the base) Season: 2026. 2 pax - Payable at the base | No | per week | 150,00 € |
| Outboard engine 2,5 HP (Payable at the base) Season: 2026. Payable at the base | No | per week | 100,00 € |
| Railing net (Safety net) (Payable at the base) Season: 2026. Rental without mounting - Payable at the base | No | per booking | 20,00 € |
| Snorkeling equipment (Payable at the base) Season: 2026. Payable at the base | No | per week | 10,00 € |
| Stand up paddle (SUP) (Payable at the base) Season: 2026. Payable at the base | No | per week | 120,00 € |
| Towels (Payable at the base) Season: 2026. 2 psc/set (1 x 50x100cm + 1 x 70x140cm) - Payable at the base | No | per set | 8,00 € |
| Wi-Fi Internet (Payable at the base) Season: 2026. Payable at the base | No | per week | 25,00 € |



WEBSITE
www.plujeme.cz



PHONE
+420 720 755 085



MOBILE
+420 777 170 276



E-MAIL
info@plujeme.cz



PLUJEME RÁDI S.R.O.
Dlouhá 730/35, 11000 Praha 1 – Staré Město, Czech Republic

PRICE AND AVAILABILITY

| | | | |
|--|--|--|--|
| 25.04. - 02.05.2026 1.696 € 2.120 € | 02.05. - 09.05.2026 NOT AVAILABLE | 09.05. - 16.05.2026 NOT AVAILABLE | 16.05. - 23.05.2026 2.096 € 2.620 € |
| 23.05. - 30.05.2026 NOT AVAILABLE | 30.05. - 06.06.2026 NOT AVAILABLE | 06.06. - 13.06.2026 2.736 € 3.420 € | 13.06. - 20.06.2026 NOT AVAILABLE |
| 20.06. - 27.06.2026 NOT AVAILABLE | 27.06. - 11.07.2026 NOT AVAILABLE | 11.07. - 18.07.2026 NOT AVAILABLE | 18.07. - 25.07.2026 3.696 € 4.620 € |
| 25.07. - 01.08.2026 NOT AVAILABLE | 01.08. - 08.08.2026 NOT AVAILABLE | 08.08. - 15.08.2026 NOT AVAILABLE | 15.08. - 22.08.2026 ON OPTION |
| 22.08. - 29.08.2026 NOT AVAILABLE | 29.08. - 05.09.2026 NOT AVAILABLE | 05.09. - 12.09.2026 NOT AVAILABLE | 12.09. - 19.09.2026 3.024 € 3.780 € |
| 19.09. - 26.09.2026 NOT AVAILABLE | 26.09. - 03.10.2026 2.464 € 3.080 € | 03.10. - 10.10.2026 NOT AVAILABLE | 10.10. - 17.10.2026 NOT AVAILABLE |
| 17.10. - 24.10.2026 1.616 € 2.020 € | 24.10. - 31.10.2026 1.744 € 2.180 € | 31.10. - 07.11.2026 1.744 € 2.180 € | 07.11. - 14.11.2026 1.744 € 2.180 € |
| 14.11. - 21.11.2026 1.744 € 2.180 € | 21.11. - 28.11.2026 1.744 € 2.180 € | 28.11. - 05.12.2026 1.744 € 2.180 € | |



WEBSITE

www.plujeme.cz



E-MAIL

info@plujeme.cz



PHONE

+420 720 755 085



MOBILE

+420 777 170 276



PLUJEME RÁDI S.R.O.

Dlouhá 730/35, 11000 Praha 1 – Staré Město, Czech Republic

PRICE AND AVAILABILITY

05.12. - 12.12.2026

1.744 € 2.180 €

12.12. - 19.12.2026

1.744 € 2.180 €

19.12. - 26.12.2026

1.744 € 2.180 €



WEBSITE

www.plujeme.cz



E-MAIL

info@plujeme.cz



PHONE

+420 720 755 085



MOBILE

+420 777 170 276



PLUJEME RÁDI S.R.O.

Dlouhá 730/35, 11000 Praha 1 – Staré Město, Czech Republic