

# LAGOON 42

Golden Bride (2024)

Catamaran Lagoon 42 Golden Bride, built in 2024 is anchored in the **Seychelles, Eden Island Marina, Mahé, Seychelles**. It has **4 + 2 cabins**, can accommodate **8 + 2 people** and has **4 toilets**. Bed linen and kitchen equipment are included in the price.

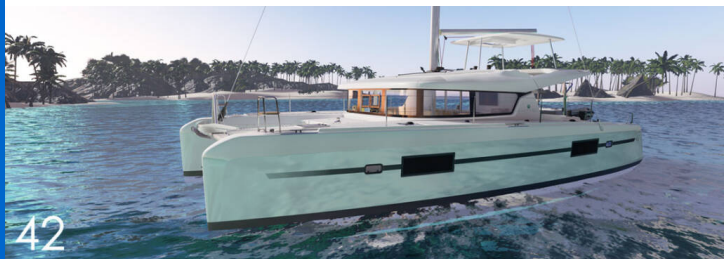

## YACHT SPECIFICATIONS

Yacht Base

**Seychelles, Eden Island Marina, Seychelles**

Yacht ID

**9690**

Brands

**Lagoon**

Yacht name

**Golden Bride**

Production year

**2024**

Length

**42 ft**

Cabins

**4 + 2**

Berths

**8 + 2**

Max Persons

**10**

WC

**4**

Engine

**2 x 56 HP**

Fuel tank

**570 l**



**WEBSITE**

[www.plujeme.cz](http://www.plujeme.cz)



**PHONE**

+420 720 755 085



**MOBILE**

+420 777 170 276



**E-MAIL**

[info@plujeme.cz](mailto:info@plujeme.cz)



**PLUJEME RÁDI S.R.O.**

Dlouhá 730/35, 11000 Praha 1 – Staré Město, Czech Republic

## STANDARD YACHT EQUIPMENT

Comfort	Cockpit cushions
Deck	Anchor with chain, Bilge pump - Mechanic, Boat hook, Bosun's chair (Safe seat) (boatswain's chair), Cockpit fridge, Cockpit table, Cockpit/stern, outside shower, Deck brush, Deck lights, Dinghy with outboard engine, Electric anchor windlass, Fenders, Flybridge, Hard Top Bimini, Jerry cans for fuel, LED outdoor ambiance lights, Mooring Cleats, Mooring ropes, Round/globular fender, Spare anchor (Reserve, Auxiliary anchor), Sponge, Swimming ladder, Water hose, Winch handles
Entertainment	Fusion radio, Mask and snorkel, Sound System
Galley	Blender, Freezer, Gas bottles, Gas cookers, Kitchen utensils (Galley equipment, cutlery), Oven, Refrigerator, Side galley, Water pump
Navigation	Navigation (Nautical) charts and nautical guide, Navigation set, Parallel ruler, Radar reflector, Tridata
Safety	Distress flare box, Emergency tiller, Fire extinguisher, First aid kit, Fog horn, Horseshoe lifebuoy, Life belts (Safety harness), Life jacket (children), Life jackets, Liferaft, Rescue sling (Life sling), Signal flags, Torch, VHF radio
Yacht electrics	220V socket, Air Conditioning, Battery charger, Bilge pump - Electric, Generator, Inverter, Motor hours counter, Service batteries, Shore power cable, Start battery, USB sockets, Watermaker - desalinator, WC pump



**WEBSITE**

[www.plujeme.cz](http://www.plujeme.cz)



**PHONE**

+420 720 755 085



**MOBILE**

+420 777 170 276



**E-MAIL**

[info@plujeme.cz](mailto:info@plujeme.cz)



**PLUJEME RÁDI S.R.O.**

Dlouhá 730/35, 11000 Praha 1 - Staré Město, Czech Republic

## SERVICES

SELECTED SERVICES	OBLIGATORY	PAYMENT TYPE	PRICE
<b>Final cleaning</b> (Payable at the base) <b>Season: 2026.</b>	Yes	per booking	<b>300,00 €</b>
<b>Tourist tax</b> (Payable at the base) <b>Season: 2026.</b>	Yes	per guest/day	<b>7,00 €</b>
<b>Cook</b> (Payable at the base) <b>Season: 2026.</b>	No	per day + food	<b>200,00 €</b>
<b>Fishing guide</b> (Payable at the base) <b>Season: 2026.</b>	No	per day + food	<b>200,00 €</b>
<b>Full board</b> (Payable at the base) <b>Season: 2026.</b> breakfast/lunch/dinner // payment on the base	No	per guest/day	<b>55,00 €</b>
<b>Half board</b> (Payable at the base) <b>Season: 2026.</b> Lunch and dinner	No	per guest/day	<b>45,00 €</b>
<b>Hostess</b> (Payable at the base) <b>Season: 2026.</b>	No	per day + food	<b>200,00 €</b>
<b>Skipper</b> (Payable at the base) <b>Season: 2026.</b>	No	per day + food	<b>200,00 €</b>
<b>Transfer</b> (Payable at the base) <b>Season: 2026.</b> for 8 pax - 2 way	No	round trip	<b>150,00 €</b>
<b>WI-FI Internet connection on boat</b> (Payable at the base) <b>Season: 2026.</b>	No	per week	<b>130,00 €</b>



**WEBSITE**  
www.plujeme.cz



**PHONE**  
+420 720 755 085



**MOBILE**  
+420 777 170 276



**E-MAIL**  
info@plujeme.cz



**PLUJEME RÁDI S.R.O.**  
Dlouhá 730/35, 11000 Praha 1 – Staré Město, Czech Republic

## ADDITIONAL EXTRAS

EXTRA	OBLIGATORY	PAYMENT TYPE	PRICE
<b>Fishing cane/rod</b> (Payable at the base) <b>Season: 2026.</b> Payable at the base	No	per week	<b>100,00 €</b>
<b>Grill/Barbecue/Plancha</b> (Payable at the base) <b>Season: 2026.</b> + a small bag of charcoal - Payable at the base	No	per week	<b>100,00 €</b>
<b>Kayak</b> (Payable at the base) <b>Season: 2026.</b> payment on the base / single/double (100 EUR/week), solid or inflatable - Payable at the base	No	per week	<b>100,00 €</b>
<b>Railing net (Safety net)</b> (Payable at the base) <b>Season: 2026.</b> Payable at the base	No	per week	<b>150,00 €</b>
<b>Stand up paddle (SUP)</b> (Payable at the base) <b>Season: 2026.</b> Payable at the base	No	per week	<b>125,00 €</b>
<b>Underwater scooter</b> (Payable at the base) <b>Season: 2026.</b> Underwater Scooter with mask / payment on the base (100 EUR/ day or 500 EUR per week - Payable at the base	No	per day	<b>100,00 €</b>

**WEBSITE**[www.plujeme.cz](http://www.plujeme.cz)**E-MAIL**[info@plujeme.cz](mailto:info@plujeme.cz)**PHONE**

+420 720 755 085

**MOBILE**

+420 777 170 276

**PLUJEME RÁDI S.R.O.**

Dlouhá 730/35, 11000 Praha 1 – Staré Město, Czech Republic

## PRICE AND AVAILABILITY

13.06. - 20.06.2026 3.575 € 5.500 €	20.06. - 27.06.2026 3.575 € 5.500 €	27.06. - 04.07.2026 4.400 € 5.500 €	04.07. - 11.07.2026 4.400 € 5.500 €
11.07. - 18.07.2026 4.950 € 5.500 €	18.07. - 25.07.2026 4.950 € 5.500 €	25.07. - 01.08.2026 4.950 € 5.500 €	01.08. - 08.08.2026 4.950 € 5.500 €
08.08. - 15.08.2026 4.950 € 5.500 €	15.08. - 22.08.2026 4.950 € 5.500 €	22.08. - 29.08.2026 NOT AVAILABLE	29.08. - 05.09.2026 4.950 € 5.500 €
05.09. - 12.09.2026 4.950 € 5.500 €	12.09. - 19.09.2026 4.950 € 5.500 €	19.09. - 26.09.2026 6.300 € 7.000 €	26.09. - 03.10.2026 6.300 € 7.000 €
03.10. - 17.10.2026 NOT AVAILABLE	17.10. - 24.10.2026 6.300 € 7.000 €	24.10. - 07.11.2026 NOT AVAILABLE	07.11. - 14.11.2026 ON OPTION
14.11. - 21.11.2026 NOT AVAILABLE	21.11. - 28.11.2026 NOT AVAILABLE	28.11. - 05.12.2026 6.300 € 7.000 €	05.12. - 12.12.2026 5.400 € 6.000 €
12.12. - 19.12.2026 5.400 € 6.000 €	19.12. - 26.12.2026 8.028 € 8.920 €	26.12. - 02.01.2027 ON OPTION	02.01. - 09.01.2027 6.547 € 7.274 €
09.01. - 16.01.2027 6.300 € 7.000 €	16.01. - 23.01.2027 6.300 € 7.000 €	23.01. - 30.01.2027 6.300 € 7.000 €	30.01. - 06.02.2027 6.300 € 7.000 €



WEBSITE

[www.plujeme.cz](http://www.plujeme.cz)



E-MAIL

[info@plujeme.cz](mailto:info@plujeme.cz)



PHONE

+420 720 755 085



MOBILE

+420 777 170 276



PLUJEME RÁDI S.R.O.

Dlouhá 730/35, 11000 Praha 1 – Staré Město, Czech Republic

## PRICE AND AVAILABILITY

06.02. - 13.02.2027 6.300 € 7.000 €	13.02. - 20.02.2027 6.300 € 7.000 €	20.02. - 27.02.2027 6.300 € 7.000 €	27.02. - 06.03.2027 6.300 € 7.000 €
06.03. - 13.03.2027 6.300 € 7.000 €	13.03. - 20.03.2027 6.300 € 7.000 €	20.03. - 27.03.2027 6.300 € 7.000 €	27.03. - 03.04.2027 6.300 € 7.000 €
03.04. - 10.04.2027 6.300 € 7.000 €	10.04. - 17.04.2027 6.300 € 7.000 €	17.04. - 24.04.2027 6.300 € 7.000 €	24.04. - 01.05.2027 6.300 € 7.000 €
01.05. - 08.05.2027 4.950 € 5.500 €	08.05. - 15.05.2027 4.950 € 5.500 €	15.05. - 22.05.2027 4.950 € 5.500 €	22.05. - 29.05.2027 4.950 € 5.500 €
29.05. - 05.06.2027 4.950 € 5.500 €	05.06. - 12.06.2027 4.950 € 5.500 €	12.06. - 19.06.2027 4.950 € 5.500 €	19.06. - 26.06.2027 4.950 € 5.500 €
26.06. - 03.07.2027 4.950 € 5.500 €	03.07. - 10.07.2027 4.950 € 5.500 €	10.07. - 17.07.2027 4.950 € 5.500 €	17.07. - 31.07.2027 NOT AVAILABLE
31.07. - 07.08.2027 4.950 € 5.500 €	07.08. - 14.08.2027 4.950 € 5.500 €	14.08. - 21.08.2027 4.950 € 5.500 €	21.08. - 28.08.2027 4.950 € 5.500 €
28.08. - 04.09.2027 4.950 € 5.500 €	04.09. - 11.09.2027 4.950 € 5.500 €	11.09. - 18.09.2027 4.950 € 5.500 €	18.09. - 25.09.2027 6.300 € 7.000 €
25.09. - 02.10.2027 6.300 € 7.000 €			



WEBSITE

[www.plujeme.cz](http://www.plujeme.cz)



E-MAIL

[info@plujeme.cz](mailto:info@plujeme.cz)



PHONE

+420 720 755 085



MOBILE

+420 777 170 276



PLUJEME RÁDI S.R.O.

Dlouhá 730/35, 11000 Praha 1 – Staré Město, Czech Republic

## PRICE AND AVAILABILITY

02.10. - 09.10.2027 <b>6.300 €</b> 7.000 €	09.10. - 16.10.2027 <b>6.300 €</b> 7.000 €	16.10. - 23.10.2027 <b>6.300 €</b> 7.000 €	23.10. - 30.10.2027 <b>6.300 €</b> 7.000 €
30.10. - 06.11.2027 <b>6.300 €</b> 7.000 €	06.11. - 13.11.2027 <b>6.300 €</b> 7.000 €	13.11. - 20.11.2027 <b>6.300 €</b> 7.000 €	20.11. - 27.11.2027 <b>6.300 €</b> 7.000 €
27.11. - 04.12.2027 <b>6.300 €</b> 7.000 €	04.12. - 11.12.2027 <b>5.400 €</b> 6.000 €	11.12. - 18.12.2027 <b>5.400 €</b> 6.000 €	18.12. - 25.12.2027 <b>8.028 €</b> 8.920 €



### WEBSITE

[www.plujeme.cz](http://www.plujeme.cz)



### E-MAIL

[info@plujeme.cz](mailto:info@plujeme.cz)



### PHONE

+420 720 755 085



### MOBILE

+420 777 170 276



### PLUJEME RÁDI S.R.O.

Dlouhá 730/35, 11000 Praha 1 – Staré Město, Czech Republic