

OCEANIS 51.1

My Way (2022)

Sailing yacht Oceanis 51.1 My Way, built in 2022 is anchored in the Athens, Alimos marina, Athens

area/Saronic/Peloponese, Greece. It has 4 + 1 cabins, can accommodate 8 + 2 + 1 people and has 4 + 1 toilets. Bed linen and kitchen equipment are included in the price.

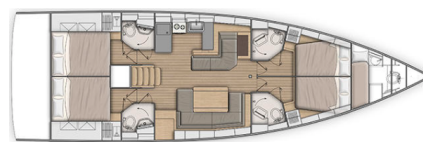

YACHT SPECIFICATIONS

Yacht Base

Athens, Alimos marina, Greece

Yacht ID

9595

Brands

Beneteau

Yacht name

My Way

Production year

2022

Length

52 ft

Cabins

4 + 1

Berths

8 + 2 + 1

Max Persons

11

WC

4 + 1

Engine

1 x 0 HP

Fuel tank

440 l



WEBSITE

www.plujeme.cz



PHONE

+420 720 755 085



MOBILE

+420 777 170 276



E-MAIL

info@plujeme.cz



PLUJEME RÁDI S.R.O.

Dlouhá 730/35, 11000 Praha 1 – Staré Město, Czech Republic

STANDARD YACHT EQUIPMENT

Comfort	Cockpit cushions
Deck	Bimini top, Cockpit table, Cockpit/stern, outside shower, Dinghy, Electric anchor windlass, Gangway, Outboard engine, Sprayhood, Swimming ladder
Entertainment	Snorkeling equipment
Galley	Kitchen utensils (Galley equipment, cutlery), Oven, Refrigerator
Navigation	Autopilot, Bow thruster, GPS chart plotter
Sails	Electric winch, Self tacking jib
Yacht electrics	Air Conditioning, Battery charger, Generator, Inverter, Plug 220V, 12 V



WEBSITE

www.plujeme.cz



E-MAIL

info@plujeme.cz



PHONE

+420 720 755 085



MOBILE

+420 777 170 276



PLUJEME RÁDI S.R.O.

Dlouhá 730/35, 11000 Praha 1 – Staré Město, Czech Republic

SERVICES

SELECTED SERVICES	OBLIGATORY	PAYMENT TYPE	PRICE
Damage waiver (Payable at the base) Season: 2026. +500EUR refundable deposit	Yes	per day	60,00 €
Service Pack (Payable at the base) Season: 2026. Final Cleaning, Bed linen, towels, blankets, one set /cabin/week, Dinghy with outboard engine, mooring fees for the first and last night in port	Yes	per booking	400,00 €
Cook (Payable at the base) Season: 2026. require their own cabin	No	per day + food	230,00 €
Crew change (Payable at the base) Season: 2026. Crew change fees (only in one of our bases. Included: Formalities (contract, crew list etc), 1 day mooring fees). Not included: Cleaning of the yacht and laundry)	No	per booking	200,00 €
Damage waiver (Payable at the base) Season: 2026. Applies only when skipper is choosen	No	per booking	350,00 €
Early Check in (Payable at the base) Season: 2026.	No	per booking	150,00 €
Hostess (Payable at the base) Season: 2026. require their own cabin	No	per day + food	190,00 €
Mooring fee (Payable at the base) Season: 2026. except for the first and last night in home port	No	per booking	0,00 €
Pet on board (Payable at the base) Season: 2026. Extra cleaning fee	No	per booking	0,00 €
Provisioning (Payable at the base) Season: 2026. can be pre-ordered without any extra service fee *Please request for our provisioning list form	No	per booking	0,00 €
Skipper (Payable at the base) Season: 2026. require their own cabin	No	per day + food	210,00 €
Transfer (Payable at the base) Season: 2026. can be arranged upon request	No	one-way	0,00 €

WI-FI Internet connection on boat (Payable at the base)

No

per week

100,00 €

Season: 2026. UNLIMITED/ week up to 10 users



WEBSITE

www.plujeme.cz



E-MAIL

info@plujeme.cz



PHONE

+420 720 755 085



MOBILE

+420 777 170 276



PLUJEME RÁDI S.R.O.

Dlouhá 730/35, 11000 Praha 1 – Staré Město, Czech Republic

ADDITIONAL EXTRAS

EXTRA	OBLIGATORY	PAYMENT TYPE	PRICE
Extra bedlinen <i>(Payable at the base)</i> Season: 2026. <i>Payable at the base</i>	No	per person	10,00 €
Fishing equipment <i>(Payable at the base)</i> Season: 2026. <i>Payable at the base</i>	No	per week	150,00 €
Paddle board <i>(Payable at the base)</i> Season: 2026. <i>Payable at the base</i>	No	per week	150,00 €
Railing net (Safety net) <i>(Payable at the base)</i> Season: 2026. <i>Installed - Payable at the base</i>	No	per booking	250,00 €

**WEBSITE**www.plujeme.cz**E-MAIL**info@plujeme.cz**PHONE**

+420 720 755 085

**MOBILE**

+420 777 170 276

**PLUJEME RÁDI S.R.O.**

Dlouhá 730/35, 11000 Praha 1 – Staré Město, Czech Republic

PRICE AND AVAILABILITY

25.04. - 02.05.2026 3.600 € 4.500 €	02.05. - 09.05.2026 3.600 € 4.500 €	09.05. - 16.05.2026 4.040 € 5.050 €	16.05. - 23.05.2026 4.040 € 5.050 €
23.05. - 30.05.2026 NOT AVAILABLE	30.05. - 06.06.2026 NOT AVAILABLE	06.06. - 13.06.2026 NOT AVAILABLE	13.06. - 20.06.2026 4.760 € 5.600 €
20.06. - 27.06.2026 5.568 € 6.550 €	27.06. - 04.07.2026 NOT AVAILABLE	04.07. - 11.07.2026 NOT AVAILABLE	11.07. - 18.07.2026 5.568 € 6.550 €
18.07. - 25.07.2026 5.568 € 6.550 €	25.07. - 08.08.2026 NOT AVAILABLE	08.08. - 15.08.2026 NOT AVAILABLE	15.08. - 22.08.2026 6.503 € 7.650 €
22.08. - 29.08.2026 5.440 € 6.400 €	29.08. - 05.09.2026 5.440 € 6.400 €	05.09. - 19.09.2026 NOT AVAILABLE	19.09. - 26.09.2026 NOT AVAILABLE
26.09. - 10.10.2026 NOT AVAILABLE	10.10. - 17.10.2026 4.675 € 5.500 €	17.10. - 24.10.2026 3.485 € 4.100 €	24.10. - 31.10.2026 3.485 € 4.100 €
31.10. - 07.11.2026 3.485 € 4.100 €	08.11. - 31.12.2026 NOT AVAILABLE		



WEBSITE

www.plujeme.cz



E-MAIL

info@plujeme.cz



PHONE

+420 720 755 085



MOBILE

+420 777 170 276



PLUJEME RÁDI S.R.O.

Dlouhá 730/35, 11000 Praha 1 – Staré Město, Czech Republic