

BALI 4.4

Bali 4.4 (2023)

Catamaran Bali 4.4 Bali 4.4, built in **2023** is anchored in the **Lefkas main port, Ionian Islands, Greece**. It has **4 + 1 cabins**, can accommodate **8 + 1 + 1 people** and has **4 + 1 toilets**. Bed linen and kitchen equipment are included in the price.

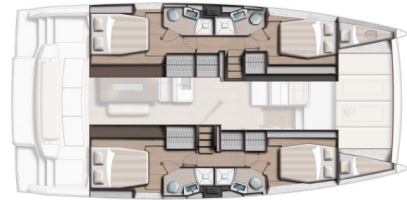

YACHT SPECIFICATIONS

Yacht Base

Lefkas main port, Greece

Yacht ID

9592

Brands

Catana

Yacht name

Bali 4.4

Production year

2023

Length

44 ft

Cabins

4 + 1

Berths

8 + 1 + 1

WC

4 + 1

Engine

2 x 57 HP

Fuel tank

800 l



WEBSITE

www.plujeme.cz



PHONE

+420 720 755 085



MOBILE

+420 777 170 276



E-MAIL

info@plujeme.cz



PLUJEME RÁDI S.R.O.

Dlouhá 730/35, 11000 Praha 1 – Staré Město, Czech Republic

STANDARD YACHT EQUIPMENT

Entertainment

FUSION sound system

Interior

Electric fans in cabins

Navigation

GPS chart plotter, GPS chart plotter - cockpit

Yacht electrics

Air Conditioning, Generator, Inverter, Solar panels



WEBSITE

www.plujeme.cz



E-MAIL

info@plujeme.cz



PHONE

+420 720 755 085



MOBILE

+420 777 170 276



PLUJEME RÁDI S.R.O.

Dlouhá 730/35, 11000 Praha 1 – Staré Město, Czech Republic

SERVICES

SELECTED SERVICES	OBLIGATORY	PAYMENT TYPE	PRICE
<p>Starter pack (Payable at the base)</p> <p>Season: 2026. Includes: end cleaning, first fill of outboard, spare bottle gas, 1 set of linen and towels/person/booking, first and last night in marina/port paid in cash at the base</p>	Yes	per booking	370,00 €
<p>Crew change (Payable at the base)</p> <p>Season: 2026. In case of mandatory formalities -contract termination- due to crew change, available only in our charter bases, includes paperwork & formalities. Yacht cleaning & laundry not included</p>	No	per crew change	100,00 €
<p>Early Check in (Payable at the base)</p> <p>Season: 2026. Access to the yacht by 14:30, to be confirmed at the base. In the event of delay beyond our control refunds will be made. El Yachting reserves the right to deny early access during high season.</p>	No	per booking	150,00 €
<p>Hostess/Cook (Payable at the base)</p> <p>Season: 2026. payable on the spot upon embarkation; require their own cabin</p>	No	per week + food	1.190,00 €
<p>Provisioning (Payable at the base)</p> <p>Season: 2026.</p>	No	per booking	20,00 €
<p>Skipper (Payable at the base)</p> <p>Season: 2026. payable on the spot upon embarkation; require their own cabin</p>	No	per week + food	1.470,00 €
<p>Start Kit Basic (Payable at the base)</p> <p>Season: 2026. includes: 1 washing up liquid -1 sponge, 1 wettex, 1 kitchen roll, 1 roll of rubbish bags, 1 salt, 1 pepper, 4 toilet rolls, 1 roll of small rubbish bags, 1 cleaning spray, 2 liquid hand soaps</p>	No	per pack	45,00 €
<p>Transfer (Payable at the base)</p> <p>Season: 2026. Taxi (up to 4 pax) Preveza Airport - Lefkas</p>	No	one-way	50,00 €
<p>Transfer 1 (Payable at the base)</p> <p>Season: 2026. Mini-Van (up to 8 pax) Preveza Airport - Lefkas</p>	No	one-way	100,00 €
<p>Transfer 2 (Payable at the base)</p> <p>Season: 2026. Mini-Bus (up to 16 pax) Preveza Airport - Lefkas</p>	No	one-way	150,00 €

WI-FI Internet connection on boat (Payable at the base)

No

per week

60,00 €

Season: 2026. up to 5 devices and 5GB internet



WEBSITE

www.plujeme.cz



E-MAIL

info@plujeme.cz



PHONE

+420 720 755 085



MOBILE

+420 777 170 276



PLUJEME RÁDI S.R.O.

Dlouhá 730/35, 11000 Praha 1 – Staré Město, Czech Republic

ADDITIONAL EXTRAS

EXTRA	OBLIGATORY	PAYMENT TYPE	PRICE
Canoe (Payable at the base) Season: 2026. 1 seater blow up (limited supply) - Payable at the base	No	per week	150,00 €
Extra bedlinen (Payable at the base) Season: 2026. set includes 1 pillow case, 2 sheets, 1 bath towel - Payable at the base	No	per set	10,00 €
Fishing equipment (Payable at the base) Season: 2026. fishing rod and reel - Payable at the base	No	per week	50,00 €
Hammock (Payable at the base) Season: 2026. Payable at the base	No	per week	20,00 €
Life jacket (children) (Payable at the base) Season: 2026. Payable at the base	No	per piece	10,00 €
Railing net (Safety net) (Payable at the base) Season: 2026. installed - Payable at the base	No	per booking	200,00 €
Self inflating life vest (Payable at the base) Season: 2026. Payable at the base	No	per week	20,00 €
Stand up paddle (SUP) (Payable at the base) Season: 2026. Payable at the base	No	per week	100,00 €



WEBSITE

www.plujeme.cz



E-MAIL

info@plujeme.cz



PHONE

+420 720 755 085



MOBILE

+420 777 170 276



PLUJEME RÁDI S.R.O.

Dlouhá 730/35, 11000 Praha 1 – Staré Město, Czech Republic

PRICE AND AVAILABILITY

25.04. - 02.05.2026 5.805 € 6.450 €	02.05. - 09.05.2026 5.483 € 6.450 €	09.05. - 16.05.2026 5.483 € 6.450 €	16.05. - 23.05.2026 5.525 € 6.500 €
23.05. - 30.05.2026 5.525 € 6.500 €	30.05. - 13.06.2026 NOT AVAILABLE	13.06. - 20.06.2026 NOT AVAILABLE	20.06. - 27.06.2026 NOT AVAILABLE
27.06. - 04.07.2026 NOT AVAILABLE	04.07. - 11.07.2026 NOT AVAILABLE	11.07. - 18.07.2026 NOT AVAILABLE	18.07. - 25.07.2026 8.820 € 9.800 €
25.07. - 01.08.2026 NOT AVAILABLE	01.08. - 08.08.2026 NOT AVAILABLE	08.08. - 15.08.2026 ON OPTION	15.08. - 22.08.2026 NOT AVAILABLE
22.08. - 29.08.2026 NOT AVAILABLE	29.08. - 05.09.2026 NOT AVAILABLE	05.09. - 12.09.2026 NOT AVAILABLE	12.09. - 19.09.2026 NOT AVAILABLE
19.09. - 26.09.2026 NOT AVAILABLE	26.09. - 03.10.2026 NOT AVAILABLE	03.10. - 10.10.2026 NOT AVAILABLE	10.10. - 17.10.2026 5.850 € 6.500 €
17.10. - 24.10.2026 5.670 € 6.300 €	24.10. - 31.10.2026 5.670 € 6.300 €	31.10. - 07.11.2026 5.670 € 6.300 €	07.11. - 14.11.2026 5.670 € 6.300 €
14.11. - 21.11.2026 5.670 € 6.300 €	21.11. - 28.11.2026 5.670 € 6.300 €	28.11. - 05.12.2026 6.300 €	



WEBSITE

www.plujeme.cz



E-MAIL

info@plujeme.cz



PHONE

+420 720 755 085



MOBILE

+420 777 170 276



PLUJEME RÁDI S.R.O.

Dlouhá 730/35, 11000 Praha 1 – Staré Město, Czech Republic

PRICE AND AVAILABILITY

05.12. - 12.12.2026

6.300 €

12.12. - 19.12.2026

6.300 €

19.12. - 26.12.2026

6.300 €



WEBSITE

www.plujeme.cz



E-MAIL

info@plujeme.cz



PHONE

+420 720 755 085



MOBILE

+420 777 170 276



PLUJEME RÁDI S.R.O.

Dlouhá 730/35, 11000 Praha 1 – Staré Město, Czech Republic