

OCEANIS 46.1

Contessa di Mare (2023)

Sailing yacht **Oceanis 46.1 Contessa di Mare**, built in **2023** is anchored in the **Pula, ACI Marina Pomer, Istra, Croatia**. It has **4 cabins**, can accommodate **8 + 2 people** and has **4 toilets**. Bed linen and kitchen equipment are included in the price.

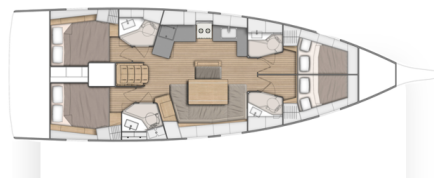

YACHT SPECIFICATIONS

Yacht Base

Pula, ACI Marina Pomer, Croatia

Yacht ID

9515

Brands

Beneteau

Yacht name

Contessa di Mare

Production year

2023

Length

48 ft

Cabins

4

Berths

8 + 2

WC

4

Engine

1 x 80 HP

Fuel tank

200 l



WEBSITE

www.plujeme.cz



PHONE

+420 720 755 085



MOBILE

+420 777 170 276



E-MAIL

info@plujeme.cz



PLUJEME RÁDI S.R.O.

Dlouhá 730/35, 11000 Praha 1 – Staré Město, Czech Republic

STANDARD YACHT EQUIPMENT

Comfort	Cockpit cushions
Deck	Anchor line, Anchor swivel, Bimini top, Black ball, Black conus, Bosun's chair (Safe seat) (boatswain's chair), Cockpit table with light, Cockpit/stern, outside shower, Dinghy, Dinghy (byboat) pump, Electric anchor windlass, Fenders, Gangway, Hawser, Main anchor, Mooring ropes, Plastic bucket, Repair box for dinghy, Round/globular fender, Spare anchor (Reserve, Auxiliary anchor), Sprayhood, Spring line, Water hose
Entertainment	Outdoor speakers, Radio
Galley	Gas bottles, Hot water, Ice box, Kitchen utensils (Galley equipment, cutlery), Refrigerator
Interior	Barometer, Clock, Lowerable salon table
Navigation	AIS, Autopilot, Bow thruster, Bretonplotter, GPS, GPS chart plotter, Hand bearing compass, Harbour guides, Logge/Lot/Speed/Wind, Navigation (Nautical) charts and nautical guide, Navigation set, Parallel ruler, Radar reflector, Spyglass with bearing compass, Tridata, Windex
Safety	Distress signals, Fire extinguisher, First aid kit, Flashlight, Fog horn, Inflatable life raft, Life belts (Safety harness), Life buoy + Flashing light, Life jackets, Liferaft, Set of tools, VHF radio
Yacht electrics	Battery charger, Heating, Inverter, Shore connection 220 V, USB sockets



WEBSITE

www.plujeme.cz



PHONE

+420 720 755 085



MOBILE

+420 777 170 276



E-MAIL

info@plujeme.cz



PLUJEME RÁDI S.R.O.

Dlouhá 730/35, 11000 Praha 1 – Staré Město, Czech Republic

SERVICES

SELECTED SERVICES	OBLIGATORY	PAYMENT TYPE	PRICE
Electric outboard engine (Payable at the base) Season: 2026.	Yes	per booking	0,00 €
Transit log (Payable at the base) Season: 2026. Standard: cleaning, check in, diving, check out, WIFI unlimited, bedlinen, towel set for crew (1 x small + 1 x big), garbage bags (1 x toilet + 1 x kitchen), gas bottles, tanks filled with drinking water, electric outboard engine, fuel for outboard engine, toilet basics (1 x paper + 1 x soap), kitchen basics (sponge, wet rag, 2 x kitchen towel, detergent, salt, pepper), Exclusive SMS warning and forecast, ACI Pomer berth, live tracking and route export, 1 x SUP.	Yes	per booking	358,00 €
Deposit insurance (Payable at the base) Season: 2026. + € 250 (deposit for EU citizens) for deposit of 2.500 €	No	per booking	320,00 €
Early Check in (Payable at the base) Season: 2026. max. 3 yachts	No	per booking	330,00 €
Extra cleaning (Payable at the base) Season: 2026. + change of bed linen, on request	No	per service	213,50 €
Extra fee for Italy (Payable at the base) Season: 2026. Sail to Italy Package Inkl. Flags, sea maps, insurances - deposit 50€ Wi-Fi not available in Italy and Slovenia.	No	per week	100,00 €
Hostess (Payable at the base) Season: 2026. Own cabin	No	per day + food	200,00 €
Late return to base (Payable at the base) Season: 2026. +Diver, until 7 pm	No	per booking	200,00 €
Late return to base (Payable at the base) Season: 2026. +Diver, after 7 pm	No	per booking	400,00 €
Parking (Payable at the base) Season: 2026. 1 Car	No	per week	70,00 €
Parking (Payable at the base) Season: 2026. 2 Cars	No	per week	125,00 €

Parking (Payable at the base) Season: 2026. 3 cars	No	per week	165,00 €
Skipper (Payable at the base) Season: 2026. Own cabin	No	per day + food	200,00 €
Surcharge for missing fuel, + Fuel price (Payable at the base) Season: 2026.	No	per service	50,00 €
Upgrade Permit EXCLUSIVE (Payable at the base) Season: 2026. Exclusive: Transit log Standard + Parking (max. 3 cars), 2 x SUPs, BBQ - Magma Gasgrill, Wineglasses, Istrian white wine (2 Bottles), Istrian Native Olive Oil.	No	per booking	229,00 €



WEBSITE
www.plujeme.cz



E-MAIL
info@plujeme.cz



PHONE
+420 720 755 085



PLUJEME RÁDI S.R.O.
Dlouhá 730/35, 11000 Praha 1 – Staré Město, Czech Republic



MOBILE
+420 777 170 276

ADDITIONAL EXTRAS

EXTRA	OBLIGATORY	PAYMENT TYPE	PRICE
Extra bedlinen (Payable at the base) Season: 2026. Payable at the base	No	per set	10,00 €
Gennaker (Payable at the base) Season: 2026. on request; +1000EUR deposit - Payable at the base	No	per booking	250,00 €
Grill/Barbecue/Plancha (Payable at the base) Season: 2026. GAS - Payable at the base	No	per week	130,00 €
Life jacket (children) (Payable at the base) Season: 2026. FREE -deposit 50€ - Payable at the base	No	per booking	0,00 €
Stand up paddle (SUP) (Payable at the base) Season: 2026. Payable at the base	No	per week	100,00 €
Towels (Payable at the base) Season: 2026. Payable at the base	No	per set	15,00 €
Towing air tube (Payable at the base) Season: 2026. Payable at the base	No	per week	80,00 €



WEBSITE
www.plujeme.cz



E-MAIL
info@plujeme.cz



PHONE
+420 720 755 085



PLUJEME RÁDI S.R.O.
Dlouhá 730/35, 11000 Praha 1 – Staré Město, Czech Republic



MOBILE
+420 777 170 276

PRICE AND AVAILABILITY

27.06. - 04.07.2026 NOT AVAILABLE	04.07. - 11.07.2026 NOT AVAILABLE	11.07. - 16.07.2026 NOT AVAILABLE	16.07. - 18.07.2026 NOT AVAILABLE
18.07. - 01.08.2026 NOT AVAILABLE	01.08. - 08.08.2026 NOT AVAILABLE	08.08. - 22.08.2026 NOT AVAILABLE	22.08. - 29.08.2026 NOT AVAILABLE
29.08. - 05.09.2026 NOT AVAILABLE	05.09. - 12.09.2026 NOT AVAILABLE	12.09. - 19.09.2026 NOT AVAILABLE	19.09. - 26.09.2026 NOT AVAILABLE
26.09. - 03.10.2026 NOT AVAILABLE	03.10. - 10.10.2026 2.189 € 2.781 €	10.10. - 05.03.2027 NOT AVAILABLE	



WEBSITE

www.plujeme.cz



E-MAIL

info@plujeme.cz



PHONE

+420 720 755 085



MOBILE

+420 777 170 276



PLUJEME RÁDI S.R.O.

Dlouhá 730/35, 11000 Praha 1 – Staré Město, Czech Republic

PRICE AND AVAILABILITY

06.03. - 13.03.2027 1.582 € 1.978 €	13.03. - 20.03.2027 1.582 € 1.978 €	20.03. - 27.03.2027 1.582 € 1.978 €	27.03. - 03.04.2027 1.582 € 1.978 €
03.04. - 10.04.2027 1.582 € 1.978 €	10.04. - 17.04.2027 1.813 € 2.266 €	17.04. - 24.04.2027 1.813 € 2.266 €	24.04. - 01.05.2027 2.142 € 2.678 €
01.05. - 08.05.2027 2.142 € 2.678 €	08.05. - 15.05.2027 2.142 € 2.678 €	15.05. - 22.05.2027 2.390 € 2.987 €	22.05. - 29.05.2027 2.802 € 3.502 €
29.05. - 05.06.2027 2.966 € 3.708 €	05.06. - 12.06.2027 3.461 € 4.326 €	12.06. - 19.06.2027 3.461 € 4.326 €	19.06. - 26.06.2027 3.461 € 4.326 €
26.06. - 03.07.2027 3.461 € 4.326 €	03.07. - 10.07.2027 3.461 € 4.326 €	10.07. - 17.07.2027 3.461 € 4.326 €	17.07. - 24.07.2027 3.461 € 4.326 €
24.07. - 31.07.2027 3.461 € 4.326 €	31.07. - 07.08.2027 3.461 € 4.326 €	07.08. - 14.08.2027 3.461 € 4.326 €	14.08. - 21.08.2027 3.461 € 4.326 €
21.08. - 28.08.2027 3.461 € 4.326 €	28.08. - 04.09.2027 3.378 € 4.223 €	04.09. - 11.09.2027 3.214 € 4.017 €	11.09. - 18.09.2027 3.049 € 3.811 €
18.09. - 25.09.2027 2.884 € 3.605 €	25.09. - 02.10.2027 2.554 € 3.193 €		



WEBSITE

www.plujeme.cz



E-MAIL

info@plujeme.cz



PHONE

+420 720 755 085



MOBILE

+420 777 170 276



PLUJEME RÁDI S.R.O.

Dlouhá 730/35, 11000 Praha 1 – Staré Město, Czech Republic

PRICE AND AVAILABILITY

02.10. - 09.10.2027 2.225 € 2.781 €	09.10. - 16.10.2027 2.142 € 2.678 €	16.10. - 23.10.2027 1.483 € 1.854 €	23.10. - 30.10.2027 1.483 € 1.854 €
30.10. - 06.11.2027 1.483 € 1.854 €	06.11. - 13.11.2027 1.483 € 1.854 €	13.11. - 20.11.2027 1.483 € 1.854 €	20.11. - 27.11.2027 1.483 € 1.854 €
27.11. - 04.12.2027 1.483 € 1.854 €	04.12. - 11.12.2027 1.483 € 1.854 €	11.12. - 18.12.2027 1.483 € 1.854 €	18.12. - 25.12.2027 1.483 € 1.854 €



WEBSITE

www.plujeme.cz



E-MAIL

info@plujeme.cz



PHONE

+420 720 755 085



MOBILE

+420 777 170 276



PLUJEME RÁDI S.R.O.

Dlouhá 730/35, 11000 Praha 1 – Staré Město, Czech Republic