

# OCEANIS 37.1

Katja (2025)

Sailing yacht Oceanis 37.1 Katja, built in 2025 is anchored in the Marina Kornati, Biograd, Zadar region, Croatia. It has 3 cabins, can accommodate 6 + 2 people and has 2 toilets. Bed linen and kitchen equipment are included in the price.

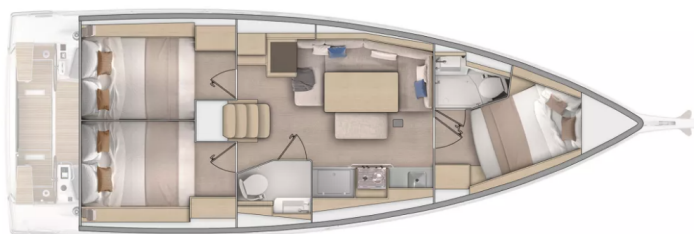

## YACHT SPECIFICATIONS

Yacht Base

**Marina Kornati, Biograd, Croatia**

Yacht ID

**9451**

Brands

**Beneteau**

Yacht name

**Katja**

Production year

**2025**

Length

**39 ft**

Cabins

**3**

Berths

**6 + 2**

WC

**2**

Engine

**1 x 40 HP**

Fuel tank

**130 l**



**WEBSITE**

[www.plujeme.cz](http://www.plujeme.cz)



**PHONE**

+420 720 755 085



**MOBILE**

+420 777 170 276



**E-MAIL**

[info@plujeme.cz](mailto:info@plujeme.cz)



**PLUJEME RÁDI S.R.O.**

Dlouhá 730/35, 11000 Praha 1 – Staré Město, Czech Republic

## STANDARD YACHT EQUIPMENT

|                 |  |
|-----------------|--|
| Additional      | <b>Flag</b>  |
| Comfort         | <b>Cockpit cushions</b>  |
| Deck            | <b>Anchor light, Anchor with chain, Bathing platform, Bilge pump - Mechanic, Bimini top, Boat hook, Bosun's chair (Safe seat) (boatswain's chair), Cockpit table, Cockpit/stern, outside shower, Deck brush, Dinghy, Electric anchor windlass, Fenders, Gangway, Impeller, Mooring ropes, Plastic bucket, Sailor's knife, Spring line, Swimming ladder, Teak cockpit</b> |
| Entertainment   | <b>Indoor speakers, Outdoor speakers, Radio, TV</b>  |
| Galley          | <b>Hot water, Kitchen utensils (Galley equipment, cutlery), Oven, Pressurized water system, Refrigerator, Sink, Stove</b>  |
| Interior        | <b>Barometer, Clock, Electric fans in cabins, Lowerable salon table, Safe</b>  |
| Navigation      | <b>AIS, Autopilot, Binoculars, Bow thruster, Composite steering wheels, Depthsounder, GPS chart plotter - cockpit, Hand bearing compass, LED Navigation lights, Navigation (Nautical) charts and nautical guide, Navigation/position Lights, Triangles, Wind instrument/Anemometer, Windex</b>   |
| Safety          | <b>Automatic Inflatable Life Jacket, Black Water Tank, Distress signals, Emergency tiller, Fire axe, Fire extinguisher, First aid kit, Flashlight, Fog horn, Guard rail, Horseshoe lifebuoy, Lifelines, Liferaft, Set of tools, VHF radio, Wire (shroud) cutter</b>  |
| Sails           | <b>Gennaker-device, Winch</b>  |
| Yacht electrics | <b>12V Socket, 220V socket, Adapter, Battery charger, Bilge pump - Electric, Converter 220V/12V, Heating, Inverter, Shore connection 220 V, Shore power cable, Solar panels, USB sockets</b>   |



**WEBSITE**  
[www.plujeme.cz](http://www.plujeme.cz)



**PHONE**  
+420 720 755 085



**MOBILE**  
+420 777 170 276



**E-MAIL**  
[info@plujeme.cz](mailto:info@plujeme.cz)



**PLUJEME RÁDI S.R.O.**  
Dlouhá 730/35, 11000 Praha 1 - Staré Město, Czech Republic

## SERVICES

| SELECTED SERVICES  | OBLIGATORY | PAYMENT TYPE   | PRICE           |
|--|------------|----------------|-----------------|
| <b>Basic package for accommodation</b> (Payable at the base)<br><b>Season: 2026.</b> Cash or with credit card (VISA, MASTER) Cleaning, made Bed linen, Permit, WiFi, Cooking gas, Rinsing set, Dinghy  | Yes        | per booking    | <b>250,00 €</b> |
| <b>Deposit insurance</b> (Payable at the base)<br><b>Season: 2026.</b> Cash / The customers still have to deposit 100,00 €. If there is no damage, they get the 100,00 € back. We do not require any prior information. The customer can take out insurance at check-in. | No         | per booking    | <b>200,00 €</b> |
| <b>Early Check in</b> (Payable at the base)<br><b>Season: 2026.</b> On request; from 13:00; Payable in cash at the base  | No         | per booking    | <b>150,00 €</b> |
| <b>Hostess</b> (Payable at the base)<br><b>Season: 2026.</b> + own cabin   | No         | per day + food | <b>150,00 €</b> |
| <b>Pet on board</b> (Payable at the base)<br><b>Season: 2026.</b> ONLY ON REQUEST!; Payable in cash at the base  | No         | per booking    | <b>140,00 €</b> |
| <b>Skipper</b> (Payable at the base)<br><b>Season: 2026.</b> On request; Free food, own cabin; Payable in cash at the base   | No         | per day        | <b>200,00 €</b> |
| <b>Transfer</b> (Payable at the base)<br><b>Season: 2026.</b> Transfer to Biograd: A trip from Zadar (up to 4 people) costs €60.   | No         | one-way        | <b>60,00 €</b>  |
| <b>Transfer</b> (Payable at the base)<br><b>Season: 2026.</b> Transfer to Biograd: A trip from Zadar (from 5 and up to 8 people) costs €90.  | No         | one-way        | <b>90,00 €</b>  |
| <b>Transfer</b> (Payable at the base)<br><b>Season: 2026.</b> Transfer to Biograd: The longer trip from Split (up to 4 people) costs €190.   | No         | one-way        | <b>190,00 €</b> |
| <b>Transfer</b> (Payable at the base)<br><b>Season: 2026.</b> Transfer to Biograd: The longer trip from Split (from 5 and up to 8 people) costs €225.  | No         | one-way        | <b>225,00 €</b> |



**WEBSITE**  
www.plujeme.cz



**PHONE**  
+420 720 755 085



**MOBILE**  
+420 777 170 276



**E-MAIL**  
info@plujeme.cz



**PLUJEME RÁDI S.R.O.**  
Dlouhá 730/35, 11000 Praha 1 – Staré Město, Czech Republic

## ADDITIONAL EXTRAS

| EXTRA   | OBLIGATORY | PAYMENT TYPE | PRICE           |
|---|------------|--------------|-----------------|
| <b>Gennaker</b> (Payable at the base)<br><b>Season: 2026.</b> on request, more weeks 50% Rabatt, Cash - Payable at the base                             | No         | per week     | <b>250,00 €</b> |
| <b>Grill/Barbecue/Plancha</b> (Payable at the base)<br><b>Season: 2026.</b> Danish Cobb Gas Grill, 50% discount on 2nd week, Cash - Payable at the base | No         | per week     | <b>100,00 €</b> |
| <b>Outboard engine</b> (Payable at the base)<br><b>Season: 2026.</b> 50% second week; in Cash or with credit card (VISA, MASTER) - Payable at the base  | No         | per week     | <b>100,00 €</b> |
| <b>Stand up paddle (SUP)</b> (Payable at the base)<br><b>Season: 2026.</b> 50% second week; Payable in cash at the base - Payable at the base           | No         | per week     | <b>100,00 €</b> |
| <b>Towels</b> (Payable at the base)<br><b>Season: 2026.</b> 1x big one, 1x small one; Payable in cash at the base - Payable at the base                 | No         | per set      | <b>10,00 €</b>  |

**WEBSITE**[www.plujeme.cz](http://www.plujeme.cz)**E-MAIL**[info@plujeme.cz](mailto:info@plujeme.cz)**PHONE**

+420 720 755 085

**MOBILE**

+420 777 170 276

**PLUJEME RÁDI S.R.O.**

Dlouhá 730/35, 11000 Praha 1 - Staré Město, Czech Republic

## PRICE AND AVAILABILITY

|  |  |  |  |
|--|--|--|--|
| 25.04. - 02.05.2026<br>NOT AVAILABLE   | 02.05. - 09.05.2026<br>NOT AVAILABLE   | 09.05. - 16.05.2026<br>1.330 € 1.900 € | 16.05. - 23.05.2026<br>NOT AVAILABLE   |
| 23.05. - 06.06.2026<br>NOT AVAILABLE   | 06.06. - 13.06.2026<br>NOT AVAILABLE   | 13.06. - 27.06.2026<br>NOT AVAILABLE   | 27.06. - 04.07.2026<br>NOT AVAILABLE   |
| 04.07. - 11.07.2026<br>3.042 € 3.900 € | 11.07. - 18.07.2026<br>NOT AVAILABLE   | 18.07. - 01.08.2026<br>NOT AVAILABLE   | 01.08. - 22.08.2026<br>NOT AVAILABLE   |
| 22.08. - 29.08.2026<br>3.042 € 3.900 € | 29.08. - 05.09.2026<br>3.042 € 3.900 € | 05.09. - 12.09.2026<br>NOT AVAILABLE   | 12.09. - 19.09.2026<br>2.847 € 3.650 € |
| 19.09. - 26.09.2026<br>NOT AVAILABLE   | 26.09. - 03.10.2026<br>2.223 € 2.850 € | 03.10. - 10.10.2026<br>1.482 € 1.900 € | 10.10. - 17.10.2026<br>1.209 € 1.550 € |
| 17.10. - 24.10.2026<br>1.209 € 1.550 € | 24.10. - 31.10.2026<br>1.209 € 1.550 € | 31.10. - 07.11.2026<br>1.209 € 1.550 € | 07.11. - 14.11.2026<br>1.209 € 1.550 € |
| 14.11. - 21.11.2026<br>1.550 €         | 21.11. - 28.11.2026<br>1.550 €         | 28.11. - 05.12.2026<br>1.550 €         |  |



WEBSITE

[www.plujeme.cz](http://www.plujeme.cz)



E-MAIL

[info@plujeme.cz](mailto:info@plujeme.cz)



PHONE

+420 720 755 085



MOBILE

+420 777 170 276



PLUJEME RÁDI S.R.O.

Dlouhá 730/35, 11000 Praha 1 – Staré Město, Czech Republic

## PRICE AND AVAILABILITY

|  |  |  |  |
|--|--|--|--|
| 05.12. - 12.12.2026<br>1.550 €         | 12.12. - 19.12.2026<br>1.550 €         | 19.12. - 26.12.2026<br>1.550 €         | 01.01. - 26.03.2027<br>NOT AVAILABLE   |
| 27.03. - 03.04.2027<br>1.163 € 1.550 € | 03.04. - 10.04.2027<br>1.163 € 1.550 € | 10.04. - 17.04.2027<br>1.163 € 1.550 € | 17.04. - 24.04.2027<br>1.163 € 1.550 € |
| 24.04. - 01.05.2027<br>1.163 € 1.550 € | 01.05. - 08.05.2027<br>1.163 € 1.550 € | 08.05. - 15.05.2027<br>1.425 € 1.900 € | 15.05. - 22.05.2027<br>1.425 € 1.900 € |
| 22.05. - 29.05.2027<br>2.138 € 2.850 € | 29.05. - 05.06.2027<br>2.400 € 3.200 € | 05.06. - 12.06.2027<br>2.400 € 3.200 € | 12.06. - 19.06.2027<br>2.400 € 3.200 € |
| 19.06. - 26.06.2027<br>2.400 € 3.200 € | 26.06. - 03.07.2027<br>2.400 € 3.200 € | 03.07. - 10.07.2027<br>2.925 € 3.900 € | 10.07. - 17.07.2027<br>2.925 € 3.900 € |
| 17.07. - 24.07.2027<br>2.925 € 3.900 € | 24.07. - 31.07.2027<br>2.925 € 3.900 € | 31.07. - 07.08.2027<br>2.925 € 3.900 € |  |



WEBSITE

[www.plujeme.cz](http://www.plujeme.cz)



E-MAIL

[info@plujeme.cz](mailto:info@plujeme.cz)



PHONE

+420 720 755 085



MOBILE

+420 777 170 276



PLUJEME RÁDI S.R.O.

Dlouhá 730/35, 11000 Praha 1 – Staré Město, Czech Republic

## PRICE AND AVAILABILITY

|   |   |   |   |
|---|---|---|---|
| 07.08. - 14.08.2027<br><b>2.925 €</b> 3.900 € | 14.08. - 21.08.2027<br><b>2.925 €</b> 3.900 € | 21.08. - 28.08.2027<br><b>2.925 €</b> 3.900 € | 28.08. - 04.09.2027<br><b>2.925 €</b> 3.900 € |
| 04.09. - 11.09.2027<br><b>2.738 €</b> 3.650 € | 11.09. - 18.09.2027<br><b>2.738 €</b> 3.650 € | 18.09. - 25.09.2027<br><b>2.400 €</b> 3.200 € | 25.09. - 02.10.2027<br><b>2.138 €</b> 2.850 € |
| 02.10. - 09.10.2027<br><b>1.425 €</b> 1.900 € | 09.10. - 16.10.2027<br><b>1.163 €</b> 1.550 € | 16.10. - 23.10.2027<br><b>1.163 €</b> 1.550 € | 23.10. - 30.10.2027<br><b>1.163 €</b> 1.550 € |
| 30.10. - 06.11.2027<br><b>1.163 €</b> 1.550 € | 07.11. - 24.03.2028<br>NOT AVAILABLE          |   |   |



### WEBSITE

[www.plujeme.cz](http://www.plujeme.cz)



### E-MAIL

[info@plujeme.cz](mailto:info@plujeme.cz)



### PHONE

+420 720 755 085



### MOBILE

+420 777 170 276



### PLUJEME RÁDI S.R.O.

Dlouhá 730/35, 11000 Praha 1 – Staré Město, Czech Republic