

LAGOON 400 S2

Second Wind (2018)

Catamaran **Lagoon 400 S2 Second Wind**, built in **2018** is anchored in the **ACI Marina Split, Split region, Croatia**. It has **4 + 2 cabins**, can accommodate **8 + 2 people** and has **4 toilets**. Bed linen and kitchen equipment are included in the price.

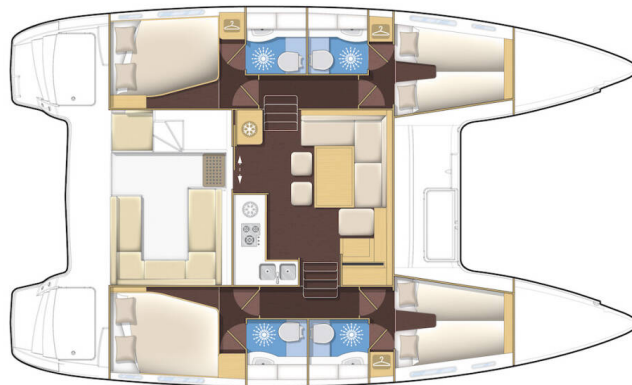

YACHT SPECIFICATIONS

Yacht Base

ACI Marina Split, Croatia

Yacht ID

937

Brands

Lagoon

Yacht name

Second Wind

Production year

2018

Length

39 ft

Cabins

4 + 2

Berths

8 + 2

Max Persons

12

WC

4

Engine

2 x 45 HP

Fuel tank

400 l



WEBSITE

www.plujeme.cz



PHONE

+420 720 755 085



MOBILE

+420 777 170 276



E-MAIL

info@plujeme.cz



PLUJEME RÁDI S.R.O.

Dlouhá 730/35, 11000 Praha 1 – Staré Město, Czech Republic

STANDARD YACHT EQUIPMENT

Additional	Flag
Comfort	Bed linen, Blankets, Cockpit cushions, Pillows, Towels
Deck	Anchor Delta, Anchor with chain, Anchor with rope, Bilge pump - Mechanic, Bimini top, Boat hook, Bosun's chair (Safe seat) (boatswain's chair), Cockpit fridge, Cockpit table, Cockpit/stern, outside shower, Dinghy, Electric anchor windlass, Fenders, Gangway, Jerry cans for diesel, Mooring ropes, Plastic bucket, Swimming ladder, Water hose, Winch handles
Entertainment	Indoor speakers, Outdoor speakers, Radio
Galley	Dishes, Ice maker, Nescaffe Dolce Gusto Coffee Maker, Refrigerator
Interior	Clock, Clothes hangers, Yacht documents
Navigation	Autopilot, Binoculars, Compass, Divider, nautic chart, GPS chart plotter - cockpit, Log, Speed, Depth- echo sounder, Navigation (Nautical) charts and nautical guide, Pilot book, Radar reflector
Safety	Distress flare box, Emergency tiller, Fire axe, Fire extinguisher, First aid kit, Fog horn, Life belts (Safety harness), Life jacket (children), Life jackets, Oars (Paddles), Repair kit, Search light, Set of tools, VHF radio
Yacht electrics	Air Conditioning, Batteries, Bilge pump - Electric, Converter 220V/12V, Generator, Shore connection 220 V, Solar panels



WEBSITE

www.plujeme.cz



PHONE

+420 720 755 085



MOBILE

+420 777 170 276



E-MAIL

info@plujeme.cz



PLUJEME RÁDI S.R.O.

Dlouhá 730/35, 11000 Praha 1 - Staré Město, Czech Republic

SERVICES

SELECTED SERVICES	OBLIGATORY	PAYMENT TYPE	PRICE
Charter package (Payable at the base) Season: 2026. VAT 25%, final cleaning, bed linen, bath towels (2pp), 2 x gas bottles, dish wash, hand soap, 2 sponges, 1 kitchen paper, 2 kitchen clothes, 2 rolls of toilet paper per toilet, garbage bags, outboard engine with 5l fuel, 2 snorkel sets, diver's fee	Yes	per booking	400,00 €
Early boarding/check-in (Payable at the base) Season: 2026. By 1 PM (limited; to be ordered in advance)	No	per booking	150,00 €
Hostess (Payable at the base) Season: 2026. Payable directly to the service provider. The hostess prepares 2 meals: breakfast and light lunch. On the request she can sometimes prepare a third meal at a price of 15 € / person for the service of preparing the third meal (crew included in the number of persons). Groceries for meals are paid by the guest	No	per week + food	1.400,00 €
Non refundable deposit/ insurance (Payable at the base) Season: 2026. + 350€/week refundable *needs to be ordered at least a week in advance	No	per week	350,00 €
Parking (Payable at the base) Season: 2026. per car, in ACI Split marina, cannot be reserved in advance	No	per week	80,00 €
Skipper (Payable at the base) Season: 2026. Payable directly to the service provider	No	per week + food	1.540,00 €
WI-FI Internet connection on boat (Payable at the base) Season: 2026. flat	No	per week	5,00 €



WEBSITE

www.plujeme.cz



PHONE

+420 720 755 085



MOBILE

+420 777 170 276



E-MAIL

info@plujeme.cz



PLUJEME RÁDI S.R.O.

Dlouhá 730/35, 11000 Praha 1 – Staré Město, Czech Republic

ADDITIONAL EXTRAS

EXTRA	OBLIGATORY	PAYMENT TYPE	PRICE
Automatic Inflatable Life Jacket (Payable at the base) <i>Season: 2026. Payable at the base</i>	No	per booking	25,00 €
Beach towel (Payable at the base) <i>Season: 2026. *to be ordered in advance - Payable at the base</i>	No	per piece	5,00 €
Extra bedlinen (Payable at the base) <i>Season: 2026. Payable at the base</i>	No	per cabin	5,00 €
Extra snorkeling equipment (Payable at the base) <i>Season: 2026. two sets per boat are already included, set includes: mask + snorkel + adjustable flippers - Payable at the base</i>	No	per week	15,00 €
Extra towels (Payable at the base) <i>Season: 2026. 2 pcs - Payable at the base</i>	No	per booking	5,00 €
Kayak tandem (Payable at the base) <i>Season: 2026. Payable at the base</i>	No	per week	150,00 €
Railing net (Safety net) (Payable at the base) <i>Season: 2026. Payable at the base</i>	No	per booking	100,00 €
Stand up paddle (SUP) (Payable at the base) <i>Season: 2026. *to be ordered in advance - Payable at the base</i>	No	per week	100,00 €



WEBSITE
www.plujeme.cz



E-MAIL
info@plujeme.cz



PHONE
+420 720 755 085



PLUJEME RÁDI S.R.O.
Dlouhá 730/35, 11000 Praha 1 – Staré Město, Czech Republic



MOBILE
+420 777 170 276

PRICE AND AVAILABILITY

13.06. - 20.06.2026 NOT AVAILABLE	20.06. - 27.06.2026 NOT AVAILABLE	27.06. - 04.07.2026 NOT AVAILABLE	04.07. - 11.07.2026 NOT AVAILABLE
11.07. - 18.07.2026 NOT AVAILABLE	18.07. - 25.07.2026 7.400 €	25.07. - 01.08.2026 NOT AVAILABLE	01.08. - 08.08.2026 NOT AVAILABLE
08.08. - 15.08.2026 NOT AVAILABLE	15.08. - 22.08.2026 NOT AVAILABLE	22.08. - 29.08.2026 NOT AVAILABLE	29.08. - 05.09.2026 NOT AVAILABLE
05.09. - 12.09.2026 NOT AVAILABLE	12.09. - 19.09.2026 NOT AVAILABLE	19.09. - 26.09.2026 4.500 €	26.09. - 03.10.2026 NOT AVAILABLE
03.10. - 10.10.2026 3.600 €	10.10. - 17.10.2026 2.700 €	17.10. - 24.10.2026 2.700 €	24.10. - 31.10.2026 2.700 €
31.10. - 07.11.2026 2.700 €	07.11. - 14.11.2026 2.700 €	14.11. - 21.11.2026 2.700 €	21.11. - 28.11.2026 2.700 €
28.11. - 05.12.2026 2.700 €	05.12. - 12.12.2026 2.700 €	12.12. - 19.12.2026 2.700 €	19.12. - 26.12.2026 2.700 €



WEBSITE

www.plujeme.cz



E-MAIL

info@plujeme.cz



PHONE

+420 720 755 085



MOBILE

+420 777 170 276



PLUJEME RÁDI S.R.O.

Dlouhá 730/35, 11000 Praha 1 – Staré Město, Czech Republic