

# LAGOON 40

MOPY III (2022)

Catamaran Lagoon 40 MOPY III, built in 2022 is anchored in the **St. Martin, Marina de L'Anse Marcel, St. Martin, Caribbean**. It has **4 + 2 cabins**, can accommodate **8 + 2 + 2 people** and has **4 toilets**. Bed linen and kitchen equipment are included in the price.

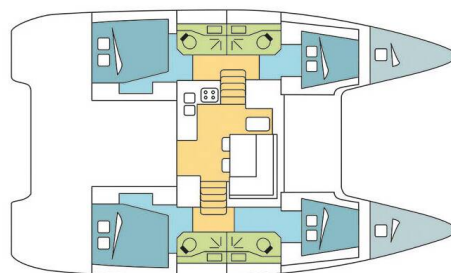

## YACHT SPECIFICATIONS

Yacht Base

**St. Martin, Marina de L'Anse Marcel,  
Caribbean**

Yacht ID

**9340**

Brands

**Lagoon**

Yacht name

**MOPY III**

Production year

**2022**

Length

**39 ft**

Cabins

**4 + 2**

Berths

**8 + 2 + 2**

Max Persons

**12**

WC

**4**

Engine

**2 x 45 HP**

Fuel tank

**400 l**



**WEBSITE**

[www.plujeme.cz](http://www.plujeme.cz)



**PHONE**

+420 720 755 085



**MOBILE**

+420 777 170 276



**E-MAIL**

[info@plujeme.cz](mailto:info@plujeme.cz)



**PLUJEME RÁDI S.R.O.**

Dlouhá 730/35, 11000 Praha 1 - Staré Město, Czech Republic

## STANDARD YACHT EQUIPMENT

Comfort	<b>Cockpit cushions</b>
Deck	<b>Bimini top, Cockpit table, Cockpit/stern, outside shower, Davit, Dinghy, Electric anchor windlass</b>
Entertainment	<b>Fusion radio, Outdoor speakers</b>
Galley	<b>Oven, Refrigerator, Stove</b>
Interior	<b>Convertible table, Convertible table in salon, Electric fans in cabins, Electric toilet</b>
Navigation	<b>Autopilot, Depthsounder, GPS chart plotter, Speedometer (Speed log), Wind instrument/Anemometer</b>
Safety	<b>VHF radio</b>
Sails	<b>Electric winch, Lazy bag, Lazy jacks</b>
Yacht electrics	<b>Battery charger, Inverter, Solar panels, USB sockets, Watermaker - desalinator</b>



### WEBSITE

[www.plujeme.cz](http://www.plujeme.cz)



### E-MAIL

[info@plujeme.cz](mailto:info@plujeme.cz)



### PHONE

+420 720 755 085



### MOBILE

+420 777 170 276



### PLUJEME RÁDI S.R.O.

Dlouhá 730/35, 11000 Praha 1 – Staré Město, Czech Republic

## SERVICES

SELECTED SERVICES	OBLIGATORY	PAYMENT TYPE	PRICE
<b>Essentials pack</b> (Payable now) <b>Season: 2026 Exotic.</b> INCLUDED: Damage waiver (covering damages) with reduced security deposit addressed specifically to blocked toilets, unpaid fuel, lost equipment, unpaid fees & fines, and returning the boat in an extremely dirty state. // starter pack – (1 gallon water or 4 bottles of 1.5L, 1 bottle of disinfectant, 1 small bottle of washing up liquid, 1 dish cloth, 1 sponge, garbage bags, 1 roll of paper towels, 1 box of matches, 1 roll of toilet paper in each head) // final cleaning // 1 set of bed sheets & towels, dinghy, outboard engine & initial supply of fuel, gas and water tanks // DYC assistance guarantee // 1st & last night in the marina /// NOT INCLUDED: refuelling, gas & water consumption at end of charter, taxes if any, handling fees & additional equipment deposit.	Yes	per booking	<b>685,00 €</b>
<b>Handling fees</b> (Payable now) <b>Season: 2026 Exotic.</b>	Yes	per booking	<b>35,00 €</b>
<b>Nature reserve tax</b> (Payable at the base) <b>Season: 2026 Exotic.</b> payable at base	Yes	per person	<b>5,00 €</b>
<b>Preparation fee</b> (Payable now) <b>Season: 2026 Exotic.</b> INCLUDED: starter pack – (1 gallon water or 4 bottles of 1.5L, 1 bottle of disinfectant, 1 small bottle of washing up liquid, 1 dish cloth, 1 sponge, garbage bags, 1 roll of paper towels, 1 box of matches, 1 roll of toilet paper in each head) // final cleaning // 1 set of bed sheets / cabin & 1 set of towels / pax, dinghy, outboard engine & initial supply of fuel, gas and water tanks // DYC assistance guarantee // 1st & last night in the marina // NOT INCLUDED: refuelling, gas & water consumption at end of charter, taxes if any, handling fees & additional equipment deposit.	Yes	per booking	<b>395,00 €</b>
<b>Crew change</b> (Payable now) <b>Season: 2026 Exotic.</b> Any crew change during the charter is subject to € 250.- additional cost. The charge includes administration cost, change of bed linen and towels and one night at DYC ponton (marina fee included only if the same base than start base). It doesn't include cleaning, nor new transit log where applicable.	No	per booking	<b>250,00 €</b>

<b>Damage waiver (Payable now)</b>	No	per night	<b>60,00 €</b>
<b>Season: 2026 Exotic.</b> Damage waiver limits your liability to the reduced Security Deposit . Mandatory when skipper is added. Price is per night of the charter ( minimum value of 7 nights & a maximum value of 21 nights) Not applicable for 4+ weeks charters , nor Regattas/Races.			
<b>Early boarding/check-in (Payable now)</b>	No	per booking	<b>450,00 €</b>
<b>Season: 2026 Exotic.</b> EB (boat only) - 14:00 h / 2 PM starting time of boat's delivery // limited number of early boardings on same departure day			
<b>Early boarding/check-in (Payable now)</b>	No	per booking	<b>670,00 €</b>
<b>Season: 2026 Exotic.</b> EB boat + extra fee skipper- 14:00 h / 2 PM starting time of boat's delivery // limited number of early boardings on same departure day			
<b>Early boarding/check-in (Payable now)</b>	No	per booking	<b>855,00 €</b>
<b>Season: 2026 Exotic.</b> EB + extra fee Skipper & Hostes - 14:00 h / 2 PM starting time of boat's delivery // limited number of early boardings on same departure day			
<b>Electric &amp; Water consumption in the Marinas (Payable at the base)</b>	No	per booking	<b>28,00 €</b>
<b>Season: 2026 Exotic.</b> Electric & Water consumption based on 2 nights on our dock (base will confirm the amount to pay locally depending on nights spent on dock)			
<b>Extra cleaning (Payable now)</b>	No	per booking	<b>285,00 €</b>
<b>Season: 2026 Exotic.</b> Optional Additional cleaning			
<b>Extra set of linen (choose how many) (Payable now)</b>	No	per booking	<b>15,00 €</b>
<b>Season: 2026 Exotic.</b> Extra set of linen : 15 € 1 set of linen (2 sheets & 2 pillow case) - to be updated manually			
<b>Extra set of towels (choose how many) (Payable now)</b>	No	per booking	<b>10,00 €</b>
<b>Season: 2026 Exotic.</b> Extra set of towels: 10 € 1 set of towels (1 face & 1 bath towel) - to be updated manually			
<b>Final cleaning (Payable now)</b>	No	per booking	<b>285,00 €</b>
<b>Season: 2026 Exotic.</b> included in Essentials pack			
<b>Final cleaning (Payable now)</b>	No	per booking	<b>285,00 €</b>
<b>Season: 2026 Exotic.</b> included in Essentials pack			
<b>Full board 1-3 pax (number of guests to update manually) (Payable now)</b>	No	per guest/day	<b>80,00 €</b>
<b>Season: 2026 Exotic.</b> only available if cook is booked on board as the cook will do the provisioning based on client's preference. Includes breakfast, lunch & dinner + the crew's food. Does not included alcoholic drinks			

<p><b>Full board 4-6 pax (number of guests to update manually)</b> (Payable now)</p> <p><b>Season: 2026 Exotic.</b> only available if cook is booked on board as the cook will do the provisioning based on client's preference. Includes breakfast, lunch &amp; dinner + the crew's food. Does not included alcoholic drinks</p>	No	per guest/day	<b>65,00 €</b>
<p><b>Full board 7-12 pax (number of guests to update manually)</b> (Payable now)</p> <p><b>Season: 2026 Exotic.</b> only available if cook is booked on board as the cook will do the provisioning based on client's preference. Includes breakfast, lunch &amp; dinner + the crew's food. Does not included alcoholic drinks</p>	No	per guest/day	<b>60,00 €</b>
<p><b>Half board 1-3 pax (number of guests to update manually)</b> (Payable now)</p> <p><b>Season: 2026 Exotic.</b> only available if cook is booked on board as the cook will do the provisioning based on client's preference. Includes breakfast &amp; lunch OR dinner + the crew's food. Does not included alcoholic drinks</p>	No	per guest/day	<b>65,00 €</b>
<p><b>Half board 4-6 pax (number of guests to update manually)</b> (Payable now)</p> <p><b>Season: 2026 Exotic.</b> only available if cook is booked on board as the cook will do the provisioning based on client's preference. Includes breakfast &amp; lunch OR dinner + the crew's food. Does not included alcoholic drinks</p>	No	per guest/day	<b>55,00 €</b>
<p><b>Half board 7-12 pax (number of guests to update manually)</b> (Payable now)</p> <p><b>Season: 2026 Exotic.</b> only available if cook is booked on board as the cook will do the provisioning based on client's preference. Includes breakfast &amp; lunch OR dinner + the crew's food. Does not included alcoholic drinks</p>	No	per guest/day	<b>50,00 €</b>
<p><b>Hostess/Cook</b> (Payable now)</p> <p><b>Season: 2026 Exotic.</b> + provisioning, Crew on board must have their own toilets/ showers. If either a skipper or a hostess/cook is on board, 1 double cabin will be required for him/her. If both a skipper and a hostess/cook are on board, 1 double cabin and 1 forepeak cabin will be required for them. Exceptions exists for specific layouts, Sales Agents will provide more details about the different boat models</p>	No	per night	<b>230,00 €</b>
<p><b>Hostess/Cook</b> (Payable now)</p> <p><b>Season: 2026 Exotic.</b> + provisioning, Crew on board must have their own toilets/ showers. If either a skipper or a hostess/cook is on board, 1 double cabin will be required for him/her. If both a skipper and a hostess/cook are on board, 1 double cabin and 1 forepeak cabin will be required for them. Exceptions exists for specific layouts, Sales Agents will provide more details about the different boat models</p>	No	per night	<b>230,00 €</b>

<b>Hostess/Cook</b> (Payable now)	No	per night	<b>255,00 €</b>
<b>Season: 2026 Exotic.</b> + provisioning, Crew on board must have their own toilets/ showers. If either a skipper or a hostess/cook is on board, 1 double cabin will be required for him/her. If both a skipper and a hostess/cook are on board, 1 double cabin and 1 forepeak cabin will be required for them. Exceptions exists for specific layouts, Sales Agents will provide more details about the different boat models			
<b>Race pack</b> (Payable now)	No	per booking	<b>1.320,00 €</b>
<b>Season: 2026 Exotic.</b> BVI Spring Regatta, Briefing before the race, preparation and gauging of sails, registration of th eyacht (not of the passengers), technical assistance during the race ** ** technical assistance during the race not valid for RORC Caribbean 600 // A special race deposit need to be doubled manually once the race fee is added.			
<b>Race pack</b> (Payable now)	No	per booking	<b>1.650,00 €</b>
<b>Season: 2026 Exotic.</b> Antigua, Briefing before the race, preparation and gauging of sails, registration of th eyacht (not of the passengers), technical assistance during the race ** ** technical assistance during the race not valid for RORC Caribbean 600 // A special race deposit need to be doubled manually once the race fee is added.			
<b>Race pack</b> (Payable now)	No	per booking	<b>1.650,00 €</b>
<b>Season: 2026 Exotic.</b> RORC caribbean 600, Briefing before the race, preparation and gauging of sails, registration of th eyacht (not of the passengers), technical assistance during the race ** ** technical assistance during the race not valid for RORC Caribbean 600 // A special race deposit need to be doubled manually once the race fee is added.			
<b>Regatta surcharge</b> (Payable now)	No	per booking	<b>1.850,00 €</b>
<b>Season: 2026 Exotic.</b> valid for ASW regatta only // A special race deposit need to be doubled manually once the regatta surcharge is added.			
<b>Regatta surcharge</b> (Payable now)	No	per booking	<b>0,00 €</b>
<b>Season: 2026 Exotic.</b> all the regattas apart of ASW (different regatta surcharge for ASW) // A special race deposit need to be doubled manually once the regatta surcharge is added.			
<b>Same day briefing</b> (Payable now)	No	per booking	<b>150,00 €</b>
<b>Season: 2026 Exotic.</b> Same day briefing starting between 5 & 5.30pm (departure following morning)			

<p><b>Skipper</b> (Payable now)</p> <p><b>Season: 2026 Exotic.</b> + provisioning, Crew on board must have their own toilets/ showers. If either a skipper or a hostess/cook is on board, 1 double cabin will be required for him/her. If both a skipper and a hostess/cook are on board, 1 double cabin and 1 forepeak cabin will be required for them. Exceptions exists for specific layouts, Sales Agents will provide more details about the different boat models</p>	No	per night	<b>300,00 €</b>
<p><b>Skipper</b> (Payable now)</p> <p><b>Season: 2026 Exotic.</b> + provisioning, Crew on board must have their own toilets/ showers. If either a skipper or a hostess/cook is on board, 1 double cabin will be required for him/her. If both a skipper and a hostess/cook are on board, 1 double cabin and 1 forepeak cabin will be required for them. Exceptions exists for specific layouts, Sales Agents will provide more details about the different boat models</p>	No	per night	<b>300,00 €</b>
<p><b>Skipper</b> (Payable now)</p> <p><b>Season: 2026 Exotic.</b> + provisioning, Crew on board must have their own toilets/ showers. If either a skipper or a hostess/cook is on board, 1 double cabin will be required for him/her. If both a skipper and a hostess/cook are on board, 1 double cabin and 1 forepeak cabin will be required for them. Exceptions exists for specific layouts, Sales Agents will provide more details about the different boat models</p>	No	per night	<b>330,00 €</b>
<p><b>Starter pack</b> (Payable now)</p> <p><b>Season: 2026 Exotic.</b> included in Essentials pack (The pack includes: 1 gallon water (or 4 bottles of 1.5L), 1 bottle of disinfectant, 1 small bottle of washing up liquid, 1 dish cloth, 1 sponge, garbage bags, 1 roll of paper towels, 1 box of matches, 1 roll of toilet paper in each head</p>	No	per booking	<b>50,00 €</b>
<p><b>Transfer</b> (Payable now)</p> <p><b>Season: 2026 Exotic.</b> RT - Grand Case airport/base - additional pax</p>	No	round trip	<b>26,00 €</b>
<p><b>Transfer</b> (Payable now)</p> <p><b>Season: 2026 Exotic.</b> RT - Juliana airport/base additional pax</p>	No	round trip	<b>65,00 €</b>
<p><b>Transfer</b> (Payable now)</p> <p><b>Season: 2026 Exotic.</b> RT -Grand Case airport – St Martin base 1-3 pax</p>	No	round trip	<b>78,00 €</b>
<p><b>Transfer</b> (Payable now)</p> <p><b>Season: 2026 Exotic.</b> RT - Juliana airport – St Martin base 1-3 pax</p>	No	round trip	<b>195,00 €</b>



**WEBSITE**  
www.plujeme.cz



**PHONE**  
+420 720 755 085



**MOBILE**  
+420 777 170 276



**E-MAIL**  
info@plujeme.cz



**PLUJEME RÁDI S.R.O.**  
Dlouhá 730/35, 11000 Praha 1 – Staré Město, Czech Republic

## ADDITIONAL EXTRAS

EXTRA	OBLIGATORY	PAYMENT TYPE	PRICE
<b>Fishing equipment</b> (Payable now) <b>Season: 2026 Exotic.</b> Additional deposit 100 EUR (subject to availability) - Payable now	No	per day	<b>15,00 €</b>
<b>Kayak single</b> (Payable now) <b>Season: 2026 Exotic.</b> price per day - Payable now	No	per night	<b>15,00 €</b>
<b>Kayak tandem</b> (Payable now) <b>Season: 2026 Exotic.</b> price per day - Payable now	No	per night	<b>15,00 €</b>
<b>Outboard engine 8 &amp; 9,8 HP</b> (Payable now) <b>Season: 2026 Exotic.</b> Dinghy not suitable in any case for waterski or wakeboard. Additional security deposit of 500 € on outboard engines. A powerboat licence is mandatory in French territories to drive a dinghy with an outboard more powerful than 6hp. It's client responsibility to ensure to have the right powerboat licence when renting a more powerful outboard. In case the needed licence is not presented at base, it will not be possible to use this larger outboard which will not be refunded - Payable now	No	per day	<b>35,00 €</b>
<b>Railing net (Safety net)</b> (Payable now) <b>Season: 2026 Exotic.</b> net is supplied but not installed - Payable now	No	per booking	<b>250,00 €</b>
<b>Stand up paddle (SUP)</b> (Payable now) <b>Season: 2026 Exotic.</b> Price per day - Payable now	No	per night	<b>15,00 €</b>



**WEBSITE**  
www.plujeme.cz



**PHONE**  
+420 720 755 085



**MOBILE**  
+420 777 170 276



**E-MAIL**  
info@plujeme.cz



**PLUJEME RÁDI S.R.O.**  
Dlouhá 730/35, 11000 Praha 1 – Staré Město, Czech Republic

## PRICE AND AVAILABILITY

11.06. - 18.06.2026 NOT AVAILABLE	20.06. - 27.06.2026 ON OPTION	27.06. - 04.07.2026 ON OPTION	04.07. - 11.07.2026 2.690 €
14.07. - 21.07.2026 NOT AVAILABLE	25.07. - 01.08.2026 2.405 €	01.08. - 08.08.2026 2.405 €	08.08. - 15.08.2026 2.405 €
15.08. - 22.08.2026 2.405 €	22.08. - 29.08.2026 2.405 €	31.08. - 17.09.2026 NOT AVAILABLE	19.09. - 26.09.2026 2.405 €
26.09. - 03.10.2026 2.446 €	03.10. - 10.10.2026 2.423 € 2.550 €	10.10. - 17.10.2026 2.423 € 2.550 €	17.10. - 24.10.2026 2.423 € 2.550 €
24.10. - 01.11.2026 NOT AVAILABLE	07.11. - 14.11.2026 2.822 € 3.135 €	14.11. - 21.11.2026 3.240 € 3.600 €	21.11. - 28.11.2026 3.591 € 3.780 €
28.11. - 05.12.2026 3.447 € 3.830 €	05.12. - 12.12.2026 3.384 € 3.760 €	12.12. - 19.12.2026 3.384 € 3.760 €	19.12. - 26.12.2026 5.952 € 6.265 €
28.12. - 14.01.2027 NOT AVAILABLE	16.01. - 23.01.2027 5.372 € 5.655 €	23.01. - 30.01.2027 5.662 € 5.960 €	30.01. - 06.02.2027 5.952 € 6.265 €



**WEBSITE**  
[www.plujeme.cz](http://www.plujeme.cz)



**E-MAIL**  
[info@plujeme.cz](mailto:info@plujeme.cz)



**PHONE**  
+420 720 755 085



**PLUJEME RÁDI S.R.O.**  
Dlouhá 730/35, 11000 Praha 1 – Staré Město, Czech Republic



**MOBILE**  
+420 777 170 276

## PRICE AND AVAILABILITY

06.02. - 13.02.2027 <b>6.071 €</b> 6.390 €	13.02. - 20.02.2027 <b>6.375 €</b> 6.710 €	20.02. - 27.02.2027 <b>6.375 €</b> 6.710 €	27.02. - 06.03.2027 <b>6.375 €</b> 6.710 €
06.03. - 13.03.2027 <b>6.375 €</b> 6.710 €	13.03. - 20.03.2027 <b>6.883 €</b> 7.245 €	20.03. - 27.03.2027 <b>6.883 €</b> 7.245 €	01.04. - 15.04.2027 NOT AVAILABLE
17.04. - 24.04.2027 <b>5.700 €</b> 6.000 €	24.04. - 01.05.2027 <b>4.655 €</b> 4.900 €	01.05. - 08.05.2027 <b>3.244 €</b> 3.415 €	08.05. - 15.05.2027 <b>3.244 €</b> 3.415 €
15.05. - 22.05.2027 <b>3.178 €</b> 3.345 €	22.05. - 29.05.2027 <b>3.178 €</b> 3.345 €	29.05. - 05.06.2027 <b>3.178 €</b> 3.345 €	05.06. - 12.06.2027 <b>3.178 €</b> 3.345 €
12.06. - 19.06.2027 <b>3.192 €</b> 3.360 €	19.06. - 26.06.2027 <b>3.178 €</b> 3.345 €	26.06. - 03.07.2027 <b>3.192 €</b> 3.360 €	03.07. - 10.07.2027 <b>3.178 €</b> 3.345 €
10.07. - 17.07.2027 <b>3.178 €</b> 3.345 €	17.07. - 24.07.2027 <b>3.178 €</b> 3.345 €	24.07. - 31.07.2027 <b>3.178 €</b> 3.345 €	31.07. - 07.08.2027 <b>2.945 €</b> 3.100 €
07.08. - 14.08.2027 <b>2.693 €</b> 2.835 €	14.08. - 21.08.2027 <b>2.693 €</b> 2.835 €	21.08. - 28.08.2027 <b>2.423 €</b> 2.550 €	28.08. - 04.09.2027 <b>2.423 €</b> 2.550 €
04.09. - 11.09.2027 <b>2.423 €</b> 2.550 €	11.09. - 18.09.2027 <b>2.423 €</b> 2.550 €	18.09. - 25.09.2027 <b>2.423 €</b> 2.550 €	25.09. - 02.10.2027 <b>2.423 €</b> 2.550 €



WEBSITE

[www.plujeme.cz](http://www.plujeme.cz)



E-MAIL

[info@plujeme.cz](mailto:info@plujeme.cz)



PHONE

+420 720 755 085



MOBILE

+420 777 170 276



PLUJEME RÁDI S.R.O.

Dlouhá 730/35, 11000 Praha 1 – Staré Město, Czech Republic

## PRICE AND AVAILABILITY

02.10. - 09.10.2027 <b>2.423 €</b> 2.550 €	09.10. - 16.10.2027 <b>2.423 €</b> 2.550 €	16.10. - 23.10.2027 <b>2.423 €</b> 2.550 €	23.10. - 30.10.2027 <b>2.779 €</b> 2.925 €
30.10. - 06.11.2027 <b>2.978 €</b> 3.135 €	06.11. - 13.11.2027 <b>3.420 €</b> 3.600 €	13.11. - 20.11.2027 <b>3.420 €</b> 3.600 €	20.11. - 27.11.2027 <b>3.420 €</b> 3.600 €
27.11. - 04.12.2027 <b>3.639 €</b> 3.830 €	04.12. - 11.12.2027 <b>3.572 €</b> 3.760 €	11.12. - 18.12.2027 <b>3.572 €</b> 3.760 €	18.12. - 25.12.2027 <b>5.306 €</b> 5.585 €



### WEBSITE

[www.plujeme.cz](http://www.plujeme.cz)



### E-MAIL

[info@plujeme.cz](mailto:info@plujeme.cz)



### PHONE

+420 720 755 085



### MOBILE

+420 777 170 276



### PLUJEME RÁDI S.R.O.

Dlouhá 730/35, 11000 Praha 1 – Staré Město, Czech Republic