

LAGOON 46

Ghost Buster (2023)

Catamaran Lagoon 46 Ghost Buster, built in 2023 is anchored in the **Seychelles, Eden Island Marina, Mahé, Seychelles**. It has **4 + 2 cabins**, can accommodate **8 + 2 people** and has **4 toilets**. Bed linen and kitchen equipment are included in the price.

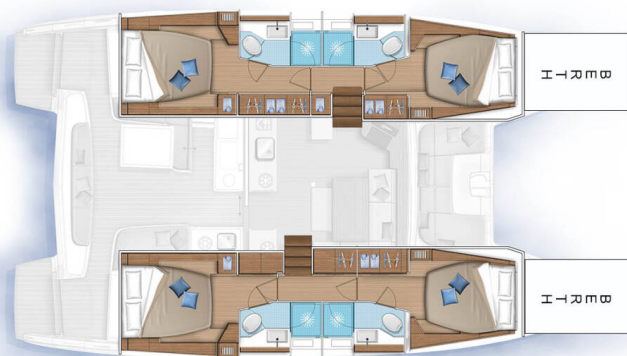

YACHT SPECIFICATIONS

Yacht Base

**Seychelles, Eden Island Marina,
Seychelles**

Yacht ID

8896

Brands

Lagoon

Yacht name

Ghost Buster

Production year

2023

Length

46 ft

Cabins

4 + 2

Berths

8 + 2

Max Persons

10

WC

4

Engine

2 x 57 HP

Fuel tank

1040 l



WEBSITE

www.plujeme.cz



PHONE

+420 720 755 085



MOBILE

+420 777 170 276



E-MAIL

info@plujeme.cz



PLUJEME RÁDI S.R.O.

Dlouhá 730/35, 11000 Praha 1 – Staré Město, Czech Republic

STANDARD YACHT EQUIPMENT

Additional	Flag
Comfort	Bed linen, Cockpit cushions, Outside cushions, Pillows
Deck	Anchor with chain, Bilge pump - Mechanic, Bimini top, Boat hook, Bosun's chair (Safe seat) (boatswain's chair), Cockpit fridge, Cockpit table, Cockpit/stern, outside shower, Deck brush, Deck lights, Dinghy with outboard engine, Electric anchor windlass, Fenders, Flybridge, Gangway, LED outdoor ambiance lights, Mooring Cleats, Mooring ropes, Round/globular fender, Spare anchor (Reserve, Auxiliary anchor), Sponge, Spring cleats, Swimming ladder, Teak cockpit, Teak cockpit table with folding leaves, Winch handles
Entertainment	Bose Sound System, Fins, Fusion radio, Mask and snorkel, Underwater lights
Galley	Blender, Gas bottles, Gas cookers, Kitchen towel, Kitchen utensils (Galley equipment, cutlery), Oven, Refrigerator, Side galley, Stove, Water pump
Interior	Clothes hangers, Electric fans in cabins, Electric toilet, Foldable table, LED interior lights, Toilet brush, Upholstery, Yacht interior refit
Navigation	Autopilot, Binoculars, Compass, Forwardscan sounder, GPS chart plotter, LED Navigation lights, Navigation set, Parallel ruler, Radar reflector, Tridata, Windex
Safety	Black Water Tank, Distress flare box, Emergency tiller, Fire extinguisher, First aid kit, Flashlight, Fog horn, Horseshoe lifebuoy, Life jackets, Liferaft, Rescue sling (Life sling), Set of tools, Signal flags, Signaling mirror, Spare parts, Torch, VHF radio, Wire (shroud) cutter
Sails	Dacron square top main sail, Electric Flatwinder, Electric winch, Lazy bag, Sails, Winch
Yacht electrics	220V socket, Air Conditioning, Battery charger, Bilge pump - Electric, DSC station, Generator, Inverter, Motor hours counter, Service batteries, Shore power cable, Start battery, USB sockets, Water heater, Watermaker - desalinator, WC pump



WEBSITE

www.plujeme.cz



PHONE

+420 720 755 085



MOBILE

+420 777 170 276



E-MAIL

info@plujeme.cz



PLUJEME RÁDI S.R.O.

Dlouhá 730/35, 11000 Praha 1 – Staré Město, Czech Republic

SERVICES

SELECTED SERVICES	OBLIGATORY	PAYMENT TYPE	PRICE
Comfort Pack (Payable now) Season: 2026 Exotic . To be added upon client's price - OBLIGATORY - SEY Welcome package, final cleaning, bed sheets & towels, dinghy, outboard engine & fuel, propane gas, full water tanks, snorkelling equipment,WIFI with unlimited use. However, if the limit of 20GB per day is crossed, the internet speed is reduced for the rest of that day. Yacht Fuel is not included - the fuel tank will be full when your charter starts and you are responsible for topping off the fuel tank at the end of your charter. Security deposit is obligatory and is paid on spot in the base.	Yes	per booking	615,00 €
Handling fees (Payable now) Season: 2026 Exotic .	Yes	per booking	35,00 €
Preparation fee (Payable now) Season: 2026 Exotic . INCLUDED: Welcome pack // final cleaning // 1 set of bed sheets / cabin & 1 set of towels / pax, dinghy, outboard engine & initial supply of fuel, gas and water tanks // 1st & last night in the marina // NOT INCLUDED: refuelling, gas & water consumption at end of charter, taxes if any, handling fees & additional equipment deposit.	Yes	per booking	430,00 €
Tourist tax (Payable at the base) Season: 2026 Exotic . According to S.I. 52 of 2023 ENVIRONMENT PROTECTION ACT (ext. of Act 18 of 2016), a Seychelles compulsory tourist tax of 100SCR per person/day (or equivalent Currency as per daily rate is applied), payable at base. NOT applicable to citizens and residents of Seychelles, children of 12 years and below (visitors), and Navigare Yacht crew. (Price will be adjusted according to the crew list)	Yes	per guest/day	7,00 €
Cook (Payable now) Season: 2026 Exotic . +provisioning ; Crew on board must have their own toilets/ showers. If either a skipper or a hostess/cook is on board, 1 double cabin will be required for him/her. If both a skipper and a hostess/cook are on board, 1 double cabin and 1 forepeak cabin will be required for them. Exceptions exists for specific layouts, Sales Agents will provide more details about the different boat models. Cooking breakfast, lunch, 5 dinners a week, supply, keeping the kitchen clean (not the rest of the boat, not the cabins).	No	per day + food	145,00 €

<p>Cook (Payable now)</p> <p>Season: 2026 Exotic . +provisioning ; Crew on board must have their own toilets/ showers. If either a skipper or a hostess/cook is on board, 1 double cabin will be required for him/her. If both a skipper and a hostess/cook are on board, 1 double cabin and 1 forepeak cabin will be required for them. Exceptions exists for specific layouts, Sales Agents will provide more details about the different boat models. Cooking breakfast, lunch, 5 dinners a week, supply, keeping the kitchen clean (not the rest of the boat, not the cabins).</p>	No	per day + food	145,00 €
<p>Cook (Payable now)</p> <p>Season: 2026 Exotic . +provisioning ; Crew on board must have their own toilets/ showers. If either a skipper or a hostess/cook is on board, 1 double cabin will be required for him/her. If both a skipper and a hostess/cook are on board, 1 double cabin and 1 forepeak cabin will be required for them. Exceptions exists for specific layouts, Sales Agents will provide more details about the different boat models. A gratuity of 15-20% of the crew fee is customary for excellent service. Cooking breakfast, lunch, dinners, keeping the kitchen clean (not the rest of the boat, not the cabins). NOTE: Cook details will be available 3 days before the charter.</p>	No	per day + food	160,00 €
<p>Damage waiver (Payable now)</p> <p>Season: 2026 Exotic . Damage waiver limits your liability to the reduced Security Deposit . Mandatory when skipper is added. Price is per night of the charter (minimum value of 7 nights & a maximum value of 21 nights) Not applicable for 4+ weeks charters , nor Regattas/Races.</p>	No	per night	70,00 €
<p>Extra cleaning (Payable now)</p> <p>Season: 2026 Exotic . Optional Additional cleaning</p>	No	per booking	340,00 €
<p>Extra set of linen (choose how many) (Payable now)</p> <p>Season: 2026 Exotic . Extra set of linen : 15 € 1 set of linen (2 sheets & 2 pillow case) - to be updated manually</p>	No	per booking	15,00 €
<p>Extra set of towels (choose how many) (Payable now)</p> <p>Season: 2026 Exotic . Extra set of towels: 10 € 1 set of towels (1 face & 1 bath towel) - to be updated manually</p>	No	per booking	10,00 €
<p>Full board 1-4 pax (number of guests to update manually) (Payable now)</p> <p>Season: 2026 Exotic . Only available if cook is booked on board as the cook will do the provisioning based on client's preference. Includes breakfast, lunch & dinner + the crew's food. Does not include fuel, alcoholic drinks, moorings park or landing fees.</p>	No	per guest/day	60,00 €

<p>Full board 5-12 pax (number of guests to update manually) (Payable now)</p> <p>Season: 2026 Exotic . Only available if cook is booked on board as the cook will do the provisioning based on client's preference. Includes breakfast, lunch & dinner + the crew's food. Does not include fuel, alcoholic drinks, moorings park or landing fees.</p>	No	per guest/day	55,00 €
<p>Gritchen cancellation insurance (Payable now)</p> <p>Season: 2026 Exotic . with Covid coverage (4% of client's Total price)- European clients Only</p>	No	per booking	0,00 €
<p>Half board 1-4 pax (number of guests to update manually) (Payable now)</p> <p>Season: 2026 Exotic . only available if cook is booked on board as the cook will do the provisioning based on client's preference. Includes breakfast & lunch OR dinner + the crew's food. Does not included alcoholic drinks</p>	No	per guest/day	50,00 €
<p>Half board 5-12 pax (number of guests to update manually) (Payable now)</p> <p>Season: 2026 Exotic . only available if cook is booked on board as the cook will do the provisioning based on client's preference. Includes breakfast & lunch OR dinner + the crew's food. Does not included alcoholic drinks</p>	No	per guest/day	45,00 €
<p>Skipper (Payable now)</p> <p>Season: 2026 Exotic . +provisioning ; Crew on board must have their own toilets/ showers. If either a skipper or a hostess/cook is on board, 1 double cabin will be required for him/her. If both a skipper and a hostess/cook are on board, 1 double cabin and 1 forepeak cabin will be required for them. Exceptions exists for specific layouts, Sales Agents will provide more details about the different boat models. ***NOTE: Skipper details will be available 3 days before the charter.</p>	No	per day + food	170,00 €
<p>Skipper (Payable now)</p> <p>Season: 2026 Exotic . +provisioning ; Crew on board must have their own toilets/ showers. If either a skipper or a hostess/cook is on board, 1 double cabin will be required for him/her. If both a skipper and a hostess/cook are on board, 1 double cabin and 1 forepeak cabin will be required for them. Exceptions exists for specific layouts, Sales Agents will provide more details about the different boat models. ***NOTE: Skipper details will be available 3 days before the charter.</p>	No	per day + food	170,00 €
<p>Skipper (Payable now)</p> <p>Season: 2026 Exotic . +provisioning ; Crew on board must have their own toilets/ showers. If either a skipper or a hostess/cook is on board, 1 double cabin will be required for him/her. If both a skipper and a hostess/cook are on board, 1 double cabin and 1 forepeak cabin will be required for them. Exceptions exists for specific layouts, Sales Agents will provide more details about the different boat models. ***NOTE: Skipper details will be available 3 days before the charter.</p>	No	per day + food	190,00 €

Skipper+Cook (Payable now)

No

per day + food

220,00 €

Season: 2026 Exotic . (for charters up to max 3 guests, one person works as a skipper and cook) + provisioning, Crew on board must have their own toilets/ showers. If either a skipper or a hostess/cook is on board, 1 double cabin will be required for him/her. If both a skipper and a hostess/cook are on board, 1 double cabin and 1 forepeak cabin will be required for them. Exceptions exists for specific layouts, Sales Agents will provide more details about the different boat models

Skipper+Cook (Payable now)

No

per day + food

220,00 €

Season: 2026 Exotic . (for charters up to max 3 guests, one person works as a skipper and cook) + provisioning, Crew on board must have their own toilets/ showers. If either a skipper or a hostess/cook is on board, 1 double cabin will be required for him/her. If both a skipper and a hostess/cook are on board, 1 double cabin and 1 forepeak cabin will be required for them. Exceptions exists for specific layouts, Sales Agents will provide more details about the different boat models

Skipper+Cook (Payable now)

No

per day + food

245,00 €

Season: 2026 Exotic . (for charters up to max 3 guests, one person works as a skipper and cook) + provisioning, Crew on board must have their own toilets/ showers. If either a skipper or a hostess/cook is on board, 1 double cabin will be required for him/her. If both a skipper and a hostess/cook are on board, 1 double cabin and 1 forepeak cabin will be required for them. Exceptions exists for specific layouts, Sales Agents will provide more details about the different boat models

WI-FI Internet connection on boat (Payable now)

No

per night

12,00 €

Season: 2026 Exotic . Unlimited GigaBytes included in the price

**WEBSITE**www.plujeme.cz**PHONE**

+420 720 755 085

**MOBILE**

+420 777 170 276

**E-MAIL**info@plujeme.cz**PLUJEME RÁDI S.R.O.**

Dlouhá 730/35, 11000 Praha 1 – Staré Město, Czech Republic

ADDITIONAL EXTRAS

EXTRA	OBLIGATORY	PAYMENT TYPE	PRICE
Extra bedlinen and towels <i>(Payable now)</i> Season: 2026 Exotic . <i>Payable now</i>	No	per person	20,00 €
Stand up paddle (SUP) <i>(Payable now)</i> Season: 2026 Exotic . <i>Price per day - Payable now</i>	No	per night	15,00 €

**WEBSITE**

www.plujeme.cz

**E-MAIL**

info@plujeme.cz

**PHONE**

+420 720 755 085

**MOBILE**

+420 777 170 276

**PLUJEME RÁDI S.R.O.**

Dlouhá 730/35, 11000 Praha 1 – Staré Město, Czech Republic

PRICE AND AVAILABILITY

24.04. - 01.05.2026 NOT AVAILABLE	02.05. - 09.05.2026 NOT AVAILABLE	09.05. - 16.05.2026 4.807 € 6.290 €	16.05. - 30.05.2026 NOT AVAILABLE
30.05. - 06.06.2026 4.204 € 5.605 €	08.06. - 15.06.2026 NOT AVAILABLE	20.06. - 27.06.2026 4.204 € 5.605 €	27.06. - 04.07.2026 NOT AVAILABLE
04.07. - 11.07.2026 4.215 € 5.620 €	11.07. - 18.07.2026 4.680 € 6.240 €	18.07. - 25.07.2026 5.201 € 6.935 €	25.07. - 01.08.2026 5.201 € 6.935 €
01.08. - 08.08.2026 5.565 € 7.420 €	08.08. - 15.08.2026 4.710 € 6.280 €	15.08. - 22.08.2026 4.785 € 6.380 €	22.08. - 29.08.2026 4.808 € 6.410 €
29.08. - 05.09.2026 4.808 € 6.410 €	05.09. - 12.09.2026 4.808 € 6.410 €	12.09. - 26.09.2026 NOT AVAILABLE	26.09. - 03.10.2026 NOT AVAILABLE
03.10. - 10.10.2026 ON OPTION	10.10. - 17.10.2026 ON OPTION	18.10. - 25.10.2026 NOT AVAILABLE	29.10. - 07.11.2026 NOT AVAILABLE
07.11. - 14.11.2026 NOT AVAILABLE	14.11. - 21.11.2026 11.129 € 11.715 €	21.11. - 28.11.2026 8.702 € 9.160 €	28.11. - 05.12.2026 7.833 € 8.245 €



WEBSITE

www.plujeme.cz



E-MAIL

info@plujeme.cz



PHONE

+420 720 755 085



MOBILE

+420 777 170 276



PLUJEME RÁDI S.R.O.

Dlouhá 730/35, 11000 Praha 1 – Staré Město, Czech Republic

PRICE AND AVAILABILITY

05.12. - 12.12.2026 6.061 € 6.380 €	12.12. - 19.12.2026 5.496 € 5.785 €	19.12. - 26.12.2026 8.061 € 8.485 €	02.01. - 09.01.2027 8.769 € 9.230 €
09.01. - 16.01.2027 7.344 € 7.730 €	16.01. - 23.01.2027 7.344 € 7.730 €	23.01. - 30.01.2027 7.344 € 7.730 €	30.01. - 06.02.2027 8.408 € 8.850 €
06.02. - 13.02.2027 9.457 € 9.955 €	13.02. - 20.02.2027 9.723 € 10.235 €	20.02. - 27.02.2027 9.989 € 10.515 €	27.02. - 06.03.2027 9.989 € 10.515 €
06.03. - 13.03.2027 10.493 € 11.045 €	13.03. - 20.03.2027 10.493 € 11.045 €	20.03. - 27.03.2027 10.493 € 11.045 €	27.03. - 03.04.2027 10.840 € 11.410 €
03.04. - 10.04.2027 10.840 € 11.410 €	10.04. - 17.04.2027 10.840 € 11.410 €	17.04. - 24.04.2027 10.840 € 11.410 €	24.04. - 01.05.2027 9.557 € 10.060 €
01.05. - 08.05.2027 7.724 € 8.130 €	08.05. - 15.05.2027 6.565 € 6.910 €	15.05. - 22.05.2027 6.565 € 6.910 €	22.05. - 29.05.2027 6.565 € 6.910 €
29.05. - 05.06.2027 6.227 € 6.555 €	05.06. - 12.06.2027 6.227 € 6.555 €	12.06. - 19.06.2027 6.227 € 6.555 €	19.06. - 26.06.2027 6.227 € 6.555 €
26.06. - 03.07.2027 6.227 € 6.555 €	03.07. - 10.07.2027 6.588 € 6.935 €	10.07. - 17.07.2027 6.588 € 6.935 €	17.07. - 24.07.2027 6.588 € 6.935 €
24.07. - 31.07.2027 6.588 € 6.935 €	31.07. - 07.08.2027 7.049 € 7.420 €		



WEBSITE
www.plujeme.cz



E-MAIL
info@plujeme.cz



PHONE
+420 720 755 085



MOBILE
+420 777 170 276



PLUJEME RÁDI S.R.O.
Dlouhá 730/35, 11000 Praha 1 – Staré Město, Czech Republic

PRICE AND AVAILABILITY

07.08. - 14.08.2027 7.049 € 7.420 €	14.08. - 21.08.2027 6.588 € 6.935 €	21.08. - 28.08.2027 6.090 € 6.410 €	28.08. - 04.09.2027 6.090 € 6.410 €
04.09. - 11.09.2027 6.090 € 6.410 €	11.09. - 18.09.2027 6.090 € 6.410 €	18.09. - 25.09.2027 6.394 € 6.730 €	25.09. - 02.10.2027 6.712 € 7.065 €
02.10. - 09.10.2027 7.111 € 7.485 €	09.10. - 16.10.2027 7.538 € 7.935 €	16.10. - 23.10.2027 8.070 € 8.495 €	23.10. - 30.10.2027 8.702 € 9.160 €
30.10. - 06.11.2027 8.702 € 9.160 €	06.11. - 13.11.2027 8.702 € 9.160 €	13.11. - 20.11.2027 8.702 € 9.160 €	20.11. - 27.11.2027 8.702 € 9.160 €
27.11. - 04.12.2027 8.702 € 9.160 €	04.12. - 11.12.2027 5.771 € 6.075 €	11.12. - 18.12.2027 5.496 € 5.785 €	18.12. - 25.12.2027 8.061 € 8.485 €



WEBSITE

www.plujeme.cz



E-MAIL

info@plujeme.cz



PHONE

+420 720 755 085



MOBILE

+420 777 170 276



PLUJEME RÁDI S.R.O.

Dlouhá 730/35, 11000 Praha 1 – Staré Město, Czech Republic