

DUFOUR 41 PERFORMANCE

Leni (2025)

Sailing yacht Dufour 41 Performance Leni, built in 2025 is anchored in the **Marina Kornati, Biograd, Zadar region, Croatia**. It has **3 cabins**, can accommodate **6 + 2 people** and has **2 toilets**. Bed linen and kitchen equipment are included in the price.

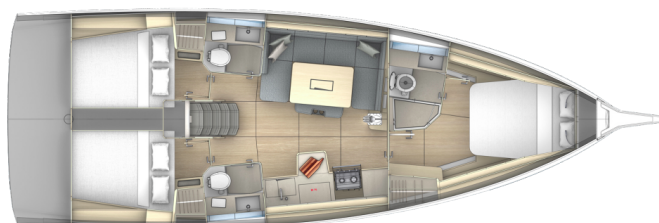

YACHT SPECIFICATIONS

Yacht Base

Marina Kornati, Biograd, Croatia

Yacht ID

8787

Brands

Dufour

Yacht name

Leni

Production year

2025

Length

42 ft

Cabins

3

Berths

6 + 2

Max Persons

8

WC

2

Engine

1 x 50 HP

Fuel tank

250 l



WEBSITE

www.plujeme.cz



PHONE

+420 720 755 085



MOBILE

+420 777 170 276



E-MAIL

info@plujeme.cz



PLUJEME RÁDI S.R.O.

Dlouhá 730/35, 11000 Praha 1 – Staré Město, Czech Republic

STANDARD YACHT EQUIPMENT

Comfort	Cockpit cushions
Deck	Anchor line, Anchor swivel, Bimini top, Black ball, Black conus, Boat hook, Bosun's chair (Safe seat) (boatswain's chair), Canister for water, Cockpit grill, Cockpit table with light, Cockpit/stern, outside shower, Dinghy, Dinghy (byboat) pump, Electric anchor windlass, Fenders, Gangway, Hawser, Impeller, V-belt, oilfilter, Jerry cans for diesel, Main anchor, Mooring ropes, Plastic bucket, Repair box for dinghy, Round/globular fender, Spare anchor (Reserve, Auxiliary anchor), Sprayhood, Spring line, Teak cockpit, Water hose
Entertainment	Outdoor speakers, Radio
Galley	Gas bottles, Hot water, Kitchen utensils (Galley equipment, cutlery), Refrigerator
Interior	Barometer, Clock, Lowerable salon table
Navigation	3 blade folding propeller, AIS, Autopilot, Bow thruster, Bretonplotter, GPS chart plotter - cockpit, Hand bearing compass, Harbour guides, Logge/Lot/Speed/Wind, Navigation (Nautical) charts and nautical guide, Navigation set, Parallel ruler, Radar reflector, Spyglass, Windex
Safety	Distress signals, Fire extinguisher, First aid kit, Flashlight, Fog horn, Life belts (Safety harness), Life buoy + Flashing light, Life jackets, Liferaft, Set of tools, VHF radio, Wire (shroud cutter)
Sails	Lazy bag, Lazy jacks
Yacht electrics	Air Conditioning, Batteries, Battery charger, Battery storage system, Heating, Inverter, Shore connection 220 V, Solar panels



WEBSITE

www.plujeme.cz



PHONE

+420 720 755 085



MOBILE

+420 777 170 276



E-MAIL

info@plujeme.cz



PLUJEME RÁDI S.R.O.

Dlouhá 730/35, 11000 Praha 1 – Staré Město, Czech Republic

SERVICES

SELECTED SERVICES	OBLIGATORY	PAYMENT TYPE	PRICE
Charter package (Payable at the base) Season: 2026. incl. Permit, outboard engine, Wi-Fi Internet (5 GB), bed linen (1 set/ person)	Yes	per booking	320,00 €
Early afternoon boarding/check-in (Payable at the base) Season: 2026. -> 2.00 pm – 4.00 pm, max. 15 yachts	No	per booking	75,00 €
Early boarding/check-in (Payable at the base) Season: 2026. -> 12.30 pm – 2.00 pm, max 5 yachts	No	per booking	200,00 €
Extra cleaning (Payable at the base) Season: 2026.	No	per booking	200,00 €
Hostess (Payable at the base) Season: 2026. + own cabin; external service provider, direct billing	No	per day + food	200,00 €
Parking (Payable at the base) Season: 2026. Price per car; secured parking at the Pitter Dry Dock (Marina Service Center - MSC) Biograd, incl. transfer for 1 person on the check-in/ - out day: Marina Kornati – MSC: FRI 16:00 – 20:00 p.m. depart. every full hour, SAT 06:30 – 08:00 a.m. depart. every hour MSC – Marina Kornati: SAT, every hour, start at 08:30 – 18:30 p.m.	No	per week	50,00 €
Regatta charge (Payable at the base) Season: 2026. ON REQUEST	No	per booking	0,00 €
Skipper (Payable at the base) Season: 2026. + own cabin; external service provider	No	per day + food	200,00 €
VIP comfort package (Payable at the base) Season: 2026. Free secured parking at Pitter Drydock, charging option for electric cars (max. 2,4kW), free transfer to the marina and back with possibility for a stopover at the shopping center and back, air-conditioned lounge area, incl. welcome drink, assistance with luggage transfer directly to the yacht, refrigerator for temporary storage of food (no drinks), free Wi-Fi and vending machines with reasonably priced snacks and drinks in the lounge area, departure and pick-up by personal arrangement considering regular check-in/-out times. Max. 5 yachts	No	per booking	350,00 €

WI-FI Internet connection on boat (Payable at the base)

No

per week

30,00 €

Season: 2026. unlimited / depending on the network reception (5 GB are included in the Charter package)



WEBSITE

www.plujeme.cz



E-MAIL

info@plujeme.cz



PHONE

+420 720 755 085



MOBILE

+420 777 170 276



PLUJEME RÁDI S.R.O.

Dlouhá 730/35, 11000 Praha 1 – Staré Město, Czech Republic

ADDITIONAL EXTRAS

EXTRA	OBLIGATORY	PAYMENT TYPE	PRICE
<p>Extra bedlinen (Payable at the base)</p> <p>Season: 2026. 1 set/ person is included in the charter package - Payable at the base</p>	No	per set	10,00 €
<p>Gennaker (Payable at the base)</p> <p>Season: 2026. Payable at the base</p>	No	per booking	350,00 €
<p>Glass bottom dinghy (Payable at the base)</p> <p>Season: 2026. Formentera 330 PC + approx. 3 HP ePropulsion engine, max. 4 persons, in 8,5 h fully loaded with 12 V - Payable at the base</p>	No	per week	220,00 €
<p>Grill/Barbecue/Plancha (Payable at the base)</p> <p>Season: 2026. Payable at the base</p>	No	per booking	65,00 €
<p>Ice box (Payable at the base)</p> <p>Season: 2026. Mobile Cooler Box (no power connection): approx. 52L, filled with approx. 6kg ice cubes - limited availability, subject to on-site ice availability For drinks and ice only. Box must be returned clean and undamaged. Max. 5 yachts. - Payable at the base</p>	No	per booking	35,00 €
<p>Ice maker (Payable at the base)</p> <p>Season: 2026. operating with - shorepower or - Inverter min. 2.000 W or - Generator - Payable at the base</p>	No	per booking	45,00 €
<p>Main sail traveler (Payable at the base)</p> <p>Season: 2026. INSTEAD OF THE COCKPIT TABLE - Payable at the base</p>	No	per booking	400,00 €
<p>NESPRESSO coffee machine (Payable at the base)</p> <p>Season: 2026. operating with - shorepower or - Inverter min. 2000 W or - Generator - Payable at the base</p>	No	per booking	45,00 €
<p>Racing sails (Payable at the base)</p> <p>Season: 2026. 108% genoa / XRP Cruiser ECO (Elvström polyester laminat sail) - Payable at the base</p>	No	per week	190,00 €
<p>Railing net (Safety net) (Payable at the base)</p> <p>Season: 2026. incl. mounting and unmounting - Payable at the base</p>	No	per booking	180,00 €

Railing net (Safety net) (Payable at the base)	No	per booking	35,00 €
<i>Season: 2026. To be mounted / unmounted by the client (Net and mounting material must be returned by the crew after the charter) - Payable at the base</i>			
Stand up paddle (SUP) (Payable at the base)	No	per week	100,00 €
<i>Season: 2026. Payable at the base</i>			
Towels (Payable at the base)	No	per set	10,00 €
<i>Season: 2026. Payable at the base</i>			



WEBSITE
www.plujeme.cz



E-MAIL
info@plujeme.cz



PHONE
+420 720 755 085



PLUJEME RÁDI S.R.O.
Dlouhá 730/35, 11000 Praha 1 – Staré Město, Czech Republic



MOBILE
+420 777 170 276

PRICE AND AVAILABILITY

25.04. - 02.05.2026 NOT AVAILABLE	02.05. - 09.05.2026 NOT AVAILABLE	09.05. - 16.05.2026 NOT AVAILABLE	16.05. - 23.05.2026 NOT AVAILABLE
23.05. - 30.05.2026 NOT AVAILABLE	30.05. - 06.06.2026 NOT AVAILABLE	06.06. - 13.06.2026 NOT AVAILABLE	13.06. - 20.06.2026 NOT AVAILABLE
20.06. - 04.07.2026 NOT AVAILABLE	04.07. - 11.07.2026 ON OPTION	11.07. - 18.07.2026 NOT AVAILABLE	18.07. - 25.07.2026 NOT AVAILABLE
25.07. - 01.08.2026 NOT AVAILABLE	01.08. - 08.08.2026 NOT AVAILABLE	08.08. - 15.08.2026 ON OPTION	15.08. - 05.09.2026 NOT AVAILABLE
05.09. - 12.09.2026 ON OPTION	12.09. - 19.09.2026 NOT AVAILABLE	19.09. - 26.09.2026 NOT AVAILABLE	26.09. - 03.10.2026 ON OPTION
03.10. - 10.10.2026 1.244 € 1.555 €	10.10. - 17.10.2026 NOT AVAILABLE	17.10. - 24.10.2026 1.120 € 1.400 €	24.10. - 31.10.2026 1.040 € 1.300 €
31.10. - 07.11.2026 1.044 € 1.305 €	07.11. - 14.11.2026 1.096 € 1.370 €	14.11. - 21.11.2026 1.096 € 1.370 €	22.11. - 31.12.2026 NOT AVAILABLE



WEBSITE

www.plujeme.cz



E-MAIL

info@plujeme.cz



PHONE

+420 720 755 085



MOBILE

+420 777 170 276



PLUJEME RÁDI S.R.O.

Dlouhá 730/35, 11000 Praha 1 – Staré Město, Czech Republic