

BAVARIA C46

Freja (2025)

Sailing yacht **Bavaria C46 Freja**, built in **2025** is anchored in the **Marina Tehnomont Veruda, Pula, Istra, Croatia**. It has **4 cabins**, can accommodate **8 + 2 people** and has **4 toilets**. Bed linen and kitchen equipment are included in the price.

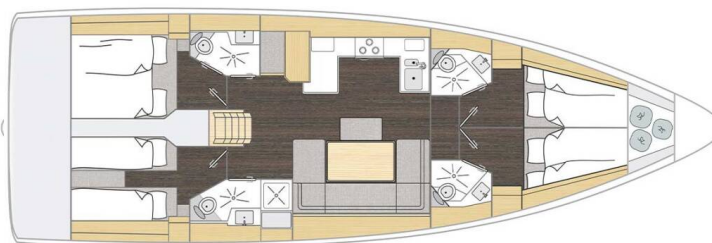

YACHT SPECIFICATIONS

Yacht Base

Marina Tehnomont Veruda, Pula, Croatia

Yacht ID

8732

Brands

Bavaria

Yacht name

Freja

Production year

2025

Length

48 ft

Cabins

4

Berths

8 + 2

Max Persons

10

WC

4

Engine

1 x 80 HP

Fuel tank

244 l



WEBSITE

www.plujeme.cz



PHONE

+420 720 755 085



MOBILE

+420 777 170 276



E-MAIL

info@plujeme.cz



PLUJEME RÁDI S.R.O.

Dlouhá 730/35, 11000 Praha 1 – Staré Město, Czech Republic

STANDARD YACHT EQUIPMENT

| | |
|-----------------|--|
| Comfort | Bed linen, Blankets, Cockpit cushions, Pillows |
| Deck | Bathing platform, Bilge pump - Mechanic, Bimini top, Boat hook, Bosun's chair (Safe seat) (boatswain's chair), Cockpit fridge, Cockpit grill, Cockpit table with light, Cockpit/stern, outside shower, Deck brush, Dinghy, Dinghy (byboat) pump, Electric anchor windlass, Fenders, Gangway, Impeller, V-belt, oilfilter, Jerry cans for diesel, Main anchor, Mooring ropes, Plastic bucket, Round/globular fender, Sea/Storm drogue anchor, Side door for boarding, Spare anchor (Reserve, Auxiliary anchor), Sponge, Sprayhood, Spring line, Swimming ladder, Teak cockpit, Water hose, Winch handles |
| Entertainment | Bluetooth player, FUSION sound system, mp3 player, Outdoor speakers, Underwater lights, USB |
| Galley | Gas bottles, Gas cookers, Hot water, Kitchen utensils (Galley equipment, cutlery), NESPRESSO coffee machine, Oven, Refrigerator, Sink |
| Interior | Barometer, Clock, Clothes hangers, Electric toilet, Inside shower, Oak interior, Upholstery, Yacht documents, Yacht keys |
| Navigation | Autopilot, Binoculars, Bow thruster, CRO flag, Echosounder/Depthsounder, GPS chart plotter - cockpit, Hand bearing compass, Harbour guides, LED Navigation lights, Logge/Lot/Speed/Wind, Navigation (Nautical) charts and nautical guide, Navigation set, Radar reflector, Spyglass with bearing compass, Tridata, Wind instrument/Anemometer |
| Safety | Black Water Tank, Day shapes / signals, Distress signals, Emergency tiller, Engine spare parts, Fire extinguisher, First aid kit, Flashlight, Fog horn, Life belts (Safety harness), Life buoy + Flashing light, Life jackets, Oars (Paddles), Set of tools, Thermal suit, VHF radio |
| Yacht electrics | Air Conditioning, Battery charger, Bilge pump - Electric, Heating, Plug 220V, 12 V, Service batteries, Shore connection 220 V, Solar panels, Start battery |



WEBSITE

www.plujeme.cz



PHONE

+420 720 755 085



MOBILE

+420 777 170 276



E-MAIL

info@plujeme.cz



PLUJEME RÁDI S.R.O.

Dlouhá 730/35, 11000 Praha 1 - Staré Město, Czech Republic

SERVICES

| SELECTED SERVICES | OBLIGATORY | PAYMENT TYPE | PRICE |
|---|------------|----------------|-----------------|
| Package for Accommodation (Payable now) Season: 2026. Final cleaning, bed linen, towels (1x large, 1x small per person), 2x gas cylinder, dishwashing liquid, kitchen sponge, 2x kitchen towel, check-in and check-out service, diver on regular check-out | Yes | per booking | 330,00 € |
| Cook (Payable at the base) Season: 2026. | No | per day + food | 220,00 € |
| Deposit insurance (Payable at the base) Season: 2026. cash, not refundable + 400,00 EUR (cash or credit card, refundable) | No | per week | 300,00 € |
| Diver (Payable at the base) Season: 2026. Non-standard check-out | No | per service | 70,00 € |
| Early boarding/check-in (Payable at the base) Season: 2026. from 13h-14h, limited capacity | No | per booking | 170,00 € |
| Hostess (Payable at the base) Season: 2026. | No | per day + food | 170,00 € |
| One way fee (Payable at the base) Season: 2026. on request | No | per booking | 0,00 € |
| Overnight on board (Payable at the base) Season: 2026. if possible | No | per booking | 170,00 € |
| Permission for int. Waters (Payable at the base) Season: 2026. on request | No | per booking | 0,00 € |
| Pet on board (Payable at the base) Season: 2026. small pets, on request only | No | per booking | 150,00 € |
| Provisioning (Payable at the base) Season: 2026. + bill (buy and delivery service) | No | per booking | 75,00 € |
| Skipper (Payable at the base) Season: 2026. | No | per day + food | 200,00 € |

| | | | |
|---|----|-------------|-----------------|
| Transfer (Payable at the base) Season: 2026. Airport Pula – Marina Veruda, 1 - 4 pax | No | one-way | 45,00 € |
| Transfer (Payable at the base) Season: 2026. Airport Pula – Marina Veruda, 5 - 8 pax | No | one-way | 55,00 € |
| VIP check-in (Payable at the base) Season: 2026. till 12:30h, limited capacity | No | per booking | 230,00 € |
| WI-FI Internet connection on boat (Payable at the base) Season: 2026. Flat rate | No | per week | 35,00 € |



WEBSITE
www.plujeme.cz



E-MAIL
info@plujeme.cz



PHONE
+420 720 755 085



MOBILE
+420 777 170 276



PLUJEME RÁDI S.R.O.
Dlouhá 730/35, 11000 Praha 1 – Staré Město, Czech Republic

ADDITIONAL EXTRAS

| EXTRA | OBLIGATORY | PAYMENT TYPE | PRICE |
|---|------------|--------------|-----------------|
| Additional gas bottle (Payable at the base) <i>Season: 2026. Payable at the base</i> | No | per piece | 15,00 € |
| Automatic Inflatable Life Jacket (Payable at the base) <i>Season: 2026. Payable at the base</i> | No | per piece | 30,00 € |
| Extra bedlinen (Payable at the base) <i>Season: 2026. Payable at the base</i> | No | per set | 10,00 € |
| Inverter (Payable at the base) <i>Season: 2026. 12V/220V - Payable at the base</i> | No | per week | 30,00 € |
| Outboard engine (Payable at the base) <i>Season: 2026. 2,3 HP - Payable at the base</i> | No | per week | 90,00 € |
| Outboard engine (Payable at the base) <i>Season: 2026. 6 HP - Payable at the base</i> | No | per week | 130,00 € |
| Railing net (Safety net) (Payable at the base) <i>Season: 2026. Payable at the base</i> | No | per booking | 140,00 € |
| Stand up paddle (SUP) (Payable at the base) <i>Season: 2026. Payable at the base</i> | No | per week | 120,00 € |
| Towels (Payable at the base) <i>Season: 2026. set - Payable at the base</i> | No | per set | 7,00 € |



WEBSITE
www.plujeme.cz



E-MAIL
info@plujeme.cz



PHONE
+420 720 755 085



MOBILE
+420 777 170 276



PLUJEME RÁDI S.R.O.
Dlouhá 730/35, 11000 Praha 1 – Staré Město, Czech Republic

PRICE AND AVAILABILITY

| | | | |
|--|--|--|--|
| 25.04. - 02.05.2026 1.800 € 3.000 € | 02.05. - 09.05.2026 1.800 € 3.000 € | 09.05. - 16.05.2026 NOT AVAILABLE | 16.05. - 23.05.2026 2.340 € 3.900 € |
| 23.05. - 30.05.2026 NOT AVAILABLE | 30.05. - 06.06.2026 NOT AVAILABLE | 06.06. - 13.06.2026 NOT AVAILABLE | 13.06. - 20.06.2026 NOT AVAILABLE |
| 20.06. - 27.06.2026 4.200 € 6.000 € | 27.06. - 04.07.2026 NOT AVAILABLE | 04.07. - 18.07.2026 NOT AVAILABLE | 18.07. - 25.07.2026 NOT AVAILABLE |
| 25.07. - 01.08.2026 NOT AVAILABLE | 01.08. - 08.08.2026 NOT AVAILABLE | 08.08. - 15.08.2026 4.896 € 6.400 € | 15.08. - 22.08.2026 NOT AVAILABLE |
| 22.08. - 29.08.2026 NOT AVAILABLE | 29.08. - 05.09.2026 NOT AVAILABLE | 05.09. - 12.09.2026 4.622 € 5.350 € | 12.09. - 19.09.2026 4.061 € 4.700 € |
| 19.09. - 26.09.2026 NOT AVAILABLE | 26.09. - 03.10.2026 3.370 € 3.900 € | 03.10. - 10.10.2026 2.592 € 3.000 € | 10.10. - 17.10.2026 2.074 € 2.400 € |
| 17.10. - 24.10.2026 1.901 € 2.200 € | 24.10. - 31.10.2026 1.901 € 2.200 € | 31.10. - 07.11.2026 1.980 € 2.200 € | 07.11. - 14.11.2026 1.980 € 2.200 € |
| 14.11. - 21.11.2026 1.980 € 2.200 € | 21.11. - 28.11.2026 1.980 € 2.200 € | 28.11. - 05.12.2026 1.980 € 2.200 € | |



WEBSITE
www.plujeme.cz



E-MAIL
info@plujeme.cz



PHONE
+420 720 755 085



MOBILE
+420 777 170 276



PLUJEME RÁDI S.R.O.
Dlouhá 730/35, 11000 Praha 1 – Staré Město, Czech Republic

PRICE AND AVAILABILITY

05.12. - 12.12.2026

1.980 € 2.200 €

12.12. - 19.12.2026

1.980 € 2.200 €

19.12. - 26.12.2026

1.980 € 2.200 €



WEBSITE

www.plujeme.cz



E-MAIL

info@plujeme.cz



PHONE

+420 720 755 085



MOBILE

+420 777 170 276



PLUJEME RÁDI S.R.O.

Dlouhá 730/35, 11000 Praha 1 – Staré Město, Czech Republic