

# ELAN IMPRESSION 50

Lena (2017)

Sailing yacht **Elan Impression 50 Lena**, built in **2017** is anchored in the **ACI Marina Split, Split region, Croatia**. It has **5 + 1 cabins**, can accommodate **10 + 1 + 1 people** and has **2 toilets**. Bed linen and kitchen equipment are included in the price.

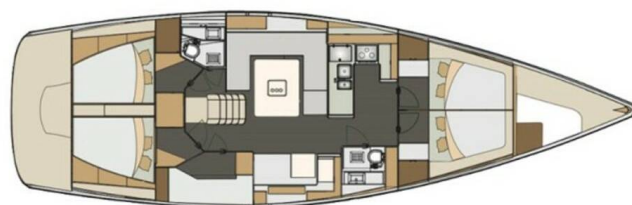

## YACHT SPECIFICATIONS

Yacht Base

**ACI Marina Split, Croatia**

Yacht ID

**869**

Brands

**Elan Marine**

Yacht name

**Lena**

Production year

**2017**

Length

**50 ft**

Cabins

**5 + 1**

Berths

**10 + 1 + 1**

WC

**2**

Engine

**1 x 134 HP**

Fuel tank

**295 l**



**WEBSITE**

[www.plujeme.cz](http://www.plujeme.cz)



**PHONE**

+420 720 755 085



**MOBILE**

+420 777 170 276



**E-MAIL**

[info@plujeme.cz](mailto:info@plujeme.cz)



**PLUJEME RÁDI S.R.O.**

Dlouhá 730/35, 11000 Praha 1 – Staré Město, Czech Republic

## STANDARD YACHT EQUIPMENT

Deck	<b>Bimini top, Cockpit table, Cockpit/stern, outside shower, Dinghy with outboard engine, Electric anchor windlass, Sprayhood</b>
Entertainment	<b>LCD TV, Radio CD player, Wi-Fi Internet</b>
Galley	<b>Gas cookers, Hot water, Kitchen utensils (Galley equipment, cutlery), Oven, Refrigerator</b>
Interior	<b>Bilge pump handle</b>
Navigation	<b>Autopilot, Bow thruster, GPS chart plotter, Log, Speed, Depth- echo sounder</b>
Safety	<b>Fire extinguisher, First aid kit, Life jackets, Signal rockets and torches, VHF radio</b>
Yacht electrics	<b>Air Conditioning, Battery charger, Bilge pump - Electric, Heating, Inverter, Shore connection 220 V, Shore power cable</b>



#### WEBSITE

[www.plujeme.cz](http://www.plujeme.cz)



#### E-MAIL

[info@plujeme.cz](mailto:info@plujeme.cz)



#### PHONE

+420 720 755 085



#### MOBILE

+420 777 170 276



#### PLUJEME RÁDI S.R.O.

Dlouhá 730/35, 11000 Praha 1 – Staré Město, Czech Republic

## SERVICES

SELECTED SERVICES	OBLIGATORY	PAYMENT TYPE	PRICE
<b>Charter package</b> (Payable now) <b>Season: 2026.</b> Includes: final cleaning, transit log, Wi-Fi no limit, dinghy with outboard engine & fuel, gas, bed linen (1 set pp), towels (1 big + 1 small sized/pp), 1 soap per toilet, 1 dish soap	Yes	per booking	<b>360,00 €</b>
<b>Tourist tax</b> (Payable at the base) <b>Season: 2026.</b>	Yes	per guest/night	<b>1,33 €</b>
<b>Deposit insurance</b> (Payable at the base) <b>Season: 2026.</b> + extra 250,00 eur refundable (in case of fuel shortage, late arrival and toilet declogging)/ week	No	per week	<b>350,00 €</b>
<b>Early boarding/check-in</b> (Payable at the base) <b>Season: 2026.</b> We can't guarantee early check-in if technical difficulties from previous charter occur. Available only for BAREBOAT charter.	No	per booking	<b>170,00 €</b>
<b>Hostess</b> (Payable at the base) <b>Season: 2026.</b> + extra cost: food / payable on spot in cash	No	per day	<b>200,00 €</b>
<b>Online doctor</b> (Payable at the base) <b>Season: 2026.</b> 24/7	No	per week	<b>30,00 €</b>
<b>Parking</b> (Payable at the base) <b>Season: 2026.</b> Please, contact marina for more details	No	per week	<b>80,00 €</b>
<b>Pet on board</b> (Payable at the base) <b>Season: 2026.</b>	No	per pet	<b>100,00 €</b>
<b>Provisioning</b> (Payable at the base) <b>Season: 2026.</b> cost of the food	No	per booking	<b>0,00 €</b>
<b>Sail refreshment</b> (Payable at the base) <b>Season: 2026.</b> 1 day sailing refresher program(Sunday)	No	per booking	<b>270,00 €</b>
<b>Skipper</b> (Payable at the base) <b>Season: 2026.</b> + extra cost: food / payable on spot in cash	No	per day + food	<b>220,00 €</b>
<b>Sleepaboard fee</b> (Payable at the base) <b>Season: 2026.</b> night before	No	per person/day	<b>30,00 €</b>

**Transfer** (Payable at the base)

No

one-way

**55,00 €**

**Season: 2026.** From/To airport: 1-3 pax

---

**Transfer** (Payable at the base)

No

one-way

**75,00 €**

**Season: 2026.** From/To airport: 4-8 pax



**WEBSITE**

[www.plujeme.cz](http://www.plujeme.cz)



**E-MAIL**

[info@plujeme.cz](mailto:info@plujeme.cz)



**PHONE**

+420 720 755 085



**MOBILE**

+420 777 170 276



**PLUJEME RÁDI S.R.O.**

Dlouhá 730/35, 11000 Praha 1 – Staré Město, Czech Republic

## ADDITIONAL EXTRAS

EXTRA	OBLIGATORY	PAYMENT TYPE	PRICE
<b>Beach towel</b> (Payable at the base) <b>Season: 2026.</b> for 1 piece - Payable at the base	No	per piece	<b>5,00 €</b>
<b>Blender</b> (Payable at the base) <b>Season: 2026.</b> Payable at the base	No	per booking	<b>30,00 €</b>
<b>Coffee capsules</b> (Payable at the base) <b>Season: 2026.</b> coffee machine (220V) + 30 coffee capsules - Payable at the base	No	per booking	<b>30,00 €</b>
<b>Extra bedlinen</b> (Payable at the base) <b>Season: 2026.</b> 2 bedsheets and 1 pillowcase - Payable at the base	No	per person	<b>5,00 €</b>
<b>Ice maker</b> (Payable at the base) <b>Season: 2026.</b> 220 V - Payable at the base	No	per week	<b>60,00 €</b>
<b>Karaoke</b> (Payable at the base) <b>Season: 2026.</b> Karaoke equipment (speaker with wireless microphone) - Payable at the base	No	per week	<b>100,00 €</b>
<b>Kayak tandem</b> (Payable at the base) <b>Season: 2026.</b> 2 Seats - Payable at the base	No	per booking	<b>200,00 €</b>
<b>Portable refrigerator</b> (Payable at the base) <b>Season: 2026.</b> Payable at the base	No	per week	<b>15,00 €</b>
<b>Railing net (Safety net)</b> (Payable at the base) <b>Season: 2026.</b> Payable at the base	No	per booking	<b>120,00 €</b>
<b>Snorkeling equipment</b> (Payable at the base) <b>Season: 2026.</b> mask, snorkel and fins - Payable at the base	No	per week	<b>15,00 €</b>
<b>Stand up paddle (SUP)</b> (Payable at the base) <b>Season: 2026.</b> Payable at the base	No	per week	<b>120,00 €</b>
<b>Towels</b> (Payable at the base) <b>Season: 2026.</b> 1 large + 1 small towel - Payable at the base	No	per person	<b>5,00 €</b>

**Season: 2026.** 1 large + 1 small towel - Payable at the base



**WEBSITE**

www.plujeme.cz



**E-MAIL**

info@plujeme.cz



**PHONE**

+420 720 755 085



**MOBILE**

+420 777 170 276



**PLUJEME RÁDI S.R.O.**

Dlouhá 730/35, 11000 Praha 1 - Staré Město, Czech Republic

## PRICE AND AVAILABILITY

13.06. - 20.06.2026 ON OPTION	20.06. - 27.06.2026 NOT AVAILABLE	27.06. - 04.07.2026 NOT AVAILABLE	04.07. - 11.07.2026 NOT AVAILABLE
11.07. - 18.07.2026 NOT AVAILABLE	18.07. - 25.07.2026 NOT AVAILABLE	25.07. - 01.08.2026 NOT AVAILABLE	01.08. - 08.08.2026 NOT AVAILABLE
08.08. - 15.08.2026 3.413 € 5.250 €	15.08. - 22.08.2026 3.543 € 5.450 €	22.08. - 29.08.2026 3.348 € 5.150 €	29.08. - 05.09.2026 NOT AVAILABLE
05.09. - 12.09.2026 3.588 € 4.600 €	12.09. - 19.09.2026 NOT AVAILABLE	19.09. - 26.09.2026 NOT AVAILABLE	26.09. - 03.10.2026 NOT AVAILABLE
03.10. - 10.10.2026 2.145 € 2.750 €	10.10. - 17.10.2026 2.145 € 2.750 €	17.10. - 24.10.2026 2.145 € 2.750 €	24.10. - 31.10.2026 2.145 € 2.750 €
31.10. - 07.11.2026 2.145 € 2.750 €	07.11. - 14.11.2026 2.145 € 2.750 €	14.11. - 21.11.2026 2.145 € 2.750 €	21.11. - 28.11.2026 2.145 € 2.750 €
28.11. - 05.12.2026 2.145 € 2.750 €	05.12. - 12.12.2026 2.145 € 2.750 €	12.12. - 19.12.2026 2.145 € 2.750 €	19.12. - 26.12.2026 2.145 € 2.750 €



### WEBSITE

[www.plujeme.cz](http://www.plujeme.cz)



### E-MAIL

[info@plujeme.cz](mailto:info@plujeme.cz)



### PHONE

+420 720 755 085



### MOBILE

+420 777 170 276



### PLUJEME RÁDI S.R.O.

Dlouhá 730/35, 11000 Praha 1 – Staré Město, Czech Republic