

# LEOPARD 50

Edoardo (2023)

Catamaran **Leopard 50 Edoardo**, built in **2023** is anchored in the **Sardinia, Cannigione, Sardinia, Italy**. It has **5 + 1 cabins**, can accommodate **10 + 2 people** and has **5 toilets**. Bed linen and kitchen equipment are included in the price.

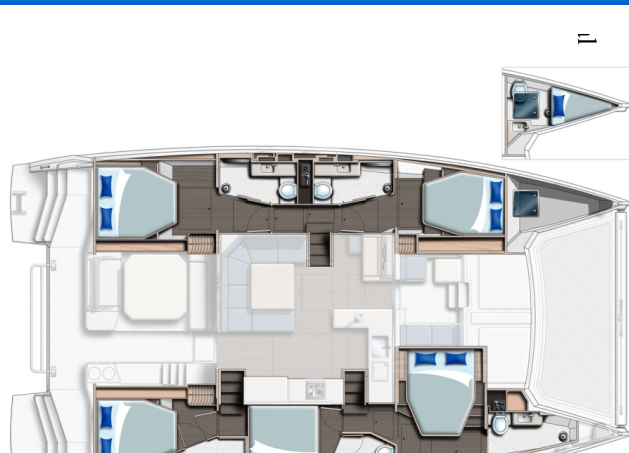

## YACHT SPECIFICATIONS

Yacht Base

**Sardinia, Cannigione, Italy**

Yacht ID

**8611**

Brands

**Leopard**

Yacht name

**Edoardo**

Production year

**2023**

Length

**51 ft**

Cabins

**5 + 1**

Berths

**10 + 2**

WC

**5**

Engine

**2 x 80 HP**

Fuel tank

**920 l**



**WEBSITE**

[www.plujeme.cz](http://www.plujeme.cz)



**PHONE**

+420 720 755 085



**MOBILE**

+420 777 170 276



**E-MAIL**

[info@plujeme.cz](mailto:info@plujeme.cz)



**PLUJEME RÁDI S.R.O.**

Dlouhá 730/35, 11000 Praha 1 – Staré Město, Czech Republic

## STANDARD YACHT EQUIPMENT

Comfort	<b>Pillows</b>
Deck	<b>Anchor with chain, Bilge pump - Mechanic, Boat hook, Bosun's chair (Safe seat) (boatswain's chair), Deck brush, Electric anchor windlass, Fenders, Flybridge, Fuel funnel, Gangway, Grill/Barbecue/Plancha, Hard Top Bimini, Mooring ropes, Outboard engine, Plastic bucket, Spare anchor (Reserve, Auxiliary anchor), Swimming ladder, Tender, Water hose, Winch handles</b>
Entertainment	<b>CD player, Fins, Outdoor speakers</b>
Galley	<b>Coffee machine, Gas bottles, Hot water, Kitchen utensils (Galley equipment, cutlery), Oven, Refrigerator, Stove</b>
Interior	<b>Barometer, Clock, Water Purifier</b>
Navigation	<b>Autopilot, Binoculars, Echosounder/Depthsounder, GPS chart plotter, Hand bearing compass, Log, Nautical charts, Pilot book, Radar reflector, Wind instrument/Anemometer</b>
Safety	<b>Buoyant smoke signal, Distress flare box, Emergency tiller, Fire extinguisher, First aid kit, Fog horn, Horseshoe lifebuoy, Life belts (Safety harness), Life jackets, Liferaft, Repair kit, Torch, VHF radio</b>
Sails	<b>Electric winch</b>
Yacht electrics	<b>Air Conditioning, Bilge pump - Electric, Generator, Inverter, Solar panels, Watermaker - desalinator</b>



**WEBSITE**  
[www.plujeme.cz](http://www.plujeme.cz)



**PHONE**  
+420 720 755 085



**MOBILE**  
+420 777 170 276



**E-MAIL**  
[info@plujeme.cz](mailto:info@plujeme.cz)



**PLUJEME RÁDI S.R.O.**  
Dlouhá 730/35, 11000 Praha 1 - Staré Město, Czech Republic

## SERVICES

SELECTED SERVICES	OBLIGATORY	PAYMENT TYPE	PRICE
<b>Airport transfer</b> (Payable at the base) <b>Season: 2026.</b> Olbia Airport - Cannigione Base, 1- 4 pax	No	one-way	<b>200,00 €</b>
<b>Airport transfer</b> (Payable at the base) <b>Season: 2026.</b> Olbia Airport - Cannigione Base, 5 - 8 pax	No	one-way	<b>250,00 €</b>
<b>Airport transfer</b> (Payable at the base) <b>Season: 2026.</b> Olbia Airport - Cannigione Base, 9 - 12 pax	No	one-way	<b>300,00 €</b>
<b>Chef</b> (Payable at the base) <b>Season: 2026.</b> must be confirmed at the time of booking	No	per week	<b>1.600,00 €</b>
<b>Damage waiver</b> (Payable at the base) <b>Season: 2026.</b> security deposit € 1050	No	per week	<b>1.015,00 €</b>
<b>Early boarding/check-in</b> (Payable at the base) <b>Season: 2026.</b> availability upon request, check in 15:00h	No	per booking	<b>445,00 €</b>
<b>Final cleaning with pets on board</b> (Payable at the base) <b>Season: 2026.</b>	No	per pet	<b>300,00 €</b>
<b>Hostess</b> (Payable at the base) <b>Season: 2026.</b> must be confirmed at the time of booking	No	per week	<b>1.600,00 €</b>
<b>Skipper</b> (Payable at the base) <b>Season: 2026.</b> must be confirmed at the time of booking	No	per week	<b>1.900,00 €</b>
<b>WI-FI Internet connection on boat</b> (Payable at the base) <b>Season: 2026.</b> 5GB - 5 connections (€100 deposit for the modem)	No	per week	<b>150,00 €</b>



**WEBSITE**

[www.plujeme.cz](http://www.plujeme.cz)



**PHONE**

+420 720 755 085



**MOBILE**

+420 777 170 276



**E-MAIL**

[info@plujeme.cz](mailto:info@plujeme.cz)



**PLUJEME RÁDI S.R.O.**

Dlouhá 730/35, 11000 Praha 1 – Staré Město, Czech Republic

## ADDITIONAL EXTRAS

EXTRA	OBLIGATORY	PAYMENT TYPE	PRICE
<b>Kayak</b> (Payable at the base) <b>Season: 2026.</b> One person, on availability at the base - Payable at the base	No	per week	<b>180,00 €</b>
<b>Railing net (Safety net)</b> (Payable at the base) <b>Season: 2026.</b> Payable at the base	No	per booking	<b>350,00 €</b>
<b>Stand up paddle (SUP)</b> (Payable at the base) <b>Season: 2026.</b> on availability at the base - Payable at the base	No	per week	<b>200,00 €</b>



#### WEBSITE

[www.plujeme.cz](http://www.plujeme.cz)



#### E-MAIL

[info@plujeme.cz](mailto:info@plujeme.cz)



#### PHONE

+420 720 755 085



#### MOBILE

+420 777 170 276



#### PLUJEME RÁDI S.R.O.

Dlouhá 730/35, 11000 Praha 1 – Staré Město, Czech Republic

## PRICE AND AVAILABILITY

02.05. - 09.05.2026 8.415 € 9.900 €	09.05. - 16.05.2026 8.415 € 9.900 €	16.05. - 23.05.2026 8.415 € 9.900 €	23.05. - 30.05.2026 8.415 € 9.900 €
30.05. - 06.06.2026 NOT AVAILABLE	06.06. - 13.06.2026 NOT AVAILABLE	13.06. - 20.06.2026 NOT AVAILABLE	20.06. - 27.06.2026 NOT AVAILABLE
27.06. - 04.07.2026 NOT AVAILABLE	04.07. - 11.07.2026 NOT AVAILABLE	11.07. - 18.07.2026 NOT AVAILABLE	18.07. - 25.07.2026 NOT AVAILABLE
25.07. - 01.08.2026 NOT AVAILABLE	01.08. - 15.08.2026 NOT AVAILABLE	15.08. - 22.08.2026 NOT AVAILABLE	22.08. - 29.08.2026 NOT AVAILABLE
29.08. - 05.09.2026 10.625 € 12.500 €	05.09. - 12.09.2026 NOT AVAILABLE	12.09. - 19.09.2026 NOT AVAILABLE	19.09. - 03.10.2026 NOT AVAILABLE
03.10. - 10.10.2026 8.415 € 9.900 €	10.10. - 17.10.2026 7.055 € 8.300 €	17.10. - 24.10.2026 7.055 € 8.300 €	24.10. - 31.10.2026 7.055 € 8.300 €
31.10. - 07.11.2026 7.055 € 8.300 €	07.11. - 14.11.2026 7.055 € 8.300 €	14.11. - 21.11.2026 7.055 € 8.300 €	21.11. - 28.11.2026 7.055 € 8.300 €
28.11. - 05.12.2026 8.300 €	05.12. - 12.12.2026 8.300 €	12.12. - 19.12.2026 8.300 €	19.12. - 26.12.2026 8.300 €



WEBSITE

[www.plujeme.cz](http://www.plujeme.cz)



E-MAIL

[info@plujeme.cz](mailto:info@plujeme.cz)



PHONE

+420 720 755 085



MOBILE

+420 777 170 276



PLUJEME RÁDI S.R.O.

Dlouhá 730/35, 11000 Praha 1 – Staré Město, Czech Republic