

# ELAN IMPRESSION 50

Vuschi (2017)

Sailing yacht **Elan Impression 50 Vuschi**, built in **2017** is anchored in the **Marina Punat, Krk, Kvarner, Croatia**. It has **5 cabins**, can accommodate **10 + 2 people** and has **2 toilets**. Bed linen and kitchen equipment are included in the price.

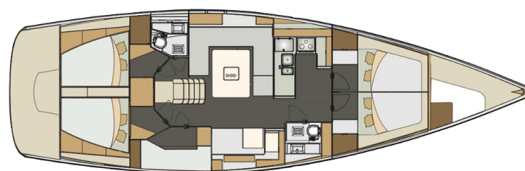

## YACHT SPECIFICATIONS

Yacht Base

**Marina Punat, Krk, Croatia**

Yacht ID

**847**

Brands

**Elan Marine**

Yacht name

**Vuschi**

Production year

**2017**

Length

**50 ft**

Cabins

**5**

Berths

**10 + 2**

WC

**2**

Engine

**1 x 0 HP**

Fuel tank

**0 l**



**WEBSITE**

[www.plujeme.cz](http://www.plujeme.cz)



**PHONE**

+420 720 755 085



**MOBILE**

+420 777 170 276



**E-MAIL**

[info@plujeme.cz](mailto:info@plujeme.cz)



**PLUJEME RÁDI S.R.O.**

Dlouhá 730/35, 11000 Praha 1 – Staré Město, Czech Republic

## STANDARD YACHT EQUIPMENT

Comfort	<b>Bed linen, Blankets, Pillows</b>
Deck	<b>Bimini top, Cockpit table, Cockpit/stern, outside shower, Dinghy, Electric anchor windlass, Sprayhood</b>
Entertainment	<b>Indoor speakers, Outdoor speakers, Radio, USB, Bluetooth</b>
Galley	<b>Gas bottles, Gas cookers, Hot water, Oven, Refrigerator, Sink</b>
Navigation	<b>Autopilot, Bow thruster, Compass, GPS chart plotter - cockpit, Navigation (Nautical) charts and nautical guide, Radar reflector, Wind instrument/Anemometer</b>
Safety	<b>Distress signals, Fire extinguisher, First aid kit, Life belts (Safety harness), Life jackets, VHF radio</b>
Yacht electrics	<b>Batteries, Shore power cable</b>



#### WEBSITE

[www.plujeme.cz](http://www.plujeme.cz)



#### E-MAIL

[info@plujeme.cz](mailto:info@plujeme.cz)



#### PHONE

+420 720 755 085



#### MOBILE

+420 777 170 276



#### PLUJEME RÁDI S.R.O.

Dlouhá 730/35, 11000 Praha 1 – Staré Město, Czech Republic

## SERVICES

SELECTED SERVICES	OBLIGATORY	PAYMENT TYPE	PRICE
<b>Transit log</b> (Payable at the base) <b>Season: 2026.</b> Includes: final cleaning, divers inspection on Friday 6 PM, bed linen for each crew member, made-up beds, Wi-Fi router up to 80GB/week, dinghy, cooking gas.	Yes	per booking	<b>320,00 €</b>
<b>Comfort pack</b> (Payable at the base) <b>Season: 2026.</b> outboard engine 2,5 HP, towels (set/2pcs)/person	No	per week	<b>150,00 €</b>
<b>Comfort pack PLUS</b> (Payable at the base) <b>Season: 2026.</b> outboard engine 2,5 HP, towels (set/2pcs)/person, early check-in at 14:00 h	No	per week	<b>290,00 €</b>
<b>Deposit insurance</b> (Payable at the base) <b>Season: 2026.</b> non-refundable + 300 EUR refundable The deposit insurance policy does not include damage to the sails, damages to or loss of inflatable boat and outboard engine. The security deposit as well as the deposit paid in case of its insurance covers only one damage.	No	per booking	<b>300,00 €</b>
<b>Early boarding/check-in</b> (Payable at the base) <b>Season: 2026.</b> at 02:00 PM	No	per booking	<b>200,00 €</b>
<b>Hostess</b> (Payable at the base) <b>Season: 2026.</b>	No	per day + food	<b>180,00 €</b>
<b>Late check out</b> (Payable at the base) <b>Season: 2026.</b>	No	per booking	<b>250,00 €</b>
<b>One way</b> (Payable at the base) <b>Season: 2026.</b> On request	No	one-way	<b>0,00 €</b>
<b>One way</b> (Payable at the base) <b>Season: 2026.</b> M.Lošinj-Primošten / Primošten-M.Lošinj	No	per booking	<b>950,00 €</b>
<b>One way</b> (Payable at the base) <b>Season: 2026.</b> Pula-Primošten / Primošten-Pula	No	one-way	<b>1.100,00 €</b>
<b>Pet on board</b> (Payable at the base) <b>Season: 2026.</b>	No	per booking	<b>200,00 €</b>

**Refuel service** (Payable at the base)

No

per service

**100,00 €**

**Season: 2026.**

**Skipper** (Payable at the base)

No

per day + food

**200,00 €**

**Season: 2026.**



**WEBSITE**

[www.plujeme.cz](http://www.plujeme.cz)



**PHONE**

+420 720 755 085



**MOBILE**

+420 777 170 276



**E-MAIL**

[info@plujeme.cz](mailto:info@plujeme.cz)



**PLUJEME RÁDI S.R.O.**

Dlouhá 730/35, 11000 Praha 1 – Staré Město, Czech Republic

## ADDITIONAL EXTRAS

EXTRA	OBLIGATORY	PAYMENT TYPE	PRICE
<b>e-SUP</b> (Payable at the base) <b>Season: 2026.</b> on request - Payable at the base	No	per week	<b>270,00 €</b>
<b>Extra bedlinen</b> (Payable at the base) <b>Season: 2026.</b> Payable at the base	No	per set	<b>10,00 €</b>
<b>Railing net (Safety net)</b> (Payable at the base) <b>Season: 2026.</b> without assembly - Payable at the base	No	per week	<b>30,00 €</b>
<b>Self inflating life vest</b> (Payable at the base) <b>Season: 2026.</b> Payable at the base	No	per week	<b>35,00 €</b>

**WEBSITE**[www.plujeme.cz](http://www.plujeme.cz)**E-MAIL**[info@plujeme.cz](mailto:info@plujeme.cz)**PHONE**

+420 720 755 085

**MOBILE**

+420 777 170 276

**PLUJEME RÁDI S.R.O.**

Dlouhá 730/35, 11000 Praha 1 – Staré Město, Czech Republic

## PRICE AND AVAILABILITY

25.04. - 02.05.2026 <b>1.365 €</b> 2.100 €	02.05. - 09.05.2026 <b>1.260 €</b> 2.100 €	09.05. - 16.05.2026 <b>1.495 €</b> 2.300 €	16.05. - 23.05.2026 NOT AVAILABLE
23.05. - 30.05.2026 NOT AVAILABLE	30.05. - 06.06.2026 NOT AVAILABLE	06.06. - 13.06.2026 <b>2.893 €</b> 4.450 €	13.06. - 20.06.2026 NOT AVAILABLE
20.06. - 27.06.2026 <b>3.115 €</b> 4.450 €	27.06. - 04.07.2026 <b>3.045 €</b> 4.350 €	04.07. - 11.07.2026 <b>3.638 €</b> 4.850 €	11.07. - 18.07.2026 <b>3.825 €</b> 5.100 €
18.07. - 25.07.2026 <b>4.335 €</b> 5.100 €	25.07. - 01.08.2026 <b>4.240 €</b> 5.300 €	01.08. - 08.08.2026 NOT AVAILABLE	08.08. - 15.08.2026 <b>3.788 €</b> 5.050 €
15.08. - 22.08.2026 <b>3.395 €</b> 4.850 €	22.08. - 29.08.2026 ON OPTION	29.08. - 05.09.2026 NOT AVAILABLE	05.09. - 12.09.2026 <b>3.910 €</b> 4.600 €
12.09. - 19.09.2026 <b>3.698 €</b> 4.350 €	19.09. - 26.09.2026 NOT AVAILABLE	26.09. - 03.10.2026 ON OPTION	03.10. - 10.10.2026 <b>1.650 €</b> 2.750 €
10.10. - 17.10.2026 <b>1.593 €</b> 2.450 €	17.10. - 24.10.2026 <b>1.593 €</b> 2.450 €	24.10. - 31.10.2026 <b>1.593 €</b> 2.450 €	31.10. - 07.11.2026 <b>1.500 €</b> 2.500 €
08.11. - 31.12.2026 NOT AVAILABLE			



WEBSITE

[www.plujeme.cz](http://www.plujeme.cz)



E-MAIL

[info@plujeme.cz](mailto:info@plujeme.cz)



PHONE

+420 720 755 085



MOBILE

+420 777 170 276



PLUJEME RÁDI S.R.O.

Dlouhá 730/35, 11000 Praha 1 – Staré Město, Czech Republic