

OCEANIS 48

LEVANZO (2018)

Sailing yacht Oceanis 48 LEVANZO, built in 2018 is anchored in the **Corfu, Gouvia Marina, Ionian Islands, Greece**. It has **5 cabins**, can accommodate **10 + 2 people** and has **3 toilets**. Bed linen and kitchen equipment are included in the price.

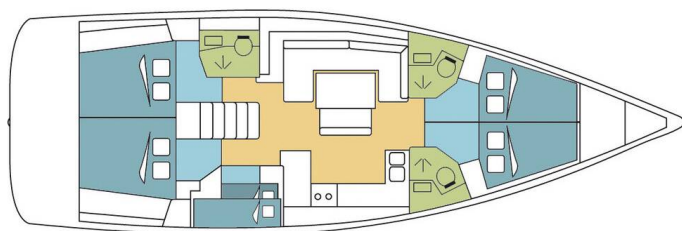

YACHT SPECIFICATIONS

Yacht Base

Corfu, Gouvia Marina, Greece

Yacht ID

8436

Brands

Beneteau

Yacht name

LEVANZO

Production year

2018

Length

48 ft

Cabins

5

Berths

10 + 2

Max Persons

10

WC

3

Engine

1 x 80 HP

Fuel tank

200 l



WEBSITE

www.plujeme.cz



PHONE

+420 720 755 085



MOBILE

+420 777 170 276



E-MAIL

info@plujeme.cz



PLUJEME RÁDI S.R.O.

Dlouhá 730/35, 11000 Praha 1 - Staré Město, Czech Republic

STANDARD YACHT EQUIPMENT

Comfort	Cockpit cushions
Deck	Bimini top, Cockpit table, Cockpit/stern, outside shower, Dinghy, Electric anchor windlass, Outboard engine, Sprayhood, Swimming ladder
Entertainment	Outdoor speakers
Galley	Hot water, Oven, Refrigerator, Stove
Interior	Convertible table, Convertible table in salon, Electric fans in cabins, Electric toilet
Navigation	Autopilot, Bow thruster, Depthsounder, GPS chart plotter, Speedometer (Speed log), Wind instrument/Anemometer
Safety	VHF radio
Sails	Lazy bag, Lazy jacks, Self tailing (manual) winch
Yacht electrics	Battery charger, Inverter, Plug 220V, 12 V, Shore connection 220 V



WEBSITE

www.plujeme.cz



PHONE

+420 720 755 085



MOBILE

+420 777 170 276



E-MAIL

info@plujeme.cz



PLUJEME RÁDI S.R.O.

Dlouhá 730/35, 11000 Praha 1 – Staré Město, Czech Republic

SERVICES

SELECTED SERVICES	OBLIGATORY	PAYMENT TYPE	PRICE
Handling fees (Payable now) Season: 2026.	Yes	per booking	20,00 €
Preparation fee (Payable now) Season: 2026. INCLUDED: starter pack – (1 gallon water or 4 bottles of 1.5L, 1 bottle of disinfectant, 1 small bottle of washing up liquid, 1 dish cloth, 1 sponge, garbage bags, 1 roll of paper towels, 1 box of matches, 1 roll of toilet paper in each head) // final cleaning // 1 set of bed sheets / cabin & 1 set of towels / pax, dinghy, outboard engine & initial supply of fuel, gas and water tanks // DYC assistance guarantee // 1st & last night in the marina // NOT INCLUDED: refuelling, gas & water consumption at end of charter, taxes if any, handling fees & additional equipment deposit.	Yes	per booking	335,00 €
Crew change (Payable now) Season: 2026. Any crew change during the charter is subject to € 250.- additional cost. The charge includes administration cost, change of bed linen and towels and one night at DYC ponton (marina fee included only if the same base than start base). It doesn't include cleaning, nor new transit log where applicable.	No	per booking	250,00 €
Damage waiver (Payable now) Season: 2026. Damage waiver limits your liability to the reduced Security Deposit . Mandatory when skipper is added. Price is per night of the charter (minimum value of 7 nights & a maximum value of 21 nights). Not applicable for 4+ weeks charters , nor Regattas/Races.	No	per night	50,00 €
Early boarding/check-in (Payable now) Season: 2026. EB (boat only) - 13:00h, starting time of boat's delivery // limited number of early boardings on same departure day	No	per booking	300,00 €
Early boarding/check-in (Payable now) Season: 2026. EB + extra fee skipper - 13:00h, starting time of boat's delivery // limited number of early boardings on same departure day	No	per booking	405,00 €
Early boarding/check-in (Payable now) Season: 2026. EB + extra fee Skipper & Hostess - 13:00h, starting time of boat's delivery // limited number of early boardings on same departure day	No	per booking	503,00 €

Electric & Water consumption in the Marinas (Payable at the base) Season: 2026. Electric & Water consumption based on 2 nights on our dock (base will confirm the amount to pay locally depending on nights spent on dock)	No	per booking	22,00 €
Extra cleaning (Payable now) Season: 2026. Optional Additional cleaning	No	per booking	260,00 €
Extra set of linen (choose how many) (Payable now) Season: 2026. Extra set of linen : 15 € 1 extra set of linen (2 sheets & 2 pillow case) - to be updated manually	No	per booking	15,00 €
Extra set of towels (choose how many) (Payable now) Season: 2026. Extra set of towels: 10 € 1 extra set of towels (1 face & 1 bath towel) - to be updated manually	No	per booking	10,00 €
Full board 1-4 pax (number of guests to update manually) (Payable now) Season: 2026. only available if cook is booked on board as the cook will do the provisioning based on client's preference. Includes breakfast, lunch & dinner + the crew's food. Does not included alcoholic drinks	No	per guest/day	60,00 €
Full board 5-12 pax (number of guests to update manually) (Payable now) Season: 2026. only available if cook is booked on board as the cook will do the provisioning based on client's preference. Includes breakfast, lunch & dinner + the crew's food. Does not included alcoholic drinks	No	per guest/day	55,00 €
Half board 1-4 pax (number of guests to update manually) (Payable now) Season: 2026. only available if cook is booked on board as the cook will do the provisioning based on client's preference. Includes breakfast & lunch OR dinner + the crew's food. Does not included alcoholic drinks	No	per guest/day	50,00 €
Half board 5-12 pax (number of guests to update manually) (Payable now) Season: 2026. only available if cook is booked on board as the cook will do the provisioning based on client's preference. Includes breakfast & lunch OR dinner + the crew's food. Does not included alcoholic drinks	No	per guest/day	45,00 €
Hostess/Cook (Payable now) Season: 2026. + provisioning, Crew on board must have their own toilets/showers. If either a skipper or a hostess/cook is on board, 1 double cabin will be required for him/her. If both a skipper and a hostess/cook are on board, 1 double cabin and 1 forepeak cabin will be required for them. Exceptions exists for specific layouts, Sales Agents will provide more details about the different boat models	No	per night	195,00 €

<p>Hostess/Cook (Payable now)</p> <p>Season: 2026. + provisioning, Crew on board must have their own toilets/showers. If either a skipper or a hostess/cook is on board, 1 double cabin will be required for him/her. If both a skipper and a hostess/cook are on board, 1 double cabin and 1 forepeak cabin will be required for them. Exceptions exists for specific layouts, Sales Agents will provide more details about the different boat models</p>	No	per night	195,00 €
<p>Hostess/Cook (Payable now)</p> <p>Season: 2026. + provisioning, Crew on board must have their own toilets/showers. If either a skipper or a hostess/cook is on board, 1 double cabin will be required for him/her. If both a skipper and a hostess/cook are on board, 1 double cabin and 1 forepeak cabin will be required for them. Exceptions exists for specific layouts, Sales Agents will provide more details about the different boat models</p>	No	per night	215,00 €
<p>Regatta surcharge (Payable now)</p> <p>Season: 2026. A special race deposit need to be doubled manually once the regatta surcharge is added.</p>	No	per booking	0,00 €
<p>Skipper (Payable now)</p> <p>Season: 2026. + provisioning, Crew on board must have their own toilets/showers. If either a skipper or a hostess/cook is on board, 1 double cabin will be required for him/her. If both a skipper and a hostess/cook are on board, 1 double cabin and 1 forepeak cabin will be required for them. Exceptions exists for specific layouts, Sales Agents will provide more details about the different boat models</p>	No	per night	210,00 €
<p>Skipper (Payable now)</p> <p>Season: 2026. + provisioning, Crew on board must have their own toilets/showers. If either a skipper or a hostess/cook is on board, 1 double cabin will be required for him/her. If both a skipper and a hostess/cook are on board, 1 double cabin and 1 forepeak cabin will be required for them. Exceptions exists for specific layouts, Sales Agents will provide more details about the different boat models</p>	No	per night	210,00 €
<p>Skipper (Payable now)</p> <p>Season: 2026. + provisioning, Crew on board must have their own toilets/showers. If either a skipper or a hostess/cook is on board, 1 double cabin will be required for him/her. If both a skipper and a hostess/cook are on board, 1 double cabin and 1 forepeak cabin will be required for them. Exceptions exists for specific layouts, Sales Agents will provide more details about the different boat models</p>	No	per night	230,00 €

Transfer (Payable now)	No	one-way	52,00 €
Season: 2026. OW - Airport / Base 1 to 5 Pax - For transfers during hours 20:00-07:00h and bank holidays price should be raised by 30€ one-way, or 60€ round trip			
Transfer (Payable now)	No	one-way	78,00 €
Season: 2026. OW - Airport / Base 6 to 8 pax - For transfers during hours 20:00-07:00h and bank holidays price should be raised by 30€ one-way, or 60€ round trip			
Transfer (Payable now)	No	one-way	85,00 €
Season: 2026. OW - Airport / Base 9 to 12 Pax - For transfers during hours 20:00-07:00h and bank holidays price should be raised by 30€ one-way, or 60€ round trip			
WI-FI Internet connection on boat (Payable now)	No	per week	50,00 €
Season: 2026. unlimited data			



WEBSITE

www.plujeme.cz



E-MAIL

info@plujeme.cz



PHONE

+420 720 755 085



MOBILE

+420 777 170 276



PLUJEME RÁDI S.R.O.

Dlouhá 730/35, 11000 Praha 1 – Staré Město, Czech Republic

ADDITIONAL EXTRAS

EXTRA	OBLIGATORY	PAYMENT TYPE	PRICE
Railing net (Safety net) (Payable now) <i>Season: 2026. net is supplied but not installed - Payable now</i>	No	per booking	230,00 €
Stand up paddle (SUP) (Payable now) <i>Season: 2026. Price per day - Payable now</i>	No	per night	15,00 €

**WEBSITE**

www.plujeme.cz

**E-MAIL**

info@plujeme.cz

**PHONE**

+420 720 755 085

**MOBILE**

+420 777 170 276

**PLUJEME RÁDI S.R.O.**

Dlouhá 730/35, 11000 Praha 1 – Staré Město, Czech Republic

PRICE AND AVAILABILITY

25.04. - 02.05.2026 NOT AVAILABLE	02.05. - 09.05.2026 1.750 € 1.845 €	09.05. - 16.05.2026 NOT AVAILABLE	16.05. - 23.05.2026 NOT AVAILABLE
23.05. - 30.05.2026 NOT AVAILABLE	30.05. - 06.06.2026 NOT AVAILABLE	06.06. - 13.06.2026 NOT AVAILABLE	13.06. - 20.06.2026 NOT AVAILABLE
20.06. - 27.06.2026 NOT AVAILABLE	27.06. - 04.07.2026 NOT AVAILABLE	04.07. - 11.07.2026 NOT AVAILABLE	11.07. - 18.07.2026 NOT AVAILABLE
18.07. - 25.07.2026 NOT AVAILABLE	25.07. - 01.08.2026 NOT AVAILABLE	01.08. - 08.08.2026 NOT AVAILABLE	08.08. - 15.08.2026 NOT AVAILABLE
15.08. - 22.08.2026 NOT AVAILABLE	22.08. - 29.08.2026 NOT AVAILABLE	29.08. - 05.09.2026 NOT AVAILABLE	05.09. - 12.09.2026 NOT AVAILABLE
12.09. - 19.09.2026 NOT AVAILABLE	19.09. - 26.09.2026 NOT AVAILABLE	26.09. - 03.10.2026 NOT AVAILABLE	03.10. - 17.10.2026 NOT AVAILABLE
17.10. - 24.10.2026 1.755 €	24.10. - 31.10.2026 1.431 € 1.590 €	31.10. - 07.11.2026 1.319 € 1.465 €	07.11. - 14.11.2026 1.319 € 1.465 €
20.11. - 12.03.2027 NOT AVAILABLE			



WEBSITE

www.plujeme.cz



E-MAIL

info@plujeme.cz



PHONE

+420 720 755 085



MOBILE

+420 777 170 276



PLUJEME RÁDI S.R.O.

Dlouhá 730/35, 11000 Praha 1 – Staré Město, Czech Republic

PRICE AND AVAILABILITY

13.03. - 20.03.2027 1.431 € 1.590 €	20.03. - 27.03.2027 1.431 € 1.590 €	27.03. - 03.04.2027 1.431 € 1.590 €	03.04. - 10.04.2027 1.431 € 1.590 €
10.04. - 17.04.2027 1.431 € 1.590 €	17.04. - 24.04.2027 1.431 € 1.590 €	24.04. - 01.05.2027 1.836 € 2.040 €	01.05. - 08.05.2027 1.836 € 2.040 €
08.05. - 15.05.2027 2.691 € 2.990 €	15.05. - 22.05.2027 2.858 € 3.175 €	22.05. - 29.05.2027 3.249 € 3.610 €	29.05. - 05.06.2027 3.627 € 4.030 €
05.06. - 12.06.2027 4.154 € 4.615 €	12.06. - 19.06.2027 ON OPTION	19.06. - 26.06.2027 4.676 € 5.195 €	26.06. - 03.07.2027 4.676 € 5.195 €
03.07. - 10.07.2027 4.779 € 5.310 €	10.07. - 17.07.2027 5.031 € 5.590 €	17.07. - 24.07.2027 5.297 € 5.885 €	24.07. - 31.07.2027 5.562 € 6.180 €
31.07. - 07.08.2027 5.841 € 6.490 €			



WEBSITE
www.plujeme.cz



E-MAIL
info@plujeme.cz



PHONE
+420 720 755 085



PLUJEME RÁDI S.R.O.
Dlouhá 730/35, 11000 Praha 1 – Staré Město, Czech Republic



MOBILE
+420 777 170 276

PRICE AND AVAILABILITY

07.08. - 14.08.2027 5.841 € 6.490 €	14.08. - 21.08.2027 5.562 € 6.180 €	21.08. - 28.08.2027 4.451 € 4.945 €	28.08. - 04.09.2027 4.320 € 4.800 €
04.09. - 11.09.2027 4.406 € 4.895 €	11.09. - 18.09.2027 4.176 € 4.640 €	18.09. - 25.09.2027 3.668 € 4.075 €	25.09. - 02.10.2027 2.763 € 3.070 €
02.10. - 09.10.2027 2.471 € 2.745 €	09.10. - 16.10.2027 1.737 € 1.930 €	16.10. - 23.10.2027 1.575 € 1.750 €	23.10. - 30.10.2027 1.449 € 1.610 €
30.10. - 06.11.2027 1.319 € 1.465 €	06.11. - 13.11.2027 1.319 € 1.465 €	13.11. - 20.11.2027 1.319 € 1.465 €	20.11. - 27.11.2027 1.319 € 1.465 €
27.11. - 04.12.2027 1.431 € 1.590 €	04.12. - 11.12.2027 1.431 € 1.590 €	11.12. - 18.12.2027 1.431 € 1.590 €	18.12. - 25.12.2027 1.431 € 1.590 €



WEBSITE

www.plujeme.cz



E-MAIL

info@plujeme.cz



PHONE

+420 720 755 085



MOBILE

+420 777 170 276



PLUJEME RÁDI S.R.O.

Dlouhá 730/35, 11000 Praha 1 – Staré Město, Czech Republic