

# OCEANIS 48

KORCULA (2018)

Sailing yacht Oceanis 48 KORCULA, built in 2018 is anchored in the **Kotor, Port of Kotor, Montenegro, Montenegro**. It has **5 cabins**, can accommodate **10 + 1 people** and has **3 toilets**. Bed linen and kitchen equipment are included in the price.

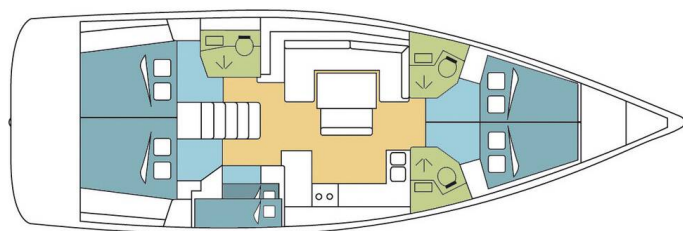

## YACHT SPECIFICATIONS

Yacht Base

**Kotor, Port of Kotor, Montenegro**

Yacht ID

**8432**

Brands

**Beneteau**

Yacht name

**KORCULA**

Production year

**2018**

Length

**48 ft**

Cabins

**5**

Berths

**10 + 1**

Max Persons

**11**

WC

**3**

Engine

**1 x 80 HP**

Fuel tank

**200 l**



**WEBSITE**

[www.plujeme.cz](http://www.plujeme.cz)



**PHONE**

+420 720 755 085



**MOBILE**

+420 777 170 276



**E-MAIL**

[info@plujeme.cz](mailto:info@plujeme.cz)



**PLUJEME RÁDI S.R.O.**

Dlouhá 730/35, 11000 Praha 1 – Staré Město, Czech Republic

## STANDARD YACHT EQUIPMENT

Comfort	<b>Cockpit cushions</b>
Deck	<b>Bimini top, Cockpit table, Cockpit/stern, outside shower, Dinghy, Electric anchor windlass, Outboard engine, Sprayhood, Swimming ladder</b>
Entertainment	<b>Outdoor speakers</b>
Galley	<b>Hot water, Oven, Refrigerator, Stove</b>
Interior	<b>Convertible table, Convertible table in salon, Electric fans in cabins, Electric toilet</b>
Navigation	<b>Autopilot, Bow thruster, Depthsounder, GPS chart plotter - cockpit, Speedometer (Speed log), Wind instrument/Anemometer</b>
Safety	<b>VHF radio</b>
Sails	<b>Lazy bag, Lazy jacks, Self tailing (manual) winch</b>
Yacht electrics	<b>Battery charger, Inverter, Plug 220V, 12 V</b>



**WEBSITE**

[www.plujeme.cz](http://www.plujeme.cz)



**PHONE**

+420 720 755 085



**MOBILE**

+420 777 170 276



**E-MAIL**

[info@plujeme.cz](mailto:info@plujeme.cz)



**PLUJEME RÁDI S.R.O.**

Dlouhá 730/35, 11000 Praha 1 – Staré Město, Czech Republic

## SERVICES

SELECTED SERVICES	OBLIGATORY	PAYMENT TYPE	PRICE
<b>Handling fees</b> (Payable now) <b>Season: 2026.</b>	Yes	per booking	<b>20,00 €</b>
<b>Local tax</b> (Payable at the base) <b>Season: 2026.</b> Mandatory tourist ID Cardboard / payment by cash only	Yes	per person	<b>1,00 €</b>
<b>Preparation fee</b> (Payable now) <b>Season: 2026.</b> INCLUDED: starter pack – (1 gallon water or 4 bottles of 1.5L, 1 bottle of disinfectant, 1 small bottle of washing up liquid, 1 dish cloth, 1 sponge, garbage bags, 1 roll of paper towels, 1 box of matches, 1 roll of toilet paper in each head) // final cleaning // 1 set of bed sheets / cabin & 1 set of towels / pax, dinghy, outboard engine & initial supply of fuel, gas and water tanks // DYC assistance guarantee // 1st & last night in the marina // NOT INCLUDED: refuelling, gas & water consumption at end of charter, taxes if any, handling fees & additional equipment deposit.	Yes	per booking	<b>335,00 €</b>
<b>Tourist tax</b> (Payable at the base) <b>Season: 2026.</b> Mandatory tourist tax Montenegro / payment by cash only	Yes	per guest/day	<b>0,90 €</b>
<b>Transit log</b> (Payable now) <b>Season: 2026.</b>	Yes	per booking	<b>100,00 €</b>
<b>Crew change</b> (Payable now) <b>Season: 2026.</b> Any crew change during the charter is subject to € 250.- additional cost. The charge includes administration cost, change of bed linen and towels and one night at DYC ponton (marina fee included only if the same base than start base). It doesn't include cleaning, nor new transit log where applicable.	No	per booking	<b>250,00 €</b>
<b>Damage waiver</b> (Payable now) <b>Season: 2026.</b> Damage waiver limits your liability to the reduced Security Deposit . Mandatory when skipper is added. Price is per night of the charter ( minimum value of 7 nights & a maximum value of 21 nights). Not applicable for 4+ weeks charters , nor Regattas/Races.	No	per night	<b>50,00 €</b>
<b>Early boarding/check-in</b> (Payable now) <b>Season: 2026.</b> EB (boat only) - 13:00h, starting time of boat's delivery // limited number of early boardings on same departure day	No	per booking	<b>300,00 €</b>

<b>Early boarding/check-in</b> (Payable now)	No	per booking	<b>388,00 €</b>
<b>Season: 2026.</b> EB + extra fee skipper - 13:00h, starting time of boat's delivery // limited number of early boardings on same departure day			
<b>Early boarding/check-in</b> (Payable now)	No	per booking	<b>468,00 €</b>
<b>Season: 2026.</b> EB + extra fee Skipper & Hostess - 13:00h, starting time of boat's delivery // limited number of early boardings on same departure day			
<b>Electric &amp; Water consumption in the Marinas</b> (Payable at the base)	No	per booking	<b>22,00 €</b>
<b>Season: 2026.</b> Electric & Water consumption based on 2 nights on our dock (base will confirm the amount to pay locally depending on nights spent on dock)			
<b>Extra cleaning</b> (Payable now)	No	per booking	<b>260,00 €</b>
<b>Season: 2026.</b> Optional Additional cleaning			
<b>Extra set of linen (choose how many)</b> (Payable now)	No	per booking	<b>15,00 €</b>
<b>Season: 2026.</b> Extra set of linen : 15 € 1 extra set of linen (2 sheets & 2 pillow case) - to be updated manually			
<b>Extra set of towels (choose how many)</b> (Payable now)	No	per booking	<b>10,00 €</b>
<b>Season: 2026.</b> Extra set of towels: 10 € 1 extra set of towels (1 face & 1 bath towel) - to be updated manually			
<b>Full board 1-4 pax (number of guests to update manually)</b> (Payable now)	No	per guest/day	<b>60,00 €</b>
<b>Season: 2026.</b> only available if cook is booked on board as the cook will do the provisioning based on client's preference. Includes breakfast, lunch & dinner + the crew's food. Does not included alcoholic drinks			
<b>Full board 5-12 pax (number of guests to update manually)</b> (Payable now)	No	per guest/day	<b>55,00 €</b>
<b>Season: 2026.</b> only available if cook is booked on board as the cook will do the provisioning based on client's preference. Includes breakfast, lunch & dinner + the crew's food. Does not included alcoholic drinks			
<b>Half board 1-4 pax (number of guests to update manually)</b> (Payable now)	No	per guest/day	<b>50,00 €</b>
<b>Season: 2026.</b> only available if cook is booked on board as the cook will do the provisioning based on client's preference. Includes breakfast & lunch OR dinner + the crew's food. Does not included alcoholic drinks			
<b>Half board 5-12 pax (number of guests to update manually)</b> (Payable now)	No	per guest/day	<b>45,00 €</b>
<b>Season: 2026.</b> only available if cook is booked on board as the cook will do the provisioning based on client's preference. Includes breakfast & lunch OR dinner + the crew's food. Does not included alcoholic drinks			

<p><b>Hostess/Cook</b> (Payable now)</p> <p><b>Season: 2026.</b> + provisioning, Crew on board must have their own toilets/showers. If either a skipper or a hostess/cook is on board, 1 double cabin will be required for him/her. If both a skipper and a hostess/cook are on board, 1 double cabin and 1 forepeak cabin will be required for them. Exceptions exists for specific layouts, Sales Agents will provide more details about the different boat models</p>	No	per night	<b>160,00 €</b>
<p><b>Hostess/Cook</b> (Payable now)</p> <p><b>Season: 2026.</b> + provisioning, Crew on board must have their own toilets/showers. If either a skipper or a hostess/cook is on board, 1 double cabin will be required for him/her. If both a skipper and a hostess/cook are on board, 1 double cabin and 1 forepeak cabin will be required for them. Exceptions exists for specific layouts, Sales Agents will provide more details about the different boat models</p>	No	per night	<b>160,00 €</b>
<p><b>Hostess/Cook</b> (Payable now)</p> <p><b>Season: 2026.</b> + provisioning, Crew on board must have their own toilets/showers. If either a skipper or a hostess/cook is on board, 1 double cabin will be required for him/her. If both a skipper and a hostess/cook are on board, 1 double cabin and 1 forepeak cabin will be required for them. Exceptions exists for specific layouts, Sales Agents will provide more details about the different boat models</p>	No	per night	<b>175,00 €</b>
<p><b>Regatta surcharge</b> (Payable now)</p> <p><b>Season: 2026.</b> A special race deposit need to be doubled manually once the regatta surcharge is added.</p>	No	per booking	<b>0,00 €</b>
<p><b>Skipper</b> (Payable now)</p> <p><b>Season: 2026.</b> + provisioning, Crew on board must have their own toilets/showers. If either a skipper or a hostess/cook is on board, 1 double cabin will be required for him/her. If both a skipper and a hostess/cook are on board, 1 double cabin and 1 forepeak cabin will be required for them. Exceptions exists for specific layouts, Sales Agents will provide more details about the different boat models</p>	No	per night	<b>175,00 €</b>
<p><b>Skipper</b> (Payable now)</p> <p><b>Season: 2026.</b> + provisioning, Crew on board must have their own toilets/showers. If either a skipper or a hostess/cook is on board, 1 double cabin will be required for him/her. If both a skipper and a hostess/cook are on board, 1 double cabin and 1 forepeak cabin will be required for them. Exceptions exists for specific layouts, Sales Agents will provide more details about the different boat models</p>	No	per night	<b>175,00 €</b>

<b>Skipper</b> (Payable now)	No	per night	<b>195,00 €</b>
<b>Season: 2026.</b> + provisioning, Crew on board must have their own toilets/showers. If either a skipper or a hostess/cook is on board, 1 double cabin will be required for him/her. If both a skipper and a hostess/cook are on board, 1 double cabin and 1 forepeak cabin will be required for them. Exceptions exists for specific layouts, Sales Agents will provide more details about the different boat models			
<b>Transfer</b> (Payable now)	No	one-way	<b>90,00 €</b>
<b>Season: 2026.</b> OW - Airport Tivat – Kotor base 1-8 pax			
<b>Transfer</b> (Payable now)	No	round trip	<b>180,00 €</b>
<b>Season: 2026.</b> RT - Airport Tivat – Kotor base 1-8 pax			
<b>Transfer</b> (Payable now)	No	one-way	<b>200,00 €</b>
<b>Season: 2026.</b> OW - Airport Podgorica – Kotor base 1-8 pax			
<b>Transfer</b> (Payable now)	No	one-way	<b>280,00 €</b>
<b>Season: 2026.</b> OW - Airport Dubrovnik – Kotor base 1-8 pax			
<b>Transfer</b> (Payable now)	No	round trip	<b>400,00 €</b>
<b>Season: 2026.</b> RT - Airport Podgorica – Kotor base 1-8 pax			
<b>Transfer</b> (Payable now)	No	round trip	<b>560,00 €</b>
<b>Season: 2026.</b> RT - Airport Dubrovnik – Kotor base 1-8 pax			
<b>WI-FI Internet connection on boat</b> (Payable now)	No	per week	<b>30,00 €</b>
<b>Season: 2026.</b>			



**WEBSITE**

[www.plujeme.cz](http://www.plujeme.cz)



**E-MAIL**

[info@plujeme.cz](mailto:info@plujeme.cz)



**PHONE**

+420 720 755 085



**MOBILE**

+420 777 170 276



**PLUJEME RÁDI S.R.O.**

Dlouhá 730/35, 11000 Praha 1 – Staré Město, Czech Republic

## ADDITIONAL EXTRAS

EXTRA	OBLIGATORY	PAYMENT TYPE	PRICE
<b>Kayak single</b> (Payable now) <b>Season: 2026.</b> Price per day - Payable now	No	per night	<b>15,00 €</b>
<b>Railing net (Safety net)</b> (Payable now) <b>Season: 2026.</b> net is supplied but not installed - Payable now	No	per booking	<b>230,00 €</b>
<b>Stand up paddle (SUP)</b> (Payable now) <b>Season: 2026.</b> Price per day - Payable now	No	per night	<b>15,00 €</b>



### WEBSITE

[www.plujeme.cz](http://www.plujeme.cz)



### E-MAIL

[info@plujeme.cz](mailto:info@plujeme.cz)



### PHONE

+420 720 755 085



### MOBILE

+420 777 170 276



### PLUJEME RÁDI S.R.O.

Dlouhá 730/35, 11000 Praha 1 – Staré Město, Czech Republic

## PRICE AND AVAILABILITY

25.04. - 02.05.2026 <b>1.200 €</b> 1.630 €	02.05. - 09.05.2026 NOT AVAILABLE	09.05. - 16.05.2026 NOT AVAILABLE	16.05. - 23.05.2026 NOT AVAILABLE
23.05. - 30.05.2026 NOT AVAILABLE	30.05. - 06.06.2026 NOT AVAILABLE	06.06. - 13.06.2026 <b>4.110 €</b>	13.06. - 20.06.2026 NOT AVAILABLE
20.06. - 27.06.2026 NOT AVAILABLE	27.06. - 04.07.2026 <b>3.575 €</b>	04.07. - 11.07.2026 <b>3.005 €</b> 3.535 €	11.07. - 18.07.2026 NOT AVAILABLE
18.07. - 25.07.2026 <b>3.689 €</b> 4.340 €	25.07. - 01.08.2026 <b>3.668 €</b> 4.315 €	01.08. - 08.08.2026 <b>3.893 €</b> 4.580 €	08.08. - 15.08.2026 <b>3.681 €</b> 4.330 €
15.08. - 22.08.2026 <b>3.749 €</b> 4.410 €	22.08. - 05.09.2026 NOT AVAILABLE	05.09. - 12.09.2026 <b>4.220 €</b>	12.09. - 19.09.2026 NOT AVAILABLE
19.09. - 26.09.2026 <b>3.690 €</b>	26.09. - 03.10.2026 <b>3.060 €</b>	03.10. - 10.10.2026 <b>2.495 €</b>	10.10. - 17.10.2026 <b>2.090 €</b>
17.10. - 24.10.2026 <b>1.590 €</b>	24.10. - 31.10.2026 <b>1.431 €</b> 1.590 €	31.10. - 07.11.2026 <b>1.431 €</b> 1.590 €	07.11. - 14.11.2026 <b>1.431 €</b> 1.590 €
20.11. - 12.03.2027 NOT AVAILABLE			



WEBSITE

[www.plujeme.cz](http://www.plujeme.cz)



E-MAIL

[info@plujeme.cz](mailto:info@plujeme.cz)



PHONE

+420 720 755 085



MOBILE

+420 777 170 276



PLUJEME RÁDI S.R.O.

Dlouhá 730/35, 11000 Praha 1 – Staré Město, Czech Republic

## PRICE AND AVAILABILITY

13.03. - 20.03.2027 <b>1.431 €</b> 1.590 €	20.03. - 27.03.2027 <b>1.431 €</b> 1.590 €	27.03. - 03.04.2027 <b>1.431 €</b> 1.590 €	03.04. - 10.04.2027 <b>1.431 €</b> 1.590 €
10.04. - 17.04.2027 <b>1.431 €</b> 1.590 €	17.04. - 24.04.2027 <b>1.431 €</b> 1.590 €	24.04. - 01.05.2027 <b>1.575 €</b> 1.750 €	01.05. - 08.05.2027 <b>1.575 €</b> 1.750 €
08.05. - 15.05.2027 <b>2.066 €</b> 2.295 €	15.05. - 22.05.2027 <b>2.493 €</b> 2.770 €	22.05. - 29.05.2027 <b>2.637 €</b> 2.930 €	29.05. - 05.06.2027 <b>2.952 €</b> 3.280 €
05.06. - 12.06.2027 <b>3.587 €</b> 3.985 €	12.06. - 19.06.2027 <b>3.204 €</b> 3.560 €	19.06. - 26.06.2027 <b>3.551 €</b> 3.945 €	26.06. - 03.07.2027 <b>3.924 €</b> 4.360 €
03.07. - 10.07.2027 <b>4.154 €</b> 4.615 €	10.07. - 17.07.2027 <b>4.613 €</b> 5.125 €	17.07. - 24.07.2027 <b>4.613 €</b> 5.125 €	24.07. - 31.07.2027 <b>4.842 €</b> 5.380 €
31.07. - 07.08.2027 <b>5.090 €</b> 5.655 €			



**WEBSITE**  
[www.plujeme.cz](http://www.plujeme.cz)



**E-MAIL**  
[info@plujeme.cz](mailto:info@plujeme.cz)



**PHONE**  
+420 720 755 085



**MOBILE**  
+420 777 170 276



**PLUJEME RÁDI S.R.O.**  
Dlouhá 730/35, 11000 Praha 1 – Staré Město, Czech Republic

## PRICE AND AVAILABILITY

07.08. - 14.08.2027 <b>5.090 €</b> 5.655 €	14.08. - 21.08.2027 <b>4.842 €</b> 5.380 €	21.08. - 28.08.2027 <b>4.046 €</b> 4.495 €	28.08. - 04.09.2027 <b>3.488 €</b> 3.875 €
04.09. - 11.09.2027 <b>3.438 €</b> 3.820 €	11.09. - 18.09.2027 <b>3.438 €</b> 3.820 €	18.09. - 25.09.2027 <b>3.164 €</b> 3.515 €	25.09. - 02.10.2027 <b>2.777 €</b> 3.085 €
02.10. - 09.10.2027 <b>2.061 €</b> 2.290 €	09.10. - 16.10.2027 <b>1.791 €</b> 1.990 €	16.10. - 23.10.2027 <b>1.431 €</b> 1.590 €	23.10. - 30.10.2027 <b>1.431 €</b> 1.590 €
30.10. - 06.11.2027 <b>1.431 €</b> 1.590 €	06.11. - 13.11.2027 <b>1.431 €</b> 1.590 €	13.11. - 20.11.2027 <b>1.431 €</b> 1.590 €	20.11. - 27.11.2027 <b>1.431 €</b> 1.590 €
27.11. - 04.12.2027 <b>1.431 €</b> 1.590 €	04.12. - 11.12.2027 <b>1.431 €</b> 1.590 €	11.12. - 18.12.2027 <b>1.431 €</b> 1.590 €	18.12. - 25.12.2027 <b>1.431 €</b> 1.590 €



WEBSITE

[www.plujeme.cz](http://www.plujeme.cz)



E-MAIL

[info@plujeme.cz](mailto:info@plujeme.cz)



PHONE

+420 720 755 085



MOBILE

+420 777 170 276



PLUJEME RÁDI S.R.O.

Dlouhá 730/35, 11000 Praha 1 – Staré Město, Czech Republic