

# FOUNTAIN PAJOT SABA 50

Serenata (2020)

Catamaran Fountaine Pajot Saba 50 Serenata, built in 2020 is anchored in the **BVI, Tortola, Ritter House Marina, British Virgin Islands, British Virgin Islands**. It has **6 + 2 cabins**, can accommodate **11 + 1 + 2 people** and has **6 toilets**. Bed linen and kitchen equipment are included in the price.

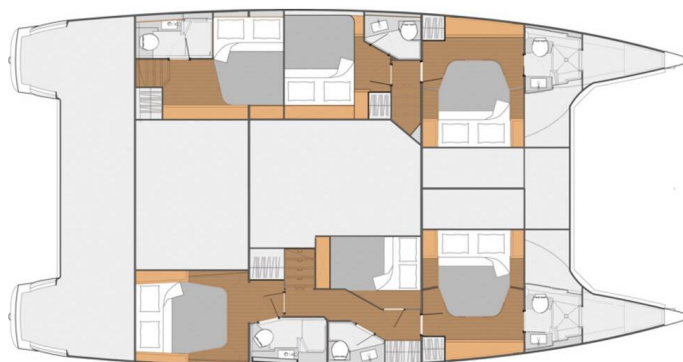

## YACHT SPECIFICATIONS

Yacht Base

**BVI, Tortola, Ritter House Marina,  
British Virgin Islands**

Yacht ID

**8375**

Brands

**Fountaine Pajot**

Yacht name

**Serenata**

Production year

**2020**

Length

**49 ft**

Cabins

**6 + 2**

Berths

**11 + 1 + 2**

Max Persons

**12**

WC

**6**

Engine

**2 x 75 HP**

Fuel tank

**938 l**



**WEBSITE**

[www.plujeme.cz](http://www.plujeme.cz)



**PHONE**

+420 720 755 085



**MOBILE**

+420 777 170 276



**E-MAIL**

[info@plujeme.cz](mailto:info@plujeme.cz)



**PLUJEME RÁDI S.R.O.**

Dlouhá 730/35, 11000 Praha 1 – Staré Město, Czech Republic

## STANDARD YACHT EQUIPMENT

Deck	<b>Grill/Barbecue/Plancha</b>
Entertainment	<b>Underwater lights</b>
Interior	<b>Electric toilet</b>
Navigation	<b>Helm station</b>
Yacht electrics	<b>Air Conditioning, Generator</b>



**WEBSITE**

[www.plujeme.cz](http://www.plujeme.cz)



**E-MAIL**

[info@plujeme.cz](mailto:info@plujeme.cz)



**PHONE**

+420 720 755 085



**MOBILE**

+420 777 170 276



**PLUJEME RÁDI S.R.O.**

Dlouhá 730/35, 11000 Praha 1 – Staré Město, Czech Republic

## SERVICES

SELECTED SERVICES	OBLIGATORY	PAYMENT TYPE	PRICE
<b>Cruising tax</b> (Payable now) <b>Season: 2026.</b>	Yes	per guest/day	<b>4,00 €</b>
<b>National parks permit</b> (Payable now) <b>Season: 2026.</b> \$25 for 4 pax, \$35 for 6 pax, \$45 for 8 pax, \$55 for 10 pax	Yes	per booking	<b>25,00 €</b>
<b>Outboard fuel &amp; Gas</b> (Payable now) <b>Season: 2026.</b> For Dinghy	Yes	per booking	<b>20,00 €</b>
<b>Visar</b> (Payable now) <b>Season: 2026.</b>	Yes	per booking	<b>20,00 €</b>
<b>Yacht Insurance</b> (Payable now) <b>Season: 2026.</b> (Minimum \$250 / Maximum \$500)	Yes	per day	<b>50,00 €</b>
<b>Cancellation insurance</b> (Payable now) <b>Season: 2026.</b> Optional and due with deposit at the time of booking	No	per booking	<b>200,00 €</b>
<b>Captain</b> (Payable now) <b>Season: 2026.</b> + Gratuity	No	per day + food	<b>300,00 €</b>
<b>Cell phone</b> (Payable now) <b>Season: 2026.</b>	No	per booking	<b>10,00 €</b>
<b>Chef</b> (Payable now) <b>Season: 2026.</b> + Gratuity	No	per day + food	<b>300,00 €</b>
<b>Credit card payments 3% surcharge</b> (Payable now) <b>Season: 2026.</b> For both: Deposit and for Final Payment	No	per booking	<b>0,00 €</b>
<b>Day Checkout Captain</b> (Payable now) <b>Season: 2026.</b>	No	per booking	<b>250,00 €</b>
<b>Fishing licence</b> (Payable now) <b>Season: 2026.</b> flat fee, per person that wants one.	No	per person	<b>65,00 €</b>
<b>Fuel consumption</b> (Payable now) <b>Season: 2026.</b>	No	per service	<b>0,00 €</b>

<b>Ice</b> (Payable now) <b>Season: 2026.</b> (\$6 per bag)	No	per pack	<b>6,00 €</b>
<b>Sailing Instructor</b> (Payable now) <b>Season: 2026.</b> + Gratuity	No	per day + food	<b>350,00 €</b>
<b>Sleep over before check in</b> (Payable now) <b>Season: 2026.</b> From 5pm	No	per person	<b>75,00 €</b>
<b>Turn around</b> (Payable now) <b>Season: 2026.</b> an additional \$50 each night less than 7	No	per night	<b>50,00 €</b>
<b>WI-FI Internet connection on boat</b> (Payable now) <b>Season: 2026.</b>	No	per day	<b>30,00 €</b>



**WEBSITE**  
www.plujeme.cz



**E-MAIL**  
info@plujeme.cz



**PHONE**  
+420 720 755 085



**MOBILE**  
+420 777 170 276



**PLUJEME RÁDI S.R.O.**  
Dlouhá 730/35, 11000 Praha 1 – Staré Město, Czech Republic

## ADDITIONAL EXTRAS

EXTRA	OBLIGATORY	PAYMENT TYPE	PRICE
<b>Additional gas bottle</b> (Payable now) <i>Season: 2026. propane gas tank for the BBQ grill - Payable now</i>	No	per booking	<b>10,50 €</b>
<b>Aquapad</b> (Payable now) <i>Season: 2026. 6ft x 12ft - Payable now</i>	No	per piece	<b>100,00 €</b>
<b>Beach canopy</b> (Payable now) <i>Season: 2026. Payable now</i>	No	per booking	<b>35,00 €</b>
<b>Beach chair</b> (Payable now) <i>Season: 2026. Payable now</i>	No	per piece	<b>25,00 €</b>
<b>Beach umbrella</b> (Payable now) <i>Season: 2026. Payable now</i>	No	per booking	<b>25,00 €</b>
<b>Bean Bag Chair</b> (Payable now) <i>Season: 2026. Payable now</i>	No	per booking	<b>75,00 €</b>
<b>Caps</b> (Payable now) <i>Season: 2026. Payable now</i>	No	per booking	<b>20,00 €</b>
<b>Dinghy ladder</b> (Payable now) <i>Season: 2026. Payable now</i>	No	per piece	<b>50,00 €</b>
<b>Electric winch</b> (Payable now) <i>Season: 2026. Payable now</i>	No	per booking	<b>100,00 €</b>
<b>Fishing casting package</b> (Payable now) <i>Season: 2026. Payable now</i>	No	per day	<b>12,00 €</b>
<b>Fishing Gaff</b> (Payable now) <i>Season: 2026. Payable now</i>	No	per booking	<b>25,00 €</b>
<b>Fishing trolling package</b> (Payable now) <i>Season: 2026. Payable now</i>	No	per day	<b>17,00 €</b>
<b>Floating mats</b> (Payable now) <i>Season: 2026. Payable now</i>	No	per piece	<b>22,00 €</b>

<b>Guitar</b> (Payable now) <b>Season: 2026.</b> Payable now	No	per piece	<b>100,00 €</b>
<b>Hammock</b> (Payable now) <b>Season: 2026.</b> Payable now	No	per booking	<b>25,00 €</b>
<b>Kayak</b> (Payable now) <b>Season: 2026.</b> Single Kayak - Payable now	No	per day	<b>25,00 €</b>
<b>Kayak tandem</b> (Payable now) <b>Season: 2026.</b> Double Kayak - Payable now	No	per day	<b>27,00 €</b>
<b>Lazybunz</b> (Payable now) <b>Season: 2026.</b> Payable now	No	per piece	<b>20,00 €</b>
<b>Modular Stack Matt</b> (Payable now) <b>Season: 2026.</b> 6ft x 12ft; Additional 'Stacks' + 25\$ per booking - Payable now	No	per booking	<b>150,00 €</b>
<b>Noodles</b> (Payable now) <b>Season: 2026.</b> Payable now	No	per piece	<b>4,00 €</b>
<b>Rash Guards</b> (Payable now) <b>Season: 2026.</b> Men, Women or Kid Rash guards - Payable now	No	per piece	<b>30,00 €</b>
<b>RIB</b> (Payable now) <b>Season: 2026.</b> Highfield CL 360 RIB (12' 18HP) - Payable now	No	per booking	<b>500,00 €</b>
<b>Snorkeling Vests</b> (Payable now) <b>Season: 2026.</b> Payable now	No	per week	<b>10,00 €</b>
<b>Stand up paddle (SUP)</b> (Payable now) <b>Season: 2026.</b> Epoxy or Inflatable - Payable now	No	per day	<b>27,00 €</b>
<b>Straw hat</b> (Payable now) <b>Season: 2026.</b> Payable now	No	per piece	<b>40,00 €</b>
<b>Sunchill floats</b> (Payable now) <b>Season: 2026.</b> Payable now	No	per booking	<b>135,00 €</b>
<b>Surf board</b> (Payable now) <b>Season: 2026.</b> Payable now	No	per booking	<b>22,00 €</b>
<b>T-shirts</b> (Payable now) <b>Season: 2026.</b> Men or Women T-Shirts - Payable now	No	per piece	<b>25,00 €</b>

**Windsurf** (Payable now)

No

per day

**45,00 €**

**Season: 2026.** Payable now



**WEBSITE**

[www.plujeme.cz](http://www.plujeme.cz)



**E-MAIL**

[info@plujeme.cz](mailto:info@plujeme.cz)



**PHONE**

+420 720 755 085



**MOBILE**

+420 777 170 276



**PLUJEME RÁDI S.R.O.**

Dlouhá 730/35, 11000 Praha 1 – Staré Město, Czech Republic

## PRICE AND AVAILABILITY

<b>02.05. - 09.05.2026</b> NOT AVAILABLE	<b>14.05. - 24.05.2026</b> NOT AVAILABLE	<b>24.05. - 02.06.2026</b> NOT AVAILABLE	<b>06.06. - 15.06.2026</b> NOT AVAILABLE
<b>19.06. - 29.06.2026</b> NOT AVAILABLE	<b>01.07. - 10.07.2026</b> NOT AVAILABLE	<b>11.07. - 18.07.2026</b> <b>9.446 €</b>	<b>18.07. - 30.07.2026</b> NOT AVAILABLE
<b>01.08. - 15.10.2026</b> NOT AVAILABLE	<b>17.10. - 24.10.2026</b> <b>9.375 €</b>	<b>24.10. - 31.10.2026</b> <b>9.375 €</b>	<b>31.10. - 07.11.2026</b> <b>9.497 €</b>
<b>10.11. - 20.11.2026</b> NOT AVAILABLE	<b>21.11. - 28.11.2026</b> <b>10.228 €</b>	<b>28.11. - 05.12.2026</b> <b>10.228 €</b>	



### WEBSITE

[www.plujeme.cz](http://www.plujeme.cz)



### E-MAIL

[info@plujeme.cz](mailto:info@plujeme.cz)



### PHONE

+420 720 755 085



### MOBILE

+420 777 170 276



### PLUJEME RÁDI S.R.O.

Dlouhá 730/35, 11000 Praha 1 – Staré Město, Czech Republic

## PRICE AND AVAILABILITY

05.12. - 12.12.2026 10.228 €	12.12. - 19.12.2026 10.958 €	19.12. - 26.12.2026 11.870 €	26.12. - 05.01.2027 NOT AVAILABLE
09.01. - 16.01.2027 13.637 €	16.01. - 23.01.2027 13.637 €	23.01. - 30.01.2027 13.637 €	30.01. - 06.02.2027 14.246 €
06.02. - 13.02.2027 14.489 €	13.02. - 20.02.2027 14.489 €	20.02. - 27.02.2027 14.489 €	27.02. - 06.03.2027 14.489 €
06.03. - 13.03.2027 14.489 €	13.03. - 20.03.2027 14.489 €	20.03. - 27.03.2027 14.489 €	27.03. - 03.04.2027 14.246 €
03.04. - 10.04.2027 13.637 €	10.04. - 17.04.2027 13.637 €	17.04. - 24.04.2027 13.637 €	24.04. - 01.05.2027 13.637 €
01.05. - 08.05.2027 12.784 €	08.05. - 15.05.2027 12.784 €	15.05. - 22.05.2027 12.784 €	22.05. - 29.05.2027 12.784 €
01.06. - 15.10.2099 NOT AVAILABLE			



### WEBSITE

[www.plujeme.cz](http://www.plujeme.cz)



### E-MAIL

[info@plujeme.cz](mailto:info@plujeme.cz)



### PHONE

+420 720 755 085



### MOBILE

+420 777 170 276



### PLUJEME RÁDI S.R.O.

Dlouhá 730/35, 11000 Praha 1 – Staré Město, Czech Republic