

# OCEANIS 51.1

Elise (2020)

Sailing yacht Oceanis 51.1 Elise, built in 2020 is anchored in the Lefkas, D-Marin, Ionian Islands, Greece. It has 5 + 1 cabins, can accommodate 10 + 2 people and has 3 + 1 toilets. Bed linen and kitchen equipment are included in the price.

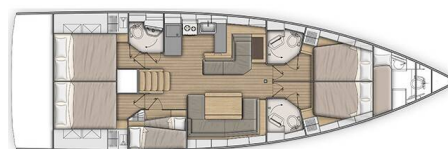

## YACHT SPECIFICATIONS

Yacht Base

**Lefkas, D-Marin, Greece**

Yacht ID

**8368**

Brands

**Beneteau**

Yacht name

**Elise**

Production year

**2020**

Length

**52 ft**

Cabins

**5 + 1**

Berths

**10 + 2**

WC

**3 + 1**

Engine

**1 x 80 HP**

Fuel tank

**200 l**



**WEBSITE**

[www.plujeme.cz](http://www.plujeme.cz)



**PHONE**

+420 720 755 085



**MOBILE**

+420 777 170 276



**E-MAIL**

[info@plujeme.cz](mailto:info@plujeme.cz)



**PLUJEME RÁDI S.R.O.**

Dlouhá 730/35, 11000 Praha 1 – Staré Město, Czech Republic

## STANDARD YACHT EQUIPMENT

Comfort	<b>Bed linen, Blankets, Pillows, Sheets, Towels</b>
Deck	<b>Bilge pump - Mechanic, Bimini top, Black ball, Boat hook, Bosun's chair (Safe seat) (boatswain's chair), Deck brush, Diesel filter, Dinghy, Electric anchor windlass, Fenders, Gangway, Impeller, Jerry cans for diesel, Main anchor, Mooring ropes, Oil filter, Outboard engine, Plastic bucket, Repair box for dinghy, Reserve motor oil, Spare anchor (Reserve, Auxiliary anchor), Sprayhood, Swimming ladder, Winch handles</b>
Entertainment	<b>Radio CD player</b>
Galley	<b>Dishes, Gas bottles, Gas cookers, Kitchen utensils (Galley equipment, cutlery), Refrigerator</b>
Interior	<b>Barometer, Bilge pump handle, Clock, Yacht documents</b>
Navigation	<b>Autopilot, Binoculars, Bow thruster, Compass, Divider, nautic chart, Echosounder/Depthsounder, GPS chart plotter, GPS chart plotter - cockpit, Hand bearing compass, Log/speed instrument, Nautical charts, Radar reflector</b>
Safety	<b>Distress flare box, Emergency tiller, Fire extinguisher, First aid kit, Floating light, Fog horn, Horseshoe lifebuoy, Life belts (Safety harness), Life jackets, Liferaft, Oars (Paddles), Repair kit, Set of tools, Torch, VHF radio, Wire (shroud) cutter</b>
Yacht electrics	<b>Air Conditioning, Bilge pump - Electric, Pump</b>



**WEBSITE**

[www.plujeme.cz](http://www.plujeme.cz)



**PHONE**

+420 720 755 085



**MOBILE**

+420 777 170 276



**E-MAIL**

[info@plujeme.cz](mailto:info@plujeme.cz)



**PLUJEME RÁDI S.R.O.**

Dlouhá 730/35, 11000 Praha 1 – Staré Město, Czech Republic

## SERVICES

SELECTED SERVICES	OBLIGATORY	PAYMENT TYPE	PRICE
<b>Starter pack</b> (Payable at the base) <b>Season: 2026.</b> Price of start pack for 2 weeks charter is € 400 !!! For more than 2 weeks price remains €400; Includes end cleaning, linen, towels (1 set per person per week), outboard engine, 1st refill of outboard engine fuel, one (1) spare cooking gas bottle, unlimited free of charter stay in home port.	Yes	per week	<b>300,00 €</b>
<b>Damage waiver</b> (Payable at the base) <b>Season: 2026.</b> The service is available only with an additional reduced refundable security deposit of €300. 2 weeks: 360 EUR 3 weeks: 420 EUR	No	per booking	<b>300,00 €</b>
<b>Early Check in</b> (Payable at the base) <b>Season: 2026.</b> by 13:00h	No	per booking	<b>150,00 €</b>
<b>Hostess</b> (Payable at the base) <b>Season: 2026.</b>	No	per week + food	<b>1.330,00 €</b>
<b>Skipper</b> (Payable at the base) <b>Season: 2026.</b>	No	per week + food	<b>1.470,00 €</b>
<b>W-LAN on Board</b> (Payable at the base) <b>Season: 2026.</b> unlimited	No	per week	<b>50,00 €</b>

**WEBSITE**[www.plujeme.cz](http://www.plujeme.cz)**E-MAIL**[info@plujeme.cz](mailto:info@plujeme.cz)**PHONE**

+420 720 755 085

**MOBILE**

+420 777 170 276

**PLUJEME RÁDI S.R.O.**

Dlouhá 730/35, 11000 Praha 1 – Staré Město, Czech Republic

## ADDITIONAL EXTRAS

EXTRA	OBLIGATORY	PAYMENT TYPE	PRICE
<b>Railing net (Safety net)</b> <i>(Payable at the base)</i> <b>Season: 2026.</b> <i>installed - Payable at the base</i>	No	per booking	<b>200,00 €</b>
<b>Stand up paddle (SUP)</b> <i>(Payable at the base)</i> <b>Season: 2026.</b> <i>Payable at the base</i>	No	per week	<b>160,00 €</b>

**WEBSITE**

[www.plujeme.cz](http://www.plujeme.cz)

**E-MAIL**

[info@plujeme.cz](mailto:info@plujeme.cz)

**PHONE**

+420 720 755 085

**MOBILE**

+420 777 170 276

**PLUJEME RÁDI S.R.O.**

Dlouhá 730/35, 11000 Praha 1 – Staré Město, Czech Republic

## PRICE AND AVAILABILITY

25.04. - 02.05.2026 4.100 €	02.05. - 09.05.2026 4.100 €	09.05. - 16.05.2026 NOT AVAILABLE	16.05. - 23.05.2026 5.400 €
23.05. - 06.06.2026 NOT AVAILABLE	06.06. - 13.06.2026 NOT AVAILABLE	13.06. - 20.06.2026 NOT AVAILABLE	20.06. - 27.06.2026 6.200 €
27.06. - 04.07.2026 6.200 €	04.07. - 11.07.2026 NOT AVAILABLE	11.07. - 18.07.2026 6.200 €	18.07. - 25.07.2026 6.200 €
25.07. - 01.08.2026 ON OPTION	01.08. - 08.08.2026 7.100 €	08.08. - 15.08.2026 NOT AVAILABLE	15.08. - 22.08.2026 7.100 €
22.08. - 29.08.2026 6.200 €	29.08. - 05.09.2026 6.200 €	05.09. - 12.09.2026 NOT AVAILABLE	12.09. - 19.09.2026 NOT AVAILABLE
19.09. - 03.10.2026 NOT AVAILABLE	03.10. - 10.10.2026 NOT AVAILABLE	10.10. - 17.10.2026 4.100 €	17.10. - 24.10.2026 3.500 €
24.10. - 31.10.2026 3.500 €	31.10. - 07.11.2026 3.500 €	07.11. - 14.11.2026 3.500 €	14.11. - 21.11.2026 3.500 €
21.11. - 28.11.2026 3.500 €	28.11. - 05.12.2026 3.500 €		



WEBSITE

[www.plujeme.cz](http://www.plujeme.cz)



E-MAIL

[info@plujeme.cz](mailto:info@plujeme.cz)



PHONE

+420 720 755 085



MOBILE

+420 777 170 276



PLUJEME RÁDI S.R.O.

Dlouhá 730/35, 11000 Praha 1 – Staré Město, Czech Republic

## PRICE AND AVAILABILITY

05.12. - 12.12.2026

3.500 €

12.12. - 19.12.2026

3.500 €

19.12. - 26.12.2026

3.500 €



### WEBSITE

[www.plujeme.cz](http://www.plujeme.cz)



### E-MAIL

[info@plujeme.cz](mailto:info@plujeme.cz)



### PHONE

+420 720 755 085



### MOBILE

+420 777 170 276



### PLUJEME RÁDI S.R.O.

Dlouhá 730/35, 11000 Praha 1 – Staré Město, Czech Republic