

# SUNREEF 60

Southern Lights (2017)

Catamaran Sunreef 60 Southern Lights, built in 2017 is anchored in the **Philippines, Busuanga Bay Lodge, Mimaropa, Philippines**. It has **4 cabins**, can accommodate **8 people** and has **4 toilets**. Bed linen and kitchen equipment are included in the price.

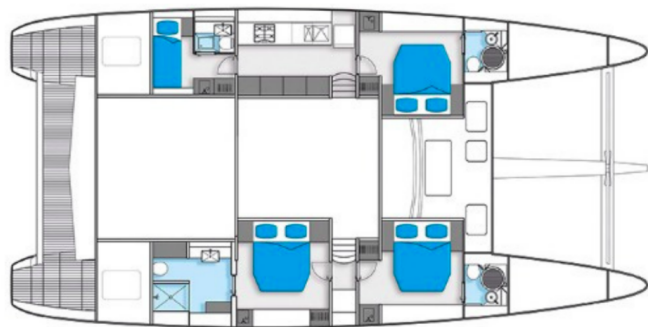

## YACHT SPECIFICATIONS

Yacht Base

**Philippines, Busuanga Bay Lodge, Philippines**

Yacht ID

**8309**

Brands

**Sunreef Yachts**

Yacht name

**Southern Lights**

Production year

**2017**

Length

**60 ft**

Cabins

**4**

Berths

**8**

WC

**4**

Engine

**2 x 0 HP**

Fuel tank

**0 l**



**WEBSITE**

[www.plujeme.cz](http://www.plujeme.cz)



**PHONE**

+420 720 755 085



**MOBILE**

+420 777 170 276



**E-MAIL**

[info@plujeme.cz](mailto:info@plujeme.cz)



**PLUJEME RÁDI S.R.O.**

Dlouhá 730/35, 11000 Praha 1 – Staré Město, Czech Republic

## STANDARD YACHT EQUIPMENT

Deck	<b>Dinghy, Grill/Barbecue/Plancha</b>
Entertainment	<b>Board games, Fins, Fishing cane/rod, Kayak, Paddle board, Snorkeling equipment, Sound System, Starlink, TV, Water toys</b>
Galley	<b>Bread machine, Freezer, Ice maker, Kitchen utensils (Galley equipment, cutlery), Microwave, Oven, Refrigerator, Stove, Wine cooler, Wine glasses</b>
Interior	<b>Water cooler</b>



**WEBSITE**

[www.plujeme.cz](http://www.plujeme.cz)



**E-MAIL**

[info@plujeme.cz](mailto:info@plujeme.cz)



**PHONE**

+420 720 755 085



**MOBILE**

+420 777 170 276



**PLUJEME RÁDI S.R.O.**

Dlouhá 730/35, 11000 Praha 1 – Staré Město, Czech Republic

## SERVICES

SELECTED SERVICES	OBLIGATORY	PAYMENT TYPE	PRICE
<b>APA (Advance Provisioning Allowance)</b> (Payable at the base) <b>Season: 2026.</b> 10% APA is required to cover expenses such as food, fuel, entrance fees to islands and other extras incurred during the cruise depending on the request of the guests. Any remaining funds are returned or additional funds may be required if expenses exceed the APA amount. *EXCLUSIONS (taken from the APA): - Food & Drinks, USD 20 per pax per meal - Fuel - Entrance fees - Land Transfers to Busuanga Bay Lodge - Delivery Fees if departure or Arrival is different than Busuanga Bay Lodge - Any personal expenses	No	per booking	<b>0,00 €</b>
<b>Delivery Fee</b> (Payable at the base) <b>Season: 2026.</b> Coron to El Nido or vice versa	No	one-way	<b>2.000,00 €</b>
<b>Food &amp; drink package</b> (Payable at the base) <b>Season: 2026.</b>	No	per meal	<b>20,00 €</b>



### WEBSITE

[www.plujeme.cz](http://www.plujeme.cz)



### E-MAIL

[info@plujeme.cz](mailto:info@plujeme.cz)



### PHONE

+420 720 755 085



### MOBILE

+420 777 170 276



### PLUJEME RÁDI S.R.O.

Dlouhá 730/35, 11000 Praha 1 – Staré Město, Czech Republic

## PRICE AND AVAILABILITY

18.04. - 25.04.2026 24.306 €	25.04. - 02.05.2026 24.306 €	02.05. - 09.05.2026 24.306 €	09.05. - 16.05.2026 24.306 €
16.05. - 23.05.2026 24.306 €	23.05. - 30.05.2026 24.306 €	30.05. - 06.06.2026 20.660 €	06.06. - 13.06.2026 19.444 €
13.06. - 20.06.2026 19.444 €	20.06. - 27.06.2026 19.444 €	27.06. - 04.07.2026 19.444 €	04.07. - 11.07.2026 19.444 €
11.07. - 18.07.2026 19.444 €	18.07. - 25.07.2026 19.444 €	25.07. - 01.08.2026 19.444 €	01.08. - 08.08.2026 19.444 €
08.08. - 15.08.2026 19.444 €	15.08. - 22.08.2026 19.444 €	22.08. - 29.08.2026 19.444 €	29.08. - 05.09.2026 19.444 €
05.09. - 12.09.2026 19.444 €	12.09. - 19.09.2026 19.444 €	19.09. - 26.09.2026 19.444 €	26.09. - 03.10.2026 19.444 €
03.10. - 10.10.2026 19.444 €	10.10. - 17.10.2026 19.444 €	17.10. - 24.10.2026 19.444 €	24.10. - 31.10.2026 19.444 €
31.10. - 07.11.2026 23.698 €	07.11. - 14.11.2026 24.306 €	14.11. - 21.11.2026 24.306 €	21.11. - 28.11.2026 24.306 €
28.11. - 05.12.2026 24.306 €			



**WEBSITE**  
www.plujeme.cz



**E-MAIL**  
info@plujeme.cz



**PHONE**  
+420 720 755 085



**PLUJEME RÁDI S.R.O.**  
Dlouhá 730/35, 11000 Praha 1 – Staré Město, Czech Republic



**MOBILE**  
+420 777 170 276

## PRICE AND AVAILABILITY

05.12. - 12.12.2026

24.306 €

12.12. - 19.12.2026

24.306 €

19.12. - 26.12.2026

24.306 €



### WEBSITE

[www.plujeme.cz](http://www.plujeme.cz)



### E-MAIL

[info@plujeme.cz](mailto:info@plujeme.cz)



### PHONE

+420 720 755 085



### MOBILE

+420 777 170 276



### PLUJEME RÁDI S.R.O.

Dlouhá 730/35, 11000 Praha 1 – Staré Město, Czech Republic