

AZIMUT 78

Concord's 6 ex. OMR Group (2021)

Motor yacht Azimut 78 Concord's 6 ex. OMR Group, built in 2021 is anchored in the Marina Lav - Podstrana, Split region, Croatia. It has 4 cabins, can accommodate 8 people and has 4 toilets. Bed linen and kitchen equipment are included in the price.

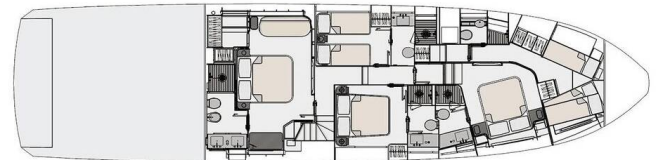

YACHT SPECIFICATIONS

Yacht Base

Marina Lav - Podstrana, Croatia

Yacht ID

8118

Brands

Azimut / Benetti Yachts

Yacht name

Concord's 6 ex. OMR Group

Production year

2021

Length

78 ft

Cabins

4

Berths

8

Max Persons

8

WC

4

Engine

3 x 1000 HP

Fuel tank

5000 l



WEBSITE

www.plujeme.cz



PHONE

+420 720 755 085



MOBILE

+420 777 170 276



E-MAIL

info@plujeme.cz



PLUJEME RÁDI S.R.O.

Dlouhá 730/35, 11000 Praha 1 - Staré Město, Czech Republic

STANDARD YACHT EQUIPMENT

Comfort	Deck cushions, Outside cushions, Sundeck beds, Sundeck cushions
Deck	Bar, Bow sunbathing area, Flybridge, Forward lounge area, Grill/Barbecue/Plancha, Hydraulic lifting swimming platform, Sun deck, Teak deck, Tender
Entertainment	Donut, Jet Ski SEA-D00 Spark, Seabob, Snorkeling equipment, Stand up paddle (SUP), Wakeboard, Water skis
Galley	Ice maker
Interior	Ambiental lighting
Navigation	Stabilizers
Yacht electrics	Air Conditioning, Generator



WEBSITE

www.plujeme.cz



E-MAIL

info@plujeme.cz



PHONE

+420 720 755 085



MOBILE

+420 777 170 276



PLUJEME RÁDI S.R.O.

Dlouhá 730/35, 11000 Praha 1 – Staré Město, Czech Republic

SERVICES

SELECTED SERVICES	OBLIGATORY	PAYMENT TYPE	PRICE
APA (Advance Provisioning Allowance) (Payable at the base) Season: 2026. 35% from the yacht price	Yes	per booking	0,00 €
Crew (Payable at the base) Season: 2026. Crew of 3 included in price	Yes	per booking	0,00 €
Cook (Payable at the base) Season: 2026.	No	per day + food	500,00 €



WEBSITE

www.plujeme.cz



E-MAIL

info@plujeme.cz



PHONE

+420 720 755 085



MOBILE

+420 777 170 276



PLUJEME RÁDI S.R.O.

Dlouhá 730/35, 11000 Praha 1 – Staré Město, Czech Republic

ADDITIONAL EXTRAS

EXTRA	OBLIGATORY	PAYMENT TYPE	PRICE
Bike (Payable at the base) Season: 2026. kids - Payable at the base	No	per week	150,00 €
Bike (Payable at the base) Season: 2026. foldable - Payable at the base	No	per week	200,00 €
Bike (Payable at the base) Season: 2026. mountain bike - Payable at the base	No	per week	250,00 €
eFoil (Payable at the base) Season: 2026. + 2000 EUR security deposit - Payable at the base	No	per week	1.500,00 €
Fishing cane/rod (Payable at the base) Season: 2026. Payable at the base	No	per week	20,00 €
Hoverboard (Payable at the base) Season: 2026. Payable at the base	No	per week	150,00 €
Jet Ski (Payable at the base) Season: 2026. Spark 60HP (2 seats) +1000 EUR security deposit - Payable at the base	No	per week	1.200,00 €
Kayak (Payable at the base) Season: 2026. 3 seats, with paddles - Payable at the base	No	per week	200,00 €
Kneeboard (Payable at the base) Season: 2026. Payable at the base	No	per week	200,00 €
Playstation 4 (Payable at the base) Season: 2026. Payable at the base	No	per week	100,00 €
Scooter (Payable at the base) Season: 2026. electric (foldable)- Payable at the base	No	per week	200,00 €
Water skis for children (Payable at the base) Season: 2026. with rope - Payable at the base	No	per week	100,00 €
Windsurf (Payable at the base) Season: 2026. Beginner - Payable at the base	No	per week	300,00 €

Windsurf (Payable at the base)

No

per week

400,00 €

Season: 2026. Professional - Payable at the base



WEBSITE

www.plujeme.cz



E-MAIL

info@plujeme.cz



PHONE

+420 720 755 085



MOBILE

+420 777 170 276



PLUJEME RÁDI S.R.O.

Dlouhá 730/35, 11000 Praha 1 – Staré Město, Czech Republic

PRICE AND AVAILABILITY

02.05. - 09.05.2026 49.327 € 51.924 €	09.05. - 16.05.2026 49.327 € 51.924 €	16.05. - 23.05.2026 49.327 € 51.924 €	23.05. - 30.05.2026 49.327 € 51.924 €
30.05. - 06.06.2026 52.172 € 54.918 €	06.06. - 13.06.2026 52.172 € 54.918 €	13.06. - 20.06.2026 52.172 € 54.918 €	20.06. - 27.06.2026 52.172 € 54.918 €
27.06. - 04.07.2026 56.896 € 59.890 €	04.07. - 11.07.2026 56.896 € 59.890 €	11.07. - 18.07.2026 56.896 € 59.890 €	18.07. - 25.07.2026 56.896 € 59.890 €
26.07. - 02.08.2026 NOT AVAILABLE	08.08. - 15.08.2026 56.896 € 59.890 €	15.08. - 22.08.2026 56.896 € 59.890 €	22.08. - 29.08.2026 56.896 € 59.890 €
29.08. - 05.09.2026 52.172 € 54.918 €	05.09. - 12.09.2026 52.172 € 54.918 €	12.09. - 19.09.2026 52.172 € 54.918 €	19.09. - 26.09.2026 52.172 € 54.918 €
26.09. - 03.10.2026 ON OPTION	03.10. - 10.10.2026 49.327 € 51.924 €	10.10. - 17.10.2026 49.327 € 51.924 €	17.10. - 24.10.2026 49.327 € 51.924 €
24.10. - 31.10.2026 49.327 € 51.924 €	31.10. - 07.11.2026 49.327 € 51.924 €	07.11. - 14.11.2026 49.327 € 51.924 €	14.11. - 21.11.2026 49.327 € 51.924 €
21.11. - 28.11.2026 49.327 € 51.924 €	28.11. - 05.12.2026 49.327 € 51.924 €	05.12. - 12.12.2026 49.327 € 51.924 €	12.12. - 19.12.2026 49.327 € 51.924 €
19.12. - 26.12.2026 49.327 € 51.924 €			



WEBSITE
www.plujeme.cz



E-MAIL
info@plujeme.cz



PHONE
+420 720 755 085



PLUJEME RÁDI S.R.O.
Dlouhá 730/35, 11000 Praha 1 – Staré Město, Czech Republic



MOBILE
+420 777 170 276