

SUNSEEKER MANHATTAN 73

Goldeneye (2013)

Motor yacht Sunseeker Manhattan 73 Goldeneye, built in 2013 is anchored in the Marina Mandalina, Sibenik, Šibenik region, Croatia. It has 4 cabins, can accommodate 8 people and has 4 toilets. Bed linen and kitchen equipment are included in the price.

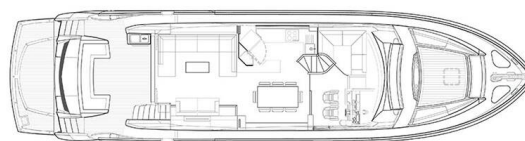

YACHT SPECIFICATIONS

Yacht Base

Marina Mandalina, Sibenik, Croatia

Yacht ID

8101

Brands

Sunseeker International

Yacht name

Goldeneye

Production year

2013

Length

74 ft

Cabins

4

Berths

8

WC

4

Engine

2 x 1360 HP

Fuel tank

5000 l



WEBSITE

www.plujeme.cz



PHONE

+420 720 755 085



MOBILE

+420 777 170 276



E-MAIL

info@plujeme.cz



PLUJEME RÁDI S.R.O.

Dlouhá 730/35, 11000 Praha 1 – Staré Město, Czech Republic

STANDARD YACHT EQUIPMENT

Comfort	Bed linen, Cockpit cushions, Outside cushions, Sun lounging area cushions with lifting backrest on foredeck, Towels
Deck	Anchor chain counter, Bimini top, Cockpit table, Cockpit/stern, outside shower, Deck lights, Dinghy with outboard engine, Fenders, Flybridge, Grill/Barbecue/Plancha, Hydraulic gangway, Mooring ropes, Outboard engine
Entertainment	Bose Sound System, Jet Ski, Outdoor speakers, Seabob, Stand up paddle (SUP), TV, Underwater lights, Wi-Fi Internet
Galley	Dishwasher, Freezer, Hot water, Ice maker, Kitchen utensils (Galley equipment, cutlery), Oven, Refrigerator, Sink, Stove, Wine cooler
Interior	Coolbox, Safe, Washer/dryer, Washing machine
Navigation	Autopilot, Bow thruster, GPS chart plotter, Radar, Stern thruster
Safety	Life jackets, Set of tools, VHF radio
Yacht electrics	Air Conditioning, Generator, Shore power cable, Shore power connection, Watermaker - desalinator



WEBSITE

www.plujeme.cz



PHONE

+420 720 755 085



MOBILE

+420 777 170 276



E-MAIL

info@plujeme.cz



PLUJEME RÁDI S.R.O.

Dlouhá 730/35, 11000 Praha 1 – Staré Město, Czech Republic

SERVICES

SELECTED SERVICES	OBLIGATORY	PAYMENT TYPE	PRICE
APA (Advance Provisioning Allowance) (Payable at the base) Season: 2026.	Yes	per booking	6.000,00 €
Base fee (Payable at the base) Season: 2026. Free berth in Marina Mandalina during whole charter period!	Yes	per booking	0,00 €
Hostess (Payable at the base) Season: 2026.	Yes	per day + food	250,00 €
Skipper (Payable at the base) Season: 2026.	Yes	per day + food	300,00 €
Permit (Payable at the base) Season: 2026. Permit for Montenegro, Italy, Malta, Greece; To sail out of Croatian waters, 2 crew members with valid licenses obligatory	No	per booking	150,00 €
Provisioning (Payable at the base) Season: 2026. 10% of the amount (minimal amount 150 EUR)	No	per booking	0,00 €

**WEBSITE**www.plujeme.cz**E-MAIL**info@plujeme.cz**PHONE**

+420 720 755 085

**MOBILE**

+420 777 170 276

**PLUJEME RÁDI S.R.O.**

Dlouhá 730/35, 11000 Praha 1 – Staré Město, Czech Republic

ADDITIONAL EXTRAS

EXTRA	OBLIGATORY	PAYMENT TYPE	PRICE
Beach towel (Payable at the base) Season: 2026. gratis - Payable at the base	No	per booking	0,00 €
Coffee machine (Payable at the base) Season: 2026. on request - Payable at the base	No	per booking	0,00 €
Jet Ski SEA-D00 Spark (Payable at the base) Season: 2026. 90 HP, deposit 500 EUR; for use of Jet Ski client must have proper licence; in case client hire jet ski, he won't have dinghy on board - Payable at the base	No	per week	1.300,00 €
Seabob (Payable at the base) Season: 2026. included in the price - Payable at the base	No	per week	0,00 €
Stand up paddle (SUP) (Payable at the base) Season: 2026. GRATIS - Payable at the base	No	per booking	0,00 €

**WEBSITE**www.plujeme.cz**E-MAIL**info@plujeme.cz**PHONE**

+420 720 755 085

**MOBILE**

+420 777 170 276

**PLUJEME RÁDI S.R.O.**

Dlouhá 730/35, 11000 Praha 1 – Staré Město, Czech Republic

PRICE AND AVAILABILITY

25.04. - 02.05.2026 20.953 € 24.650 €	02.05. - 09.05.2026 20.953 € 24.650 €	12.05. - 17.05.2026 NOT AVAILABLE	23.05. - 30.05.2026 20.953 € 24.650 €
30.05. - 06.06.2026 20.953 € 24.650 €	06.06. - 13.06.2026 22.908 € 26.950 €	13.06. - 20.06.2026 22.908 € 26.950 €	20.06. - 27.06.2026 25.492 € 29.990 €
27.06. - 11.07.2026 NOT AVAILABLE	11.07. - 18.07.2026 NOT AVAILABLE	18.07. - 25.07.2026 NOT AVAILABLE	25.07. - 01.08.2026 NOT AVAILABLE
01.08. - 08.08.2026 27.625 € 32.500 €	08.08. - 15.08.2026 25.492 € 29.990 €	15.08. - 29.08.2026 NOT AVAILABLE	29.08. - 05.09.2026 22.908 € 26.950 €
05.09. - 12.09.2026 20.953 € 24.650 €	12.09. - 19.09.2026 20.953 € 24.650 €	19.09. - 26.09.2026 20.953 € 24.650 €	26.09. - 03.10.2026 20.953 € 24.650 €
03.10. - 10.10.2026 20.953 € 24.650 €	10.10. - 17.10.2026 20.953 € 24.650 €	17.10. - 24.10.2026 20.953 € 24.650 €	24.10. - 31.10.2026 20.953 € 24.650 €
31.10. - 07.11.2026 20.953 € 24.650 €	07.11. - 14.11.2026 20.953 € 24.650 €	14.11. - 21.11.2026 20.953 € 24.650 €	21.11. - 28.11.2026 20.953 € 24.650 €
28.11. - 05.12.2026 20.953 € 24.650 €			



WEBSITE
www.plujeme.cz



E-MAIL
info@plujeme.cz



PHONE
+420 720 755 085



PLUJEME RÁDI S.R.O.
Dlouhá 730/35, 11000 Praha 1 – Staré Město, Czech Republic



MOBILE
+420 777 170 276

PRICE AND AVAILABILITY

05.12. - 12.12.2026

20.953 € 24.650 €

12.12. - 19.12.2026

20.953 € 24.650 €

19.12. - 26.12.2026

20.953 € 24.650 €



WEBSITE

www.plujeme.cz



E-MAIL

info@plujeme.cz



PHONE

+420 720 755 085



MOBILE

+420 777 170 276



PLUJEME RÁDI S.R.O.

Dlouhá 730/35, 11000 Praha 1 – Staré Město, Czech Republic