

# LAGOON 46

Maryna (2021)

Catamaran **Lagoon 46 Maryna**, built in **2021** is anchored in the **Seychelles, Eden Island Marina, Mahé, Seychelles**. It has **4 + 1 cabins**, can accommodate **8 + 1 people** and has **4 toilets**. Bed linen and kitchen equipment are included in the price.

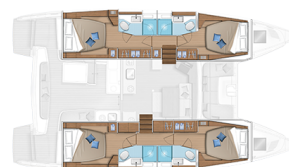

## YACHT SPECIFICATIONS

Yacht Base

**Seychelles, Eden Island Marina,  
Seychelles**

Yacht ID

**7853**

Brands

**Lagoon**

Yacht name

**Maryna**

Production year

**2021**

Length

**46 ft**

Cabins

**4 + 1**

Berths

**8 + 1**

Max Persons

**9**

WC

**4**

Engine

**2 x 57 HP**

Fuel tank

**1040 l**



**WEBSITE**

[www.plujeme.cz](http://www.plujeme.cz)



**PHONE**

+420 720 755 085



**MOBILE**

+420 777 170 276



**E-MAIL**

[info@plujeme.cz](mailto:info@plujeme.cz)



**PLUJEME RÁDI S.R.O.**

Dlouhá 730/35, 11000 Praha 1 – Staré Město, Czech Republic

## STANDARD YACHT EQUIPMENT

Additional	<b>Flag</b>
Comfort	<b>Cockpit cushions, Pillows</b>
Deck	<b>Anchor with chain, Bilge pump - Mechanic, Bimini top, Bosun's chair (Safe seat) (boatswain's chair), Cockpit fridge, Cockpit table, Cockpit/stern, outside shower, Deck brush, Deck lights, Dinghy with outboard engine, Electric anchor windlass, Fenders, Flybridge, Gangway, Jerry cans for fuel, LED outdoor ambiance lights, Mooring Cleats, Mooring ropes, Round/globular fender, Spare anchor (Reserve, Auxiliary anchor), Sponge, Spring cleats, Swimming ladder, Teak cockpit table with folding leaves, Water hose, Winch handles</b>
Entertainment	<b>Fusion radio</b>
Galley	<b>Blender, Freezer, Gas bottles, Gas cookers, Kitchen utensils (Galley equipment, cutlery), Oven, Refrigerator, Side galley, Water pump</b>
Interior	<b>Clothes hangers, Electric fans in cabins, Electric toilet, LED interior lights, Salon table, Toilet brush, Upholstery</b>
Navigation	<b>GPS chart plotter, Navigation (Nautical) charts and nautical guide, Navigation set, Parallel ruler, Radar reflector, Tridata</b>
Safety	<b>Black Water Tank, Distress flare box, Emergency tiller, Fire extinguisher, First aid kit, Flashlight, Fog horn, Horseshoe lifebuoy, Life belts (Safety harness), Life jacket (children), Life jackets, Liferaft, Rescue sling (Life sling), Set of tools, Signal flags, Spare parts, VHF radio, Wire (shroud) cutter</b>
Yacht electrics	<b>220V socket, Air Conditioning, Battery charger, Bilge pump - Electric, DSC station, Fish finder, Generator, Inverter, Motor hours counter, Service batteries, Shore connection 220 V, Shore power cable, Start battery, USB sockets, Water heater, Watermaker - desalinator</b>



**WEBSITE**

[www.plujeme.cz](http://www.plujeme.cz)



**PHONE**

+420 720 755 085



**MOBILE**

+420 777 170 276



**E-MAIL**

[info@plujeme.cz](mailto:info@plujeme.cz)



**PLUJEME RÁDI S.R.O.**

Dlouhá 730/35, 11000 Praha 1 - Staré Město, Czech Republic

## SERVICES

SELECTED SERVICES	OBLIGATORY	PAYMENT TYPE	PRICE
<b>Final cleaning</b> (Payable at the base) <b>Season: 2026.</b>	Yes	per booking	<b>300,00 €</b>
<b>Tourist tax</b> (Payable at the base) <b>Season: 2026.</b>	Yes	per guest/day	<b>7,00 €</b>
<b>Cook</b> (Payable at the base) <b>Season: 2026.</b>	No	per day + food	<b>200,00 €</b>
<b>Full board</b> (Payable at the base) <b>Season: 2026.</b> breakfast/lunch/dinner // payment on the base	No	per week/ person	<b>300,00 €</b>
<b>Hostess</b> (Payable at the base) <b>Season: 2026.</b>	No	per day + food	<b>200,00 €</b>
<b>Skipper</b> (Payable at the base) <b>Season: 2026.</b>	No	per day + food	<b>200,00 €</b>
<b>Transfer</b> (Payable at the base) <b>Season: 2026.</b> for 8 pax - 2 way	No	round trip	<b>150,00 €</b>
<b>WI-FI Internet connection on boat</b> (Payable at the base) <b>Season: 2026.</b>	No	per week	<b>130,00 €</b>

**WEBSITE**[www.plujeme.cz](http://www.plujeme.cz)**E-MAIL**[info@plujeme.cz](mailto:info@plujeme.cz)**PHONE**

+420 720 755 085

**MOBILE**

+420 777 170 276

**PLUJEME RÁDI S.R.O.**

Dlouhá 730/35, 11000 Praha 1 – Staré Město, Czech Republic

## ADDITIONAL EXTRAS

EXTRA	OBLIGATORY	PAYMENT TYPE	PRICE
<b>Fishing cane/rod</b> (Payable at the base) <b>Season: 2026.</b> Payable at the base	No	per week	<b>100,00 €</b>
<b>Kayak</b> (Payable at the base) <b>Season: 2026.</b> payment on the base / single/double (100 EUR/week), solid or inflatable - Payable at the base	No	per week	<b>100,00 €</b>
<b>Railing net (Safety net)</b> (Payable at the base) <b>Season: 2026.</b> Payable at the base	No	per week	<b>150,00 €</b>
<b>Stand up paddle (SUP)</b> (Payable at the base) <b>Season: 2026.</b> Payable at the base	No	per week	<b>125,00 €</b>
<b>Underwater scooter</b> (Payable at the base) <b>Season: 2026.</b> Underwater Scooter with mask / payment on the base (100 EUR/ day or 500 EUR per week - Payable at the base	No	per day	<b>100,00 €</b>

**WEBSITE**[www.plujeme.cz](http://www.plujeme.cz)**E-MAIL**[info@plujeme.cz](mailto:info@plujeme.cz)**PHONE**

+420 720 755 085

**MOBILE**

+420 777 170 276

**PLUJEME RÁDI S.R.O.**

Dlouhá 730/35, 11000 Praha 1 – Staré Město, Czech Republic

## PRICE AND AVAILABILITY

25.04. - 02.05.2026 7.150 € 11.000 €	02.05. - 09.05.2026 NOT AVAILABLE	09.05. - 16.05.2026 7.360 € 9.200 €	16.05. - 23.05.2026 7.360 € 9.200 €
23.05. - 30.05.2026 7.360 € 9.200 €	30.05. - 06.06.2026 4.950 € 5.500 €	06.06. - 13.06.2026 NOT AVAILABLE	13.06. - 20.06.2026 4.950 € 5.500 €
20.06. - 27.06.2026 4.950 € 5.500 €	27.06. - 04.07.2026 4.950 € 5.500 €	04.07. - 11.07.2026 4.950 € 5.500 €	11.07. - 18.07.2026 NOT AVAILABLE
18.07. - 25.07.2026 4.950 € 5.500 €	25.07. - 01.08.2026 4.950 € 5.500 €	01.08. - 08.08.2026 NOT AVAILABLE	08.08. - 15.08.2026 NOT AVAILABLE
15.08. - 22.08.2026 4.950 € 5.500 €	22.08. - 29.08.2026 4.950 € 5.500 €	29.08. - 05.09.2026 4.950 € 5.500 €	05.09. - 12.09.2026 4.950 € 5.500 €
12.09. - 19.09.2026 4.950 € 5.500 €	19.09. - 26.09.2026 7.173 € 7.970 €	26.09. - 03.10.2026 ON OPTION	03.10. - 17.10.2026 NOT AVAILABLE
17.10. - 24.10.2026 7.173 € 7.970 €	24.10. - 31.10.2026 NOT AVAILABLE	31.10. - 07.11.2026 NOT AVAILABLE	07.11. - 14.11.2026 7.173 € 7.970 €
14.11. - 21.11.2026 7.173 € 7.970 €	21.11. - 28.11.2026 NOT AVAILABLE	28.11. - 05.12.2026 7.173 € 7.970 €	



**WEBSITE**  
www.plujeme.cz



**E-MAIL**  
info@plujeme.cz



**PHONE**  
+420 720 755 085



**PLUJEME RÁDI S.R.O.**  
Dlouhá 730/35, 11000 Praha 1 – Staré Město, Czech Republic



**MOBILE**  
+420 777 170 276

## PRICE AND AVAILABILITY

05.12. - 12.12.2026 NOT AVAILABLE	12.12. - 19.12.2026 5.400 € 6.000 €	19.12. - 26.12.2026 9.630 € 10.700 €	02.01. - 09.01.2027 7.884 € 8.760 €
09.01. - 16.01.2027 7.173 € 7.970 €	16.01. - 23.01.2027 7.173 € 7.970 €	23.01. - 30.01.2027 7.173 € 7.970 €	30.01. - 06.02.2027 8.280 € 9.200 €
06.02. - 13.02.2027 8.280 € 9.200 €	13.02. - 20.02.2027 8.280 € 9.200 €	20.02. - 27.02.2027 8.280 € 9.200 €	27.02. - 06.03.2027 8.280 € 9.200 €
06.03. - 13.03.2027 NOT AVAILABLE	13.03. - 20.03.2027 ON OPTION	20.03. - 27.03.2027 8.280 € 9.200 €	27.03. - 03.04.2027 9.900 € 11.000 €
03.04. - 10.04.2027 9.900 € 11.000 €	10.04. - 17.04.2027 9.900 € 11.000 €	17.04. - 24.04.2027 9.900 € 11.000 €	24.04. - 01.05.2027 9.900 € 11.000 €
01.05. - 08.05.2027 8.280 € 9.200 €	08.05. - 15.05.2027 8.280 € 9.200 €	15.05. - 22.05.2027 8.280 € 9.200 €	22.05. - 29.05.2027 8.280 € 9.200 €
29.05. - 05.06.2027 4.950 € 5.500 €	05.06. - 12.06.2027 4.950 € 5.500 €	12.06. - 19.06.2027 4.950 € 5.500 €	19.06. - 26.06.2027 4.950 € 5.500 €
26.06. - 03.07.2027 4.950 € 5.500 €	03.07. - 10.07.2027 4.950 € 5.500 €	10.07. - 17.07.2027 4.950 € 5.500 €	17.07. - 24.07.2027 4.950 € 5.500 €
24.07. - 31.07.2027 4.950 € 5.500 €	31.07. - 07.08.2027 4.950 € 5.500 €		



WEBSITE

[www.plujeme.cz](http://www.plujeme.cz)



E-MAIL

[info@plujeme.cz](mailto:info@plujeme.cz)



PHONE

+420 720 755 085



MOBILE

+420 777 170 276



PLUJEME RÁDI S.R.O.

Dlouhá 730/35, 11000 Praha 1 – Staré Město, Czech Republic

## PRICE AND AVAILABILITY

07.08. - 14.08.2027 <b>4.950 €</b> 5.500 €	14.08. - 21.08.2027 <b>4.950 €</b> 5.500 €	21.08. - 28.08.2027 <b>4.950 €</b> 5.500 €	28.08. - 04.09.2027 <b>4.950 €</b> 5.500 €
04.09. - 11.09.2027 <b>4.950 €</b> 5.500 €	11.09. - 18.09.2027 <b>4.950 €</b> 5.500 €	18.09. - 25.09.2027 <b>7.173 €</b> 7.970 €	25.09. - 02.10.2027 <b>7.173 €</b> 7.970 €
02.10. - 09.10.2027 <b>7.173 €</b> 7.970 €	09.10. - 16.10.2027 <b>7.173 €</b> 7.970 €	16.10. - 23.10.2027 <b>7.173 €</b> 7.970 €	23.10. - 30.10.2027 <b>7.173 €</b> 7.970 €
30.10. - 06.11.2027 <b>7.173 €</b> 7.970 €	06.11. - 13.11.2027 <b>7.173 €</b> 7.970 €	13.11. - 20.11.2027 <b>7.173 €</b> 7.970 €	20.11. - 27.11.2027 <b>7.173 €</b> 7.970 €
27.11. - 04.12.2027 <b>7.173 €</b> 7.970 €	04.12. - 11.12.2027 <b>5.400 €</b> 6.000 €	11.12. - 18.12.2027 <b>5.400 €</b> 6.000 €	18.12. - 25.12.2027 <b>9.630 €</b> 10.700 €



### WEBSITE

[www.plujeme.cz](http://www.plujeme.cz)



### E-MAIL

[info@plujeme.cz](mailto:info@plujeme.cz)



### PHONE

+420 720 755 085



### MOBILE

+420 777 170 276



### PLUJEME RÁDI S.R.O.

Dlouhá 730/35, 11000 Praha 1 – Staré Město, Czech Republic