

LEOPARD 48

Satisfaction (2018)

Catamaran **Leopard 48 Satisfaction**, built in **2018** is anchored in the **Lefkas main port, Ionian Islands, Greece**. It has **4 + 1 cabins**, can accommodate **8 + 1 people** and has **4 + 1 toilets**. Bed linen and kitchen equipment are included in the price.

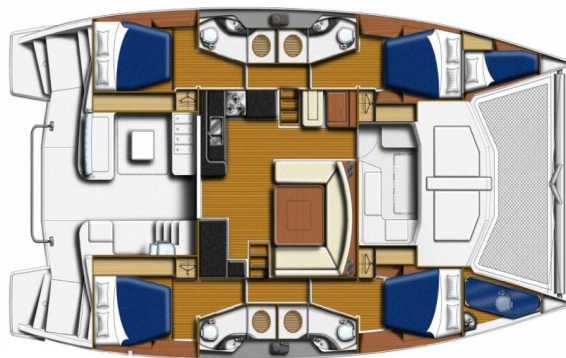

YACHT SPECIFICATIONS

Yacht Base

Lefkas main port, Greece

Yacht ID

7758

Brands

Leopard

Yacht name

Satisfaction

Production year

2018

Length

48 ft

Cabins

4 + 1

Berths

8 + 1

Max Persons

12

WC

4 + 1

Engine

2 x 57 HP

Fuel tank

690 l



WEBSITE

www.plujeme.cz



PHONE

+420 720 755 085



MOBILE

+420 777 170 276



E-MAIL

info@plujeme.cz



PLUJEME RÁDI S.R.O.

Dlouhá 730/35, 11000 Praha 1 – Staré Město, Czech Republic

STANDARD YACHT EQUIPMENT

Comfort	Cockpit cushions
Deck	Davit, Dinghy with outboard engine, Fenders, Flybridge, Gangway
Galley	Oven, Refrigerator, Stove
Interior	Electric fans in cabins, Electric toilet
Navigation	Autopilot, Compass, Depthsounder, GPS chart plotter, Wind instrument/Anemometer
Safety	Black Water Tank, EPIRB-Distress radio beacons, VHF radio
Yacht electrics	Air Conditioning, Generator, Solar panels, Start battery



WEBSITE

www.plujeme.cz



E-MAIL

info@plujeme.cz



PHONE

+420 720 755 085



MOBILE

+420 777 170 276



PLUJEME RÁDI S.R.O.

Dlouhá 730/35, 11000 Praha 1 – Staré Město, Czech Republic

SERVICES

SELECTED SERVICES	OBLIGATORY	PAYMENT TYPE	PRICE
Security Deposit Waiver (Payable at the base) Season: 2026. 300 EUR credit voucher for the next charter in case of no damage/loss upon redelivery. No cash refund.	Yes	per booking	650,00 €
Standard Charter Pack (Payable at the base) Season: 2026. Welcome kit	Yes	per booking	370,00 €
Beach towel (Payable at the base) Season: 2026.	No	per booking	10,00 €
Berth cost (Payable at the base) Season: 2026. Berthing fees for first & last night at the marina/port	No	per booking	0,00 €
Cook (Payable at the base) Season: 2026. Crew provisioning to be provided by Charterer in arrangement with crew. If monetary compensation shall be agreed, then it shall be of no less than €30 per crew member per day. Charterer shall provide crew with sleeping cabin/berth and shower/toilet use to be designated to them onboard.	No	per day + food	215,00 €
Family pack (Payable at the base) Season: 2026. Safety net, SUP, junior life jackets, normal foam type	No	per booking	350,00 €
Fast Track pack (Payable at the base) Season: 2026. Access to the yacht by 14:00h on embarkation day, only IF feasible	No	per booking	200,00 €
Hostess (Payable at the base) Season: 2026. Crew provisioning to be provided by Charterer in arrangement with crew. If monetary compensation shall be agreed, then it shall be of no less than €30 per crew member per day. Charterer shall provide crew with sleeping cabin/berth and shower/toilet use to be designated to them onboard.	No	per day + food	180,00 €
Internet pack (Payable at the base) Season: 2026. Wi-Fi router for Internet aboard (subject to GSM coverage up to 10GB/week)	No	per week	50,00 €
One way fee (Payable at the base) Season: 2026. Volos-Skiathos	No	per booking	300,00 €

One way fee (Payable at the base) Season: 2026. Preveza-Lefkas	No	per booking	300,00 €
One way fee (Payable at the base) Season: 2026. Athens-Lavrion	No	per booking	500,00 €
One way fee (Payable at the base) Season: 2026. Athens-Cyclades/Sporades	No	per booking	1.000,00 €
One way fee (Payable at the base) Season: 2026. Athens-Dodecanese	No	per booking	1.200,00 €
One way fee (Payable at the base) Season: 2026. Kos-Rhodos	No	per booking	600,00 €
One way fee (Payable at the base) Season: 2026. Lefkas/Preveza-Corfu	No	per booking	600,00 €
One way fee (Payable at the base) Season: 2026. Athens-Lefkas-Preveza	No	per booking	1.200,00 €
One way fee (Payable at the base) Season: 2026. Athens-Corfu	No	per booking	1.400,00 €
Overnight on board (Payable at the base) Season: 2026. Embarkation on yacht & overnight stay the day before charter starts, check-in by 13:00h on charter start day. Subject to last minute availability of yacht on previous day.	No	per booking	180,00 €
Pet on board (Payable at the base) Season: 2026. up to 7 kg	No	per booking	200,00 €
Skipper (Payable at the base) Season: 2026. Crew provisioning to be provided by Charterer in arrangement with crew. If monetary compensation shall be agreed, then it shall be of no less than €30 per crew member per day. Charterer shall provide crew with sleeping cabin/berth and shower/toilet use to be designated to them onboard. Skipped charters come obligatorily with: Security deposit waiver, non refundable, EUR 400	No	per day + food	215,00 €
Stand up paddle (SUP) (Payable at the base) Season: 2026.	No	per week	100,00 €

VIP Pack (Payable at the base)

No

per booking

300,00 €

Season: 2026. Airport/Local Base welcome & pickup, transfer to the yacht, welcome pack with sparkling wine & fruits, departure transfer to the local airport



WEBSITE

www.plujeme.cz



E-MAIL

info@plujeme.cz



PHONE

+420 720 755 085



MOBILE

+420 777 170 276



PLUJEME RÁDI S.R.O.

Dlouhá 730/35, 11000 Praha 1 – Staré Město, Czech Republic

ADDITIONAL EXTRAS

EXTRA	OBLIGATORY	PAYMENT TYPE	PRICE
Automatic Inflatable Life Jacket (Payable at the base) <i>Season: 2026. Payable at the base</i>	No	per week/ person	20,00 €
Beach towel (Payable at the base) <i>Season: 2026. Payable at the base</i>	No	per piece	10,00 €
Extra bedlinen (Payable at the base) <i>Season: 2026. Payable at the base</i>	No	per set	10,00 €
Fishing equipment (Payable at the base) <i>Season: 2026. fishing rod & reel - Payable at the base</i>	No	per week	30,00 €
Gennaker (Payable at the base) <i>Season: 2026. + extra security deposit 500 EUR (refundable) - Payable at the base</i>	No	per week	200,00 €
Grill/Barbecue/Plancha (Payable at the base) <i>Season: 2026. portable, 1x gas bottle included - Payable at the base</i>	No	per week	80,00 €
Kayak (Payable at the base) <i>Season: 2026. Payable at the base</i>	No	per week	100,00 €
Outboard engine 9 HP (Payable at the base) <i>Season: 2026. + 600€ deposit Available only on specific bases & only upon request! - Payable at the base</i>	No	per week	250,00 €
Railing net (Safety net) (Payable at the base) <i>Season: 2026. installed - Payable at the base</i>	No	per booking	200,00 €
Stand up paddle (SUP) (Payable at the base) <i>Season: 2026. Payable at the base</i>	No	per week	100,00 €



WEBSITE
www.plujeme.cz



E-MAIL
info@plujeme.cz



PHONE
+420 720 755 085



MOBILE
+420 777 170 276



PLUJEME RÁDI S.R.O.
Dlouhá 730/35, 11000 Praha 1 – Staré Město, Czech Republic

PRICE AND AVAILABILITY

25.04. - 02.05.2026 3.710 € 5.300 €	02.05. - 09.05.2026 3.710 € 5.300 €	09.05. - 16.05.2026 3.710 € 5.300 €	16.05. - 23.05.2026 4.800 € 6.000 €
23.05. - 30.05.2026 5.760 € 7.200 €	30.05. - 06.06.2026 7.020 € 7.800 €	06.06. - 13.06.2026 7.785 € 8.650 €	13.06. - 20.06.2026 NOT AVAILABLE
20.06. - 24.06.2026 NOT AVAILABLE	27.06. - 04.07.2026 NOT AVAILABLE	04.07. - 11.07.2026 NOT AVAILABLE	11.07. - 18.07.2026 ON OPTION
18.07. - 25.07.2026 NOT AVAILABLE	25.07. - 01.08.2026 9.135 € 10.150 €	01.08. - 08.08.2026 NOT AVAILABLE	08.08. - 15.08.2026 10.980 € 12.200 €
15.08. - 22.08.2026 10.980 € 12.200 €	22.08. - 29.08.2026 9.135 € 10.150 €	29.08. - 05.09.2026 9.135 € 10.150 €	05.09. - 12.09.2026 9.135 € 10.150 €
12.09. - 19.09.2026 8.010 € 8.900 €	19.09. - 26.09.2026 ON OPTION	26.09. - 03.10.2026 NOT AVAILABLE	03.10. - 10.10.2026 NOT AVAILABLE
10.10. - 17.10.2026 5.760 € 6.400 €	17.10. - 24.10.2026 4.500 € 5.000 €	24.10. - 31.10.2026 4.500 € 5.000 €	31.10. - 07.11.2026 4.500 € 5.000 €
07.11. - 14.11.2026 4.500 € 5.000 €	14.11. - 21.11.2026 4.500 € 5.000 €	21.11. - 31.12.2026 NOT AVAILABLE	



WEBSITE

www.plujeme.cz



E-MAIL

info@plujeme.cz



PHONE

+420 720 755 085



MOBILE

+420 777 170 276



PLUJEME RÁDI S.R.O.

Dlouhá 730/35, 11000 Praha 1 – Staré Město, Czech Republic

PRICE AND AVAILABILITY

02.01. - 09.01.2027 3.780 € 4.200 €	09.01. - 16.01.2027 3.780 € 4.200 €	16.01. - 23.01.2027 3.780 € 4.200 €	23.01. - 30.01.2027 3.780 € 4.200 €
30.01. - 06.02.2027 3.780 € 4.200 €	06.02. - 13.02.2027 3.780 € 4.200 €	13.02. - 20.02.2027 3.780 € 4.200 €	20.02. - 27.02.2027 3.780 € 4.200 €
27.02. - 06.03.2027 3.780 € 4.200 €	06.03. - 13.03.2027 3.780 € 4.200 €	13.03. - 20.03.2027 3.780 € 4.200 €	20.03. - 27.03.2027 3.780 € 4.200 €
27.03. - 03.04.2027 3.780 € 4.200 €	03.04. - 10.04.2027 3.780 € 4.200 €	10.04. - 17.04.2027 3.780 € 4.200 €	17.04. - 24.04.2027 3.780 € 4.200 €
24.04. - 01.05.2027 4.770 € 5.300 €	01.05. - 08.05.2027 4.770 € 5.300 €	08.05. - 15.05.2027 4.770 € 5.300 €	15.05. - 22.05.2027 5.400 € 6.000 €
22.05. - 29.05.2027 6.480 € 7.200 €	29.05. - 05.06.2027 7.020 € 7.800 €	05.06. - 12.06.2027 7.785 € 8.650 €	12.06. - 19.06.2027 7.785 € 8.650 €
19.06. - 26.06.2027 9.135 € 10.150 €	26.06. - 03.07.2027 9.135 € 10.150 €	03.07. - 10.07.2027 9.135 € 10.150 €	10.07. - 17.07.2027 9.135 € 10.150 €
17.07. - 24.07.2027 9.135 € 10.150 €	24.07. - 31.07.2027 9.135 € 10.150 €	31.07. - 07.08.2027 10.980 € 12.200 €	



WEBSITE

www.plujeme.cz



E-MAIL

info@plujeme.cz



PHONE

+420 720 755 085



MOBILE

+420 777 170 276



PLUJEME RÁDI S.R.O.

Dlouhá 730/35, 11000 Praha 1 – Staré Město, Czech Republic

PRICE AND AVAILABILITY

07.08. - 14.08.2027 10.980 € 12.200 €	14.08. - 21.08.2027 10.980 € 12.200 €	21.08. - 28.08.2027 9.135 € 10.150 €	28.08. - 04.09.2027 9.135 € 10.150 €
04.09. - 11.09.2027 9.135 € 10.150 €	11.09. - 18.09.2027 8.010 € 8.900 €	18.09. - 25.09.2027 8.010 € 8.900 €	25.09. - 02.10.2027 6.480 € 7.200 €
02.10. - 09.10.2027 6.300 € 7.000 €	09.10. - 16.10.2027 5.760 € 6.400 €	16.10. - 23.10.2027 4.500 € 5.000 €	23.10. - 30.10.2027 4.500 € 5.000 €
30.10. - 06.11.2027 4.500 € 5.000 €	06.11. - 13.11.2027 4.500 € 5.000 €	13.11. - 20.11.2027 4.500 € 5.000 €	20.11. - 27.11.2027 4.500 € 5.000 €
27.11. - 04.12.2027 4.500 € 5.000 €	04.12. - 11.12.2027 4.500 € 5.000 €	11.12. - 18.12.2027 4.500 € 5.000 €	18.12. - 25.12.2027 4.500 € 5.000 €



WEBSITE

www.plujeme.cz



E-MAIL

info@plujeme.cz



PHONE

+420 720 755 085



MOBILE

+420 777 170 276



PLUJEME RÁDI S.R.O.

Dlouhá 730/35, 11000 Praha 1 – Staré Město, Czech Republic