

HANSE 548

Adele (2022)

Sailing yacht Hanse 548 Adele, built in 2022 is anchored in the Trogir, Yachtclub Seget (Marina Baotic), Split region, Croatia. It has 5 + 1 cabins, can accommodate 10 + 2 people and has 3 + 1 toilets. Bed linen and kitchen equipment are included in the price.

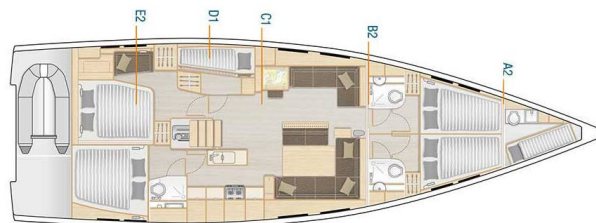

YACHT SPECIFICATIONS

Yacht Base

Trogir, Yachtclub Seget (Marina Baotic), Croatia

Yacht ID

7686

Brands

Hanse Yachts

Yacht name

Adele

Production year

2022

Length

53 ft

Cabins

5 + 1

Berths

10 + 2

Max Persons

12

WC

3 + 1

Engine

1 x 110 HP

Fuel tank

520 l



WEBSITE

www.plujeme.cz



PHONE

+420 720 755 085



MOBILE

+420 777 170 276



E-MAIL

info@plujeme.cz



PLUJEME RÁDI S.R.O.

Dlouhá 730/35, 11000 Praha 1 – Staré Město, Czech Republic

STANDARD YACHT EQUIPMENT

Additional	Skipper's CV / sailing resume required upon booking confirmation
Comfort	Bed linen, Cockpit cushions
Deck	Bimini top, Cockpit table, Cockpit/stern, outside shower, Dinghy, Electric anchor windlass, Hydraulic lifting swimming platform, Sprayhood, Teak cockpit
Entertainment	Outdoor speakers, Radio CD player + USB
Galley	Freezer, Gas cookers, Hot water, Kitchen utensils (Galley equipment, cutlery), Oven, Refrigerator, Stove
Interior	Electric toilet
Navigation	AIS, Autopilot, Bow thruster, GPS chart plotter - cockpit, Navigation (Nautical) charts and nautical guide, Pilot book, Tridata
Safety	Set of tools, VHF radio
Sails	Electric primary winch
Yacht electrics	Air Conditioning, Battery charger, Generator, Heating, Inverter



WEBSITE

www.plujeme.cz



PHONE

+420 720 755 085



MOBILE

+420 777 170 276



E-MAIL

info@plujeme.cz



PLUJEME RÁDI S.R.O.

Dlouhá 730/35, 11000 Praha 1 – Staré Město, Czech Republic

SERVICES

SELECTED SERVICES	OBLIGATORY	PAYMENT TYPE	PRICE
Beach towel (Payable at the base) Season: 2026.	Yes	per person	0,00 €
Coffee machine (Payable at the base) Season: 2026.	Yes	per booking	0,00 €
Comfort pack (Payable now) Season: 2026. 25% VAT, bed linen, towels, final cleaning, diver check upon check-out, gas in the kitchen, small start up kit	Yes	per booking	490,00 €
Outboard engine (Payable now) Season: 2026. Included in price	Yes	per booking	0,00 €
WI-FI Internet connection on boat (Payable at the base) Season: 2026. Unlimited	Yes	per booking	0,00 €
Crew change (Payable now) Season: 2026. includes: divers inspection, check-in, crew list	No	per booking	150,00 €
Early boarding/check-in (Payable now) Season: 2026. at 13:00H (Limited availability)	No	per booking	220,00 €
Early boarding/check-in (Payable at the base) Season: 2026. 14h, limited, upon request	No	per booking	0,00 €
Extra cleaning (Payable now) Season: 2026. cleaning boat inside, bed linen, towels	No	per booking	350,00 €
Hostess (Payable now) Season: 2026. a cabin or forepeak to sleep and access to a WC/Shower (Obligatory payment and confirmation in advance, at least 2 weeks before the start date)	No	per day + food	210,00 €
Late check out (Payable now) Season: 2026. until 10:00am; Late check-out can be confirmed only on check-in with base manger	No	per booking	300,00 €
Late check out (Payable at the base) Season: 2026. Saturday 11h, limited, upon request	No	per booking	0,00 €

One way (Payable now)	No	one-way	750,00 €
Season: 2026. (Trogir - Dubrovnik/Dubrovnik - Trogir); mooring fees in Dubrovnik not included			
Parking (Payable at the base)	No	per week	90,00 €
Season: 2026. Parking spot reservation: discounted rate payment in cash on check in, limited availability, valid for one car per reservation. For longer and shorter stays, the price is on request.			
Permit for Montenegro (Payable now)	No	per booking	350,00 €
Season: 2026. 11 days and more			
Regatta charge (Payable now)	No	per booking	0,00 €
Season: 2026. +10% from list price, double deposit to be paid			
Skipper (Payable now)	No	per day + food	250,00 €
Season: 2026. a cabin or forepeak to sleep and access to a WC/Shower (Obligatory payment and confirmation in advance, at least 2 weeks before the start date)			
Stress free package (Payable now)	No	per booking	400,00 €
Season: 2026. beach towels, Nescafé dolce gusto + 1 coffee pack, ice maker, welcome package (fresh fruit, water, juices, wine), SUP, inflatable beach toys set			



WEBSITE

www.plujeme.cz



E-MAIL

info@plujeme.cz



PHONE

+420 720 755 085



MOBILE

+420 777 170 276



PLUJEME RÁDI S.R.O.

Dlouhá 730/35, 11000 Praha 1 - Staré Město, Czech Republic

ADDITIONAL EXTRAS

EXTRA	OBLIGATORY	PAYMENT TYPE	PRICE
Additional gas bottle (Payable now) <i>Season: 2026. Payable now</i>	No	per booking	15,00 €
Automatic Inflatable Life Jacket (Payable now) <i>Season: 2026. Limited availability - Payable now</i>	No	per week/ person	15,00 €
Extra bedlinen (Payable now) <i>Season: 2026. Payable now</i>	No	per week/ person	7,00 €
Extra towels (Payable now) <i>Season: 2026. set, 2 pcs - Payable now</i>	No	per week/ person	5,00 €
Fuel for an outboard engine - 5 lit. (Payable now) <i>Season: 2026. Payable now</i>	No	per booking	10,00 €
Gennaker (Payable now) <i>Season: 2026. + 400€ refundable deposit; limited availability, must be booked at least 2 weeks before, double price and deposit for reggatas - Payable now</i>	No	per week	500,00 €
Grill/Barbecue/Plancha (Payable now) <i>Season: 2026. Payable now</i>	No	per week	100,00 €
Ice maker (Payable now) <i>Season: 2026. Payable now</i>	No	per week	50,00 €
Kayak tandem (Payable now) <i>Season: 2026. Payable now</i>	No	per week	140,00 €
Outboard engine (Payable now) <i>Season: 2026. 6hp - Payable now</i>	No	per week	100,00 €
Railing net (Safety net) (Payable now) <i>Season: 2026. Payable now</i>	No	per booking	160,00 €
Snorkeling equipment (Payable now) <i>Season: 2026. flippers, tube, mask - Payable now</i>	No	per week/ person	12,00 €
Stand up paddle (SUP) (Payable now) <i>Season: 2026. limited availability - Payable now</i>	No	per week	120,00 €

Water toys (Payable now)

No

per booking

30,00 €

Season: 2026. Payable now



WEBSITE

www.plujeme.cz



E-MAIL

info@plujeme.cz



PHONE

+420 720 755 085



MOBILE

+420 777 170 276



PLUJEME RÁDI S.R.O.

Dlouhá 730/35, 11000 Praha 1 – Staré Město, Czech Republic

PRICE AND AVAILABILITY

25.04. - 02.05.2026 1.980 € 3.600 €	02.05. - 09.05.2026 2.255 € 4.100 €	09.05. - 16.05.2026 2.365 € 4.300 €	16.05. - 23.05.2026 2.640 € 4.800 €
23.05. - 30.05.2026 2.805 € 5.100 €	30.05. - 06.06.2026 NOT AVAILABLE	06.06. - 13.06.2026 ON OPTION	13.06. - 20.06.2026 ON OPTION
20.06. - 27.06.2026 NOT AVAILABLE	27.06. - 04.07.2026 4.655 € 7.000 €	04.07. - 11.07.2026 5.250 € 7.000 €	11.07. - 18.07.2026 ON OPTION
18.07. - 25.07.2026 NOT AVAILABLE	25.07. - 01.08.2026 5.925 € 7.900 €	01.08. - 08.08.2026 5.925 € 7.900 €	08.08. - 15.08.2026 ON OPTION
15.08. - 22.08.2026 5.363 € 7.150 €	22.08. - 29.08.2026 NOT AVAILABLE	29.08. - 05.09.2026 4.950 € 6.600 €	05.09. - 12.09.2026 NOT AVAILABLE
12.09. - 19.09.2026 NOT AVAILABLE	19.09. - 26.09.2026 NOT AVAILABLE	26.09. - 03.10.2026 NOT AVAILABLE	03.10. - 10.10.2026 NOT AVAILABLE
10.10. - 17.10.2026 2.400 € 3.200 €	17.10. - 24.10.2026 2.400 € 3.200 €	24.10. - 31.10.2026 2.400 € 3.200 €	31.10. - 07.11.2026 2.400 € 3.200 €
07.11. - 14.11.2026 2.400 € 3.200 €	14.11. - 21.11.2026 2.400 € 3.200 €	21.11. - 28.11.2026 2.400 € 3.200 €	28.11. - 05.12.2026 3.200 €



WEBSITE

www.plujeme.cz



E-MAIL

info@plujeme.cz



PHONE

+420 720 755 085



MOBILE

+420 777 170 276



PLUJEME RÁDI S.R.O.

Dlouhá 730/35, 11000 Praha 1 – Staré Město, Czech Republic

PRICE AND AVAILABILITY

05.12. - 12.12.2026

3.200 €

12.12. - 19.12.2026

3.200 €

19.12. - 26.12.2026

3.200 €



WEBSITE

www.plujeme.cz



E-MAIL

info@plujeme.cz



PHONE

+420 720 755 085



MOBILE

+420 777 170 276



PLUJEME RÁDI S.R.O.

Dlouhá 730/35, 11000 Praha 1 – Staré Město, Czech Republic