

LAGOON 400 S2

Sunshine (2013)

Catamaran Lagoon 400 S2 Sunshine, built in 2013 is anchored in the **ACI Marina Split, Split region, Croatia**. It has **4 + 2 cabins**, can accommodate **8 + 2 + 2 people** and has **4 toilets**. Bed linen and kitchen equipment are included in the price.

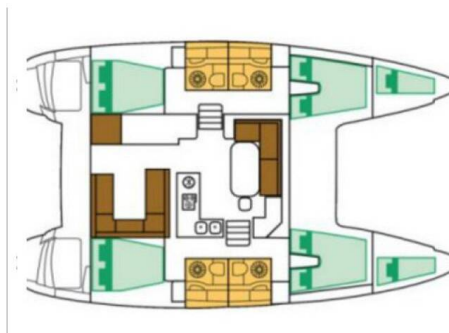

YACHT SPECIFICATIONS

Yacht Base

ACI Marina Split, Croatia

Yacht ID

7633

Brands

Lagoon

Yacht name

Sunshine

Production year

2013

Length

39 ft

Cabins

4 + 2

Berths

8 + 2 + 2

WC

4

Engine

2 x 0 HP

Fuel tank

0 l



WEBSITE

www.plujeme.cz



PHONE

+420 720 755 085



MOBILE

+420 777 170 276



E-MAIL

info@plujeme.cz



PLUJEME RÁDI S.R.O.

Dlouhá 730/35, 11000 Praha 1 – Staré Město, Czech Republic

STANDARD YACHT EQUIPMENT

Comfort	Cockpit cushions
Deck	Bimini top, Cockpit/stern, outside shower, Dinghy, Electric anchor windlass, Sprayhood
Entertainment	Outdoor speakers, USB, Wi-Fi Internet
Galley	Hot water, Refrigerator
Navigation	Autopilot, GPS chart plotter
Safety	VHF radio
Sails	Electric main sail winch, Lazy bag, Lazy jacks
Yacht electrics	Air Conditioning, Heating, Inverter, Shore connection 220 V, Solar panels



WEBSITE

www.plujeme.cz



E-MAIL

info@plujeme.cz



PHONE

+420 720 755 085



MOBILE

+420 777 170 276



PLUJEME RÁDI S.R.O.

Dlouhá 730/35, 11000 Praha 1 – Staré Město, Czech Republic

SERVICES

SELECTED SERVICES	OBLIGATORY	PAYMENT TYPE	PRICE
Comfort Pack (Payable at the base) Season: 2026. includes: final cleaning, outboard engine 4 HP, cockpit cushions, WIFI 200 GB, bedlinen, 1 big (70x130 cm) + 1 medium sized towel (50x90 cm) pp, 1 soap per toilet, gas, kitchen sponges	Yes	per booking	410,00 €
Booking changed (Payable at the base) Season: 2026. changing boat or period	No	per booking	100,00 €
Cook (Payable at the base) Season: 2026.	No	per day + food	300,00 €
Early Check in (Payable at the base) Season: 2026. at 2pm	No	per booking	150,00 €
Early Check in (Payable at the base) Season: 2026. at 1pm	No	per booking	200,00 €
Hostess (Payable at the base) Season: 2026. up to 4 guests, payable on the spot in cash	No	per day + food	190,00 €
Hostess (Payable at the base) Season: 2026. 5-8 guests, payable on the spot in cash	No	per day + food	210,00 €
Late check out (Payable at the base) Season: 2026. at 11am	No	per booking	150,00 €
Service fee for filling up fuel tank (Payable at the base) Season: 2026.	No	per service	250,00 €
Skipper (Payable at the base) Season: 2026. payable on the spot in cash	No	per day + food	210,00 €
Transfer (Payable at the base) Season: 2026. from airport to marina, up to 7 pax	No	per booking	75,00 €
Transfer 1 (Payable at the base) Season: 2026. from airport to marina, 8-16 pax	No	per booking	110,00 €



WEBSITE

www.plujeme.cz



E-MAIL

info@plujeme.cz



PHONE

+420 720 755 085



MOBILE

+420 777 170 276



PLUJEME RÁDI S.R.O.

Dlouhá 730/35, 11000 Praha 1 – Staré Město, Czech Republic

ADDITIONAL EXTRAS

EXTRA	OBLIGATORY	PAYMENT TYPE	PRICE
Beach towel (Payable at the base) Season: 2026. Payable at the base	No	per week	10,00 €
Extra bedlinen (Payable at the base) Season: 2026. Payable at the base	No	per person	10,00 €
Extra towels (Payable at the base) Season: 2026. Payable at the base	No	per week	30,00 €
Kayak (Payable at the base) Season: 2026. 1 seat - Payable at the base	No	per week	170,00 €
Kayak tandem (Payable at the base) Season: 2026. 2 seats - Payable at the base	No	per week	220,00 €
NESPRESSO coffee machine (Payable at the base) Season: 2026. +50 capsules - Payable at the base	No	per week	50,00 €
Railing net (Safety net) (Payable at the base) Season: 2026. Payable at the base	No	per booking	120,00 €
Sea Scooter (Payable at the base) Season: 2026. Payable at the base	No	per week	120,00 €
Snorkeling equipment (Payable at the base) Season: 2026. 1 set - Payable at the base	No	per week	15,00 €
Stand up paddle (SUP) (Payable at the base) Season: 2026. Payable at the base	No	per week	100,00 €
Water slide (Payable at the base) Season: 2026. FLOATICO inflatable slide - Payable at the base	No	per week	210,00 €



WEBSITE
www.plujeme.cz



PHONE
+420 720 755 085



MOBILE
+420 777 170 276



E-MAIL
info@plujeme.cz



PLUJEME RÁDI S.R.O.
Dlouhá 730/35, 11000 Praha 1 – Staré Město, Czech Republic

PRICE AND AVAILABILITY

02.05. - 09.05.2026 1.800 € 3.000 €	09.05. - 16.05.2026 1.800 € 3.000 €	16.05. - 23.05.2026 1.950 € 3.900 €	23.05. - 30.05.2026 2.340 € 3.900 €
30.05. - 06.06.2026 NOT AVAILABLE	06.06. - 13.06.2026 3.843 € 5.490 €	13.06. - 20.06.2026 NOT AVAILABLE	20.06. - 27.06.2026 5.232 € 6.540 €
27.06. - 04.07.2026 NOT AVAILABLE	04.07. - 11.07.2026 NOT AVAILABLE	11.07. - 18.07.2026 NOT AVAILABLE	18.07. - 25.07.2026 5.592 € 6.990 €
25.07. - 01.08.2026 NOT AVAILABLE	01.08. - 08.08.2026 NOT AVAILABLE	12.08. - 19.08.2026 NOT AVAILABLE	22.08. - 29.08.2026 NOT AVAILABLE
29.08. - 05.09.2026 4.453 € 6.850 €	05.09. - 12.09.2026 4.316 € 6.640 €	12.09. - 19.09.2026 3.984 € 6.640 €	19.09. - 26.09.2026 3.220 € 4.600 €
26.09. - 03.10.2026 3.680 € 4.600 €	03.10. - 10.10.2026 3.680 € 4.600 €	10.10. - 17.10.2026 2.400 € 3.000 €	17.10. - 24.10.2026 2.400 € 3.000 €
24.10. - 31.10.2026 2.400 € 3.000 €	31.10. - 07.11.2026 2.400 € 3.000 €	07.11. - 14.11.2026 3.000 €	14.11. - 21.11.2026 3.000 €
21.11. - 28.11.2026 3.000 €	28.11. - 05.12.2026 3.000 €	05.12. - 12.12.2026 3.000 €	12.12. - 19.12.2026 3.000 €
19.12. - 26.12.2026 3.000 €			



WEBSITE

www.plujeme.cz



E-MAIL

info@plujeme.cz



PHONE

+420 720 755 085



MOBILE

+420 777 170 276



PLUJEME RÁDI S.R.O.

Dlouhá 730/35, 11000 Praha 1 – Staré Město, Czech Republic