

# FOUNTAINE PAJOT ISLA 40

Artemis (2021)

Catamaran Fountaine Pajot Isla 40 Artemis, built in 2021 is anchored in the **Lefkas, D-Marin, Ionian Islands, Greece**. It has **4 + 1 cabins**, can accommodate **8 + 1 people** and has **4 + 1 toilets**. Bed linen and kitchen equipment are included in the price.

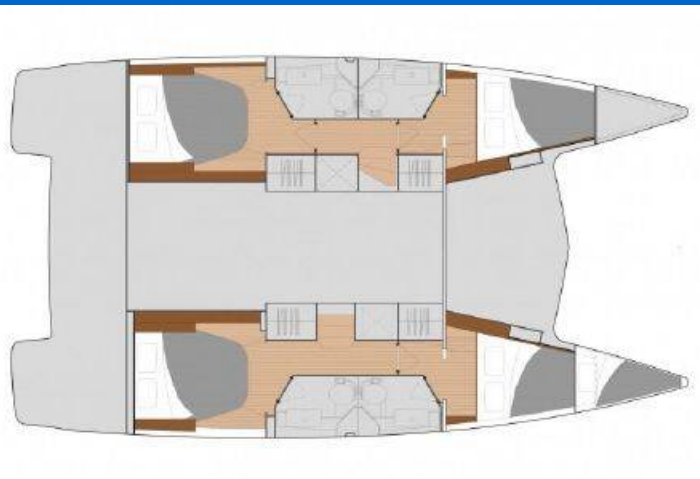

## YACHT SPECIFICATIONS

Yacht Base

**Lefkas, D-Marin, Greece**

Yacht ID

**7550**

Brands

**Fountaine Pajot**

Yacht name

**Artemis**

Production year

**2021**

Length

**39 ft**

Cabins

**4 + 1**

Berths

**8 + 1**

Max Persons

**10**

WC

**4 + 1**

Engine

**2 x 40 HP**

Fuel tank

**300 l**



**WEBSITE**

[www.plujeme.cz](http://www.plujeme.cz)



**PHONE**

+420 720 755 085



**MOBILE**

+420 777 170 276



**E-MAIL**

[info@plujeme.cz](mailto:info@plujeme.cz)



**PLUJEME RÁDI S.R.O.**

Dlouhá 730/35, 11000 Praha 1 – Staré Město, Czech Republic

## STANDARD YACHT EQUIPMENT

|                 |  |
|-----------------|--|
| Comfort         | <b>Cockpit cushions, Mosquito nets</b>   |
| Deck            | <b>Bimini top, Black ball, Black conus, Boat hook, Bosun's chair (Safe seat) (boatswain's chair), Cockpit table, Deck brush, Dinghy, Electric anchor windlass, Fuel funnel, Gangway, Inox Boarding Ladder, Jerry cans for diesel, Jerry cans for fuel, Mooring ropes, Outboard engine, Plastic bucket, Remote control for anchor winch with chain counter at helm, Repair box for dinghy, Spare anchor (Reserve, Auxiliary anchor), Spotlight / Headlights, Teak cockpit, Water hose</b> |
| Entertainment   | <b>Fusion radio, Indoor speakers, Outdoor speakers, Snorkeling equipment, TV</b>   |
| Galley          | <b>Coffee pot, Electrical kettle, Gas bottles, Kitchen utensils (Galley equipment, cutlery), Refrigerator, Stove, Water pump</b>   |
| Interior        | <b>Barometer, Electric fans, Indirect lighting in cabins and salon</b>   |
| Navigation      | <b>AIS, Autopilot, Binoculars, Divider, nautic chart, Hand bearing compass, Nautical charts, Navigation/position Lights, Parallel ruler, Radar reflector, Wind/speed/depth instruments</b>   |
| Safety          | <b>Bow shield, Buoyant smoke signal, Distress flare box, Engine spare parts, EPIRB-Distress radio beacons, Extra water tank, Fire blanket, Fire extinguisher, First aid kit, Flags QNC, Fog horn, Horseshoe lifebuoy, Life jacket (children), Life jackets, Liferaft, Padlock, Search light, Set of tools, Signaling mirror, VHF radio, Wire (shroud) cutter</b>   |
| Sails           | <b>Lazy bag</b>  |
| Yacht electrics | <b>Air Conditioning, Battery charger, Battery monitor, Generator, Shore power cable, Shore power connection, Solar panels, Watermaker - desalinator</b>  |



**WEBSITE**

[www.plujeme.cz](http://www.plujeme.cz)



**PHONE**

+420 720 755 085



**MOBILE**

+420 777 170 276



**E-MAIL**

[info@plujeme.cz](mailto:info@plujeme.cz)



**PLUJEME RÁDI S.R.O.**

Dlouhá 730/35, 11000 Praha 1 – Staré Město, Czech Republic

## SERVICES

| SELECTED SERVICES  | OBLIGATORY | PAYMENT TYPE    | PRICE           |
|--|------------|-----------------|-----------------|
| <b>Charter pack</b> (Payable at the base)<br><b>Season: 2026.</b> includes End Cleaning, Bed Linen & Towels, 1 Gas Bottle, batteries, Water  | Yes        | per booking     | <b>300,00 €</b> |
| <b>Crew list change</b> (Payable at the base)<br><b>Season: 2026.</b> Crew change includes administration fee and new crew list to the port authority  | No         | per crew change | <b>50,00 €</b>  |
| <b>Early boarding/check-in</b> (Payable at the base)<br><b>Season: 2026.</b> Check in until 13:00 - (must be reconfirmed and depends on if yacht needs repair from charter before)   | No         | per booking     | <b>170,00 €</b> |
| <b>Hostess</b> (Payable at the base)<br><b>Season: 2026.</b> Paid on spot in cash. Food provided by clients or to be paid an extra 30€/day, Hostess must have his own cabin.   | No         | per day + food  | <b>180,00 €</b> |
| <b>Late Check in</b> (Payable at the base)<br><b>Season: 2026.</b> On Sunday   | No         | per booking     | <b>100,00 €</b> |
| <b>One way fee</b> (Payable at the base)<br><b>Season: 2026.</b> Corfu - Lefkas; Lefkas - Corfu  | No         | one-way         | <b>500,00 €</b> |
| <b>Provisioning</b> (Payable at the base)<br><b>Season: 2026.</b> order form will be forwarded upon request. Please fill it in and email it back to us, at least 7 days before embarkation. Upon your arrival your food and drinks will be onboard               | No         | per service     | <b>30,00 €</b>  |
| <b>Skipper</b> (Payable at the base)<br><b>Season: 2026.</b> Paid on spot in cash. Food provided by clients or to be paid an extra 30€/day. Skipper must have his own cabin and access to one of the toilets. Damage waiver is obligatory on skippered charters. | No         | per day + food  | <b>190,00 €</b> |
| <b>Transfer</b> (Payable at the base)<br><b>Season: 2026.</b> upon request 7 days before the starting day  | No         | per booking     | <b>0,00 €</b>   |
| <b>WI-FI Internet connection on boat</b> (Payable at the base)<br><b>Season: 2026.</b> 5GB, up to 10 connections (deposit €100)  | No         | per week        | <b>50,00 €</b>  |



**WEBSITE**  
www.plujeme.cz



**E-MAIL**  
info@plujeme.cz



**PHONE**  
+420 720 755 085



**MOBILE**  
+420 777 170 276



**PLUJEME RÁDI S.R.O.**  
Dlouhá 730/35, 11000 Praha 1 – Staré Město, Czech Republic

## ADDITIONAL EXTRAS

| EXTRA  | OBLIGATORY | PAYMENT TYPE | PRICE           |
|--|------------|--------------|-----------------|
| <b>Blister</b> (Payable at the base)<br><b>Season: 2026.</b> + extra security deposit 500 EUR (refundable) - Payable at the base | No         | per week     | <b>250,00 €</b> |
| <b>Extra bedlinen</b> (Payable at the base)<br><b>Season: 2026.</b> Payable at the base  | No         | per set      | <b>15,00 €</b>  |
| <b>Railing net (Safety net)</b> (Payable at the base)<br><b>Season: 2026.</b> installed - Payable at the base                    | No         | per booking  | <b>250,00 €</b> |
| <b>Stand up paddle (SUP)</b> (Payable at the base)<br><b>Season: 2026.</b> Payable at the base                                   | No         | per week     | <b>130,00 €</b> |



#### WEBSITE

[www.plujeme.cz](http://www.plujeme.cz)



#### E-MAIL

[info@plujeme.cz](mailto:info@plujeme.cz)



#### PHONE

+420 720 755 085



#### MOBILE

+420 777 170 276



#### PLUJEME RÁDI S.R.O.

Dlouhá 730/35, 11000 Praha 1 – Staré Město, Czech Republic

## PRICE AND AVAILABILITY

|  |  |  |  |
|--|--|--|--|
| 06.06. - 13.06.2026<br>NOT AVAILABLE   | 13.06. - 20.06.2026<br>NOT AVAILABLE   | 20.06. - 27.06.2026<br>NOT AVAILABLE   | 27.06. - 04.07.2026<br>NOT AVAILABLE   |
| 04.07. - 11.07.2026<br>NOT AVAILABLE   | 11.07. - 18.07.2026<br>ON OPTION       | 18.07. - 25.07.2026<br>NOT AVAILABLE   | 25.07. - 01.08.2026<br>NOT AVAILABLE   |
| 01.08. - 08.08.2026<br>NOT AVAILABLE   | 08.08. - 15.08.2026<br>NOT AVAILABLE   | 15.08. - 22.08.2026<br>NOT AVAILABLE   | 22.08. - 29.08.2026<br>NOT AVAILABLE   |
| 29.08. - 05.09.2026<br>NOT AVAILABLE   | 05.09. - 12.09.2026<br>NOT AVAILABLE   | 12.09. - 19.09.2026<br>NOT AVAILABLE   | 19.09. - 26.09.2026<br>NOT AVAILABLE   |
| 26.09. - 03.10.2026<br>NOT AVAILABLE   | 03.10. - 10.10.2026<br>NOT AVAILABLE   | 10.10. - 17.10.2026<br>NOT AVAILABLE   | 17.10. - 24.10.2026<br>3.740 € 4.400 € |
| 24.10. - 31.10.2026<br>3.740 € 4.400 € | 31.10. - 07.11.2026<br>3.740 € 4.400 € | 07.11. - 14.11.2026<br>3.740 € 4.400 € | 14.11. - 21.11.2026<br>3.740 € 4.400 € |
| 21.11. - 28.11.2026<br>3.740 € 4.400 € | 28.11. - 05.12.2026<br>3.740 € 4.400 € | 05.12. - 12.12.2026<br>4.400 €         | 12.12. - 19.12.2026<br>4.400 €         |
| 19.12. - 26.12.2026<br>4.400 €         |  |  |  |



**WEBSITE**  
www.plujeme.cz



**E-MAIL**  
info@plujeme.cz



**PHONE**  
+420 720 755 085



**PLUJEME RÁDI S.R.O.**  
Dlouhá 730/35, 11000 Praha 1 – Staré Město, Czech Republic



**MOBILE**  
+420 777 170 276