

BALI 4.2

Merlot (2024)

Catamaran Bali 4.2 Merlot, built in **2024** is anchored in the **Marina Pirovac, Šibenik region, Croatia**. It has **4 + 1 cabins**, can accommodate **8 + 2 + 1 people** and has **4 + 1 toilets**. Bed linen and kitchen equipment are included in the price.

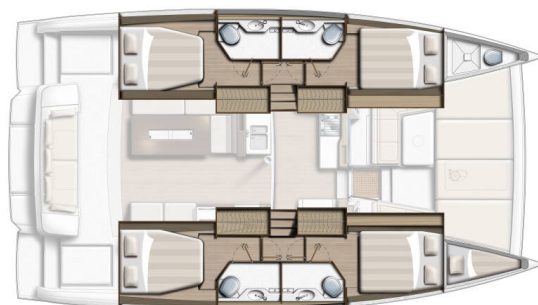

YACHT SPECIFICATIONS

Yacht Base

Marina Pirovac, Croatia

Yacht ID

7533

Brands

Catana

Yacht name

Merlot

Production year

2024

Length

42 ft

Cabins

4 + 1

Berths

8 + 2 + 1

WC

4 + 1

Engine

2 x 47 HP

Fuel tank

640 l



WEBSITE

www.plujeme.cz



PHONE

+420 720 755 085



MOBILE

+420 777 170 276



E-MAIL

info@plujeme.cz



PLUJEME RÁDI S.R.O.

Dlouhá 730/35, 11000 Praha 1 – Staré Město, Czech Republic

STANDARD YACHT EQUIPMENT

Comfort	Cockpit cushions, Mosquito nets, Outside cushions, Sun loungers, Sun mattresses
Deck	Anchor with chain, Cockpit table, Cockpit/stern, outside shower, Davit, Dinghy with outboard engine, Electric anchor windlass, Fenders, Fly sunbathing area, Flybridge, Grill/Barbecue/Plancha, Mooring ropes, Swimming ladder
Entertainment	Fusion radio
Galley	Freezer, Hot water, Microwave, Oven, Refrigerator
Interior	Curtains, Electric fans in cabins, Electric toilet, Indirect lighting in cabins and salon
Navigation	Autopilot, Compass, GPS chart plotter, Raymarine navsystem (Tridata, Echo, Wind), Wind/speed/depth instruments
Safety	First aid kit, Horseshoe lifebuoy, Liferaft, Safety equipment, VHF radio
Sails	Electric winch, Lazy bag, Lazy jacks
Yacht electrics	Battery charger, Inverter, Service batteries, Solar panels



WEBSITE

www.plujeme.cz



E-MAIL

info@plujeme.cz



PHONE

+420 720 755 085



MOBILE

+420 777 170 276



PLUJEME RÁDI S.R.O.

Dlouhá 730/35, 11000 Praha 1 – Staré Město, Czech Republic

SERVICES

SELECTED SERVICES	OBLIGATORY	PAYMENT TYPE	PRICE
Transit log (Payable now) Season: 2026. Gas, bed linen, final cleaning, Wi-Fi, diver, first & last night in Marina Pirovac, towels	Yes	per booking	430,00 €
Divers inspection (Payable at the base) Season: 2026.	No	per service	150,00 €
Extra cleaning (Payable at the base) Season: 2026.	No	per booking	150,00 €
Hostess (Payable at the base) Season: 2026.	No	per day	200,00 €
Non-standard check-in/check-out (Payable at the base) Season: 2026.	No	per booking	150,00 €
Pet on board (Payable at the base) Season: 2026.	No	per booking	150,00 €
Priority check in (Payable at the base) Season: 2026. check in from 13h to 15h	No	per booking	150,00 €
Provisioning (Payable at the base) Season: 2026. with local products, olive oil, vegetables etc. - at request	No	per booking	0,00 €
Security Deposit Reduction (Payable at the base) Season: 2026. + 600EUR refundable deposit	No	per booking	500,00 €
Skipper (Payable at the base) Season: 2026.	No	per day	250,00 €



WEBSITE
www.plujeme.cz



PHONE
+420 720 755 085



MOBILE
+420 777 170 276



E-MAIL
info@plujeme.cz



PLUJEME RÁDI S.R.O.
Dlouhá 730/35, 11000 Praha 1 – Staré Město, Czech Republic

ADDITIONAL EXTRAS

EXTRA	OBLIGATORY	PAYMENT TYPE	PRICE
Beach towel (Payable at the base) Season: 2026. Payable at the base	No	per booking	80,00 €
Coffee machine (Payable at the base) Season: 2026. Nespresso, 16 capsules - Payable at the base	No	per booking	40,00 €
Extra bedlinen and towels (Payable at the base) Season: 2026. Payable at the base	No	per set	10,00 €
Extra towels (Payable at the base) Season: 2026. Set - Payable at the base	No	per week	50,00 €
Outboard engine (Payable at the base) Season: 2026. Payable at the base	No	per week	0,00 €
Railing net (Safety net) (Payable at the base) Season: 2026. Payable at the base	No	per booking	120,00 €
Seabob (Payable at the base) Season: 2026. price on request / per order, it needs to be ordered before charter - limited availability - Payable at the base	No	per week	0,00 €
Stand up paddle (SUP) (Payable at the base) Season: 2026. Payable at the base	No	per booking	120,00 €



WEBSITE
www.plujeme.cz



E-MAIL
info@plujeme.cz



PHONE
+420 720 755 085



PLUJEME RÁDI S.R.O.
Dlouhá 730/35, 11000 Praha 1 – Staré Město, Czech Republic



MOBILE
+420 777 170 276

PRICE AND AVAILABILITY

25.04. - 02.05.2026 2.400 € 3.200 €	02.05. - 09.05.2026 2.550 € 3.400 €	09.05. - 16.05.2026 NOT AVAILABLE	16.05. - 23.05.2026 3.600 € 4.800 €
23.05. - 30.05.2026 4.500 € 6.000 €	30.05. - 06.06.2026 4.875 € 6.500 €	06.06. - 13.06.2026 NOT AVAILABLE	13.06. - 20.06.2026 NOT AVAILABLE
20.06. - 27.06.2026 6.300 € 8.400 €	27.06. - 04.07.2026 6.450 € 8.600 €	04.07. - 11.07.2026 NOT AVAILABLE	11.07. - 18.07.2026 NOT AVAILABLE
18.07. - 25.07.2026 6.450 € 8.600 €	25.07. - 01.08.2026 6.675 € 8.900 €	01.08. - 08.08.2026 NOT AVAILABLE	08.08. - 15.08.2026 6.525 € 8.700 €
15.08. - 22.08.2026 6.150 € 8.200 €	22.08. - 29.08.2026 NOT AVAILABLE	29.08. - 05.09.2026 5.400 € 7.200 €	05.09. - 12.09.2026 NOT AVAILABLE
12.09. - 19.09.2026 NOT AVAILABLE	19.09. - 26.09.2026 NOT AVAILABLE	26.09. - 03.10.2026 NOT AVAILABLE	03.10. - 10.10.2026 2.430 € 2.700 €
10.10. - 17.10.2026 2.430 € 2.700 €	17.10. - 24.10.2026 2.430 € 2.700 €	25.10. - 31.12.2026 NOT AVAILABLE	



WEBSITE

www.plujeme.cz



E-MAIL

info@plujeme.cz



PHONE

+420 720 755 085



MOBILE

+420 777 170 276



PLUJEME RÁDI S.R.O.

Dlouhá 730/35, 11000 Praha 1 – Staré Město, Czech Republic