

ELAN IMPRESSION 50

Vuschi (2017)

Sailing yacht **Elan Impression 50 Vuschi**, built in **2017** is anchored in the **Marina Punat, Krk, Kvarner, Croatia**. It has **5 cabins**, can accommodate **10 + 2 people** and has **2 toilets**. Bed linen and kitchen equipment are included in the price.

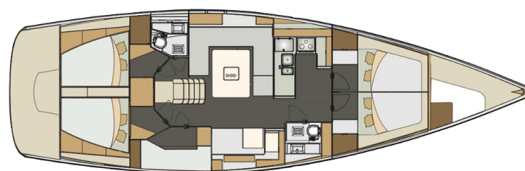

YACHT SPECIFICATIONS

Yacht Base

Marina Punat, Krk, Croatia

Yacht ID

7528

Brands

Elan Marine

Yacht name

Vuschi

Production year

2017

Length

50 ft

Cabins

5

Berths

10 + 2

WC

2

Engine

1 x 0 HP

Fuel tank

0 l



WEBSITE

www.plujeme.cz



PHONE

+420 720 755 085



MOBILE

+420 777 170 276



E-MAIL

info@plujeme.cz



PLUJEME RÁDI S.R.O.

Dlouhá 730/35, 11000 Praha 1 – Staré Město, Czech Republic

STANDARD YACHT EQUIPMENT

Comfort	Bed linen, Blankets, Pillows
Deck	Bimini top, Cockpit table, Cockpit/stern, outside shower, Dinghy, Electric anchor windlass, Sprayhood
Entertainment	Indoor speakers, Outdoor speakers, Radio, USB, Bluetooth
Galley	Gas bottles, Gas cookers, Hot water, Oven, Refrigerator, Sink
Navigation	Autopilot, Bow thruster, Compass, GPS chart plotter - cockpit, Navigation (Nautical) charts and nautical guide, Radar reflector, Wind instrument/Anemometer
Safety	Distress signals, Fire extinguisher, First aid kit, Life belts (Safety harness), Life jackets, VHF radio
Yacht electrics	Batteries, Shore power cable



WEBSITE

www.plujeme.cz



E-MAIL

info@plujeme.cz



PHONE

+420 720 755 085



MOBILE

+420 777 170 276



PLUJEME RÁDI S.R.O.

Dlouhá 730/35, 11000 Praha 1 – Staré Město, Czech Republic

SERVICES

SELECTED SERVICES	OBLIGATORY	PAYMENT TYPE	PRICE
Transit log (Payable at the base) Season: 2026 - Jadranka Yachting. Includes: final cleaning, divers inspection on Friday 6 PM, bed linen for each crew member, made-up beds, Wi-Fi router up to 80GB/week, dinghy, cooking gas.	Yes	per booking	320,00 €
Comfort pack (Payable at the base) Season: 2026 - Jadranka Yachting. outboard engine 2,5 HP, towels (set/2pcs)/person	No	per week	150,00 €
Comfort pack PLUS (Payable at the base) Season: 2026 - Jadranka Yachting. outboard engine 2,5 HP, towels (set/2pcs)/person, early check-in at 14:00 h	No	per week	290,00 €
Deposit insurance (Payable at the base) Season: 2026 - Jadranka Yachting. non-refundable + 300 EUR refundable The deposit insurance policy does not include damage to the sails, damages to or loss of inflatable boat and outboard engine. The security deposit as well as the deposit paid in case of its insurance covers only one damage.	No	per booking	300,00 €
Early boarding/check-in (Payable at the base) Season: 2026 - Jadranka Yachting. at 02:00 PM	No	per booking	200,00 €
Hostess (Payable at the base) Season: 2026 - Jadranka Yachting.	No	per day + food	180,00 €
Late check out (Payable at the base) Season: 2026 - Jadranka Yachting.	No	per booking	250,00 €
One way (Payable at the base) Season: 2026 - Jadranka Yachting. On request	No	one-way	0,00 €
One way (Payable at the base) Season: 2026 - Jadranka Yachting. M.Lošinj-Primošten / Primošten-M.Lošinj	No	per booking	950,00 €
One way (Payable at the base) Season: 2026 - Jadranka Yachting. Pula-Primošten / Primošten-Pula	No	one-way	1.100,00 €
Pet on board (Payable at the base) Season: 2026 - Jadranka Yachting.	No	per booking	200,00 €

Refuel service (Payable at the base)

No

per service

100,00 €

Season: 2026 - Jadranka Yachting.

Skipper (Payable at the base)

No

per day + food

200,00 €

Season: 2026 - Jadranka Yachting.



WEBSITE

www.plujeme.cz



E-MAIL

info@plujeme.cz



PHONE

+420 720 755 085



MOBILE

+420 777 170 276



PLUJEME RÁDI S.R.O.

Dlouhá 730/35, 11000 Praha 1 – Staré Město, Czech Republic

ADDITIONAL EXTRAS

EXTRA	OBLIGATORY	PAYMENT TYPE	PRICE
e-SUP (Payable at the base) Season: 2026 - Jadranka Yachting. on request - Payable at the base	No	per week	270,00 €
Extra bedlinen (Payable at the base) Season: 2026 - Jadranka Yachting. Payable at the base	No	per set	10,00 €
Railing net (Safety net) (Payable at the base) Season: 2026 - Jadranka Yachting. without assembly - Payable at the base	No	per week	30,00 €
Self inflating life vest (Payable at the base) Season: 2026 - Jadranka Yachting. Payable at the base	No	per week	35,00 €

**WEBSITE**www.plujeme.cz**E-MAIL**info@plujeme.cz**PHONE**

+420 720 755 085

**MOBILE**

+420 777 170 276

**PLUJEME RÁDI S.R.O.**

Dlouhá 730/35, 11000 Praha 1 – Staré Město, Czech Republic

PRICE AND AVAILABILITY

25.04. - 02.05.2026 1.365 € 2.100 €	02.05. - 09.05.2026 1.260 € 2.100 €	09.05. - 16.05.2026 1.495 € 2.300 €	16.05. - 23.05.2026 NOT AVAILABLE
23.05. - 30.05.2026 NOT AVAILABLE	30.05. - 06.06.2026 NOT AVAILABLE	06.06. - 13.06.2026 2.893 € 4.450 €	13.06. - 20.06.2026 NOT AVAILABLE
20.06. - 27.06.2026 3.115 € 4.450 €	27.06. - 04.07.2026 3.045 € 4.350 €	04.07. - 11.07.2026 3.638 € 4.850 €	11.07. - 18.07.2026 3.825 € 5.100 €
18.07. - 25.07.2026 4.335 € 5.100 €	25.07. - 01.08.2026 4.240 € 5.300 €	01.08. - 08.08.2026 NOT AVAILABLE	08.08. - 15.08.2026 3.788 € 5.050 €
15.08. - 22.08.2026 3.395 € 4.850 €	22.08. - 29.08.2026 ON OPTION	29.08. - 05.09.2026 NOT AVAILABLE	05.09. - 12.09.2026 3.910 € 4.600 €
12.09. - 19.09.2026 3.698 € 4.350 €	19.09. - 26.09.2026 NOT AVAILABLE	26.09. - 03.10.2026 ON OPTION	03.10. - 10.10.2026 1.650 € 2.750 €
10.10. - 17.10.2026 1.593 € 2.450 €	17.10. - 24.10.2026 1.593 € 2.450 €	24.10. - 31.10.2026 1.593 € 2.450 €	31.10. - 07.11.2026 1.500 € 2.500 €
08.11. - 31.12.2026 NOT AVAILABLE			



WEBSITE
www.plujeme.cz



E-MAIL
info@plujeme.cz



PHONE
+420 720 755 085



PLUJEME RÁDI S.R.O.
Dlouhá 730/35, 11000 Praha 1 – Staré Město, Czech Republic



MOBILE
+420 777 170 276

PRICE AND AVAILABILITY

01.01. - 05.03.2027

NOT AVAILABLE



WEBSITE

www.plujeme.cz



E-MAIL

info@plujeme.cz



PHONE

+420 720 755 085



MOBILE

+420 777 170 276



PLUJEME RÁDI S.R.O.

Dlouhá 730/35, 11000 Praha 1 – Staré Město, Czech Republic

PRICE AND AVAILABILITY

07.11. - 31.12.2027

NOT AVAILABLE



WEBSITE

www.plujeme.cz



E-MAIL

info@plujeme.cz



PHONE

+420 720 755 085



MOBILE

+420 777 170 276



PLUJEME RÁDI S.R.O.

Dlouhá 730/35, 11000 Praha 1 – Staré Město, Czech Republic