

# BALI 4.4

Sunset Chaser (2024)

Catamaran Bali 4.4 Sunset Chaser, built in 2024 is anchored in the Bahamas, Abacos, Boat Harbour Marina, Abaco Islands, Bahamas. It has 3 cabins, can accommodate 6 people and has 3 toilets. Bed linen and kitchen equipment are included in the price.

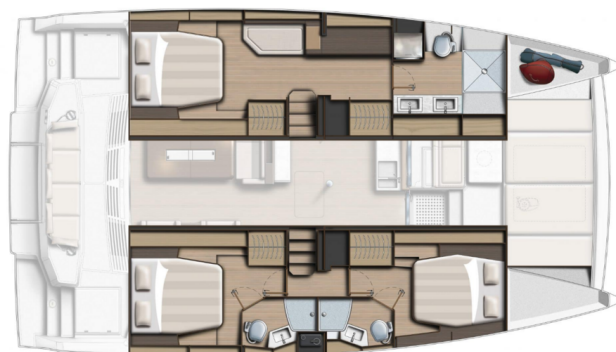

## YACHT SPECIFICATIONS

Yacht Base

**Bahamas, Abacos, Boat Harbour Marina, Bahamas**

Yacht ID

**7069**

Brands

**Catana**

Yacht name

**Sunset Chaser**

Production year

**2024**

Length

**44 ft**

Cabins

**3**

Berths

**6**

Max Persons

**6**

WC

**3**

Engine

**2 x 57 HP**

Fuel tank

**800 l**



**WEBSITE**

[www.plujeme.cz](http://www.plujeme.cz)



**PHONE**

+420 720 755 085



**MOBILE**

+420 777 170 276



**E-MAIL**

[info@plujeme.cz](mailto:info@plujeme.cz)



**PLUJEME RÁDI S.R.O.**

Dlouhá 730/35, 11000 Praha 1 – Staré Město, Czech Republic

## STANDARD YACHT EQUIPMENT

Comfort	<b>Sundeck cushions</b>
Deck	<b>Bimini top, Cockpit fridge, Cockpit table, Cockpit/stern, outside shower, Davit, Dinghy with outboard engine, Electric anchor windlass, Flybridge, Grill/Barbecue/Plancha, Sprayhood</b>
Entertainment	<b>Bluetooth player, Fusion radio, Indoor speakers, Outdoor speakers, Underwater lights</b>
Galley	<b>Freezer, Ice maker, Kitchen utensils (Galley equipment, cutlery), Microwave, Oven, Refrigerator, Stove</b>
Interior	<b>Coolbox, Electric toilet</b>
Navigation	<b>Autopilot, GPS chart plotter - cockpit, Helm station, Wind/speed/depth instruments</b>
Safety	<b>VHF radio</b>
Sails	<b>Electric winch, Lazy bag, Lazy jacks</b>
Yacht electrics	<b>110V socket, Air Conditioning, Generator, Inverter, Shore power connection, Solar panels, USB sockets, Watermaker - desalinator</b>



**WEBSITE**

[www.plujeme.cz](http://www.plujeme.cz)



**PHONE**

+420 720 755 085



**MOBILE**

+420 777 170 276



**E-MAIL**

[info@plujeme.cz](mailto:info@plujeme.cz)



**PLUJEME RÁDI S.R.O.**

Dlouhá 730/35, 11000 Praha 1 - Staré Město, Czech Republic

## SERVICES

SELECTED SERVICES	OBLIGATORY	PAYMENT TYPE	PRICE
<b>Bahamas foreign charter tax</b> (Payable now) <b>Season: 2026.</b>	Yes	per booking	<b>0,00 €</b>
<b>Bahamas Taxes</b> (Payable now) <b>Season: 2026.</b>	Yes	per booking	<b>0,00 €</b>
<b>DRA</b> (Payable now) <b>Season: 2026.</b>	Yes	per day	<b>50,00 €</b>
<b>ASA Processing Fee</b> (Payable now) <b>Season: 2026.</b> Certificate 103	No	per person/per course	<b>150,00 €</b>
<b>ASA Processing Fee</b> (Payable now) <b>Season: 2026.</b> Certificate 101	No	per person/per course	<b>150,00 €</b>
<b>ASA Processing Fee</b> (Payable now) <b>Season: 2026.</b> Certificate 114	No	per person/per course	<b>200,00 €</b>
<b>ASA Processing Fee</b> (Payable now) <b>Season: 2026.</b> Certificate 104	No	per person/per course	<b>200,00 €</b>
<b>ASA Processing Fee</b> (Payable now) <b>Season: 2026.</b> Overnight Open Water. Available only on Flotilla Sails; Certificate 106	No	per person/per course	<b>250,00 €</b>
<b>ASA Processing Fee</b> (Payable now) <b>Season: 2026.</b> Certificate 101, 103 & 104	No	per person/per course	<b>400,00 €</b>
<b>ASA Processing Fee</b> (Payable now) <b>Season: 2026.</b> Overnight Open Water. Available only on Flotilla Sails; Certificate 105	No	per person/per course	<b>400,00 €</b>
<b>ASA Processing Fee</b> (Payable now) <b>Season: 2026.</b> Overnight Open Water. Available only on Flotilla Sails; Certificate 105 & 106	No	per person/per course	<b>550,00 €</b>
<b>Captain By Day</b> (Payable now) <b>Season: 2026.</b>	No	per day + food	<b>350,00 €</b>

<b>Captain By Night</b> (Payable now) <b>Season: 2026.</b>	No	per night	<b>450,00 €</b>
<b>Chef</b> (Payable now) <b>Season: 2026.</b> Overnight	No	per day + food	<b>400,00 €</b>
<b>Credit card surcharge</b> (Payable now) <b>Season: 2026.</b> A 3% convenience fee will be added to all credit card transactions	No	per booking	<b>0,00 €</b>
<b>Daily trips</b> (Payable now) <b>Season: 2026.</b> Trips north from Guana	No	per booking	<b>400,00 €</b>
<b>Education</b> (Payable at the base) <b>Season: 2026.</b> NauticEd skipper training hours	No	per person/per course	<b>100,00 €</b>
<b>Education</b> (Payable at the base) <b>Season: 2026.</b> NauticEd bareboat hours	No	per person/per course	<b>200,00 €</b>
<b>Extra cleaning</b> (Payable at the base) <b>Season: 2026.</b>	No	per service	<b>400,00 €</b>
<b>Fuel charge</b> (Payable now) <b>Season: 2026.</b> + 500,00\$ deposit; This is only for day trips	No	per booking	<b>300,00 €</b>
<b>Gratuity</b> (Payable now) <b>Season: 2026.</b> On Day Trips	No	per booking	<b>220,00 €</b>
<b>Hostess/Cook</b> (Payable now) <b>Season: 2026.</b>	No	per day + food	<b>350,00 €</b>
<b>Participation fee</b> (Payable at the base) <b>Season: 2026.</b> NauticEd sign up fee	No	per person/per course	<b>175,00 €</b>
<b>Rescheduling</b> (Payable now) <b>Season: 2026.</b> On Day Trips	No	per booking	<b>350,00 €</b>
<b>Sleep over after check out</b> (Payable now) <b>Season: 2026.</b>	No	per booking	<b>700,00 €</b>
<b>Sleep over before check in</b> (Payable now) <b>Season: 2026.</b> at 12:00 PM	No	per booking	<b>700,00 €</b>



**WEBSITE**  
www.plujeme.cz



**PHONE**  
+420 720 755 085



**MOBILE**  
+420 777 170 276



**E-MAIL**  
info@plujeme.cz



**PLUJEME RÁDI S.R.O.**  
Dlouhá 730/35, 11000 Praha 1 – Staré Město, Czech Republic

## ADDITIONAL EXTRAS

EXTRA	OBLIGATORY	PAYMENT TYPE	PRICE
<b>Fins</b> (Payable now) <b>Season: 2026.</b> Payable now	No	per week/ person	<b>35,00 €</b>
<b>Fishing cane/rod</b> (Payable now) <b>Season: 2026.</b> Payable now	No	per week	<b>60,00 €</b>
<b>Inflatable swimming platform</b> (Payable now) <b>Season: 2026.</b> POP-UP DOCK - Payable now	No	per week	<b>250,00 €</b>
<b>Kayak</b> (Payable now) <b>Season: 2026.</b> Tandem - Payable now	No	per week	<b>250,00 €</b>
<b>Snorkeling equipment</b> (Payable now) <b>Season: 2026.</b> Payable now	No	per week/ person	<b>50,00 €</b>
<b>Stand up paddle (SUP)</b> (Payable now) <b>Season: 2026.</b> Payable now	No	per week	<b>250,00 €</b>
<b>Starlink</b> (Payable now) <b>Season: 2026.</b> Payable now	No	per week	<b>100,00 €</b>



**WEBSITE**  
www.plujeme.cz



**E-MAIL**  
info@plujeme.cz



**PHONE**  
+420 720 755 085



**PLUJEME RÁDI S.R.O.**  
Dlouhá 730/35, 11000 Praha 1 – Staré Město, Czech Republic



**MOBILE**  
+420 777 170 276

## PRICE AND AVAILABILITY

<b>27.04. - 05.05.2026</b> NOT AVAILABLE	<b>11.05. - 20.05.2026</b> NOT AVAILABLE	<b>23.05. - 30.05.2026</b> <b>6.880 €</b>	<b>30.05. - 07.06.2026</b> NOT AVAILABLE
<b>07.06. - 16.06.2026</b> NOT AVAILABLE	<b>20.06. - 29.06.2026</b> NOT AVAILABLE	<b>04.07. - 11.07.2026</b> <b>6.776 €</b>	<b>11.07. - 18.07.2026</b> <b>6.776 €</b>
<b>22.07. - 30.07.2026</b> NOT AVAILABLE	<b>01.08. - 04.11.2026</b> NOT AVAILABLE	<b>07.11. - 14.11.2026</b> <b>6.776 €</b>	<b>14.11. - 21.11.2026</b> <b>6.776 €</b>
<b>21.11. - 28.11.2026</b> <b>6.776 €</b>	<b>28.11. - 05.12.2026</b> <b>6.776 €</b>		



### WEBSITE

[www.plujeme.cz](http://www.plujeme.cz)



### E-MAIL

[info@plujeme.cz](mailto:info@plujeme.cz)



### PHONE

+420 720 755 085



### MOBILE

+420 777 170 276



### PLUJEME RÁDI S.R.O.

Dlouhá 730/35, 11000 Praha 1 – Staré Město, Czech Republic

## PRICE AND AVAILABILITY

05.12. - 12.12.2026 6.776 €	12.12. - 19.12.2026 6.776 €	19.12. - 26.12.2026 7.458 €	02.01. - 09.01.2027 7.165 €
09.01. - 16.01.2027 6.094 €	16.01. - 23.01.2027 6.094 €	23.01. - 30.01.2027 6.094 €	30.01. - 06.02.2027 6.094 €
06.02. - 13.02.2027 6.094 €	13.02. - 20.02.2027 6.094 €	20.02. - 27.02.2027 6.094 €	27.02. - 06.03.2027 6.630 €
06.03. - 13.03.2027 7.969 €	13.03. - 20.03.2027 7.969 €	20.03. - 27.03.2027 7.969 €	27.03. - 03.04.2027 7.969 €
03.04. - 10.04.2027 7.969 €	10.04. - 17.04.2027 7.969 €	17.04. - 24.04.2027 7.969 €	24.04. - 01.05.2027 7.458 €
01.05. - 08.05.2027 6.776 €	08.05. - 15.05.2027 6.776 €	15.05. - 22.05.2027 6.776 €	22.05. - 29.05.2027 6.776 €
29.05. - 05.06.2027 6.776 €	05.06. - 12.06.2027 6.776 €	12.06. - 19.06.2027 6.776 €	19.06. - 26.06.2027 6.776 €
26.06. - 03.07.2027 6.776 €	03.07. - 10.07.2027 6.776 €	10.07. - 17.07.2027 6.776 €	17.07. - 24.07.2027 6.776 €
24.07. - 31.07.2027 6.776 €	31.07. - 07.08.2027 6.776 €		



**WEBSITE**  
www.plujeme.cz



**E-MAIL**  
info@plujeme.cz



**PHONE**  
+420 720 755 085



**PLUJEME RÁDI S.R.O.**  
Dlouhá 730/35, 11000 Praha 1 – Staré Město, Czech Republic



**MOBILE**  
+420 777 170 276

## PRICE AND AVAILABILITY

07.08. - 14.08.2027 6.776 €	14.08. - 21.08.2027 6.776 €	21.08. - 28.08.2027 6.776 €	28.08. - 04.09.2027 6.776 €
04.09. - 11.09.2027 6.776 €	11.09. - 18.09.2027 6.776 €	18.09. - 25.09.2027 6.776 €	25.09. - 02.10.2027 6.776 €
02.10. - 09.10.2027 6.776 €	09.10. - 16.10.2027 6.776 €	16.10. - 23.10.2027 6.776 €	23.10. - 30.10.2027 6.776 €
30.10. - 06.11.2027 6.776 €	06.11. - 13.11.2027 6.776 €	13.11. - 20.11.2027 6.776 €	20.11. - 27.11.2027 6.776 €
27.11. - 04.12.2027 6.776 €	04.12. - 11.12.2027 6.776 €	11.12. - 18.12.2027 6.776 €	18.12. - 25.12.2027 7.287 €



### WEBSITE

[www.plujeme.cz](http://www.plujeme.cz)



### E-MAIL

[info@plujeme.cz](mailto:info@plujeme.cz)



### PHONE

+420 720 755 085



### MOBILE

+420 777 170 276



### PLUJEME RÁDI S.R.O.

Dlouhá 730/35, 11000 Praha 1 – Staré Město, Czech Republic