

OCEANIS 51.1

Dune (2024)

Sailing yacht **Oceanis 51.1 Dune**, built in **2024** is anchored in the **Marina Frapa, Rogoznica, Šibenik region, Croatia**. It has **5 + 1 cabins**, can accommodate **10 + 2 + 1 people** and has **3 + 1 toilets**. Bed linen and kitchen equipment are included in the price.

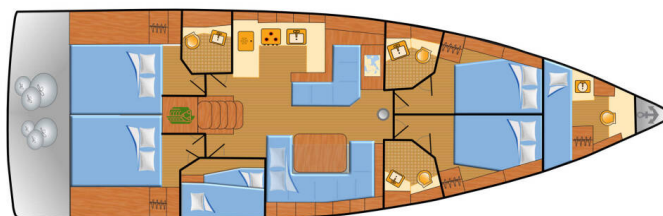

YACHT SPECIFICATIONS

Yacht Base

Marina Frapa, Rogoznica, Croatia

Yacht ID

7026

Brands

Beneteau

Yacht name

Dune

Production year

2024

Length

52 ft

Cabins

5 + 1

Berths

10 + 2 + 1

Max Persons

12

WC

3 + 1

Engine

1 x 108 HP

Fuel tank

200 l



WEBSITE

www.plujeme.cz



PHONE

+420 720 755 085



MOBILE

+420 777 170 276



E-MAIL

info@plujeme.cz



PLUJEME RÁDI S.R.O.

Dlouhá 730/35, 11000 Praha 1 – Staré Město, Czech Republic

STANDARD YACHT EQUIPMENT

Additional	Flag
Comfort	Cockpit cushions
Deck	Anchor light, Bathing platform, Bilge pump - Mechanic, Bimini top, Boat hook, Bosun's chair (Safe seat) (boatswain's chair), Cockpit table, Cockpit/stern, outside shower, Deck brush, Dinghy, Electric anchor windlass, Fenders, Gangway, Mooring ropes, Pulpit seat, Sailor's knife, Sprayhood, Swimming ladder, Teak cockpit
Entertainment	Indoor speakers, Mask and snorkel, Outdoor speakers, Radio, USB, Bluetooth, TV, Wi-Fi Internet, Wireless Internet Router
Galley	Freezer, Gas cookers, Hot water, Kitchen utensils (Galley equipment, cutlery), Oven, Pressurized water system, Refrigerator, Sink
Interior	Barometer, Coolbox, Electric fans in cabins, Electric toilet, Lowerable salon table, Safe
Navigation	AIS, Autopilot, Binoculars, Bow thruster, Compass, Composite steering wheels, Echosounder/Depthsounder, GPS, GPS chart plotter, Navigation (Nautical) charts and nautical guide, Navigation/position Lights, Triangles, Windex
Safety	Distress signals, Emergency tiller, Fire axe, Fire extinguisher, First aid kit, Flashlight, Fog horn, Horseshoe lifebuoy, Life belts (Safety harness), Lifelines, Liferaft, Set of tools, Torch, VHF radio
Sails	Gennaker-device, Halyard winches
Yacht electrics	Adapter, Air Conditioning, Battery charger, Bilge pump - Electric, Converter 220V/12V, Double USB socket in cabins, Generator, Heating, Inverter, Plug 220V, 12 V, Shore power connection, Solar panels, USB sockets



WEBSITE

www.plujeme.cz



PHONE

+420 720 755 085



MOBILE

+420 777 170 276



E-MAIL

info@plujeme.cz



PLUJEME RÁDI S.R.O.

Dlouhá 730/35, 11000 Praha 1 – Staré Město, Czech Republic

SERVICES

SELECTED SERVICES	OBLIGATORY	PAYMENT TYPE	PRICE
Basic package for accommodation (Payable at the base) Season: 2026. Cleaning, made Bed linen, Permit, WiFi, Cooking gas, Rinsing set, Dinghy / in Cash or with credit card (VISA, MASTER)	Yes	per booking	350,00 €
Deposit insurance (Payable at the base) Season: 2026. Cash / The customers still have to deposit 100,00 €. If there is no damage, they get the 100,00 € back. We do not require any prior information. The customer can take out insurance at check-in.	No	per booking	200,00 €
Early Check in (Payable at the base) Season: 2026. On request; from 13:00; Payable in cash at the base	No	per booking	150,00 €
Hostess (Payable at the base) Season: 2026. + own cabin	No	per day + food	150,00 €
Pet on board (Payable at the base) Season: 2026. ONLY ON REQUEST!; Payable in cash at the base	No	per booking	140,00 €
Skipper (Payable at the base) Season: 2026. On request; Free food, own cabin; Payable in cash at the base	No	per day	200,00 €
Transfer (Payable at the base) Season: 2026. Transfer to Marina Frapa (Split Airport) 1-2 people €60 Shopping stop for 1 hour: If you arrive by taxi from the airport and would like to stop at the supermarket, this is possible, but the driver will have to charge you for it: From June 1st to September 30th, the stop costs €50, and €20 during the off-season (applies to transfers booked through us).	No	one-way	60,00 €
Transfer (Payable at the base) Season: 2026. Transfer to Marina Frapa (Split Airport) 3-4 people €75 Shopping stop for 1 hour: If you arrive by taxi from the airport and would like to stop at the supermarket, this is possible, but the driver will have to charge you for it: From June 1st to September 30th, the stop costs €50, and €20 during the off-season (applies to transfers booked through us).	No	one-way	75,00 €

Transfer (Payable at the base)

No

one-way

85,00 €

Season: 2026. Transfer to Marina Frapa (Split Airport) 5-8 people €85

Shopping stop for 1 hour: If you arrive by taxi from the airport and would like to stop at the supermarket, this is possible, but the driver will have to charge you for it: From June 1st to September 30th, the stop costs €50, and €20 during the off-season (applies to transfers booked through us).

Transfer (Payable at the base)

No

one-way

140,00 €

Season: 2026. Transfer to Marina Frapa (Split Airport) 9-15 people €140

Shopping stop for 1 hour: If you arrive by taxi from the airport and would like to stop at the supermarket, this is possible, but the driver will have to charge you for it: From June 1st to September 30th, the stop costs €50, and €20 during the off-season (applies to transfers booked through us).



WEBSITE

www.plujeme.cz



PHONE

+420 720 755 085



MOBILE

+420 777 170 276



E-MAIL

info@plujeme.cz



PLUJEME RÁDI S.R.O.

Dlouhá 730/35, 11000 Praha 1 – Staré Město, Czech Republic

ADDITIONAL EXTRAS

EXTRA	OBLIGATORY	PAYMENT TYPE	PRICE
Gennaker (Payable at the base) Season: 2026. on request, more weeks 50% Rabatt, Cash - Payable at the base	No	per week	250,00 €
Grill/Barbecue/Plancha (Payable at the base) Season: 2026. Danish Cobb Gas Grill, 50% discount on 2nd week, Cash - Payable at the base	No	per week	100,00 €
Grill/Barbecue/Plancha (Payable at the base) Season: 2026. Danish Cobb Gas Grill, 50% discount on 2nd week, Cash - Payable at the base	No	per week	100,00 €
Outboard engine (Payable at the base) Season: 2026. 50% second week; in Cash or with credit card (VISA, MASTER) - Payable at the base	No	per week	100,00 €
Stand up paddle (SUP) (Payable at the base) Season: 2026. 50% second week; Payable in cash at the base - Payable at the base	No	per week	100,00 €
Towels (Payable at the base) Season: 2026. 1x big one, 1x small one; Payable in cash at the base - Payable at the base	No	per set	10,00 €



WEBSITE

www.plujeme.cz



PHONE

+420 720 755 085



MOBILE

+420 777 170 276



E-MAIL

info@plujeme.cz



PLUJEME RÁDI S.R.O.

Dlouhá 730/35, 11000 Praha 1 - Staré Město, Czech Republic

PRICE AND AVAILABILITY

13.06. - 20.06.2026 NOT AVAILABLE	20.06. - 27.06.2026 NOT AVAILABLE	27.06. - 04.07.2026 NOT AVAILABLE	04.07. - 11.07.2026 NOT AVAILABLE
11.07. - 18.07.2026 NOT AVAILABLE	18.07. - 25.07.2026 NOT AVAILABLE	25.07. - 01.08.2026 NOT AVAILABLE	01.08. - 22.08.2026 NOT AVAILABLE
22.08. - 29.08.2026 NOT AVAILABLE	29.08. - 05.09.2026 NOT AVAILABLE	05.09. - 12.09.2026 NOT AVAILABLE	12.09. - 19.09.2026 NOT AVAILABLE
19.09. - 26.09.2026 ON OPTION	26.09. - 03.10.2026 4.602 € 5.900 €	03.10. - 10.10.2026 2.730 € 3.500 €	10.10. - 17.10.2026 2.184 € 2.800 €
17.10. - 24.10.2026 2.184 € 2.800 €	24.10. - 31.10.2026 2.184 € 2.800 €	31.10. - 07.11.2026 2.184 € 2.800 €	07.11. - 14.11.2026 2.184 € 2.800 €
14.11. - 21.11.2026 2.800 €	21.11. - 28.11.2026 2.800 €	28.11. - 05.12.2026 2.800 €	05.12. - 12.12.2026 2.800 €
12.12. - 19.12.2026 2.800 €	19.12. - 26.12.2026 2.800 €	01.01. - 26.03.2027 NOT AVAILABLE	



WEBSITE

www.plujeme.cz



E-MAIL

info@plujeme.cz



PHONE

+420 720 755 085



MOBILE

+420 777 170 276



PLUJEME RÁDI S.R.O.

Dlouhá 730/35, 11000 Praha 1 – Staré Město, Czech Republic

PRICE AND AVAILABILITY

27.03. - 03.04.2027 2.100 € 2.800 €	03.04. - 10.04.2027 2.100 € 2.800 €	10.04. - 17.04.2027 2.100 € 2.800 €	17.04. - 24.04.2027 NOT AVAILABLE
24.04. - 01.05.2027 2.100 € 2.800 €	01.05. - 08.05.2027 2.100 € 2.800 €	08.05. - 15.05.2027 2.625 € 3.500 €	15.05. - 22.05.2027 2.625 € 3.500 €
22.05. - 29.05.2027 4.425 € 5.900 €	29.05. - 05.06.2027 4.988 € 6.650 €	05.06. - 12.06.2027 4.988 € 6.650 €	12.06. - 19.06.2027 4.988 € 6.650 €
19.06. - 26.06.2027 4.988 € 6.650 €	26.06. - 03.07.2027 4.988 € 6.650 €	03.07. - 10.07.2027 5.250 € 7.000 €	10.07. - 17.07.2027 5.250 € 7.000 €
17.07. - 24.07.2027 5.250 € 7.000 €	24.07. - 31.07.2027 5.250 € 7.000 €	31.07. - 07.08.2027 5.250 € 7.000 €	07.08. - 14.08.2027 5.250 € 7.000 €
14.08. - 21.08.2027 5.250 € 7.000 €	21.08. - 28.08.2027 5.250 € 7.000 €	28.08. - 04.09.2027 5.250 € 7.000 €	04.09. - 11.09.2027 5.138 € 6.850 €
11.09. - 18.09.2027 5.138 € 6.850 €	18.09. - 25.09.2027 4.988 € 6.650 €	25.09. - 02.10.2027 4.425 € 5.900 €	



WEBSITE

www.plujeme.cz



E-MAIL

info@plujeme.cz



PHONE

+420 720 755 085



MOBILE

+420 777 170 276



PLUJEME RÁDI S.R.O.

Dlouhá 730/35, 11000 Praha 1 – Staré Město, Czech Republic

PRICE AND AVAILABILITY

02.10. - 09.10.2027

2.625 € 3.500 €

09.10. - 16.10.2027

2.100 € 2.800 €

16.10. - 23.10.2027

2.100 € 2.800 €

23.10. - 30.10.2027

2.100 € 2.800 €

30.10. - 06.11.2027

2.100 € 2.800 €

07.11. - 24.03.2028

NOT AVAILABLE



WEBSITE

www.plujeme.cz



E-MAIL

info@plujeme.cz



PHONE

+420 720 755 085



MOBILE

+420 777 170 276



PLUJEME RÁDI S.R.O.

Dlouhá 730/35, 11000 Praha 1 – Staré Město, Czech Republic