

# HANSE 588

Oceanelle (2024)

Sailing yacht Hanse 588 Oceanelle, built in 2024 is anchored in the Trogir, Yachtclub Seget (Marina Baotić), Split region, Croatia. It has 3 + 1 cabins, can accommodate 6 + 2 + 1 people and has 3 + 1 toilets. Bed linen and kitchen equipment are included in the price.

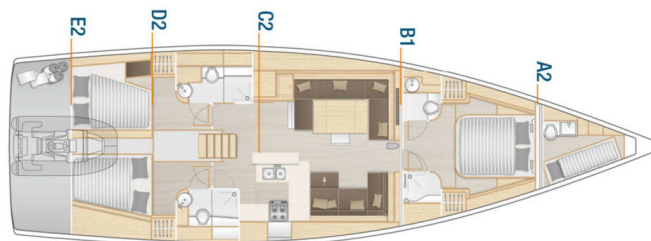

## YACHT SPECIFICATIONS

Yacht Base

**Trogir, Yachtclub Seget (Marina Baotić), Croatia**

Yacht ID

**6957**

Brands

**Hanse Yachts**

Yacht name

**Oceanelle**

Production year

**2024**

Length

**56 ft**

Cabins

**3 + 1**

Berths

**6 + 2 + 1**

Max Persons

**9**

WC

**3 + 1**

Engine

**1 x 110 HP**

Fuel tank

**520 l**



**WEBSITE**

[www.plujeme.cz](http://www.plujeme.cz)



**PHONE**

+420 720 755 085



**MOBILE**

+420 777 170 276



**E-MAIL**

[info@plujeme.cz](mailto:info@plujeme.cz)



**PLUJEME RÁDI S.R.O.**

Dlouhá 730/35, 11000 Praha 1 – Staré Město, Czech Republic

## STANDARD YACHT EQUIPMENT

Comfort	<b>Bed linen, Cockpit cushions, Sundeck cushions</b>
Deck	<b>Bathing platform, Cockpit fridge, Cockpit table, Cockpit/stern, outside shower, Dinghy, Grill/Barbecue/Plancha, Hard Top Bimini, Hydraulic gangway, Sprayhood, Teak cockpit, Teak deck</b>
Entertainment	<b>Outdoor speakers, Radio CD player, TV, Wet bar</b>
Galley	<b>Freezer, Hot water, Kitchen utensils (Galley equipment, cutlery), Oven, Refrigerator, Stove</b>
Interior	<b>Electric toilet</b>
Navigation	<b>Autopilot, Bow thruster, GPS chart plotter - cockpit, Nautical charts, Pilot book, Stern thruster, Tridata</b>
Safety	<b>VHF radio</b>
Sails	<b>Electric primary winch</b>
Yacht electrics	<b>Air Conditioning, Battery charger, Generator, Heating, Inverter, Solar panels, Watermaker - desalinator</b>



**WEBSITE**

[www.plujeme.cz](http://www.plujeme.cz)



**E-MAIL**

[info@plujeme.cz](mailto:info@plujeme.cz)



**PHONE**

+420 720 755 085



**MOBILE**

+420 777 170 276



**PLUJEME RÁDI S.R.O.**

Dlouhá 730/35, 11000 Praha 1 - Staré Město, Czech Republic

## SERVICES

SELECTED SERVICES	OBLIGATORY	PAYMENT TYPE	PRICE
<b>Charter pack</b> (Payable at the base) <b>Season: 2026.</b> includes final cleaning, bedlinen, towels - 1 set/person, cooking gas	Yes	per booking	<b>410,00 €</b>
<b>Outboard engine</b> (Payable at the base) <b>Season: 2026.</b> Free of charge for bookings in May	Yes	per booking	<b>0,00 €</b>
<b>Comfort Pack</b> (Payable at the base) <b>Season: 2026.</b> includes outboard 2,5 HP, WiFi routers	No	per week	<b>105,00 €</b>
<b>Deposit insurance</b> (Payable at the base) <b>Season: 2026.</b> + 450 EUR refundable deposit	No	per booking	<b>380,00 €</b>
<b>Early Check in</b> (Payable at the base) <b>Season: 2026.</b> Saturdays between 13hr - 14hr. Early check in can be confirmed only on embarkation day in the charter base.	No	per booking	<b>250,00 €</b>
<b>Flexible booking</b> (Payable now) <b>Season: 2026.</b> allows you to cancel or rebook your charter up to 30 days before the embarkation for no specific reason. You can reschedule your holiday at no cost for unlimited number of times or use a credit note if you are uncertain of new charter dates. With our FLEX PLAN your rebooking costs are completely eliminated while cancellation costs with refund option are reduced to a minimum (15% of the charter fee, min 350 EUR). Extra bonus: free cancellation and FULL REFUND granted in case of closed state borders within 7 days before the embarkation. Notes: FLEX PLAN costs 7% of the final charter price, can be added to booking up to 72hr after booking confirmation and is not available for bookings confirmed within 30 days before the embarkation.	No	per booking	<b>0,00 €</b>
<b>Hostess</b> (Payable now) <b>Season: 2026.</b> + own cabin 50% cancellation fee in case of cancellation up to 15 days prior to embarkation 100% cancellation fee in case of cancellation within 14 days prior to embarkation	No	per day + food	<b>220,00 €</b>
<b>Late check out</b> (Payable at the base) <b>Season: 2026.</b> Saturdays till 10hr Late check-out can be confirmed only on Friday before the embarkation day.	No	per booking	<b>350,00 €</b>

<p><b>One way fee</b> (Payable at the base)</p> <p><b>Season: 2026.</b> Seg - Bio / Bio - Seg On request only. One-way conditions: one way fee + skipper service obligatory for the whole booking period + mooring fee in port of disembarkation/embarkation; check-out on Friday until 12:00 in Biograd</p>	No	per booking	<b>480,00 €</b>
<p><b>One way fee</b> (Payable at the base)</p> <p><b>Season: 2026.</b> Seg - Du / Du - Seg On request only. One-way conditions: one way fee + skipper service obligatory for the whole booking period + mooring fee in port of disembarkation/embarkation; check-out on Friday until 09:00hr in Dubrovnik</p>	No	per booking	<b>550,00 €</b>
<p><b>Parking</b> (Payable at the base)</p> <p><b>Season: 2026.</b> Per Car/week - parking place within Marina Baotić, can be ordered in advance and paid in our office (limited availability)</p>	No	per week	<b>70,00 €</b>
<p><b>Pet on board</b> (Payable at the base)</p> <p><b>Season: 2026.</b> Small or medium pet, up to 25 kg</p>	No	per booking	<b>150,00 €</b>
<p><b>Provisioning</b> (Payable now)</p> <p><b>Season: 2026.</b> upon request + price of groceries, to be done online</p>	No	per booking	<b>0,00 €</b>
<p><b>Skipper</b> (Payable now)</p> <p><b>Season: 2026.</b> + own cabin 50% cancellation fee in case of cancellation up to 15 days prior to embarkation 100% cancellation fee in case of cancellation within 14 days prior to embarkation</p>	No	per day + food	<b>240,00 €</b>



**WEBSITE**  
www.plujeme.cz



**PHONE**  
+420 720 755 085



**MOBILE**  
+420 777 170 276



**E-MAIL**  
info@plujeme.cz



**PLUJEME RÁDI S.R.O.**  
Dlouhá 730/35, 11000 Praha 1 - Staré Město, Czech Republic

## ADDITIONAL EXTRAS

EXTRA	OBLIGATORY	PAYMENT TYPE	PRICE
<b>Beach towel</b> (Payable at the base) <b>Season: 2026.</b> Payable at the base	No	per piece	<b>8,00 €</b>
<b>Donut</b> (Payable at the base) <b>Season: 2026.</b> Payable at the base	No	per week	<b>50,00 €</b>
<b>eFoil</b> (Payable now) <b>Season: 2026.</b> Loft Foil / Awake Vinga Security deposit: 1000 EUR Cancellation policy: 50% cancellation fee in case of cancellation within 2 weeks prior to embarkation. Delivery fee – free of charge – Payable now	No	per week	<b>2.000,00 €</b>
<b>Electric scooter</b> (Payable at the base) <b>Season: 2026.</b> Xiaomi Electric Scooter 4 Lite (2nd Gen) – Payable at the base	No	per week	<b>120,00 €</b>
<b>Extra bedlinen</b> (Payable at the base) <b>Season: 2026.</b> Payable at the base	No	per set	<b>15,00 €</b>
<b>Floating Water Hammock</b> (Payable at the base) <b>Season: 2026.</b> Partyzone – Payable at the base	No	per week	<b>220,00 €</b>
<b>Gennaker</b> (Payable at the base) <b>Season: 2026.</b> deposit raise + 750 EUR – Payable at the base	No	per week	<b>280,00 €</b>
<b>JetBoard</b> (Payable now) <b>Season: 2026.</b> Awake Security deposit: 1000 EUR Cancellation policy: 50% cancellation fee in case of cancellation within 2 weeks prior to embarkation. Delivery fee – free of charge – Payable now	No	per week	<b>2.200,00 €</b>
<b>Kayak</b> (Payable at the base) <b>Season: 2026.</b> 2 pax – Payable at the base	No	per week	<b>150,00 €</b>
<b>Outboard engine 2,5 HP</b> (Payable at the base) <b>Season: 2026.</b> Payable at the base	No	per week	<b>100,00 €</b>
<b>Outboard engine 5 HP</b> (Payable at the base) <b>Season: 2026.</b> on request – Payable at the base	No	per week	<b>150,00 €</b>
<b>Railing net (Safety net)</b> (Payable at the base) <b>Season: 2026.</b> Rental without mounting – Payable at the base	No	per booking	<b>20,00 €</b>

<b>RIB 3,8 with console + 20 HP</b> (Payable at the base) <b>Season: 2026.</b> Deposit increase € 500 Cancellation policy: 50% cancellation fee in case of cancellation within 2 weeks prior to embarkation. RIB has to be towed. - Payable at the base	No	per week	<b>790,00 €</b>
<b>RIB 4,6m with console + 60 HP outboard</b> (Payable at the base) <b>Season: 2026.</b> Deposit increase € 800 Cancellation policy: 50% cancellation fee in case of cancellation within 2 weeks prior to embarkation. RIB has to be towed. - Payable at the base	No	per week	<b>1.290,00 €</b>
<b>Seabob</b> (Payable now) <b>Season: 2026.</b> Seabob F5 Security deposit: 500 EUR Cancellation policy: 50% cancellation fee in case of cancellation within 2 weeks prior to embarkation. Delivery fee - free of charge - Payable now	No	per week	<b>1.000,00 €</b>
<b>Seabob</b> (Payable now) <b>Season: 2026.</b> Seabob F5S Security deposit: 500 EUR Cancellation policy: 50% cancellation fee in case of cancellation within 2 weeks prior to embarkation. Delivery fee - free of charge - Payable now	No	per week	<b>1.200,00 €</b>
<b>Seabob</b> (Payable now) <b>Season: 2026.</b> Seabob F9 Security deposit: 500 EUR Cancellation policy: 50% cancellation fee in case of cancellation within 2 weeks prior to embarkation. Delivery fee - free of charge - Payable now	No	per week	<b>1.300,00 €</b>
<b>Seabob</b> (Payable now) <b>Season: 2026.</b> Seabob F9S Security deposit: 500 EUR Cancellation policy: 50% cancellation fee in case of cancellation within 2 weeks prior to embarkation. Delivery fee - free of charge - Payable now	No	per week	<b>1.500,00 €</b>
<b>Seabob</b> (Payable now) <b>Season: 2026.</b> Seabob F5SR Security deposit: 500 EUR Cancellation policy: 50% cancellation fee in case of cancellation within 2 weeks prior to embarkation. Delivery fee - free of charge - Payable now	No	per week	<b>1.500,00 €</b>
<b>Snorkeling equipment</b> (Payable at the base) <b>Season: 2026.</b> Payable at the base	No	per week	<b>10,00 €</b>
<b>Stand up paddle (SUP)</b> (Payable at the base) <b>Season: 2026.</b> Payable at the base	No	per week	<b>120,00 €</b>
<b>Towels</b> (Payable at the base) <b>Season: 2026.</b> 2 psc/set (1 x 50x100cm + 1 x 70x140cm) - Payable at the base	No	per set	<b>8,00 €</b>
<b>Wakeboard</b> (Payable at the base) <b>Season: 2026.</b> Payable at the base	No	per week	<b>50,00 €</b>

**Wi-Fi Internet** (Payable at the base)

No

per week

**25,00 €**

**Season: 2026.** Payable at the base



**WEBSITE**

[www.plujeme.cz](http://www.plujeme.cz)



**E-MAIL**

[info@plujeme.cz](mailto:info@plujeme.cz)



**PHONE**

+420 720 755 085



**MOBILE**

+420 777 170 276



**PLUJEME RÁDI S.R.O.**

Dlouhá 730/35, 11000 Praha 1 – Staré Město, Czech Republic

## PRICE AND AVAILABILITY

25.04. - 02.05.2026 3.776 € 4.720 €	02.05. - 09.05.2026 NOT AVAILABLE	09.05. - 16.05.2026 4.256 € 5.320 €	16.05. - 23.05.2026 4.416 € 5.520 €
23.05. - 30.05.2026 5.568 € 6.960 €	30.05. - 06.06.2026 NOT AVAILABLE	06.06. - 13.06.2026 6.416 € 8.020 €	13.06. - 20.06.2026 NOT AVAILABLE
20.06. - 27.06.2026 NOT AVAILABLE	27.06. - 04.07.2026 NOT AVAILABLE	04.07. - 11.07.2026 7.936 € 9.920 €	11.07. - 18.07.2026 7.936 € 9.920 €
18.07. - 01.08.2026 NOT AVAILABLE	01.08. - 08.08.2026 8.256 € 10.320 €	08.08. - 15.08.2026 7.936 € 9.920 €	15.08. - 22.08.2026 7.936 € 9.920 €
22.08. - 29.08.2026 NOT AVAILABLE	29.08. - 05.09.2026 NOT AVAILABLE	05.09. - 12.09.2026 NOT AVAILABLE	12.09. - 26.09.2026 NOT AVAILABLE
26.09. - 03.10.2026 NOT AVAILABLE	03.10. - 10.10.2026 4.816 € 6.020 €	10.10. - 17.10.2026 4.336 € 5.420 €	17.10. - 24.10.2026 4.336 € 5.420 €
24.10. - 31.10.2026 4.928 € 6.160 €	31.10. - 07.11.2026 4.928 € 6.160 €	07.11. - 14.11.2026 4.928 € 6.160 €	14.11. - 21.11.2026 4.928 € 6.160 €
21.11. - 28.11.2026 4.928 € 6.160 €	28.11. - 05.12.2026 4.928 € 6.160 €		



WEBSITE

[www.plujeme.cz](http://www.plujeme.cz)



E-MAIL

[info@plujeme.cz](mailto:info@plujeme.cz)



PHONE

+420 720 755 085



MOBILE

+420 777 170 276



PLUJEME RÁDI S.R.O.

Dlouhá 730/35, 11000 Praha 1 – Staré Město, Czech Republic

## PRICE AND AVAILABILITY

05.12. - 12.12.2026

**4.928 €** 6.160 €

12.12. - 19.12.2026

**4.928 €** 6.160 €

19.12. - 26.12.2026

**4.928 €** 6.160 €



### WEBSITE

[www.plujeme.cz](http://www.plujeme.cz)



### E-MAIL

[info@plujeme.cz](mailto:info@plujeme.cz)



### PHONE

+420 720 755 085



### MOBILE

+420 777 170 276



### PLUJEME RÁDI S.R.O.

Dlouhá 730/35, 11000 Praha 1 – Staré Město, Czech Republic