

HANSE 460

Venus (2024)

Sailing yacht **Hanse 460 Venus**, built in **2024** is anchored in the **Marina Kornati, Biograd, Zadar region, Croatia**. It has **4 cabins**, can accommodate **8 + 1 people** and has **4 toilets**. Bed linen and kitchen equipment are included in the price.

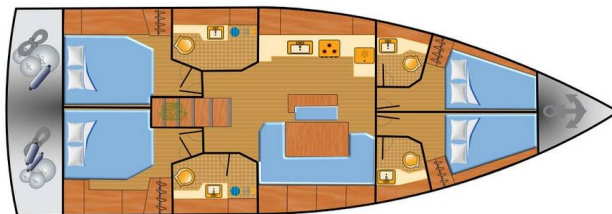

YACHT SPECIFICATIONS

Yacht Base

Marina Kornati, Biograd, Croatia

Yacht ID

6943

Brands

Hanse Yachts

Yacht name

Venus

Production year

2024

Length

48 ft

Cabins

4

Berths

8 + 1

Max Persons

9

WC

4

Engine

1 x 56 HP

Fuel tank

210 l



WEBSITE

www.plujeme.cz



PHONE

+420 720 755 085



MOBILE

+420 777 170 276



E-MAIL

info@plujeme.cz



PLUJEME RÁDI S.R.O.

Dlouhá 730/35, 11000 Praha 1 - Staré Město, Czech Republic

STANDARD YACHT EQUIPMENT

Additional	Flag
Comfort	Cockpit cushions
Deck	Bathing platform, Bimini top, Boat hook, Bosun's chair (Safe seat) (boatswain's chair), Cockpit table, Cockpit/stern, outside shower, Deck brush, Dinghy, Electric anchor windlass, Fenders, Gangway, Mooring ropes, Pulpit seat, Sailor's knife, Sprayhood, Swimming ladder, Teak cockpit
Entertainment	Outdoor speakers, Radio, Radio, USB, Bluetooth, TV, Wi-Fi Internet
Galley	Gas cookers, Hot water, Kitchen utensils (Galley equipment, cutlery), Oven, Pressurized water system, Refrigerator, Sink, Wine glasses
Interior	Barometer, Bilge pump handle, Electric toilet, Safe
Navigation	AIS, Autopilot, Binoculars, Bow thruster, Compass, Echosounder/Depthsounder, GPS, LED Navigation lights, Navigation (Nautical) charts and nautical guide, Triangles, Windex
Safety	Automatic Inflatable Life Jacket, Distress signals, Emergency tiller, Fire axe, Fire extinguisher, Fog horn, Horseshoe lifebuoy, Life buoy + Flashing light, Lifelines, Set of tools, Torch, VHF radio, Wire (shroud) cutter
Sails	Electric halyard winch, Electric winch, Lazy bag, Lazy jacks, Main sheet winches
Yacht electrics	Adapter, Battery charger, Bilge pump - Electric, Converter 220V/12V, Heating, Inverter, Plug 220V, 12 V, Shore power connection, Solar panels, USB sockets



WEBSITE

www.plujeme.cz



PHONE

+420 720 755 085



MOBILE

+420 777 170 276



E-MAIL

info@plujeme.cz



PLUJEME RÁDI S.R.O.

Dlouhá 730/35, 11000 Praha 1 – Staré Město, Czech Republic

SERVICES

SELECTED SERVICES	OBLIGATORY	PAYMENT TYPE	PRICE
Basic package for accommodation (Payable at the base) Season: 2026. Cleaning, made Bed linen, Permit, WiFi, Cooking gas, Rinsing set, Dinghy / in Cash or with credit card (VISA, MASTER)	Yes	per booking	290,00 €
Deposit insurance (Payable at the base) Season: 2026. Cash / The customers still have to deposit 100,00 €. If there is no damage, they get the 100,00 € back. We do not require any prior information. The customer can take out insurance at check-in.	No	per booking	200,00 €
Early Check in (Payable at the base) Season: 2026. On request; from 13:00; Payable in cash at the base	No	per booking	150,00 €
Hostess (Payable at the base) Season: 2026. + own cabin	No	per day + food	150,00 €
Pet on board (Payable at the base) Season: 2026. ONLY ON REQUEST!; Payable in cash at the base	No	per booking	140,00 €
Skipper (Payable at the base) Season: 2026. On request; Free food, own cabin; Payable in cash at the base	No	per day	200,00 €
Transfer (Payable at the base) Season: 2026. Transfer to Biograd: A trip from Zadar (up to 4 people) costs €60.	No	one-way	60,00 €
Transfer (Payable at the base) Season: 2026. Transfer to Biograd: A trip from Zadar (from 5 and up to 8 people) costs €90.	No	one-way	90,00 €
Transfer (Payable at the base) Season: 2026. Transfer to Biograd: The longer trip from Split (up to 4 people) costs €190.	No	one-way	190,00 €
Transfer (Payable at the base) Season: 2026. Transfer to Biograd: The longer trip from Split (from 5 and up to 8 people) costs €225.	No	one-way	225,00 €



WEBSITE
www.plujeme.cz



PHONE
+420 720 755 085



MOBILE
+420 777 170 276



E-MAIL
info@plujeme.cz



PLUJEME RÁDI S.R.O.
Dlouhá 730/35, 11000 Praha 1 – Staré Město, Czech Republic

ADDITIONAL EXTRAS

EXTRA	OBLIGATORY	PAYMENT TYPE	PRICE
Code Zero (Payable at the base) Season: 2026. 250 €/Woche, 50 % Rabatt bei 2 Wochen... Payable in cash at the base. - Payable at the base	No	per week	250,00 €
Grill/Barbecue/Plancha (Payable at the base) Season: 2026. Danish Cobb Gas Grill, 50% discount on 2nd week, Cash - Payable at the base	No	per week	100,00 €
Outboard engine (Payable at the base) Season: 2026. 50% second week; in Cash or with credit card (VISA, MASTER) - Payable at the base	No	per week	100,00 €
Stand up paddle (SUP) (Payable at the base) Season: 2026. 50% second week; Payable in cash at the base - Payable at the base	No	per week	100,00 €
Towels (Payable at the base) Season: 2026. 1x big one, 1x small one; Payable in cash at the base - Payable at the base	No	per set	10,00 €

**WEBSITE**www.plujeme.cz**E-MAIL**info@plujeme.cz**PHONE**

+420 720 755 085

**MOBILE**

+420 777 170 276

**PLUJEME RÁDI S.R.O.**

Dlouhá 730/35, 11000 Praha 1 - Staré Město, Czech Republic

PRICE AND AVAILABILITY

25.04. - 02.05.2026 NOT AVAILABLE	02.05. - 09.05.2026 NOT AVAILABLE	09.05. - 16.05.2026 NOT AVAILABLE	16.05. - 23.05.2026 2.170 € 3.100 €
23.05. - 30.05.2026 3.080 € 4.400 €	30.05. - 06.06.2026 ON OPTION	06.06. - 13.06.2026 3.430 € 4.900 €	13.06. - 20.06.2026 NOT AVAILABLE
20.06. - 27.06.2026 NOT AVAILABLE	27.06. - 04.07.2026 3.822 € 4.900 €	04.07. - 11.07.2026 NOT AVAILABLE	11.07. - 18.07.2026 NOT AVAILABLE
18.07. - 25.07.2026 NOT AVAILABLE	25.07. - 01.08.2026 NOT AVAILABLE	01.08. - 08.08.2026 NOT AVAILABLE	08.08. - 15.08.2026 NOT AVAILABLE
15.08. - 22.08.2026 4.290 € 5.500 €	22.08. - 29.08.2026 4.290 € 5.500 €	29.08. - 05.09.2026 4.290 € 5.500 €	05.09. - 12.09.2026 NOT AVAILABLE
12.09. - 19.09.2026 NOT AVAILABLE	19.09. - 26.09.2026 NOT AVAILABLE	26.09. - 03.10.2026 NOT AVAILABLE	03.10. - 17.10.2026 NOT AVAILABLE
17.10. - 24.10.2026 1.638 € 2.100 €	24.10. - 31.10.2026 1.638 € 2.100 €	31.10. - 07.11.2026 1.638 € 2.100 €	07.11. - 14.11.2026 1.638 € 2.100 €
14.11. - 21.11.2026 2.100 €	21.11. - 28.11.2026 2.100 €	28.11. - 05.12.2026 2.100 €	



WEBSITE
www.plujeme.cz



E-MAIL
info@plujeme.cz



PHONE
+420 720 755 085



PLUJEME RÁDI S.R.O.
Dlouhá 730/35, 11000 Praha 1 – Staré Město, Czech Republic



MOBILE
+420 777 170 276

PRICE AND AVAILABILITY

05.12. - 12.12.2026 2.100 €	12.12. - 19.12.2026 2.100 €	19.12. - 26.12.2026 2.100 €	01.01. - 26.03.2027 NOT AVAILABLE
27.03. - 03.04.2027 1.575 € 2.100 €	03.04. - 10.04.2027 1.575 € 2.100 €	10.04. - 17.04.2027 1.575 € 2.100 €	17.04. - 24.04.2027 1.575 € 2.100 €
24.04. - 01.05.2027 1.575 € 2.100 €	01.05. - 08.05.2027 1.575 € 2.100 €	08.05. - 15.05.2027 2.325 € 3.100 €	15.05. - 22.05.2027 2.325 € 3.100 €
22.05. - 29.05.2027 3.300 € 4.400 €	29.05. - 05.06.2027 3.675 € 4.900 €	05.06. - 12.06.2027 3.675 € 4.900 €	12.06. - 19.06.2027 3.675 € 4.900 €
19.06. - 26.06.2027 3.675 € 4.900 €	26.06. - 03.07.2027 3.675 € 4.900 €	03.07. - 10.07.2027 4.125 € 5.500 €	10.07. - 17.07.2027 4.125 € 5.500 €
17.07. - 24.07.2027 4.125 € 5.500 €	24.07. - 31.07.2027 4.125 € 5.500 €	31.07. - 07.08.2027 4.125 € 5.500 €	



WEBSITE

www.plujeme.cz



E-MAIL

info@plujeme.cz



PHONE

+420 720 755 085



MOBILE

+420 777 170 276



PLUJEME RÁDI S.R.O.

Dlouhá 730/35, 11000 Praha 1 – Staré Město, Czech Republic

PRICE AND AVAILABILITY

07.08. - 14.08.2027 4.125 € 5.500 €	14.08. - 21.08.2027 4.125 € 5.500 €	21.08. - 28.08.2027 4.125 € 5.500 €	28.08. - 04.09.2027 4.125 € 5.500 €
04.09. - 11.09.2027 4.050 € 5.400 €	11.09. - 18.09.2027 4.050 € 5.400 €	18.09. - 25.09.2027 3.675 € 4.900 €	25.09. - 02.10.2027 3.300 € 4.400 €
02.10. - 09.10.2027 2.325 € 3.100 €	09.10. - 16.10.2027 1.575 € 2.100 €	16.10. - 23.10.2027 1.575 € 2.100 €	23.10. - 30.10.2027 1.575 € 2.100 €
30.10. - 06.11.2027 1.575 € 2.100 €	07.11. - 24.03.2028 NOT AVAILABLE		



WEBSITE

www.plujeme.cz



E-MAIL

info@plujeme.cz



PHONE

+420 720 755 085



MOBILE

+420 777 170 276



PLUJEME RÁDI S.R.O.

Dlouhá 730/35, 11000 Praha 1 – Staré Město, Czech Republic