

FONTAINE PAJOT SAONA 47 MAESTRO

Impossible Dream (2021)

Catamaran Fontaine Pajot Saona 47 Maestro Impossible Dream, built in 2021 is anchored in the Bahamas, Abacos, Boat Harbour Marina, Abaco Islands, Bahamas. It has 3 cabins, can accommodate 6 people and has 3 toilets. Bed linen and kitchen equipment are included in the price.

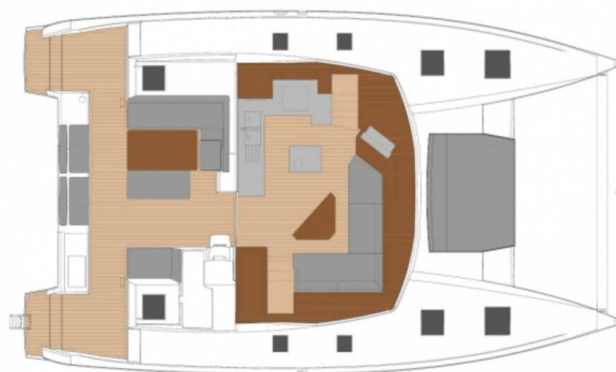

YACHT SPECIFICATIONS

Yacht Base

**Bahamas, Abacos, Boat Harbour
Marina, Bahamas**

Yacht ID

6928

Brands

Fontaine Pajot

Yacht name

Impossible Dream

Production year

2021

Length

46 ft

Cabins

3

Berths

6

Max Persons

6

WC

3

Engine

2 x 60 HP

Fuel tank

940 l



WEBSITE

www.plujeme.cz



PHONE

+420 720 755 085



MOBILE

+420 777 170 276



E-MAIL

info@plujeme.cz



PLUJEME RÁDI S.R.O.

Dlouhá 730/35, 11000 Praha 1 – Staré Město, Czech Republic

STANDARD YACHT EQUIPMENT

Comfort	Sundeck cushions
Deck	Cockpit fridge, Cockpit table, Cockpit/stern, outside shower, Davit, Dinghy with outboard engine, Electric anchor windlass, Grill/Barbecue/Plancha, Sprayhood
Entertainment	Fusion radio, Indoor speakers, Outdoor speakers, TV, Underwater lights
Galley	Freezer, Kitchen utensils (Galley equipment, cutlery), Microwave, Oven, Refrigerator, Stove
Interior	Electric toilet, Portable cooling fan
Navigation	Autopilot, GPS chart plotter - cockpit, Helm station, Wind/speed/depth instruments
Safety	VHF radio
Sails	Electric winch, Lazy bag, Lazy jacks
Yacht electrics	110V socket, Air Conditioning, Generator, Inverter, Shore power connection, Solar panels, USB sockets



WEBSITE

www.plujeme.cz



E-MAIL

info@plujeme.cz



PHONE

+420 720 755 085



MOBILE

+420 777 170 276



PLUJEME RÁDI S.R.O.

Dlouhá 730/35, 11000 Praha 1 – Staré Město, Czech Republic

SERVICES

SELECTED SERVICES	OBLIGATORY	PAYMENT TYPE	PRICE
Bahamas foreign charter tax (Payable now) Season: 2026.	Yes	per booking	0,00 €
Bahamas Taxes (Payable now) Season: 2026.	Yes	per booking	0,00 €
DRA (Payable now) Season: 2026.	Yes	per day	50,00 €
ASA Processing Fee (Payable now) Season: 2026. Certificate 103	No	per person/per course	150,00 €
ASA Processing Fee (Payable now) Season: 2026. Certificate 101	No	per person/per course	150,00 €
ASA Processing Fee (Payable now) Season: 2026. Certificate 114	No	per person/per course	200,00 €
ASA Processing Fee (Payable now) Season: 2026. Certificate 104	No	per person/per course	200,00 €
ASA Processing Fee (Payable now) Season: 2026. Overnight Open Water. Available only on Flotilla Sails; Certificate 106	No	per person/per course	250,00 €
ASA Processing Fee (Payable now) Season: 2026. Certificate 101, 103 & 104	No	per person/per course	400,00 €
ASA Processing Fee (Payable now) Season: 2026. Overnight Open Water. Available only on Flotilla Sails; Certificate 105	No	per person/per course	400,00 €
ASA Processing Fee (Payable now) Season: 2026. Overnight Open Water. Available only on Flotilla Sails; Certificate 105 & 106	No	per person/per course	550,00 €
Captain By Day (Payable now) Season: 2026.	No	per day + food	350,00 €

Captain By Night (Payable now) Season: 2026.	No	per night	450,00 €
Chef (Payable now) Season: 2026. Overnight	No	per day + food	400,00 €
Credit card surcharge (Payable now) Season: 2026. A 3% convenience fee will be added to all credit card transactions	No	per booking	0,00 €
Daily trips (Payable now) Season: 2026. Trips north from Guana	No	per booking	400,00 €
Education (Payable at the base) Season: 2026. NauticEd skipper training hours	No	per person/per course	100,00 €
Education (Payable at the base) Season: 2026. NauticEd bareboat hours	No	per person/per course	200,00 €
Extra cleaning (Payable at the base) Season: 2026.	No	per service	400,00 €
Fuel charge (Payable now) Season: 2026. + 500,00\$ deposit; This is only for day trips	No	per booking	300,00 €
Gratuity (Payable now) Season: 2026. On Day Trips	No	per booking	220,00 €
Hostess/Cook (Payable now) Season: 2026.	No	per day + food	350,00 €
Participation fee (Payable at the base) Season: 2026. NauticEd sign up fee	No	per person/per course	175,00 €
Rescheduling (Payable now) Season: 2026. On Day Trips	No	per booking	350,00 €
Sleep over after check out (Payable now) Season: 2026.	No	per booking	700,00 €
Sleep over before check in (Payable now) Season: 2026. at 12:00 PM	No	per booking	700,00 €



WEBSITE
www.plujeme.cz



PHONE
+420 720 755 085



MOBILE
+420 777 170 276



E-MAIL
info@plujeme.cz



PLUJEME RÁDI S.R.O.
Dlouhá 730/35, 11000 Praha 1 – Staré Město, Czech Republic

ADDITIONAL EXTRAS

EXTRA	OBLIGATORY	PAYMENT TYPE	PRICE
Fins (Payable now) Season: 2026. Payable now	No	per week/ person	35,00 €
Fishing cane/rod (Payable now) Season: 2026. Payable now	No	per week	60,00 €
Inflatable swimming platform (Payable now) Season: 2026. POP-UP DOCK - Payable now	No	per week	250,00 €
Kayak (Payable now) Season: 2026. Tandem - Payable now	No	per week	250,00 €
Snorkeling equipment (Payable now) Season: 2026. Payable now	No	per week/ person	50,00 €
Stand up paddle (SUP) (Payable now) Season: 2026. Payable now	No	per week	250,00 €
Starlink (Payable now) Season: 2026. Payable now	No	per week	100,00 €

**WEBSITE**www.plujeme.cz**E-MAIL**info@plujeme.cz**PHONE**

+420 720 755 085

**MOBILE**

+420 777 170 276

**PLUJEME RÁDI S.R.O.**

Dlouhá 730/35, 11000 Praha 1 – Staré Město, Czech Republic

PRICE AND AVAILABILITY

30.04. - 08.05.2026 NOT AVAILABLE	08.05. - 17.05.2026 NOT AVAILABLE	23.05. - 30.05.2026 6.520 €	04.06. - 13.06.2026 NOT AVAILABLE
13.06. - 21.06.2026 NOT AVAILABLE	27.06. - 04.07.2026 6.520 €	04.07. - 11.07.2026 6.520 €	17.07. - 25.07.2026 NOT AVAILABLE
25.07. - 01.08.2026 6.520 €	02.08. - 04.08.2026 NOT AVAILABLE	08.08. - 15.08.2026 6.520 €	15.08. - 22.08.2026 6.520 €
22.08. - 29.08.2026 6.520 €	29.08. - 05.09.2026 6.520 €	05.09. - 12.09.2026 6.520 €	12.09. - 19.09.2026 6.520 €
19.09. - 26.09.2026 6.520 €	26.09. - 03.10.2026 6.520 €	03.10. - 10.10.2026 6.520 €	10.10. - 17.10.2026 6.520 €
17.10. - 24.10.2026 6.520 €	24.10. - 31.10.2026 6.520 €	31.10. - 07.11.2026 6.520 €	08.11. - 15.11.2026 NOT AVAILABLE
21.11. - 28.11.2026 6.520 €	28.11. - 05.12.2026 6.520 €		



WEBSITE

www.plujeme.cz



E-MAIL

info@plujeme.cz



PHONE

+420 720 755 085



MOBILE

+420 777 170 276



PLUJEME RÁDI S.R.O.

Dlouhá 730/35, 11000 Praha 1 – Staré Město, Czech Republic

PRICE AND AVAILABILITY

05.12. - 12.12.2026 6.520 €	12.12. - 19.12.2026 6.520 €	19.12. - 26.12.2026 6.910 €	02.01. - 09.01.2027 6.617 €
09.01. - 16.01.2027 5.838 €	16.01. - 23.01.2027 5.838 €	23.01. - 30.01.2027 5.838 €	30.01. - 06.02.2027 5.838 €
06.02. - 13.02.2027 5.838 €	13.02. - 20.02.2027 5.838 €	20.02. - 27.02.2027 5.838 €	27.02. - 06.03.2027 6.228 € 6.228 €
06.03. - 13.03.2027 7.202 €	13.03. - 20.03.2027 7.202 €	20.03. - 27.03.2027 7.202 €	27.03. - 03.04.2027 7.202 €
03.04. - 10.04.2027 7.202 €	10.04. - 17.04.2027 7.202 €	17.04. - 24.04.2027 7.202 €	24.04. - 01.05.2027 6.910 €
01.05. - 08.05.2027 6.520 €	08.05. - 15.05.2027 6.520 €	15.05. - 22.05.2027 6.520 €	22.05. - 29.05.2027 6.520 €
29.05. - 05.06.2027 6.520 €	05.06. - 12.06.2027 6.520 €	12.06. - 19.06.2027 6.520 €	19.06. - 26.06.2027 6.520 €
26.06. - 03.07.2027 6.520 €	03.07. - 10.07.2027 6.520 €	10.07. - 17.07.2027 6.520 €	17.07. - 24.07.2027 6.520 €
24.07. - 31.07.2027 6.520 €	31.07. - 07.08.2027 6.520 €		



WEBSITE
www.plujeme.cz



E-MAIL
info@plujeme.cz



PHONE
+420 720 755 085



MOBILE
+420 777 170 276



PLUJEME RÁDI S.R.O.
Dlouhá 730/35, 11000 Praha 1 – Staré Město, Czech Republic

PRICE AND AVAILABILITY

07.08. - 14.08.2027 6.520 €	14.08. - 21.08.2027 6.520 €	21.08. - 28.08.2027 6.520 €	28.08. - 04.09.2027 6.520 €
04.09. - 11.09.2027 6.520 €	11.09. - 18.09.2027 6.520 €	18.09. - 25.09.2027 6.520 €	25.09. - 02.10.2027 6.520 €
02.10. - 09.10.2027 6.520 €	09.10. - 16.10.2027 6.520 €	16.10. - 23.10.2027 6.520 €	23.10. - 30.10.2027 6.520 €
30.10. - 06.11.2027 6.520 €	06.11. - 13.11.2027 6.520 €	13.11. - 20.11.2027 6.520 €	20.11. - 27.11.2027 6.520 €
27.11. - 04.12.2027 6.520 €	04.12. - 11.12.2027 6.520 €	11.12. - 18.12.2027 6.520 €	18.12. - 25.12.2027 6.812 €



WEBSITE

www.plujeme.cz



E-MAIL

info@plujeme.cz



PHONE

+420 720 755 085



MOBILE

+420 777 170 276



PLUJEME RÁDI S.R.O.

Dlouhá 730/35, 11000 Praha 1 – Staré Město, Czech Republic