

# NAUTITECH 40

Negroni (2024)

Catamaran Nautitech 40 Negroni, built in 2024 is anchored in the Marina Frapa, Rogoznica, Šibenik region, Croatia. It has 3 cabins, can accommodate 6 + 2 people and has 2 toilets. Bed linen and kitchen equipment are included in the price.

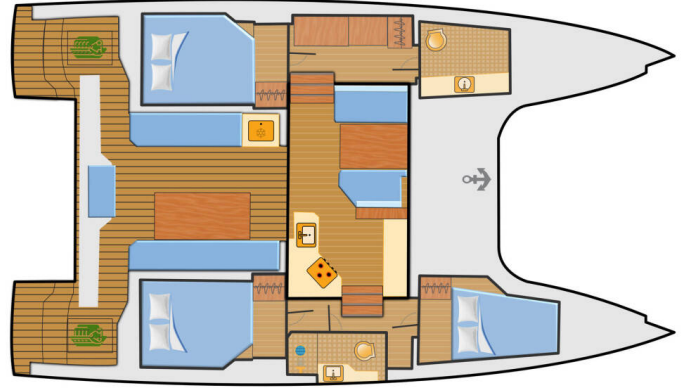

## YACHT SPECIFICATIONS

Yacht Base

**Marina Frapa, Rogoznica, Croatia**

Yacht ID

**6831**

Brands

**Nautitech**

Yacht name

**Negroni**

Production year

**2024**

Length

**39 ft**

Cabins

**3**

Berths

**6 + 2**

Max Persons

**8**

WC

**2**

Engine

**2 x 50 HP**

Fuel tank

**400 l**



**WEBSITE**

[www.plujeme.cz](http://www.plujeme.cz)



**PHONE**

+420 720 755 085



**MOBILE**

+420 777 170 276



**E-MAIL**

[info@plujeme.cz](mailto:info@plujeme.cz)



**PLUJEME RÁDI S.R.O.**

Dlouhá 730/35, 11000 Praha 1 – Staré Město, Czech Republic

## STANDARD YACHT EQUIPMENT

Comfort	Cockpit cushions
Deck	Anchor with chain, Bathing platform, Bimini top, Boat hook, Bosun's chair (Safe seat) (boatswain's chair), Cockpit grill, Cockpit table, Cockpit/stern, outside shower, Deck brush, Electric anchor windlass, Fenders, Gangway, Impeller, Jerry cans for diesel, Mooring ropes, Sailor's knife, Sprayhood, Swimming ladder, Teak cockpit
Entertainment	Indoor speakers, Radio CD player, USB, Bluetooth, Wi-Fi Internet, Wireless Internet Router
Galley	Coffee machine, Coffee pot, Freezer, Hot water, Oven, Refrigerator, Stove, Wine glasses
Interior	Barometer, Clock, Convertible table in salon, Electric fans, Electric fans in cabins, Electric toilet, Indirect lighting in cabins and salon, Lowerable salon table, Safe
Navigation	AIS, Autopilot, Binoculars, Compass, Folding propeller, GPS chart plotter, Nautical charts, Navigation/position Lights, Radar, Triangles
Safety	Automatic Inflatable Life Jacket, Black Water Tank, Emergency tiller, Fire extinguisher, First aid kit, Flashlight, Fog horn, Lifelines, VHF radio
Sails	Electric winch, Gennaker-device, Lazy bag, Lazy jacks
Yacht electrics	12V Socket, 220V socket, Adapter, Battery charger, Bilge pump - Electric, Converter 220V/12V, Heating, Inverter, Shore connection 220 V, Solar panels, USB sockets



**WEBSITE**

[www.plujeme.cz](http://www.plujeme.cz)



**PHONE**

+420 720 755 085



**MOBILE**

+420 777 170 276



**E-MAIL**

[info@plujeme.cz](mailto:info@plujeme.cz)



**PLUJEME RÁDI S.R.O.**

Dlouhá 730/35, 11000 Praha 1 – Staré Město, Czech Republic

## SERVICES

SELECTED SERVICES	OBLIGATORY	PAYMENT TYPE	PRICE
<b>Basic package for accommodation</b> (Payable at the base) <b>Season: 2026.</b> Cleaning, made Bed linen, Permit, WiFi, Towel set (1 small + 1 big one), Cooking gas, Rinsing set, Dinghy, Outboard Engine / in Cash or with credit card (VISA, MASTER)	Yes	per booking	<b>450,00 €</b>
<b>Deposit insurance</b> (Payable at the base) <b>Season: 2026.</b> Cash / The customers still have to deposit 100,00 €. If there is no damage, they get the 100,00 € back. We do not require any prior information. The customer can take out insurance at check-in.	No	per booking	<b>300,00 €</b>
<b>Early Check in</b> (Payable at the base) <b>Season: 2026.</b> On request; from 13:00; Payable in cash at the base	No	per booking	<b>150,00 €</b>
<b>Hostess</b> (Payable at the base) <b>Season: 2026.</b> + own cabin	No	per day + food	<b>150,00 €</b>
<b>Pet on board</b> (Payable at the base) <b>Season: 2026.</b> ONLY ON REQUEST!; Payable in cash at the base	No	per booking	<b>140,00 €</b>
<b>Skipper</b> (Payable at the base) <b>Season: 2026.</b> On request; Free food, own cabin; Payable in cash at the base	No	per day	<b>200,00 €</b>
<b>Transfer</b> (Payable at the base) <b>Season: 2026.</b> Transfer to Marina Frapa (Split Airport) 1-2 people €60 Shopping stop for 1 hour: If you arrive by taxi from the airport and would like to stop at the supermarket, this is possible, but the driver will have to charge you for it: From June 1st to September 30th, the stop costs €50, and €20 during the off-season (applies to transfers booked through us).	No	one-way	<b>60,00 €</b>
<b>Transfer</b> (Payable at the base) <b>Season: 2026.</b> Transfer to Marina Frapa (Split Airport) 3-4 people €75 Shopping stop for 1 hour: If you arrive by taxi from the airport and would like to stop at the supermarket, this is possible, but the driver will have to charge you for it: From June 1st to September 30th, the stop costs €50, and €20 during the off-season (applies to transfers booked through us).	No	one-way	<b>75,00 €</b>

**Transfer** (Payable at the base)

No

one-way

**85,00 €**

**Season: 2026.** Transfer to Marina Frapa (Split Airport) 5-8 people €85

Shopping stop for 1 hour: If you arrive by taxi from the airport and would like to stop at the supermarket, this is possible, but the driver will have to charge you for it: From June 1st to September 30th, the stop costs €50, and €20 during the off-season (applies to transfers booked through us).

**Transfer** (Payable at the base)

No

one-way

**140,00 €**

**Season: 2026.** Transfer to Marina Frapa (Split Airport) 9-15 people €140

Shopping stop for 1 hour: If you arrive by taxi from the airport and would like to stop at the supermarket, this is possible, but the driver will have to charge you for it: From June 1st to September 30th, the stop costs €50, and €20 during the off-season (applies to transfers booked through us).



**WEBSITE**

[www.plujeme.cz](http://www.plujeme.cz)



**PHONE**

+420 720 755 085



**MOBILE**

+420 777 170 276



**E-MAIL**

[info@plujeme.cz](mailto:info@plujeme.cz)



**PLUJEME RÁDI S.R.O.**

Dlouhá 730/35, 11000 Praha 1 – Staré Město, Czech Republic

## ADDITIONAL EXTRAS

EXTRA	OBLIGATORY	PAYMENT TYPE	PRICE
<b>Stand up paddle (SUP)</b> <i>(Payable at the base)</i>	No	per week	<b>100,00 €</b>
<b>Season: 2026.</b> 50% second week; Payable in cash at the base - Payable at the base			



#### WEBSITE

[www.plujeme.cz](http://www.plujeme.cz)



#### E-MAIL

[info@plujeme.cz](mailto:info@plujeme.cz)



#### PHONE

+420 720 755 085



#### MOBILE

+420 777 170 276



#### PLUJEME RÁDI S.R.O.

Dlouhá 730/35, 11000 Praha 1 – Staré Město, Czech Republic

## PRICE AND AVAILABILITY

13.06. - 27.06.2026 NOT AVAILABLE	27.06. - 04.07.2026 NOT AVAILABLE	04.07. - 11.07.2026 4.290 € 6.600 €	11.07. - 18.07.2026 4.290 € 6.600 €
18.07. - 01.08.2026 NOT AVAILABLE	01.08. - 08.08.2026 ON OPTION	08.08. - 15.08.2026 NOT AVAILABLE	15.08. - 22.08.2026 4.290 € 6.600 €
22.08. - 29.08.2026 NOT AVAILABLE	29.08. - 05.09.2026 4.290 € 6.600 €	05.09. - 12.09.2026 NOT AVAILABLE	12.09. - 19.09.2026 4.836 € 6.200 €
19.09. - 26.09.2026 NOT AVAILABLE	26.09. - 03.10.2026 4.056 € 5.200 €	03.10. - 10.10.2026 2.496 € 3.200 €	10.10. - 17.10.2026 1.950 € 2.500 €
17.10. - 24.10.2026 NOT AVAILABLE	24.10. - 31.10.2026 1.950 € 2.500 €	31.10. - 07.11.2026 1.950 € 2.500 €	07.11. - 14.11.2026 1.950 € 2.500 €
14.11. - 21.11.2026 2.500 €	21.11. - 28.11.2026 2.500 €	28.11. - 05.12.2026 2.500 €	05.12. - 12.12.2026 2.500 €
12.12. - 19.12.2026 2.500 €	19.12. - 26.12.2026 2.500 €	01.01. - 26.03.2027 NOT AVAILABLE	



WEBSITE

[www.plujeme.cz](http://www.plujeme.cz)



E-MAIL

[info@plujeme.cz](mailto:info@plujeme.cz)



PHONE

+420 720 755 085



MOBILE

+420 777 170 276



PLUJEME RÁDI S.R.O.

Dlouhá 730/35, 11000 Praha 1 – Staré Město, Czech Republic

## PRICE AND AVAILABILITY

27.03. - 03.04.2027 1.875 € 2.500 €	03.04. - 10.04.2027 1.875 € 2.500 €	10.04. - 17.04.2027 1.875 € 2.500 €	17.04. - 24.04.2027 1.875 € 2.500 €
24.04. - 01.05.2027 1.875 € 2.500 €	01.05. - 08.05.2027 NOT AVAILABLE	08.05. - 15.05.2027 2.400 € 3.200 €	15.05. - 22.05.2027 2.400 € 3.200 €
22.05. - 29.05.2027 3.900 € 5.200 €	29.05. - 05.06.2027 4.125 € 5.500 €	05.06. - 12.06.2027 4.125 € 5.500 €	12.06. - 19.06.2027 ON OPTION
19.06. - 26.06.2027 4.125 € 5.500 €	26.06. - 03.07.2027 4.125 € 5.500 €	03.07. - 10.07.2027 4.950 € 6.600 €	10.07. - 17.07.2027 4.950 € 6.600 €
17.07. - 24.07.2027 4.950 € 6.600 €	24.07. - 31.07.2027 4.950 € 6.600 €	31.07. - 07.08.2027 4.950 € 6.600 €	07.08. - 14.08.2027 4.950 € 6.600 €
14.08. - 21.08.2027 4.950 € 6.600 €	21.08. - 28.08.2027 4.950 € 6.600 €	28.08. - 04.09.2027 4.950 € 6.600 €	04.09. - 11.09.2027 4.650 € 6.200 €
11.09. - 18.09.2027 4.650 € 6.200 €	18.09. - 25.09.2027 4.125 € 5.500 €	25.09. - 02.10.2027 3.900 € 5.200 €	



WEBSITE

[www.plujeme.cz](http://www.plujeme.cz)



E-MAIL

[info@plujeme.cz](mailto:info@plujeme.cz)



PHONE

+420 720 755 085



MOBILE

+420 777 170 276



PLUJEME RÁDI S.R.O.

Dlouhá 730/35, 11000 Praha 1 – Staré Město, Czech Republic

## PRICE AND AVAILABILITY

02.10. - 09.10.2027

**2.400 €** 3.200 €

09.10. - 16.10.2027

**1.875 €** 2.500 €

16.10. - 23.10.2027

**1.875 €** 2.500 €

23.10. - 30.10.2027

**1.875 €** 2.500 €

30.10. - 06.11.2027

**1.875 €** 2.500 €

07.11. - 24.03.2028

NOT AVAILABLE



**WEBSITE**

[www.plujeme.cz](http://www.plujeme.cz)



**E-MAIL**

[info@plujeme.cz](mailto:info@plujeme.cz)



**PHONE**

+420 720 755 085



**MOBILE**

+420 777 170 276



**PLUJEME RÁDI S.R.O.**

Dlouhá 730/35, 11000 Praha 1 – Staré Město, Czech Republic