

BAVARIA CRUISER 46

Skrivena (2024)

Sailing yacht **Bavaria Cruiser 46 Skrivena**, built in **2024** is anchored in the **Marina Kastela, Split region, Croatia**. It has **4 cabins**, can accommodate **8 people** and has **3 toilets**. Bed linen and kitchen equipment are included in the price.

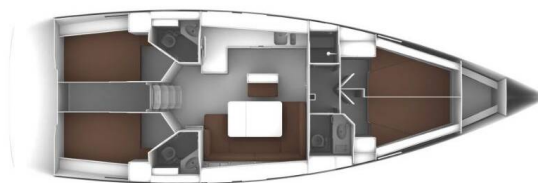

YACHT SPECIFICATIONS

Yacht Base

Marina Kastela, Croatia

Yacht ID

6799

Brands

Bavaria

Yacht name

Skrivena

Production year

2024

Length

47 ft

Cabins

4

Berths

8

Max Persons

9

WC

3

Engine

1 x 75 HP

Fuel tank

210 l



WEBSITE

www.plujeme.cz



PHONE

+420 720 755 085



MOBILE

+420 777 170 276



E-MAIL

info@plujeme.cz



PLUJEME RÁDI S.R.O.

Dlouhá 730/35, 11000 Praha 1 – Staré Město, Czech Republic

STANDARD YACHT EQUIPMENT

Additional	Flag
Comfort	Blankets, Pillows, Sheets
Deck	Anchor Jambo, Anchor with chain, Bathing platform, Bilge pump - Mechanic, Bimini top, Boat hook, Cockpit/stern, outside shower, Deck brush, Dinghy, Electric anchor windlass, Entrance Plexiglas panel, Fenders, Fuel funnel, Gangway, Impeller, V-belt, oilfilter, Mooring ropes, Plastic bucket, Sprayhood, Swimming ladder, Water hose, Winch handles
Entertainment	Bose Sound System, Fusion radio, Outdoor speakers, W-LAN GRATIS
Galley	Coffee pot, Gas bottles, Hot water, Kitchen utensils (Galley equipment, cutlery), Oven, Refrigerator, Stove
Interior	Barometer, Clothes hangers, Inside shower, Yacht documents
Navigation	Autopilot, Binoculars, Bow thruster, Compass, Divider, nautic chart, Echosounder/Depthsounder, Electronic sea charts, GPS chart plotter - cockpit, Log/speed instrument, Pilot book, Triangles
Safety	Distress flare box, Emergency tiller, Fire extinguisher, First aid kit, Fog horn, Horseshoe lifebuoy, Life belts (Safety harness), Life jackets, Liferaft, Oars (Paddles), Repair kit, Set of tools, VHF radio
Yacht electrics	Pump, Shore connection 220 V



WEBSITE

www.plujeme.cz



PHONE

+420 720 755 085



MOBILE

+420 777 170 276



E-MAIL

info@plujeme.cz



PLUJEME RÁDI S.R.O.

Dlouhá 730/35, 11000 Praha 1 - Staré Město, Czech Republic

SERVICES

SELECTED SERVICES	OBLIGATORY	PAYMENT TYPE	PRICE
Autopilot, bimini top, GPS, gas, sprayhood, dinghy, bed linen, bathing platform (Payable at the base) Season: 2026.	Yes	per booking	0,00 €
Charter package (Payable at the base) Season: 2026. final cleaning, outboard engine, Internet-WLAN Payable locally in the base, cash or Visa, Euro/Mastercard, Diners	Yes	per booking	300,00 €
Welcome package (Payable at the base) Season: 2026. Only in marina Kaštela: - Free parking for 1 or more cars - Free use of a swimming pool	Yes	per booking	0,00 €
Cook (Payable at the base) Season: 2026. payable on site (only cash payment possible)	No	per week + food	1.260,00 €
Crew change (Payable at the base) Season: 2026. extra bedlinen, on request	No	per booking	20,00 €
Crew list - Fill/Update fee (Payable at the base) Season: 2026.	No	per booking	30,00 €
Early boarding/check-in (Payable at the base) Season: 2026. 130€ - early check-in 13-14h - mohull	No	per booking	130,00 €
Entry Fee (Payable at the base) Season: 2026. includes regatta costs, welcome drink in Marina Kaštela, mooring drink with dinner - Bobovišće, dinner with wine and breakfast - Spinnaker restaurant, Bavadria - Friendship Regatta T-shirt	No	per booking	400,00 €
Extra cleaning- change of crew (Payable at the base) Season: 2026.	No	per booking	150,00 €
Hostess (Payable at the base) Season: 2026. payable on site (only cash payment possible)	No	per week	1.050,00 €
Mobile hand-held radio (Payable at the base) Season: 2026.	No	per booking	0,00 €
One way fee (Payable at the base) Season: 2026.	No	per booking	180,00 €

Permit for Montenegro (Payable at the base) Season: 2026. + Flag of Montenegro/ on request	No	per booking	0,00 €
Pet on board (Payable at the base) Season: 2026.	No	per booking	120,00 €
Regatta surcharge (Payable at the base) Season: 2026.	No	per boat	500,00 €
Rescheduling (Payable at the base) Season: 2026.	No	per service	50,00 €
Skipper (Payable at the base) Season: 2026. payable on site (only cash payment possible) - must have his own cabin	No	per day + food	200,00 €
Transfer (Payable at the base) Season: 2026. Marina Kastela - Aeroport Split - 5-8pax	No	one-way	50,00 €
Transfer (Payable at the base) Season: 2026. Marina Kastela - Trogir - 5-8pax	No	one-way	55,00 €
Transfer (Payable at the base) Season: 2026. Marina Kastela - Split - 5-8pax	No	one-way	55,00 €
Transit log (Payable at the base) Season: 2026.	No	per booking	0,00 €
Wardrobe (Payable at the base) Season: 2026.	No	per day	3,00 €



WEBSITE
www.plujeme.cz



E-MAIL
info@plujeme.cz



PHONE
+420 720 755 085



MOBILE
+420 777 170 276



PLUJEME RÁDI S.R.O.
Dlouhá 730/35, 11000 Praha 1 – Staré Město, Czech Republic

ADDITIONAL EXTRAS

EXTRA	OBLIGATORY	PAYMENT TYPE	PRICE
Extra bedlinen (Payable at the base) Season: 2026. for two or three weeks/ on request - Payable at the base	No	per week/ person	20,00 €
Gennaker (Payable at the base) Season: 2026. 1000 EUR additional deposit - Payable at the base	No	per week	200,00 €
Life jacket (children) (Payable at the base) Season: 2026. on request - Payable at the base	No	per week	0,00 €
Railing net (Safety net) (Payable at the base) Season: 2026. Payable at the base	No	per week	50,00 €
Towels (Payable at the base) Season: 2026. one small and one large - Payable at the base	No	per week/ person	5,00 €

**WEBSITE**www.plujeme.cz**E-MAIL**info@plujeme.cz**PHONE**

+420 720 755 085

**MOBILE**

+420 777 170 276

**PLUJEME RÁDI S.R.O.**

Dlouhá 730/35, 11000 Praha 1 – Staré Město, Czech Republic

PRICE AND AVAILABILITY

06.06. - 13.06.2026 NOT AVAILABLE	13.06. - 20.06.2026 NOT AVAILABLE	20.06. - 27.06.2026 NOT AVAILABLE	27.06. - 04.07.2026 3.555 € 4.740 €
04.07. - 11.07.2026 3.555 € 4.740 €	11.07. - 18.07.2026 3.825 € 5.100 €	18.07. - 25.07.2026 3.825 € 5.100 €	25.07. - 01.08.2026 3.825 € 5.100 €
01.08. - 15.08.2026 NOT AVAILABLE	15.08. - 22.08.2026 3.555 € 4.740 €	22.08. - 29.08.2026 3.555 € 4.740 €	29.08. - 05.09.2026 3.450 € 4.600 €
05.09. - 12.09.2026 3.450 € 4.600 €	12.09. - 19.09.2026 NOT AVAILABLE	19.09. - 26.09.2026 NOT AVAILABLE	26.09. - 03.10.2026 NOT AVAILABLE
03.10. - 10.10.2026 NOT AVAILABLE	10.10. - 17.10.2026 NOT AVAILABLE	17.10. - 24.10.2026 1.905 € 2.540 €	24.10. - 31.10.2026 1.905 € 2.540 €
31.10. - 07.11.2026 1.905 € 2.540 €	07.11. - 14.11.2026 1.905 € 2.540 €	14.11. - 21.11.2026 1.905 € 2.540 €	21.11. - 28.11.2026 1.905 € 2.540 €
28.11. - 05.12.2026 1.905 € 2.540 €	05.12. - 12.12.2026 1.905 € 2.540 €	12.12. - 19.12.2026 1.905 € 2.540 €	19.12. - 26.12.2026 1.905 € 2.540 €



WEBSITE

www.plujeme.cz



E-MAIL

info@plujeme.cz



PHONE

+420 720 755 085



MOBILE

+420 777 170 276



PLUJEME RÁDI S.R.O.

Dlouhá 730/35, 11000 Praha 1 – Staré Město, Czech Republic