

BALI 4.4

My Ares (2024)

Catamaran Bali 4.4 My Ares, built in 2024 is anchored in the Göcek, Aegean, Turkey. It has 4 + 1 cabins, can accommodate 8 people and has 4 + 1 toilets. Bed linen and kitchen equipment are included in the price.

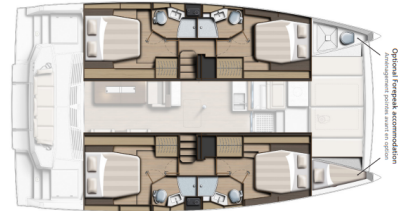

YACHT SPECIFICATIONS

Yacht Base

Göcek, Turkey

Yacht ID

6770

Brands

Catana

Yacht name

My Ares

Production year

2024

Length

44 ft

Cabins

4 + 1

Berths

8

WC

4 + 1

Engine

2 x 59 HP

Fuel tank

800 l



WEBSITE

www.plujeme.cz



PHONE

+420 720 755 085



MOBILE

+420 777 170 276



E-MAIL

info@plujeme.cz



PLUJEME RÁDI S.R.O.

Dlouhá 730/35, 11000 Praha 1 – Staré Město, Czech Republic

STANDARD YACHT EQUIPMENT

Additional	Flag
Comfort	Blankets, Cockpit cushions, Pillows
Deck	Anchor with chain, Bilge pump - Mechanic, Bimini top, Boat hook, Bosun's chair (Safe seat) (boatswain's chair), Cockpit table with light, Cockpit/stern, outside shower, Deck brush, Electric anchor windlass, Fenders, Fuel funnel, Gangway, Grill/Barbecue/Plancha, Jerry cans for diesel, Plastic bucket, Repair box for dinghy, Sponge, Sun awning (aft), Swimming ladder, Teak cockpit, Winch handles
Entertainment	AUX Input, Mask and snorkel, Radio CD player, USB, AUX input
Galley	Coffee machine, Dishwasher, Dishwashing liquid, Gas bottles, Gas cookers, Hot water, Kitchen utensils (Galley equipment, cutlery), Refrigerator, Sink
Interior	Barometer, Clock
Navigation	Autopilot, Binoculars, Compass, GPS chart plotter, Hand bearing compass, Log, Speed, Depth-echo sounder, Navigation (Nautical) charts and nautical guide, Pilot book, Radar reflector, Wind instrument/Anemometer, Windex
Safety	Black Water Tank, Distress signals, Emergency tiller, Engine spare parts, Fire blanket, Fire extinguisher, First aid kit, Fog horn, Life belts (Safety harness), Life buoy + Flashing light, Life jackets, Liferaft, Repair kit, Search light, Set of tools, Sos Dan Buoy, Torch, VHF radio
Yacht electrics	12V Socket, 220V socket, Air Conditioning, Batteries, Battery charger, Bilge pump - Electric, Generator, Inverter, Pump, Service batteries, Shore power cable, Solar panels, Watermaker - desalinator



WEBSITE

www.plujeme.cz



PHONE

+420 720 755 085



MOBILE

+420 777 170 276



E-MAIL

info@plujeme.cz



PLUJEME RÁDI S.R.O.

Dlouhá 730/35, 11000 Praha 1 – Staré Město, Czech Republic

SERVICES

SELECTED SERVICES	OBLIGATORY	PAYMENT TYPE	PRICE
Standard package (Payable at the base) Season: 2026. Includes : Transitlog, final cleaning, bed linen & towels, outboard engine & fuel, Turkish mobile phone for emergency calls to the base, other E.G.G. Yachts and bay restaurants / marinas. Only local calls, with the option to receive international calls.	Yes	per booking	500,00 €
Cook (Payable at the base) Season: 2026.	No	per day + food	170,00 €
Damage waiver (Payable at the base) Season: 2026. All damages are covered (except any damage or loss of outboard & dinghy)	No	per booking	600,00 €
Deckhand/ Marinero (Payable at the base) Season: 2026.	No	per day + food	170,00 €
Early Check in (Payable at the base) Season: 2026. at 13.00 hr (limited with 3 bookings / week)	No	per booking	250,00 €
Exclusive package (Payable at the base) Season: 2026. Includes : Standard package + Damage waiver (except total loss of outboard & dingy)+ 20 GB Wi-Fi internet on board	No	per booking	1.000,00 €
Final cleaning (Payable at the base) Season: 2026.	No	per booking	110,00 €
Hostess/Cook (Payable at the base) Season: 2026.	No	per day + food	170,00 €
Regatta (Payable at the base) Season: 2026. + 2x Security Deposit; Race Preparations Fees	No	per booking	150,00 €
Skipper (Payable at the base) Season: 2026.	No	per day + food	210,00 €
Transfer (Payable at the base) Season: 2026. Transfer up to 3 pax, Dalaman Airport to Göcek Base/MUCEV or reverse.	No	one-way	50,00 €

Transfer (Payable at the base)	No	one-way	70,00 €
Season: 2026. Transfer up to 6 pax with Minibus, Dalaman Airport to Göcek Base/MUCEV or reverse			
Transfer (Payable at the base)	No	one-way	90,00 €
Season: 2026. Transfer up to 14 pax with Minibus, Dalaman Airport to Göcek Base/MUCEV or reverse			
Wireless Internet Router (Payable at the base)	No	per booking	50,00 €
Season: 2026. 20 GB			
Wireless Internet Router (Payable at the base)	No	per booking	100,00 €
Season: 2026. Limitless			



WEBSITE

www.plujeme.cz



E-MAIL

info@plujeme.cz



PHONE

+420 720 755 085



MOBILE

+420 777 170 276



PLUJEME RÁDI S.R.O.

Dlouhá 730/35, 11000 Praha 1 – Staré Město, Czech Republic

ADDITIONAL EXTRAS

EXTRA	OBLIGATORY	PAYMENT TYPE	PRICE
Bed linen (Payable at the base) Season: 2026. Payable at the base	No	per set	5,00 €
Comfort seats (Payable at the base) Season: 2026. + deposit - Payable at the base	No	per week	30,00 €
Comfort seats (Payable at the base) Season: 2026. for pair / week & boat +deposit - Payable at the base	No	per week	50,00 €
Gennaker (Payable at the base) Season: 2026. security deposit 1000 EUR - Payable at the base	No	per week	400,00 €
Outboard engine (Payable at the base) Season: 2026. Payable at the base	No	per week	75,00 €
Railing net (Safety net) (Payable at the base) Season: 2026. mounting and dismounting - Payable at the base	No	per booking	200,00 €
Spinnaker (Payable at the base) Season: 2026. security deposit 1000 EUR - Payable at the base	No	per week	400,00 €
Stand up paddle (SUP) (Payable at the base) Season: 2026. + deposit 600 EUR - Payable at the base	No	per week	150,00 €
Towels (Payable at the base) Season: 2026. Payable at the base	No	per set	5,00 €



WEBSITE
www.plujeme.cz



E-MAIL
info@plujeme.cz



PHONE
+420 720 755 085



PLUJEME RÁDI S.R.O.
Dlouhá 730/35, 11000 Praha 1 – Staré Město, Czech Republic



MOBILE
+420 777 170 276

PRICE AND AVAILABILITY

02.05. - 09.05.2026 6.750 € 9.000 €	09.05. - 16.05.2026 NOT AVAILABLE	16.05. - 23.05.2026 6.750 € 9.000 €	23.05. - 30.05.2026 NOT AVAILABLE
30.05. - 06.06.2026 NOT AVAILABLE	06.06. - 13.06.2026 9.765 € 10.850 €	13.06. - 20.06.2026 9.765 € 10.850 €	20.06. - 27.06.2026 9.765 € 10.850 €
27.06. - 04.07.2026 NOT AVAILABLE	04.07. - 11.07.2026 NOT AVAILABLE	11.07. - 18.07.2026 NOT AVAILABLE	18.07. - 25.07.2026 NOT AVAILABLE
25.07. - 01.08.2026 9.000 € 10.000 €	01.08. - 08.08.2026 NOT AVAILABLE	08.08. - 15.08.2026 NOT AVAILABLE	15.08. - 22.08.2026 NOT AVAILABLE
22.08. - 29.08.2026 NOT AVAILABLE	29.08. - 05.09.2026 9.765 € 10.850 €	05.09. - 12.09.2026 NOT AVAILABLE	12.09. - 19.09.2026 10.575 € 11.750 €
19.09. - 26.09.2026 10.575 € 11.750 €	26.09. - 03.10.2026 NOT AVAILABLE	03.10. - 10.10.2026 10.575 € 11.750 €	10.10. - 17.10.2026 10.575 € 11.750 €
17.10. - 24.10.2026 NOT AVAILABLE	24.10. - 31.10.2026 NOT AVAILABLE	31.10. - 07.11.2026 9.000 € 10.000 €	07.11. - 14.11.2026 5.535 € 6.150 €
14.11. - 21.11.2026 ON OPTION	21.11. - 28.11.2026 5.535 € 6.150 €	28.11. - 05.12.2026 5.535 € 6.150 €	05.12. - 12.12.2026 5.535 € 6.150 €
12.12. - 19.12.2026 5.535 € 6.150 €	19.12. - 26.12.2026 5.535 € 6.150 €		



WEBSITE

www.plujeme.cz



E-MAIL

info@plujeme.cz



PHONE

+420 720 755 085



MOBILE

+420 777 170 276



PLUJEME RÁDI S.R.O.

Dlouhá 730/35, 11000 Praha 1 – Staré Město, Czech Republic