

FOUNTAIN PAJOT ISLA 40

Ninoa (2023)

Catamaran Fountaine Pajot Isla 40 Ninoa, built in 2023 is anchored in the Marina Frapa, Rogoznica, Šibenik region, Croatia. It has 3 cabins, can accommodate 6 + 1 people and has 2 toilets. Bed linen and kitchen equipment are included in the price.

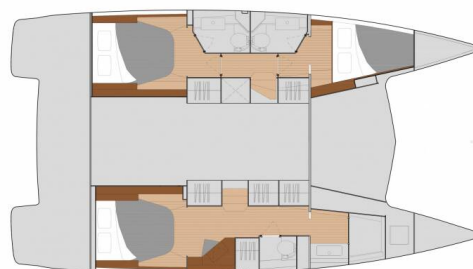

YACHT SPECIFICATIONS

Yacht Base

Marina Frapa, Rogoznica, Croatia

Yacht ID

6760

Brands

Fountaine Pajot

Yacht name

Ninoa

Production year

2023

Length

39 ft

Cabins

3

Berths

6 + 1

WC

2

Engine

2 x 30 HP

Fuel tank

300 l



WEBSITE

www.plujeme.cz



PHONE

+420 720 755 085



MOBILE

+420 777 170 276



E-MAIL

info@plujeme.cz



PLUJEME RÁDI S.R.O.

Dlouhá 730/35, 11000 Praha 1 - Staré Město, Czech Republic

STANDARD YACHT EQUIPMENT

Comfort	Cockpit cushions, Sundeck cushions
Deck	Anchor line, Anchor swivel, Bimini top, Black ball, Black conus, Boat hook, Bosun's chair (Safe seat) (boatswain's chair), Chairs, Cockpit table with light, Cockpit/stern, outside shower, Davit, Dinghy, Dinghy (byboat) pump, Dinghy with outboard engine, Electric anchor windlass, Fenders, Gangway, Hawser, Jerry cans for diesel, Main anchor, Mooring ropes, Plastic bucket, Remote control for anchor winch with chain counter at helm, Repair box for dinghy, Round/globular fender, Spare anchor (Reserve, Auxiliary anchor), Spotlight / Headlights, Sprayhood, Spring line, Water hose
Entertainment	Outdoor speakers
Galley	Coffee machine, Gas bottles, Hot water, Kitchen utensils (Galley equipment, cutlery), Refrigerator
Interior	Barometer, Clock, Electric fans in cabins, Electric toilet, Lowerable salon table
Navigation	3 blade folding propeller, AIS, Autopilot, Binoculars, Bretonplotter, Composite steering wheels, GPS chart plotter, Harbour guides, Logge/Lot/Speed/Wind, Navigation (Nautical) charts and nautical guide, Navigation set, Parallel ruler, Radar, Radar reflector, Screen, Tridata, Windex
Safety	Distress signals, EPIRB-Distress radio beacons, Fire extinguisher, First aid kit, Flashlight, Fog horn, Life belts (Safety harness), Life buoy + Flashing light, Life jackets, Liferaft, Set of tools, VHF radio, Wire (shroud) cutter
Sails	Electric winch, Gennaker-device, Lazy bag, Lazy jacks
Yacht electrics	Air Conditioning, Battery charger, Generator, Heating, Inverter, Shore connection 220 V, Solar panels, USB sockets



WEBSITE

www.plujeme.cz



PHONE

+420 720 755 085



MOBILE

+420 777 170 276



E-MAIL

info@plujeme.cz



PLUJEME RÁDI S.R.O.

Dlouhá 730/35, 11000 Praha 1 – Staré Město, Czech Republic

SERVICES

SELECTED SERVICES	OBLIGATORY	PAYMENT TYPE	PRICE
Permit (Payable at the base) Season: 2026. Incl. In price: Final cleaning, Starter pack: Washing-up liquid, sponge, tea towel, Wettex, toilet paper, 1 set/bed line person, towel set per person, fuel gas bottle, Hygienic Pack (4x body lotion 30ml, 4x Shower gel 4x shampoo 4x Hard soap)	Yes	per booking	390,00 €
WI-FI Internet connection on boat (Payable at the base) Season: 2026. UNLIMITED	Yes	per booking	0,00 €
Deposit insurance (Payable at the base) Season: 2026. +100 EUR refundable deposit (CASH ONLY)	No	per booking	300,00 €
Early Check in (Payable at the base) Season: 2026. Check-in 1:00-2:00 pm max. 4 yachts	No	per booking	250,00 €
Extra cleaning (Payable at the base) Season: 2026.	No	per booking	200,00 €
Hostess (Payable at the base) Season: 2026. The hostess is an independent service provider, with charter company solely as an intermediary. Payment for the services is to be made directly to the hostess at start of the charter. Please note that hostess requires a dedicated cabin for the duration of the charter. Additionally, it is the charterer's responsibility to provide meals for the hostess throughout the charter period.	No	per day + food	180,00 €
Pet on board (Payable at the base) Season: 2026.	No	per booking	100,00 €
Skipper (Payable at the base) Season: 2026. Driving boat and dinghy, responsible for the crew, making reservations in the restaurants. The skipper is an independent service provider, with charter company solely as an intermediary. Payment for the services is to be made directly to the skipper at start of the charter. Please note that skipper requires a dedicated cabin for the duration of the charter. Additionally, it is the charterer's responsibility to provide meals for the skipper throughout the charter period.	No	per day + food	200,00 €
Transfer (Payable at the base) Season: 2026. price on daily base	No	per booking	0,00 €



WEBSITE
www.plujeme.cz



PHONE
+420 720 755 085



MOBILE
+420 777 170 276



E-MAIL
info@plujeme.cz



PLUJEME RÁDI S.R.O.
Dlouhá 730/35, 11000 Praha 1 – Staré Město, Czech Republic

ADDITIONAL EXTRAS

EXTRA	OBLIGATORY	PAYMENT TYPE	PRICE
Beach towel (Payable at the base) Season: 2026. Payable at the base	No	per booking	5,00 €
Cockpit full tent (Payable at the base) Season: 2026. ON REQUEST - Payable at the base	No	per booking	0,00 €
Extra bedlinen (Payable at the base) Season: 2026. 1 set/person - Payable at the base	No	per booking	5,00 €
Extra towels (Payable at the base) Season: 2026. 1 Set already included - Payable at the base	No	per booking	5,00 €
Grill/Barbecue/Plancha (Payable at the base) Season: 2026. Payable at the base	No	per week	100,00 €
Ice maker (Payable at the base) Season: 2026. Payable at the base	No	per week	100,00 €
Outboard engine (Payable at the base) Season: 2026. included in price - Payable at the base	No	per week	0,00 €
Snorkeling equipment (Payable at the base) Season: 2026. mask, flippers and snorkel - Payable at the base	No	per week	35,00 €
Stand up paddle (SUP) (Payable at the base) Season: 2026. Payable at the base	No	per week	120,00 €



WEBSITE
www.plujeme.cz



PHONE
+420 720 755 085



MOBILE
+420 777 170 276



E-MAIL
info@plujeme.cz



PLUJEME RÁDI S.R.O.
Dlouhá 730/35, 11000 Praha 1 – Staré Město, Czech Republic

PRICE AND AVAILABILITY

25.04. - 02.05.2026 1.853 € 2.850 €	02.05. - 09.05.2026 2.178 € 3.350 €	13.05. - 18.05.2026 NOT AVAILABLE	23.05. - 30.05.2026 NOT AVAILABLE
30.05. - 06.06.2026 3.510 € 5.400 €	06.06. - 20.06.2026 NOT AVAILABLE	20.06. - 27.06.2026 NOT AVAILABLE	27.06. - 04.07.2026 4.193 € 6.450 €
04.07. - 11.07.2026 4.388 € 6.750 €	11.07. - 18.07.2026 NOT AVAILABLE	18.07. - 25.07.2026 NOT AVAILABLE	25.07. - 01.08.2026 ON OPTION
01.08. - 08.08.2026 4.518 € 6.950 €	08.08. - 15.08.2026 ON OPTION	15.08. - 22.08.2026 NOT AVAILABLE	22.08. - 29.08.2026 ON OPTION
29.08. - 05.09.2026 3.543 € 5.450 €	05.09. - 12.09.2026 NOT AVAILABLE	12.09. - 19.09.2026 NOT AVAILABLE	19.09. - 03.10.2026 NOT AVAILABLE
03.10. - 17.10.2026 NOT AVAILABLE	17.10. - 24.10.2026 1.824 € 2.400 €	25.10. - 31.12.2026 NOT AVAILABLE	



WEBSITE

www.plujeme.cz



E-MAIL

info@plujeme.cz



PHONE

+420 720 755 085



MOBILE

+420 777 170 276



PLUJEME RÁDI S.R.O.

Dlouhá 730/35, 11000 Praha 1 – Staré Město, Czech Republic