

BALI 4.5

Sylvester (2019)

Catamaran Bali 4.5 Sylvester, built in 2019 is anchored in the Marina Mandalina, Sibenik, Šibenik region, Croatia. It has 4 + 2 cabins, can accommodate 8 + 2 + 2 people and has 4 toilets. Bed linen and kitchen equipment are included in the price.

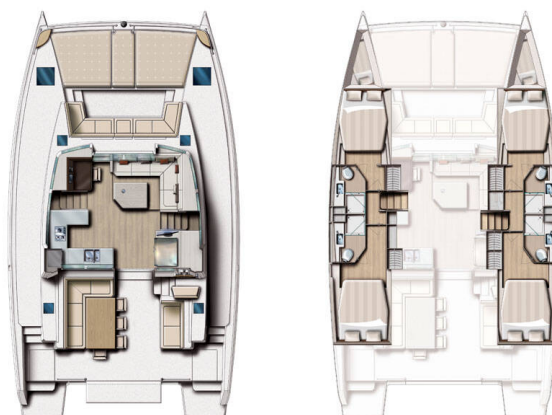

YACHT SPECIFICATIONS

Yacht Base

Marina Mandalina, Sibenik, Croatia

Yacht ID

6721

Brands

Catana

Yacht name

Sylvester

Production year

2019

Length

45 ft

Cabins

4 + 2

Berths

8 + 2 + 2

Max Persons

12

WC

4

Engine

2 x 76 HP

Fuel tank

800 l



WEBSITE

www.plujeme.cz



PHONE

+420 720 755 085



MOBILE

+420 777 170 276



E-MAIL

info@plujeme.cz



PLUJEME RÁDI S.R.O.

Dlouhá 730/35, 11000 Praha 1 – Staré Město, Czech Republic

STANDARD YACHT EQUIPMENT

| | |
|-----------------|--|
| Deck | Anchor, Anchor with chain, Bimini top, Cockpit full tent, Cockpit/stern, outside shower, Dinghy, Electric anchor windlass, Floating rope, Grill/Barbecue/Plancha, Main anchor, Spare anchor (Reserve, Auxiliary anchor) |
| Entertainment | Radio CD player, TV |
| Galley | Hot water, Sink |
| Navigation | Autopilot, Depthsounder, GPS chart plotter, Log/speed instrument, Wind instrument/Anemometer |
| Safety | Distress flare box, Fire extinguisher, First aid kit, Life belts (Safety harness), Life buoy + Flashing light, Liferaft, Sos Dan Buoy |
| Sails | Electric halyard winch, Lazy bag, Lazy jacks |
| Yacht electrics | Air Conditioning, Generator, Heating, Inverter, Service batteries, Shore connection 220 V, Shore power cable, Solar panels, Start battery |



WEBSITE

www.plujeme.cz



PHONE

+420 720 755 085



MOBILE

+420 777 170 276



E-MAIL

info@plujeme.cz



PLUJEME RÁDI S.R.O.

Dlouhá 730/35, 11000 Praha 1 – Staré Město, Czech Republic

SERVICES

| SELECTED SERVICES | OBLIGATORY | PAYMENT TYPE | PRICE |
|---|------------|----------------|-----------------|
| Charter pack (Payable at the base) Season: 2026. includes final cleaning, bedlinen, towels - 1 set/person, cooking gas | Yes | per booking | 470,00 € |
| Outboard engine (Payable at the base) Season: 2026. Free of charge for bookings in May | Yes | per booking | 0,00 € |
| Comfort Pack (Payable at the base) Season: 2026. includes outboard 2,5 HP, WiFi routers | No | per week | 105,00 € |
| Deposit insurance (Payable at the base) Season: 2026. + 450 EUR refundable deposit | No | per booking | 380,00 € |
| Early Check in (Payable at the base) Season: 2026. Saturdays between 13hr - 14hr. Early check in can be confirmed only on embarkation day in the charter base. | No | per booking | 250,00 € |
| Flexible booking (Payable now) Season: 2026. allows you to cancel or rebook your charter up to 30 days before the embarkation for no specific reason. You can reschedule your holiday at no cost for unlimited number of times or use a credit note if you are uncertain of new charter dates. With our FLEX PLAN your rebooking costs are completely eliminated while cancellation costs with refund option are reduced to a minimum (15% of the charter fee, min 350 EUR). Extra bonus: free cancellation and FULL REFUND granted in case of closed state borders within 7 days before the embarkation. Notes: FLEX PLAN costs 7% of the final charter price, can be added to booking up to 72hr after booking confirmation and is not available for bookings confirmed within 30 days before the embarkation. | No | per booking | 0,00 € |
| Hostess (Payable now) Season: 2026. + own cabin 50% cancellation fee in case of cancellation up to 15 days prior to embarkation 100% cancellation fee in case of cancellation within 14 days prior to embarkation | No | per day + food | 220,00 € |
| Late check out (Payable at the base) Season: 2026. Saturdays till 10hr Late check-out can be confirmed only on Friday before the embarkation day. | No | per booking | 350,00 € |

| | | | |
|---|----|----------------|-----------------|
| One way fee (Payable at the base) | No | per booking | 250,00 € |
| Season: 2026. Ši - Bio / Bio - Ši On request only. One-way conditions: one way fee + skipper service obligatory for the whole booking period + mooring fee in port of disembarkation/embarkation check-out on Friday until 12:00 in Biograd/Šibenik | | | |
| One way fee (Payable at the base) | No | per booking | 320,00 € |
| Season: 2026. Ši - Kas / Kas - Ši On request only. One-way conditions: one way fee + skipper service obligatory for the whole booking period + mooring fee in port of disembarkation/embarkation; check-out on Friday until 12:00 in Kaštela/Šibenik | | | |
| Pet on board (Payable at the base) | No | per booking | 150,00 € |
| Season: 2026. Small or medium pet, up to 25 kg | | | |
| Provisioning (Payable now) | No | per booking | 0,00 € |
| Season: 2026. upon request + price of groceries, to be done online | | | |
| Skipper (Payable now) | No | per day + food | 240,00 € |
| Season: 2026. + own cabin 50% cancellation fee in case of cancellation up to 15 days prior to embarkation 100% cancellation fee in case of cancellation within 14 days prior to embarkation | | | |



WEBSITE

www.plujeme.cz



PHONE

+420 720 755 085



MOBILE

+420 777 170 276



E-MAIL

info@plujeme.cz



PLUJEME RÁDI S.R.O.

Dlouhá 730/35, 11000 Praha 1 – Staré Město, Czech Republic

ADDITIONAL EXTRAS

| EXTRA | OBLIGATORY | PAYMENT TYPE | PRICE |
|---|------------|--------------|-------------------|
| Beach towel (Payable at the base) Season: 2026. Payable at the base | No | per piece | 8,00 € |
| eFoil (Payable now) Season: 2026. Loft Foil / Awake Vinga Security deposit: 1000 EUR Cancellation policy: 50% cancellation fee in case of cancellation within 2 weeks prior to embarkation. Delivery fee – 200,00 EUR – Payable now | No | per week | 2.000,00 € |
| Extra bedlinen (Payable at the base) Season: 2026. Payable at the base | No | per set | 15,00 € |
| Floating Water Hammock (Payable at the base) Season: 2026. Partyzone – Payable at the base | No | per week | 220,00 € |
| JetBoard (Payable now) Season: 2026. Awake Security deposit: 1000 EUR Cancellation policy: 50% cancellation fee in case of cancellation within 2 weeks prior to embarkation. Delivery fee – 200,00 EUR – Payable now | No | per week | 2.200,00 € |
| Outboard engine 2,5 HP (Payable at the base) Season: 2026. Payable at the base | No | per week | 100,00 € |
| Outboard engine 5 HP (Payable at the base) Season: 2026. on request – Payable at the base | No | per week | 150,00 € |
| Railing net (Safety net) (Payable at the base) Season: 2026. Rental without mounting – Payable at the base | No | per booking | 20,00 € |
| Seabob (Payable now) Season: 2026. Seabob F5 Security deposit: 500 EUR Cancellation policy: 50% cancellation fee in case of cancellation within 2 weeks prior to embarkation. Delivery fee – 200,00 EUR – Payable now | No | per week | 1.000,00 € |
| Seabob (Payable now) Season: 2026. Seabob F5S Security deposit: 500 EUR Cancellation policy: 50% cancellation fee in case of cancellation within 2 weeks prior to embarkation. Delivery fee – 200,00 EUR – Payable now | No | per week | 1.200,00 € |

| | | | |
|---|----|----------|-------------------|
| Seabob (Payable now) | No | per week | 1.300,00 € |
| Season: 2026. Seabob F9 Security deposit: 500 EUR Cancellation policy: 50% cancellation fee in case of cancellation within 2 weeks prior to embarkation. Delivery fee – 200,00 EUR – Payable now | | | |
| Seabob (Payable now) | No | per week | 1.500,00 € |
| Season: 2026. Seabob F5SR Security deposit: 500 EUR Cancellation policy: 50% cancellation fee in case of cancellation within 2 weeks prior to embarkation. Delivery fee – 200,00 EUR – Payable now | | | |
| Seabob (Payable now) | No | per week | 1.500,00 € |
| Season: 2026. Seabob F9S Security deposit: 500 EUR Cancellation policy: 50% cancellation fee in case of cancellation within 2 weeks prior to embarkation. Delivery fee – 200,00 EUR – Payable now | | | |
| Stand up paddle (SUP) (Payable at the base) | No | per week | 120,00 € |
| Season: 2026. Payable at the base | | | |
| Towels (Payable at the base) | No | per set | 8,00 € |
| Season: 2026. 2 psc/set (1 x 50x100cm + 1 x 70x140cm) – Payable at the base | | | |
| Wi-Fi Internet (Payable at the base) | No | per week | 25,00 € |
| Season: 2026. Payable at the base | | | |



WEBSITE

www.plujeme.cz



PHONE

+420 720 755 085



MOBILE

+420 777 170 276



E-MAIL

info@plujeme.cz



PLUJEME RÁDI S.R.O.

Dlouhá 730/35, 11000 Praha 1 – Staré Město, Czech Republic

PRICE AND AVAILABILITY

| | | | |
|--|---|---|--|
| 25.04. - 02.05.2026 2.368 € 2.960 € | 02.05. - 09.05.2026 2.368 € 2.960 € | 09.05. - 16.05.2026 2.704 € 3.380 € | 16.05. - 23.05.2026 3.056 € 3.820 € |
| 23.05. - 30.05.2026 4.336 € 5.420 € | 30.05. - 06.06.2026 NOT AVAILABLE | 06.06. - 20.06.2026 NOT AVAILABLE | 20.06. - 02.07.2026 NOT AVAILABLE |
| 04.07. - 11.07.2026 NOT AVAILABLE | 11.07. - 18.07.2026 7.744 € 9.680 € | 18.07. - 25.07.2026 NOT AVAILABLE | 25.07. - 01.08.2026 8.624 € 10.780 € |
| 01.08. - 08.08.2026 8.624 € 10.780 € | 08.08. - 15.08.2026 NOT AVAILABLE | 15.08. - 22.08.2026 NOT AVAILABLE | 22.08. - 29.08.2026 NOT AVAILABLE |
| 29.08. - 05.09.2026 6.592 € 8.240 € | 05.09. - 12.09.2026 NOT AVAILABLE | 12.09. - 19.09.2026 NOT AVAILABLE | 19.09. - 26.09.2026 NOT AVAILABLE |
| 26.09. - 03.10.2026 3.696 € 4.620 € | 03.10. - 10.10.2026 2.976 € 3.720 € | 10.10. - 17.10.2026 2.656 € 3.320 € | 17.10. - 24.10.2026 2.496 € 3.120 € |
| 24.10. - 31.10.2026 2.496 € 3.120 € | 31.10. - 07.11.2026 2.496 € 3.120 € | 07.11. - 14.11.2026 2.496 € 3.120 € | 14.11. - 21.11.2026 2.496 € 3.120 € |
| 21.11. - 28.11.2026 2.496 € 3.120 € | 28.11. - 05.12.2026 2.496 € 3.120 € | | |



WEBSITE

www.plujeme.cz



E-MAIL

info@plujeme.cz



PHONE

+420 720 755 085



MOBILE

+420 777 170 276



PLUJEME RÁDI S.R.O.

Dlouhá 730/35, 11000 Praha 1 – Staré Město, Czech Republic

PRICE AND AVAILABILITY

05.12. - 12.12.2026

2.496 € 3.120 €

12.12. - 19.12.2026

2.496 € 3.120 €

19.12. - 26.12.2026

2.496 € 3.120 €



WEBSITE

www.plujeme.cz



E-MAIL

info@plujeme.cz



PHONE

+420 720 755 085



MOBILE

+420 777 170 276



PLUJEME RÁDI S.R.O.

Dlouhá 730/35, 11000 Praha 1 – Staré Město, Czech Republic