

BALI CATSPACE

L Hippocampe (2024)

Catamaran Bali Catspace L Hippocampe, built in 2024 is anchored in the **Bormes Les Mimosas, Provence-Alpes-Côte d'Azur, France**. It has **4 cabins**, can accommodate **8 + 2 people** and has **4 toilets**. Bed linen and kitchen equipment are included in the price.

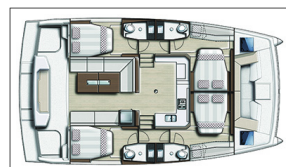

YACHT SPECIFICATIONS

Yacht Base

Bormes Les Mimosas, France

Yacht ID

6699

Brands

Catana

Yacht name

L Hippocampe

Production year

2024

Length

40 ft

Cabins

4

Berths

8 + 2

WC

4

Engine

2 x 30 HP

Fuel tank

400 l



WEBSITE

www.plujeme.cz



PHONE

+420 720 755 085



MOBILE

+420 777 170 276



E-MAIL

info@plujeme.cz



PLUJEME RÁDI S.R.O.

Dlouhá 730/35, 11000 Praha 1 – Staré Město, Czech Republic

STANDARD YACHT EQUIPMENT

| | |
|-----------------|--|
| Comfort | Cockpit cushions, Sun mattresses, Sundeck cushions |
| Deck | Anchor, Bathing platform, Bimini top, Cockpit/stern, outside shower, Deck brush, Dinghy, Electric anchor windlass, Fenders, Plastic bucket, Sprayhood |
| Entertainment | Fusion radio, Outdoor speakers, USB |
| Galley | Freezer, Hot water, Kitchen utensils (Galley equipment, cutlery), Oven, Refrigerator, Stove |
| Interior | Electric fans, Electric toilet, Inside shower |
| Navigation | Autopilot, Compass, GPS, GPS chart plotter, GPS chart plotter - cockpit, Logge/Lot/Speed, Nautical charts, Navigation set, Wind instrument/Anemometer |
| Safety | Black Water Tank, Fire extinguisher, First aid kit, Flashlight, Safety equipment, Set of tools, VHF radio |
| Sails | Electric winch, Lazy bag, Lazy jacks |
| Yacht electrics | Solar panels |



WEBSITE

www.plujeme.cz



PHONE

+420 720 755 085



MOBILE

+420 777 170 276



E-MAIL

info@plujeme.cz



PLUJEME RÁDI S.R.O.

Dlouhá 730/35, 11000 Praha 1 – Staré Město, Czech Republic

SERVICES

| SELECTED SERVICES | OBLIGATORY | PAYMENT TYPE | PRICE |
|--|------------|--------------|-----------------|
| Damage waiver (Payable at the base) Season: 2026. + Refundable Security Deposit: 1000,00eur About your Damage Waiver: If you're sailing with us for more than a week, the extra waiver cost for each additional week is 50% of the standard rate. The damage waiver is excluded from racing activities. Therefore, the full security deposit is required for these bookings. For Skipped charters the Damage waiver is 350,00eur If the yacht is returned in perfect condition, we'll give you a reward credit voucher for your next charter! - Reward Bonus: 150,00eur - This is just for you (non-transferable). - It's valid until the end of the year (31/12) and can be used for a trip this year or the next. | Yes | per booking | 380,00 € |
| Service Pack (Payable at the base) Season: 2026. end-cleaning, water / 1x cooking gaz bottle at the departure, batteries | Yes | per booking | 290,00 € |
| Early Check in (Payable at the base) Season: 2026. Embarkation at 13:00h option is subject to the condition that the yacht returns without damages from the previous charter | No | per booking | 300,00 € |
| Harbour and marine fee (Payable at the base) Season: 2026. for the first and the last charter-night | No | per booking | 0,00 € |
| Late Check in (Payable at the base) Season: 2026. *France: Departure any day of the week except Sunday € 325 surcharge for every embarkation after 17h or outside the working hours or the working day | No | per booking | 350,00 € |
| Welcome package (Payable at the base) Season: 2026. washing up liquid, sponge, rubbish bags, matches, toilet & kitchen rolls, fruit plate, water, orange juice, wine, packet of biscuits, individual sachets of tea, coffee, sugar, milk | No | per booking | 60,00 € |



WEBSITE

www.plujeme.cz



PHONE

+420 720 755 085



MOBILE

+420 777 170 276



E-MAIL

info@plujeme.cz



PLUJEME RÁDI S.R.O.

Dlouhá 730/35, 11000 Praha 1 – Staré Město, Czech Republic

ADDITIONAL EXTRAS

| EXTRA | OBLIGATORY | PAYMENT TYPE | PRICE |
|--|------------|--------------|-----------------|
| Bed linen (Payable at the base) Season: 2026. Includes 1 large towel, 2 sheets, and 1 pillowcase. Bed linen can be provided upon request and at an additional cost. - Payable at the base | No | per person | 12,00 € |
| Outboard engine (Payable at the base) Season: 2026. An additional deposit of € 850 is required if the client pays for a non-refundable deposit for their charter AND rents an Outboard. - Payable at the base | No | per week | 100,00 € |
| Railing net (Safety net) (Payable at the base) Season: 2026. Payable at the base | No | per booking | 250,00 € |

**WEBSITE**www.plujeme.cz**E-MAIL**info@plujeme.cz**PHONE**

+420 720 755 085

**MOBILE**

+420 777 170 276

**PLUJEME RÁDI S.R.O.**

Dlouhá 730/35, 11000 Praha 1 – Staré Město, Czech Republic

PRICE AND AVAILABILITY

| | | | |
|---|---|---|---|
| 25.04. - 02.05.2026 2.803 € 3.737 € | 02.05. - 09.05.2026 2.803 € 3.737 € | 09.05. - 16.05.2026 ON OPTION | 16.05. - 23.05.2026 NOT AVAILABLE |
| 23.05. - 30.05.2026 NOT AVAILABLE | 30.05. - 06.06.2026 4.570 € 6.093 € | 06.06. - 13.06.2026 4.570 € 6.093 € | 13.06. - 20.06.2026 4.570 € 6.093 € |
| 20.06. - 27.06.2026 5.118 € 6.824 € | 27.06. - 04.07.2026 5.118 € 6.824 € | 04.07. - 11.07.2026 5.118 € 6.824 € | 15.07. - 22.07.2026 NOT AVAILABLE |
| 25.07. - 01.08.2026 NOT AVAILABLE | 01.08. - 08.08.2026 NOT AVAILABLE | 08.08. - 15.08.2026 NOT AVAILABLE | 15.08. - 22.08.2026 NOT AVAILABLE |
| 22.08. - 05.09.2026 NOT AVAILABLE | 05.09. - 12.09.2026 NOT AVAILABLE | 12.09. - 19.09.2026 4.717 € 5.241 € | 19.09. - 26.09.2026 4.717 € 5.241 € |
| 26.09. - 03.10.2026 NOT AVAILABLE | 03.10. - 10.10.2026 3.363 € 3.737 € | 10.10. - 17.10.2026 3.363 € 3.737 € | 17.10. - 24.10.2026 3.363 € 3.737 € |
| 24.10. - 31.10.2026 3.363 € 3.737 € | 31.10. - 07.11.2026 3.176 € 3.737 € | 07.11. - 14.11.2026 3.176 € 3.737 € | 14.11. - 21.11.2026 3.176 € 3.737 € |
| 21.11. - 28.11.2026 3.176 € 3.737 € | 30.11. - 30.12.2026 NOT AVAILABLE | | |



WEBSITE

www.plujeme.cz



E-MAIL

info@plujeme.cz



PHONE

+420 720 755 085



MOBILE

+420 777 170 276



PLUJEME RÁDI S.R.O.

Dlouhá 730/35, 11000 Praha 1 – Staré Město, Czech Republic