

# BALI 4.2

Nedo (2024)

Catamaran Bali 4.2 Nedo, built in 2024 is anchored in the Trogir, Yachtclub Seget (Marina Baotić), Split region, Croatia . It has 4 + 1 cabins, can accommodate 8 + 1 + 1 people and has 4 + 1 toilets. Bed linen and kitchen equipment are included in the price.

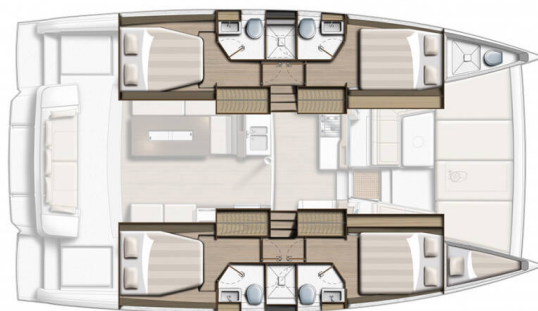

## YACHT SPECIFICATIONS

Yacht Base

**Trogir, Yachtclub Seget (Marina Baotić), Croatia**

Yacht ID

**6528**

Brands

**Catana**

Yacht name

**Nedo**

Production year

**2024**

Length

**42 ft**

Cabins

**4 + 1**

Berths

**8 + 1 + 1**

Max Persons

**10**

WC

**4 + 1**

Engine

**2 x 45 HP**

Fuel tank

**640 l**



**WEBSITE**

[www.plujeme.cz](http://www.plujeme.cz)



**PHONE**

+420 720 755 085



**MOBILE**

+420 777 170 276



**E-MAIL**

[info@plujeme.cz](mailto:info@plujeme.cz)



**PLUJEME RÁDI S.R.O.**

Dlouhá 730/35, 11000 Praha 1 – Staré Město, Czech Republic

## STANDARD YACHT EQUIPMENT

Comfort	<b>Blankets, Cockpit cushions, Cockpit seat cushions with backrest, Salon cushions, Sundeck cushions, Towels</b>
Deck	<b>Bimini top, Black ball, Boat hook, Chain counter on helm station, Cockpit/stern, outside shower, Davit, Deck brush, Dinghy with outboard engine, Fenders, Jerry cans for fuel, Swimming ladder, Teak cockpit</b>
Entertainment	<b>LED submarine lights, Radio</b>
Galley	<b>Freezer, Mug, Oven</b>
Interior	<b>Electric fans in cabins, Electric toilet, Salon table</b>
Navigation	<b>Autopilot, Binoculars, Compass, GPS chart plotter, Parallel ruler, Windex</b>
Safety	<b>Buoyant smoke signal, Extra fuel tank, Extra water tank, Fire axe, Fire blanket, Fire extinguisher, First aid kit, Fog horn, Horseshoe lifebuoy, Life jacket (children), Life jackets, Liferaft, Set of tools, Signaling mirror, VHF radio</b>
Sails	<b>Electric winch, Sails, Self tacking jib</b>
Yacht electrics	<b>Air Conditioning, Battery charger, Generator, Heating, Inverter, Service batteries, USB sockets</b>



**WEBSITE**

[www.plujeme.cz](http://www.plujeme.cz)



**PHONE**

+420 720 755 085



**MOBILE**

+420 777 170 276



**E-MAIL**

[info@plujeme.cz](mailto:info@plujeme.cz)



**PLUJEME RÁDI S.R.O.**

Dlouhá 730/35, 11000 Praha 1 – Staré Město, Czech Republic

## SERVICES

SELECTED SERVICES	OBLIGATORY	PAYMENT TYPE	PRICE
<b>Handling fees</b> (Payable now) <b>Season: 2026 New.</b>	Yes	per booking	<b>20,00 €</b>
<b>Preparation fee</b> (Payable now) <b>Season: 2026 New.</b> INCLUDED: Welcome pack // final cleaning // 1 set of bed sheets / cabin & 1 set of towels / pax, dinghy, outboard engine & initial supply of fuel, gas and water tanks // 1st & last night in the marina // NOT INCLUDED: refuelling, gas & water consumption at end of charter, taxes if any, handling fees & additional equipment deposit.	Yes	per booking	<b>355,00 €</b>
<b>Tourist tax</b> (Payable at the base) <b>Season: 2026 New.</b>	Yes	per guest/day	<b>1,33 €</b>
<b>Adrenalin pack</b> (Payable now) <b>Season: 2026 New.</b> * upon request - + 300 EUR deposit - includes 2 donuts, 1 wake board, 1 pair of water skis, bigger rib (4,70m) with outboard engine 50 HP in Trogir and 40 HP in Dubrovnik. **Important note: The bigger rib is to be towed and can not be used in Italian water territories! Surcharge for a skipper if clients book an adrenalin pack - 200 EURO ***CANNOT BE USED ON ONE-WAY CHARTERS***	No	per booking	<b>1.050,00 €</b>
<b>Cook</b> (Payable now) <b>Season: 2026 New.</b> +provisioning ; Crew on board must have their own toilets/ showers. If either a skipper or a hostess/cook is on board, 1 double cabin will be required for him/her. If both a skipper and a hostess/cook are on board, 1 double cabin and 1 forepeak cabin will be required for them. Exceptions exists for specific layouts, Sales Agents will provide more details about the different boat models. Cooking breakfast, lunch, 5 dinners a week, supply, keeping the kitchen clean (not the rest of the boat, not the cabins).	No	per week + food	<b>1.890,00 €</b>
<b>Crew change</b> (Payable now) <b>Season: 2026 New.</b> Any crew change during the charter is subject to € 250.- additional cost. The charge includes administration cost, change of bed linen and towels and one night at NY ponton (marina fee included only if the same base than start base). It doesn't include cleaning, nor new transit log where applicable.	No	per booking	<b>250,00 €</b>

<b>Crew surcharge early check in</b> (Payable now)	No	per booking	<b>125,00 €</b>
<b>Season: 2026 New.</b> VIP crew surcharge 125€ per crew member. *** (ONLY APPLIED WHEN VIP PACK AND A CREW MEMBER ARE BOOKED)***			
<b>Damage waiver</b> (Payable now)	No	per night	<b>50,00 €</b>
<b>Season: 2026 New.</b> Damage waiver limits your liability to the reduced Security Deposit . Mandatory when skipper is added. Price is per night of the charter ( minimum value of 7 nights & a maximum value of 21 nights). Not applicable for 4+ weeks charters , nor Regattas/Races.			
<b>Extra cleaning</b> (Payable now)	No	per booking	<b>310,00 €</b>
<b>Season: 2026 New.</b> Optional Additional cleaning			
<b>Extra set of linen (choose how many)</b> (Payable now)	No	per booking	<b>15,00 €</b>
<b>Season: 2026 New.</b> Extra set of linen : 15 € 1 set of linen (2 sheets & 2 pillow case) - to be updated manually			
<b>Extra set of towels (choose how many)</b> (Payable now)	No	per booking	<b>10,00 €</b>
<b>Season: 2026 New.</b> Extra set of towels: 10 € 1 set of towels (1 face & 1 bath towel) - to be updated manually			
<b>Full board 1-4 pax (number of guests to update manually)</b> (Payable now)	No	per guest/day	<b>60,00 €</b>
<b>Season: 2026 New.</b> only available if cook is booked on board as the cook will do the provisioning based on client's preference. Includes breakfast, lunch & dinner + the crew's food. Does not included alcoholic drinks			
<b>Full board 5-12 pax (number of guests to update manually)</b> (Payable now)	No	per guest/day	<b>55,00 €</b>
<b>Season: 2026 New.</b> only available if cook is booked on board as the cook will do the provisioning based on client's preference. Includes breakfast, lunch & dinner + the crew's food. Does not included alcoholic drinks			
<b>Gritchen cancellation insurance</b> (Payable now)	No	per booking	<b>0,00 €</b>
<b>Season: 2026 New.</b> with Covid coverage (4% of client's Total price)- European clients Only			
<b>Half board 1-4 pax (number of guests to update manually)</b> (Payable now)	No	per guest/day	<b>50,00 €</b>
<b>Season: 2026 New.</b> only available if cook is booked on board as the cook will do the provisioning based on client's preference. Includes breakfast & lunch OR dinner + the crew's food. Does not included alcoholic drinks			
<b>Half board 5-12 pax (number of guests to update manually)</b> (Payable now)	No	per guest/day	<b>45,00 €</b>
<b>Season: 2026 New.</b> only available if cook is booked on board as the cook will do the provisioning based on client's preference. Includes breakfast & lunch OR dinner + the crew's food. Does not included alcoholic drinks			

<p><b>Hostess</b> (Payable now)</p> <p><b>Season: 2026 New.</b> +provisioning ; Crew on board must have their own toilets/ showers. If either a skipper or a hostess/cook is on board, 1 double cabin will be required for him/her. If both a skipper and a hostess/cook are on board, 1 double cabin and 1 forepeak cabin will be required for them. Exceptions exists for specific layouts, Sales Agents will provide more details about the different boat models. Breakfast, light lunch, keeping the boat and toilet clean.</p>	No	per week + food	<b>1.330,00 €</b>
<p><b>Hostess</b> (Payable now)</p> <p><b>Season: 2026 New.</b> +provisioning ; Crew on board must have their own toilets/ showers. If either a skipper or a hostess/cook is on board, 1 double cabin will be required for him/her. If both a skipper and a hostess/cook are on board, 1 double cabin and 1 forepeak cabin will be required for them. Exceptions exists for specific layouts, Sales Agents will provide more details about the different boat models. Breakfast, light lunch, keeping the boat and toilet clean.</p>	No	per week + food	<b>1.330,00 €</b>
<p><b>Hostess</b> (Payable now)</p> <p><b>Season: 2026 New.</b> +provisioning ; Crew on board must have their own toilets/ showers. If either a skipper or a hostess/cook is on board, 1 double cabin will be required for him/her. If both a skipper and a hostess/cook are on board, 1 double cabin and 1 forepeak cabin will be required for them. Exceptions exists for specific layouts, Sales Agents will provide more details about the different boat models. Breakfast, light lunch, keeping the boat and toilet clean.</p>	No	per week + food	<b>1.465,00 €</b>
<p><b>Parking</b> (Payable now)</p> <p><b>Season: 2026 New.</b> Navigare parking Special slots within the Baotic Marina, only for Navigare clients. Price is per week, per vehicle. UPON REQUEST, LIMITED NUMBER</p>	No	per day	<b>10,00 €</b>
<p><b>Sailing Instructor</b> (Payable now)</p> <p><b>Season: 2026 New.</b> Sailing Instructor: price per week - food (Skippering with the basic school of sailing and manoevring)</p>	No	per week + food	<b>1.960,00 €</b>
<p><b>Skipper</b> (Payable now)</p> <p><b>Season: 2026 New.</b> +provisioning ; Crew on board must have their own toilets/ showers. If either a skipper or a hostess/cook is on board, 1 double cabin will be required for him/her. If both a skipper and a hostess/cook are on board, 1 double cabin and 1 forepeak cabin will be required for them. Exceptions exists for specific layouts, Sales Agents will provide more details about the different boat models. ***NOTE: Skipper details will be available 3 days before the charter.</p>	No	per week	<b>1.575,00 €</b>

<b>Skipper</b> (Payable now)	No	per week	<b>1.575,00 €</b>
<b>Season: 2026 New.</b> +provisioning ; Crew on board must have their own toilets/ showers. If either a skipper or a hostess/cook is on board, 1 double cabin will be required for him/her. If both a skipper and a hostess/cook are on board, 1 double cabin and 1 forepeak cabin will be required for them. Exceptions exists for specific layouts, Sales Agents will provide more details about the different boat models. ***NOTE: Skipper details will be available 3 days before the charter.			
<b>Skipper</b> (Payable now)	No	per week	<b>1.730,00 €</b>
<b>Season: 2026 New.</b> +provisioning ; Crew on board must have their own toilets/ showers. If either a skipper or a hostess/cook is on board, 1 double cabin will be required for him/her. If both a skipper and a hostess/cook are on board, 1 double cabin and 1 forepeak cabin will be required for them. Exceptions exists for specific layouts, Sales Agents will provide more details about the different boat models. ***NOTE: Skipper details will be available 3 days before the charter.			
<b>Transfer</b> (Payable now)	No	one-way	<b>65,00 €</b>
<b>Season: 2026 New.</b> OW - Split Airport - Marina Baotic / Up to 3 persons			
<b>Transfer</b> (Payable now)	No	one-way	<b>75,00 €</b>
<b>Season: 2026 New.</b> OW - Split, town - Marina Baotic Up to 3 persons			
<b>Transfer</b> (Payable now)	No	one-way	<b>75,00 €</b>
<b>Season: 2026 New.</b> OW - Split Airport - Marina Baotic Up to 8 persons			
<b>Transfer</b> (Payable now)	No	one-way	<b>80,00 €</b>
<b>Season: 2026 New.</b> OW - Split, town - Marina Baotic Up to 8 persons			
<b>Transfer</b> (Payable now)	No	one-way	<b>330,00 €</b>
<b>Season: 2026 New.</b> OW - Zadar, town - Marina Baotic Up to 3 persons			
<b>Transfer</b> (Payable now)	No	one-way	<b>350,00 €</b>
<b>Season: 2026 New.</b> OW - Zadar, town - Marina Baotic Up to 8 persons			
<b>Transfer</b> (Payable now)	No	one-way	<b>495,00 €</b>
<b>Season: 2026 New.</b> OW - Dubrovnik, town - Marina Baotic Up to 3 persons			
<b>Transfer</b> (Payable now)	No	one-way	<b>550,00 €</b>
<b>Season: 2026 New.</b> OW - Dubrovnik, town - Marina Baotic Up to 8 persons			
<b>VIP Pack</b> (Payable now)	No	per booking	<b>450,00 €</b>
<b>Season: 2026 New.</b> VIP PACK Catamaran (fast track service on arrival and access to the yacht at 13.00 pm + a luxurious drink welcome pack)			

**WI-FI Internet connection on boat** (Payable now)

No

per week

**32,00 €**

**Season: 2026 New.**



**WEBSITE**

[www.plujeme.cz](http://www.plujeme.cz)



**E-MAIL**

[info@plujeme.cz](mailto:info@plujeme.cz)



**PHONE**

+420 720 755 085



**MOBILE**

+420 777 170 276



**PLUJEME RÁDI S.R.O.**

Dlouhá 730/35, 11000 Praha 1 – Staré Město, Czech Republic

## ADDITIONAL EXTRAS

EXTRA	OBLIGATORY	PAYMENT TYPE	PRICE
<b>Donut</b> (Payable now) <b>Season: 2026 New.</b> includes 1 donut - Payable now	No	per week	<b>65,00 €</b>
<b>Extra bedlinen and towels</b> (Payable now) <b>Season: 2026 New.</b> Payable now	No	per person	<b>15,00 €</b>
<b>Inflatable lifejacket</b> (Payable now) <b>Season: 2026 New.</b> Inflatable life vests and Jackstay - Payable now	No	per booking	<b>65,00 €</b>
<b>Kayak</b> (Payable now) <b>Season: 2026 New.</b> Payable now	No	per booking	<b>285,00 €</b>
<b>Railing net (Safety net)</b> (Payable now) <b>Season: 2026 New.</b> Railing net - mounting not included. Clients must mount the railing net (safety net) by themselves - Payable now	No	per booking	<b>110,00 €</b>
<b>Stand up paddle (SUP)</b> (Payable now) <b>Season: 2026 New.</b> Price per day - Payable now	No	per night	<b>15,00 €</b>



**WEBSITE**

[www.plujeme.cz](http://www.plujeme.cz)



**E-MAIL**

[info@plujeme.cz](mailto:info@plujeme.cz)



**PHONE**

+420 720 755 085



**MOBILE**

+420 777 170 276



**PLUJEME RÁDI S.R.O.**

Dlouhá 730/35, 11000 Praha 1 – Staré Město, Czech Republic

## PRICE AND AVAILABILITY

<b>25.04. - 02.05.2026</b> ON OPTION	<b>02.05. - 09.05.2026</b> NOT AVAILABLE	<b>09.05. - 16.05.2026</b> NOT AVAILABLE	<b>16.05. - 23.05.2026</b> NOT AVAILABLE
<b>23.05. - 30.05.2026</b> NOT AVAILABLE	<b>30.05. - 06.06.2026</b> NOT AVAILABLE	<b>06.06. - 13.06.2026</b> NOT AVAILABLE	<b>13.06. - 20.06.2026</b> NOT AVAILABLE
<b>20.06. - 27.06.2026</b> NOT AVAILABLE	<b>27.06. - 04.07.2026</b> NOT AVAILABLE	<b>04.07. - 11.07.2026</b> NOT AVAILABLE	<b>11.07. - 18.07.2026</b> NOT AVAILABLE
<b>18.07. - 25.07.2026</b> <b>7.904 €</b> 9.880 €	<b>25.07. - 01.08.2026</b> NOT AVAILABLE	<b>01.08. - 08.08.2026</b> <b>8.584 €</b> 10.730 €	<b>08.08. - 15.08.2026</b> NOT AVAILABLE
<b>15.08. - 22.08.2026</b> <b>8.606 €</b> 10.125 €	<b>22.08. - 29.08.2026</b> <b>7.251 €</b> 8.530 €	<b>29.08. - 05.09.2026</b> <b>6.877 €</b> 8.090 €	<b>05.09. - 12.09.2026</b> NOT AVAILABLE
<b>12.09. - 19.09.2026</b> NOT AVAILABLE	<b>19.09. - 26.09.2026</b> <b>7.085 €</b>	<b>26.09. - 03.10.2026</b> <b>5.580 €</b>	<b>03.10. - 10.10.2026</b> <b>3.475 €</b>
<b>10.10. - 17.10.2026</b> <b>2.780 €</b>	<b>17.10. - 24.10.2026</b> <b>2.215 €</b>	<b>24.10. - 31.10.2026</b> <b>2.043 €</b> 2.150 €	<b>31.10. - 07.11.2026</b> <b>2.047 €</b> 2.155 €
<b>07.11. - 14.11.2026</b> <b>2.047 €</b> 2.155 €	<b>20.11. - 12.03.2027</b> NOT AVAILABLE		



WEBSITE

[www.plujeme.cz](http://www.plujeme.cz)



E-MAIL

[info@plujeme.cz](mailto:info@plujeme.cz)



PHONE

+420 720 755 085



MOBILE

+420 777 170 276



PLUJEME RÁDI S.R.O.

Dlouhá 730/35, 11000 Praha 1 – Staré Město, Czech Republic

## PRICE AND AVAILABILITY

13.03. - 20.03.2027 <b>1.986 €</b> 2.090 €	20.03. - 27.03.2027 <b>1.986 €</b> 2.090 €	27.03. - 03.04.2027 <b>2.275 €</b> 2.395 €	03.04. - 10.04.2027 <b>2.275 €</b> 2.395 €
10.04. - 17.04.2027 <b>2.499 €</b> 2.630 €	17.04. - 24.04.2027 <b>2.499 €</b> 2.630 €	24.04. - 01.05.2027 <b>3.045 €</b> 3.205 €	01.05. - 08.05.2027 <b>3.045 €</b> 3.205 €
08.05. - 15.05.2027 <b>3.344 €</b> 3.520 €	15.05. - 22.05.2027 <b>4.698 €</b> 4.945 €	22.05. - 29.05.2027 <b>6.299 €</b> 6.630 €	29.05. - 05.06.2027 <b>7.876 €</b> 8.290 €
05.06. - 12.06.2027 <b>8.693 €</b> 9.150 €	12.06. - 19.06.2027 <b>9.609 €</b> 10.115 €	19.06. - 26.06.2027 <b>9.899 €</b> 10.420 €	26.06. - 03.07.2027 <b>10.593 €</b> 11.150 €
03.07. - 10.07.2027 <b>11.357 €</b> 11.955 €	10.07. - 17.07.2027 <b>12.198 €</b> 12.840 €	17.07. - 24.07.2027 <b>12.198 €</b> 12.840 €	24.07. - 31.07.2027 <b>12.198 €</b> 12.840 €
31.07. - 07.08.2027 <b>13.191 €</b> 13.885 €			



**WEBSITE**  
[www.plujeme.cz](http://www.plujeme.cz)



**E-MAIL**  
[info@plujeme.cz](mailto:info@plujeme.cz)



**PHONE**  
+420 720 755 085



**PLUJEME RÁDI S.R.O.**  
Dlouhá 730/35, 11000 Praha 1 – Staré Město, Czech Republic



**MOBILE**  
+420 777 170 276

## PRICE AND AVAILABILITY

07.08. - 14.08.2027 <b>13.191 €</b> 13.885 €	14.08. - 21.08.2027 <b>12.198 €</b> 12.840 €	21.08. - 28.08.2027 <b>8.574 €</b> 9.025 €	28.08. - 04.09.2027 <b>8.151 €</b> 8.580 €
04.09. - 11.09.2027 <b>8.536 €</b> 8.985 €	11.09. - 18.09.2027 <b>8.070 €</b> 8.495 €	18.09. - 25.09.2027 <b>7.477 €</b> 7.870 €	25.09. - 02.10.2027 <b>5.890 €</b> 6.200 €
02.10. - 09.10.2027 <b>3.392 €</b> 3.570 €	09.10. - 16.10.2027 <b>2.765 €</b> 2.910 €	16.10. - 23.10.2027 <b>2.313 €</b> 2.435 €	23.10. - 30.10.2027 <b>2.147 €</b> 2.260 €
30.10. - 06.11.2027 <b>2.047 €</b> 2.155 €	06.11. - 13.11.2027 <b>2.047 €</b> 2.155 €	13.11. - 20.11.2027 <b>2.047 €</b> 2.155 €	20.11. - 27.11.2027 <b>2.047 €</b> 2.155 €
27.11. - 04.12.2027 <b>2.047 €</b> 2.155 €	04.12. - 11.12.2027 <b>2.047 €</b> 2.155 €	11.12. - 18.12.2027 <b>2.047 €</b> 2.155 €	18.12. - 25.12.2027 <b>2.047 €</b> 2.155 €



### WEBSITE

[www.plujeme.cz](http://www.plujeme.cz)



### E-MAIL

[info@plujeme.cz](mailto:info@plujeme.cz)



### PHONE

+420 720 755 085



### MOBILE

+420 777 170 276



### PLUJEME RÁDI S.R.O.

Dlouhá 730/35, 11000 Praha 1 – Staré Město, Czech Republic