

# NAUTITECH 46

Aureliano (2017)

Catamaran **Nautitech 46 Aureliano**, built in **2017** is anchored in the **Athens, Alimos marina, Athens area/Saronic/Peloponese, Greece**. It has **4 + 2 cabins**, can accommodate **8 + 2 people** and has **4 + 1 toilets**. Bed linen and kitchen equipment are included in the price.

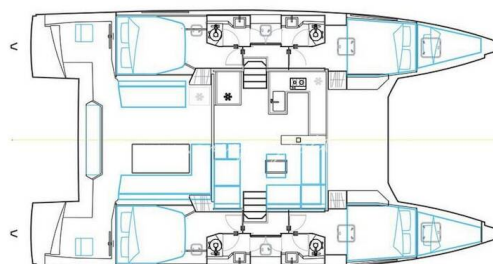

## YACHT SPECIFICATIONS

Yacht Base

**Athens, Alimos marina, Greece**

Yacht ID

**6518**

Brands

**Nautitech**

Yacht name

**Aureliano**

Production year

**2017**

Length

**45 ft**

Cabins

**4 + 2**

Berths

**8 + 2**

WC

**4 + 1**

Engine

**2 x 40 HP**

Fuel tank

**600 l**



**WEBSITE**

[www.plujeme.cz](http://www.plujeme.cz)



**PHONE**

+420 720 755 085



**MOBILE**

+420 777 170 276



**E-MAIL**

[info@plujeme.cz](mailto:info@plujeme.cz)



**PLUJEME RÁDI S.R.O.**

Dlouhá 730/35, 11000 Praha 1 – Staré Město, Czech Republic

## STANDARD YACHT EQUIPMENT

|                 |  |
|-----------------|--|
| Comfort         | <b>Bed linen, Blankets, Cockpit cushions, Sundeck beds, Towels</b>   |
| Deck            | <b>Bathing platform, Bimini top, Bosun's chair (Safe seat) (boatswain's chair), Cockpit table, Cockpit/stern, outside shower, Dinghy, Electric anchor windlass, Flybridge, Gangway, Spare anchor (Reserve, Auxiliary anchor), Sprayhood, Swimming ladder</b> |
| Entertainment   | <b>Mask, Outdoor speakers, Radio CD player, TV</b>   |
| Galley          | <b>Coffee machine, Kitchen utensils (Galley equipment, cutlery), Oven, Refrigerator, Stove</b>   |
| Interior        | <b>Electric fans in cabins, Electric toilet</b>  |
| Navigation      | <b>Autopilot, Binoculars, Compass, Depthsounder, GPS chart plotter - cockpit, Navigation (Nautical) charts and nautical guide, Pilot book, Speedometer (Speed log), Wind instrument/Anemometer</b>   |
| Safety          | <b>Distress flare box, EPIRB-Distress radio beacons, Fire extinguisher, First aid kit, Floating light, Horseshoe lifebuoy, Life belts (Safety harness), Life jackets, Liferaft, Repair kit, Set of tools, VHF radio</b>                                      |
| Sails           | <b>Electric winch</b>  |
| Yacht electrics | <b>Air Conditioning, Batteries, Generator, Heating, Inverter, Plug 220V, 12 V, Shore connection 220 V, Solar panels, USB sockets, Watermaker - desalinator</b>   |



**WEBSITE**  
[www.plujeme.cz](http://www.plujeme.cz)



**PHONE**  
+420 720 755 085



**MOBILE**  
+420 777 170 276



**E-MAIL**  
[info@plujeme.cz](mailto:info@plujeme.cz)



**PLUJEME RÁDI S.R.O.**  
Dlouhá 730/35, 11000 Praha 1 – Staré Město, Czech Republic

## SERVICES

| SELECTED SERVICES  | OBLIGATORY | PAYMENT TYPE    | PRICE             |
|--|------------|-----------------|-------------------|
| <b>Final cleaning</b> (Payable at the base)<br><b>Season: 2026.</b>                                  | Yes        | per booking     | <b>350,00 €</b>   |
| <b>Crew change</b> (Payable at the base)<br><b>Season: 2026.</b> Upon agreement and only in our base | No         | per crew change | <b>150,00 €</b>   |
| <b>Damage waiver</b> (Payable at the base)<br><b>Season: 2026.</b> + 1000 € (refundable)             | No         | per booking     | <b>550,00 €</b>   |
| <b>Early Check in</b> (Payable at the base)<br><b>Season: 2026.</b> at 14:00                         | No         | per booking     | <b>150,00 €</b>   |
| <b>Hostess</b> (Payable at the base)<br><b>Season: 2026.</b>   | No         | per day + food  | <b>190,00 €</b>   |
| <b>Skipper</b> (Payable at the base)<br><b>Season: 2026.</b> insurance obligatory                    | No         | per week + food | <b>1.470,00 €</b> |
| <b>WI-FI Internet connection on boat</b> (Payable at the base)<br><b>Season: 2026.</b>               | No         | per week        | <b>70,00 €</b>    |



**WEBSITE**

[www.plujeme.cz](http://www.plujeme.cz)



**E-MAIL**

[info@plujeme.cz](mailto:info@plujeme.cz)



**PHONE**

+420 720 755 085



**MOBILE**

+420 777 170 276



**PLUJEME RÁDI S.R.O.**

Dlouhá 730/35, 11000 Praha 1 – Staré Město, Czech Republic

## ADDITIONAL EXTRAS

| EXTRA   | OBLIGATORY | PAYMENT TYPE | PRICE           |
|---|------------|--------------|-----------------|
| <b>Extra bedlinen and towels</b> (Payable at the base)<br><i>Season: 2026. Payable at the base</i>              | No         | per person   | <b>10,00 €</b>  |
| <b>Grill/Barbecue/Plancha</b> (Payable at the base)<br><i>Season: 2026. Payable at the base</i>                 | No         | per week     | <b>150,00 €</b> |
| <b>Outboard engine</b> (Payable at the base)<br><i>Season: 2026. Payable at the base</i>                        | No         | per week     | <b>80,00 €</b>  |
| <b>Railing net (Safety net)</b> (Payable at the base)<br><i>Season: 2026. Payable at the base</i>               | No         | per booking  | <b>250,00 €</b> |
| <b>Stand up paddle (SUP)</b> (Payable at the base)<br><i>Season: 2026. 2x SUP - 180 € - Payable at the base</i> | No         | per booking  | <b>100,00 €</b> |
| <b>Water toys</b> (Payable at the base)<br><i>Season: 2026. sport tubes - Payable at the base</i>               | No         | per week     | <b>40,00 €</b>  |



**WEBSITE**

[www.plujeme.cz](http://www.plujeme.cz)



**E-MAIL**

[info@plujeme.cz](mailto:info@plujeme.cz)



**PHONE**

+420 720 755 085



**MOBILE**

+420 777 170 276



**PLUJEME RÁDI S.R.O.**

Dlouhá 730/35, 11000 Praha 1 – Staré Město, Czech Republic

## PRICE AND AVAILABILITY

|   |   |   |   |
|---|---|---|---|
| 25.04. - 02.05.2026<br><b>3.380 €</b> 5.200 € | 02.05. - 09.05.2026<br><b>3.536 €</b> 5.200 € | 09.05. - 16.05.2026<br><b>3.536 €</b> 5.200 € | 16.05. - 23.05.2026<br>NOT AVAILABLE          |
| 23.05. - 30.05.2026<br><b>4.807 €</b> 7.175 € | 30.05. - 06.06.2026<br>NOT AVAILABLE          | 06.06. - 13.06.2026<br>NOT AVAILABLE          | 13.06. - 11.07.2026<br>NOT AVAILABLE          |
| 11.07. - 18.07.2026<br><b>6.680 €</b> 8.350 € | 18.07. - 25.07.2026<br><b>6.847 €</b> 8.350 € | 25.07. - 01.08.2026<br><b>7.238 €</b> 9.400 € | 01.08. - 08.08.2026<br>NOT AVAILABLE          |
| 08.08. - 15.08.2026<br>NOT AVAILABLE          | 15.08. - 22.08.2026<br>NOT AVAILABLE          | 22.08. - 29.08.2026<br>NOT AVAILABLE          | 29.08. - 05.09.2026<br><b>6.945 €</b> 8.470 € |
| 05.09. - 12.09.2026<br><b>7.030 €</b> 8.470 € | 12.09. - 19.09.2026<br>NOT AVAILABLE          | 19.09. - 26.09.2026<br><b>5.812 €</b> 7.175 € | 26.09. - 03.10.2026<br>NOT AVAILABLE          |
| 03.10. - 10.10.2026<br>ON OPTION              | 10.10. - 24.10.2026<br>NOT AVAILABLE          | 24.10. - 31.10.2026<br><b>3.240 €</b> 4.000 € | 31.10. - 07.11.2026<br><b>3.400 €</b> 4.000 € |
| 07.11. - 14.11.2026<br><b>3.400 €</b> 4.000 € | 14.11. - 21.11.2026<br><b>3.400 €</b> 4.000 € | 21.11. - 28.11.2026<br><b>3.400 €</b> 4.000 € | 28.11. - 05.12.2026<br><b>3.400 €</b> 4.000 € |



WEBSITE

[www.plujeme.cz](http://www.plujeme.cz)



E-MAIL

[info@plujeme.cz](mailto:info@plujeme.cz)



PHONE

+420 720 755 085



MOBILE

+420 777 170 276



PLUJEME RÁDI S.R.O.

Dlouhá 730/35, 11000 Praha 1 – Staré Město, Czech Republic

## PRICE AND AVAILABILITY

05.12. - 12.12.2026

**3.400 €** 4.000 €

12.12. - 19.12.2026

**3.400 €** 4.000 €

19.12. - 26.12.2026

**3.400 €** 4.000 €



### WEBSITE

[www.plujeme.cz](http://www.plujeme.cz)



### E-MAIL

[info@plujeme.cz](mailto:info@plujeme.cz)



### PHONE

+420 720 755 085



### MOBILE

+420 777 170 276



### PLUJEME RÁDI S.R.O.

Dlouhá 730/35, 11000 Praha 1 – Staré Město, Czech Republic