

OCEANIS 46.1

Nagia (2020)

Sailing yacht **Oceanis 46.1 Nagia**, built in **2020** is anchored in the **Athens, Alimos marina, Athens area/Saronic/Peloponese, Greece**. It has **4 cabins**, can accommodate **8 + 2 people** and has **4 toilets**. Bed linen and kitchen equipment are included in the price.

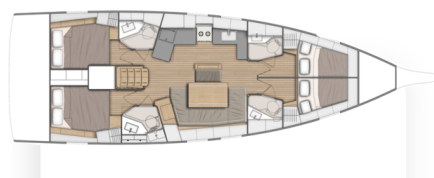

YACHT SPECIFICATIONS

Yacht Base

Athens, Alimos marina, Greece

Yacht ID

6452

Brands

Beneteau

Yacht name

Nagia

Production year

2020

Length

48 ft

Cabins

4

Berths

8 + 2

WC

4

Engine

1 x 54 HP

Fuel tank

375 l



WEBSITE

www.plujeme.cz



PHONE

+420 720 755 085



MOBILE

+420 777 170 276



E-MAIL

info@plujeme.cz



PLUJEME RÁDI S.R.O.

Dlouhá 730/35, 11000 Praha 1 – Staré Město, Czech Republic

STANDARD YACHT EQUIPMENT

Deck	Anchor, Bathing platform, Bimini top, Boat hook, Cockpit table, Cockpit/stern, outside shower, Dinghy, Electric anchor windlass, Gangway, Sprayhood, Swimming ladder, Water hose
Entertainment	Diving mask, Fins, Outdoor speakers, Radio
Galley	Gas bottles, Hot water, Kitchen utensils (Galley equipment, cutlery), Oven, Refrigerator
Interior	Barometer, Clock, Electric toilet
Navigation	Autopilot, Binoculars, Bow thruster, Cockpit control panel, Compass, Echosounder/Depthsounder, GPS chart plotter, Nautical charts, Navigation/position Lights, Wind/speed/depth instruments, Windex
Safety	Black Water Tank, Distress flare box, Emergency tiller, EPIRB-Distress radio beacons, First aid kit, Floating light, Horseshoe lifebuoy, Life belts (Safety harness), Life jackets, Liferaft, Set of tools, Torch, VHF radio
Yacht electrics	Battery charger, Bilge pump - Electric, Plug 220V, 12 V, Shore connection 220 V, Solar panels, USB sockets



WEBSITE

www.plujeme.cz



E-MAIL

info@plujeme.cz



PHONE

+420 720 755 085



MOBILE

+420 777 170 276



PLUJEME RÁDI S.R.O.

Dlouhá 730/35, 11000 Praha 1 – Staré Město, Czech Republic

SERVICES

SELECTED SERVICES	OBLIGATORY	PAYMENT TYPE	PRICE
Final cleaning (Payable at the base) Season: 2026. Final cleaning doesn't include bed linen and towels.	Yes	per booking	220,00 €
Crew change (Payable at the base) Season: 2026. available only at our charter base, includes paperwork & formalities, 1 day berthing fee, water tank top-up. Yacht cleaning & laundry are not included - to pay at the base	No	per booking	150,00 €
Damage waiver (Payable at the base) Season: 2026. +1000 EUR refundable deposit (by bank transfer).	No	per booking	550,00 €
Early boarding/check-in (Payable at the base) Season: 2026.	No	per booking	150,00 €
Late check out (Payable at the base) Season: 2026.	No	per booking	150,00 €
Transfer (Payable at the base) Season: 2026. Airport - marina Alimos, 3 pax	No	one-way	80,00 €
Transfer (Payable at the base) Season: 2026. Transfer Airport - marina Alimos, 4 pax	No	one-way	120,00 €
Transfer (Payable at the base) Season: 2026. Airport - marina Alimos, 6 pax	No	one-way	140,00 €
Transfer (Payable at the base) Season: 2026. Airport - marina Alimos, 12 pax	No	one-way	240,00 €



WEBSITE

www.plujeme.cz



PHONE

+420 720 755 085



MOBILE

+420 777 170 276



E-MAIL

info@plujeme.cz



PLUJEME RÁDI S.R.O.

Dlouhá 730/35, 11000 Praha 1 – Staré Město, Czech Republic

ADDITIONAL EXTRAS

EXTRA	OBLIGATORY	PAYMENT TYPE	PRICE
Bed linen (Payable at the base) Season: 2026. Payable at the base	No	per set	20,00 €
Coffee machine (Payable at the base) Season: 2026. if available - Payable at the base	No	per week	30,00 €
Electric scooter (Payable at the base) Season: 2026. if available - Payable at the base	No	per week	80,00 €
Gennaker (Payable at the base) Season: 2026. if available - Payable at the base	No	per week	450,00 €
Outboard engine (Payable at the base) Season: 2026. Payable at the base	No	per week	80,00 €
Railing net (Safety net) (Payable at the base) Season: 2026. if available - Payable at the base	No	per week	160,00 €
Stand up paddle (SUP) (Payable at the base) Season: 2026. if available - Payable at the base	No	per week	150,00 €
Towels (Payable at the base) Season: 2026. Payable at the base	No	per set	5,00 €



WEBSITE
www.plujeme.cz



E-MAIL
info@plujeme.cz



PHONE
+420 720 755 085



PLUJEME RÁDI S.R.O.
Dlouhá 730/35, 11000 Praha 1 – Staré Město, Czech Republic



MOBILE
+420 777 170 276

PRICE AND AVAILABILITY

25.04. - 02.05.2026 NOT AVAILABLE	02.05. - 09.05.2026 NOT AVAILABLE	09.05. - 16.05.2026 1.820 €	16.05. - 23.05.2026 NOT AVAILABLE
23.05. - 30.05.2026 NOT AVAILABLE	30.05. - 06.06.2026 NOT AVAILABLE	06.06. - 13.06.2026 2.450 €	13.06. - 20.06.2026 NOT AVAILABLE
20.06. - 27.06.2026 NOT AVAILABLE	27.06. - 04.07.2026 ON OPTION	04.07. - 11.07.2026 ON OPTION	11.07. - 18.07.2026 3.150 €
18.07. - 25.07.2026 3.150 €	25.07. - 01.08.2026 3.150 €	01.08. - 08.08.2026 3.150 €	08.08. - 15.08.2026 3.150 €
15.08. - 22.08.2026 3.330 €	22.08. - 29.08.2026 3.400 €	29.08. - 05.09.2026 3.680 €	05.09. - 12.09.2026 3.680 €
12.09. - 19.09.2026 3.575 €	19.09. - 26.09.2026 NOT AVAILABLE	26.09. - 03.10.2026 NOT AVAILABLE	03.10. - 10.10.2026 2.816 €
10.10. - 17.10.2026 2.592 €	17.10. - 24.10.2026 2.176 €	24.10. - 31.10.2026 2.176 €	31.10. - 07.11.2026 2.176 €
07.11. - 14.11.2026 2.176 €	14.11. - 21.11.2026 2.176 €	21.11. - 28.11.2026 2.176 €	28.11. - 05.12.2026 2.176 €



WEBSITE
www.plujeme.cz



E-MAIL
info@plujeme.cz



PHONE
+420 720 755 085



PLUJEME RÁDI S.R.O.
Dlouhá 730/35, 11000 Praha 1 – Staré Město, Czech Republic



MOBILE
+420 777 170 276

PRICE AND AVAILABILITY

05.12. - 12.12.2026

2.176 €

12.12. - 19.12.2026

2.176 €

19.12. - 26.12.2026

2.176 €



WEBSITE

www.plujeme.cz



E-MAIL

info@plujeme.cz



PHONE

+420 720 755 085



MOBILE

+420 777 170 276



PLUJEME RÁDI S.R.O.

Dlouhá 730/35, 11000 Praha 1 – Staré Město, Czech Republic