

# BAVARIA CRUISER 46

Summer Breeze (2024)

Sailing yacht **Bavaria Cruiser 46 Summer Breeze**, built in **2024** is anchored in the **ACI Marina Split, Split region, Croatia**.

It has **3 + 1 cabins**, can accommodate **8 + 1 people** and has **3 toilets**. Bed linen and kitchen equipment are included in the price.

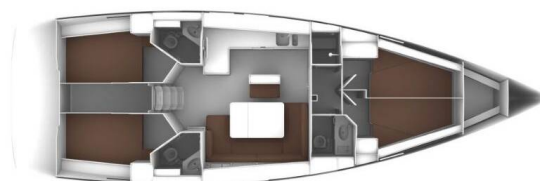

## YACHT SPECIFICATIONS

Yacht Base

**ACI Marina Split, Croatia**

Yacht ID

**6431**

Brands

**Bavaria**

Yacht name

**Summer Breeze**

Production year

**2024**

Length

**47 ft**

Cabins

**3 + 1**

Berths

**8 + 1**

WC

**3**

Engine

**1 x 51 HP**

Fuel tank

**210 l**



**WEBSITE**

[www.plujeme.cz](http://www.plujeme.cz)



**PHONE**

+420 720 755 085



**MOBILE**

+420 777 170 276



**E-MAIL**

[info@plujeme.cz](mailto:info@plujeme.cz)



**PLUJEME RÁDI S.R.O.**

Dlouhá 730/35, 11000 Praha 1 – Staré Město, Czech Republic

## STANDARD YACHT EQUIPMENT

Comfort	<b>Bed linen, Blankets, Cockpit cushions, Outside cushions, Pillows, Towels</b>
Deck	<b>Anchor Delta, Bathing platform, Bilge pump - Mechanic, Bimini top, Boat hook, Bosun's chair (Safe seat) (boatswain's chair), Cockpit table, Cockpit/stern, outside shower, Dinghy, Electric anchor windlass, Fenders, Gangway, Jerry cans for diesel, Mooring ropes, Plastic bucket, Spare anchor (Reserve, Auxiliary anchor), Sprayhood, Teak cockpit, Water hose, Winch handles</b>
Entertainment	<b>Indoor speakers, Outdoor speakers, Radio</b>
Galley	<b>Dishes, Gas cookers, Kitchen utensils (Galley equipment, cutlery), Oven, Refrigerator</b>
Interior	<b>Clock, Clothes hangers, Convertible from 4 into 3 cabins, Yacht documents</b>
Navigation	<b>Autopilot, Binoculars, Bow thruster, Compass, Divider, nautic chart, Echosounder/Depthsounder, GPS chart plotter - cockpit, Hand bearing compass, Log/speed instrument, Navigation (Nautical) charts and nautical guide, Navigation set, Pilot book, Radar reflector, Wind instrument/Anemometer</b>
Safety	<b>Distress flare box, Fire axe, Fire extinguisher, First aid kit, Fog horn, Life belts (Safety harness), Life jacket (children), Life jackets, Oars (Paddles), Repair kit, Search light, Set of tools, VHF radio</b>
Yacht electrics	<b>Air Conditioning, Batteries, Bilge pump - Electric, Converter 220V/12V, Inverter, Shore connection 220 V, Solar panels</b>



**WEBSITE**

[www.plujeme.cz](http://www.plujeme.cz)



**PHONE**

+420 720 755 085



**MOBILE**

+420 777 170 276



**E-MAIL**

[info@plujeme.cz](mailto:info@plujeme.cz)



**PLUJEME RÁDI S.R.O.**

Dlouhá 730/35, 11000 Praha 1 – Staré Město, Czech Republic

## SERVICES

SELECTED SERVICES	OBLIGATORY	PAYMENT TYPE	PRICE
<b>Charter package</b> (Payable at the base) <b>Season: 2026.</b> VAT 25%, final cleaning, bed linen, bath towels (2pp), 2 x gas bottles, dish wash, hand soap, 2 sponges, 1 kitchen paper, 2 kitchen clothes, 2 rolls of toilet paper per toilet, garbage bags, outboard engine with 5l fuel, 2 snorkel sets, diver's fee	Yes	per booking	<b>350,00 €</b>
<b>Early boarding/check-in</b> (Payable at the base) <b>Season: 2026.</b> By 1 PM ( limited; to be ordered in advance )	No	per booking	<b>150,00 €</b>
<b>Hostess</b> (Payable at the base) <b>Season: 2026.</b> Payable directly to the service provider. The hostess prepares 2 meals: breakfast and light lunch. On the request she can sometimes prepare a third meal at a price of 15 € / person for the service of preparing the third meal (crew included in the number of persons). Groceries for meals are paid by the guest	No	per week + food	<b>1.400,00 €</b>
<b>Non refundable deposit/ insurance</b> (Payable at the base) <b>Season: 2026.</b> +200€/week refundable *Needs to be ordered at least a week in advance	No	per week	<b>200,00 €</b>
<b>Parking</b> (Payable at the base) <b>Season: 2026.</b> per car, in ACI Split marina, cannot be reserved in advance	No	per week	<b>80,00 €</b>
<b>Skipper</b> (Payable at the base) <b>Season: 2026.</b> Payable directly to the service provider	No	per week + food	<b>1.540,00 €</b>
<b>WI-FI Internet connection on boat</b> (Payable at the base) <b>Season: 2026.</b> flat	No	per week	<b>5,00 €</b>



**WEBSITE**

[www.plujeme.cz](http://www.plujeme.cz)



**E-MAIL**

[info@plujeme.cz](mailto:info@plujeme.cz)



**PHONE**

+420 720 755 085



**MOBILE**

+420 777 170 276



**PLUJEME RÁDI S.R.O.**

Dlouhá 730/35, 11000 Praha 1 – Staré Město, Czech Republic

## ADDITIONAL EXTRAS

EXTRA	OBLIGATORY	PAYMENT TYPE	PRICE
<b>Automatic Inflatable Life Jacket</b> (Payable at the base) <i>Season: 2026. Payable at the base</i>	No	per booking	<b>25,00 €</b>
<b>Beach towel</b> (Payable at the base) <i>Season: 2026. *to be ordered in advance - Payable at the base</i>	No	per piece	<b>5,00 €</b>
<b>Extra bedlinen</b> (Payable at the base) <i>Season: 2026. Payable at the base</i>	No	per cabin	<b>5,00 €</b>
<b>Extra snorkeling equipment</b> (Payable at the base) <i>Season: 2026. two sets per boat are already included, set includes: mask + snorkel + adjustable flippers - Payable at the base</i>	No	per week	<b>15,00 €</b>
<b>Extra towels</b> (Payable at the base) <i>Season: 2026. 2 pcs - Payable at the base</i>	No	per booking	<b>5,00 €</b>
<b>Kayak tandem</b> (Payable at the base) <i>Season: 2026. Payable at the base</i>	No	per week	<b>150,00 €</b>
<b>Railing net (Safety net)</b> (Payable at the base) <i>Season: 2026. Payable at the base</i>	No	per booking	<b>100,00 €</b>
<b>Stand up paddle (SUP)</b> (Payable at the base) <i>Season: 2026. *to be ordered in advance - Payable at the base</i>	No	per week	<b>100,00 €</b>



WEBSITE

[www.plujeme.cz](http://www.plujeme.cz)



E-MAIL

[info@plujeme.cz](mailto:info@plujeme.cz)



PHONE

+420 720 755 085



MOBILE

+420 777 170 276



PLUJEME RÁDI S.R.O.

Dlouhá 730/35, 11000 Praha 1 – Staré Město, Czech Republic

## PRICE AND AVAILABILITY

30.04. - 02.05.2026 NOT AVAILABLE	02.05. - 09.05.2026 1.820 € 2.800 €	09.05. - 16.05.2026 1.820 € 2.800 €	16.05. - 23.05.2026 1.820 € 2.800 €
23.05. - 30.05.2026 2.405 € 3.700 €	30.05. - 13.06.2026 NOT AVAILABLE	13.06. - 20.06.2026 NOT AVAILABLE	20.06. - 27.06.2026 NOT AVAILABLE
27.06. - 04.07.2026 NOT AVAILABLE	04.07. - 11.07.2026 NOT AVAILABLE	11.07. - 18.07.2026 NOT AVAILABLE	18.07. - 25.07.2026 5.500 €
25.07. - 01.08.2026 5.500 €	01.08. - 08.08.2026 5.500 €	08.08. - 15.08.2026 5.500 €	15.08. - 29.08.2026 NOT AVAILABLE
29.08. - 05.09.2026 4.400 €	05.09. - 12.09.2026 NOT AVAILABLE	12.09. - 19.09.2026 3.700 €	19.09. - 26.09.2026 3.700 €
26.09. - 03.10.2026 2.800 €	03.10. - 17.10.2026 NOT AVAILABLE	17.10. - 24.10.2026 2.200 €	24.10. - 31.10.2026 2.200 €
31.10. - 07.11.2026 2.200 €	07.11. - 14.11.2026 2.200 €	14.11. - 21.11.2026 2.200 €	21.11. - 28.11.2026 2.200 €
28.11. - 05.12.2026 2.200 €			



**WEBSITE**  
www.plujeme.cz



**E-MAIL**  
info@plujeme.cz



**PHONE**  
+420 720 755 085



**PLUJEME RÁDI S.R.O.**  
Dlouhá 730/35, 11000 Praha 1 – Staré Město, Czech Republic



**MOBILE**  
+420 777 170 276

## PRICE AND AVAILABILITY

05.12. - 12.12.2026

2.200 €

12.12. - 19.12.2026

2.200 €

19.12. - 26.12.2026

2.200 €



### WEBSITE

[www.plujeme.cz](http://www.plujeme.cz)



### E-MAIL

[info@plujeme.cz](mailto:info@plujeme.cz)



### PHONE

+420 720 755 085



### MOBILE

+420 777 170 276



### PLUJEME RÁDI S.R.O.

Dlouhá 730/35, 11000 Praha 1 – Staré Město, Czech Republic