

# BALI CATSPACE

Phoenix (2023)

Catamaran Bali Catspace Phoenix, built in 2023 is anchored in the **Lefkas main port, Ionian Islands, Greece**. It has **4 cabins**, can accommodate **10 people** and has **4 toilets**. Bed linen and kitchen equipment are included in the price.

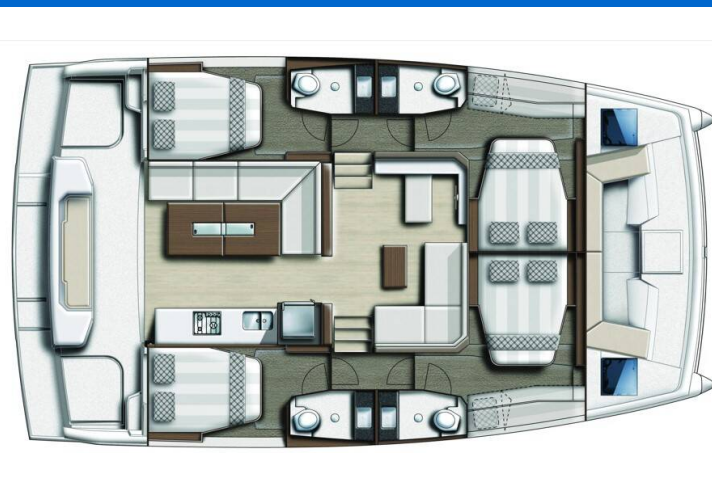

## YACHT SPECIFICATIONS

Yacht Base

**Lefkas main port, Greece**

Yacht ID

**6411**

Brands

**Catana**

Yacht name

**Phoenix**

Production year

**2023**

Length

**40 ft**

Cabins

**4**

Berths

**10**

Max Persons

**12**

WC

**4**

Engine

**2 x 2 HP**

Fuel tank

**400 l**



**WEBSITE**

[www.plujeme.cz](http://www.plujeme.cz)



**PHONE**

+420 720 755 085



**MOBILE**

+420 777 170 276



**E-MAIL**

[info@plujeme.cz](mailto:info@plujeme.cz)



**PLUJEME RÁDI S.R.O.**

Dlouhá 730/35, 11000 Praha 1 – Staré Město, Czech Republic

## STANDARD YACHT EQUIPMENT

Comfort	<b>Cockpit cushions, Deck cushions</b>
Deck	<b>Bimini top, Cockpit fridge, Dinghy with outboard engine, Gangway, Grill/Barbecue/Plancha, Sprayhood</b>
Galley	<b>Freezer, Kitchen utensils (Galley equipment, cutlery)</b>
Interior	<b>Electric fans, Electric toilet</b>
Navigation	<b>Autopilot, GPS chart plotter - cockpit</b>
Sails	<b>Electric winch, Lazy bag, Lazy jacks</b>
Yacht electrics	<b>Inverter, Solar panels</b>



**WEBSITE**

[www.plujeme.cz](http://www.plujeme.cz)



**E-MAIL**

[info@plujeme.cz](mailto:info@plujeme.cz)



**PHONE**

+420 720 755 085



**MOBILE**

+420 777 170 276



**PLUJEME RÁDI S.R.O.**

Dlouhá 730/35, 11000 Praha 1 – Staré Město, Czech Republic

## SERVICES

SELECTED SERVICES	OBLIGATORY	PAYMENT TYPE	PRICE
<b>Security Deposit Waiver</b> (Payable at the base) <b>Season: 2026.</b> 250 EUR credit voucher for the next charter in case of no damage/loss upon redelivery. No cash refund.	Yes	per booking	<b>500,00 €</b>
<b>Standard Charter Pack</b> (Payable at the base) <b>Season: 2026.</b> Welcome kit	Yes	per booking	<b>290,00 €</b>
<b>Beach towel</b> (Payable at the base) <b>Season: 2026.</b>	No	per booking	<b>10,00 €</b>
<b>Berth cost</b> (Payable at the base) <b>Season: 2026.</b> Berthing fees for first & last night at the marina/port	No	per booking	<b>0,00 €</b>
<b>Cook</b> (Payable at the base) <b>Season: 2026.</b> Crew provisioning to be provided by Charterer in arrangement with crew. If monetary compensation shall be agreed, then it shall be of no less than €30 per crew member per day. Charterer shall provide crew with sleeping cabin/berth and shower/toilet use to be designated to them onboard.	No	per day + food	<b>215,00 €</b>
<b>Family pack</b> (Payable at the base) <b>Season: 2026.</b> Safety net, SUP, junior life jackets, normal foam type	No	per booking	<b>350,00 €</b>
<b>Fast Track pack</b> (Payable at the base) <b>Season: 2026.</b> Access to the yacht by 14:00h on embarkation day, only IF feasible	No	per booking	<b>200,00 €</b>
<b>Overnight on board</b> (Payable at the base) <b>Season: 2026.</b> Embarkation on yacht & overnight stay the day before charter starts, check-in by 13:00h on charter start day. Subject to last minute availability of yacht on previous day.	No	per booking	<b>180,00 €</b>
<b>Pet on board</b> (Payable at the base) <b>Season: 2026.</b> up to 7 kg	No	per booking	<b>200,00 €</b>

<p><b>Skipper</b> (Payable at the base)</p> <p><b>Season: 2026.</b> Crew provisioning to be provided by Charterer in arrangement with crew. If monetary compensation shall be agreed, then it shall be of no less than €30 per crew member per day. Charterer shall provide crew with sleeping cabin/berth and shower/toilet use to be designated to them onboard. Skipped charters come obligatorily with: Security deposit waiver, non refundable, EUR 400</p>	No	per day + food	<b>215,00 €</b>
<p><b>Stand up paddle (SUP)</b> (Payable at the base)</p> <p><b>Season: 2026.</b></p>	No	per week	<b>100,00 €</b>
<p><b>VIP Pack</b> (Payable at the base)</p> <p><b>Season: 2026.</b> Airport/Local Base welcome &amp; pickup, transfer to the yacht, welcome pack with sparkling wine &amp; fruits, departure transfer to the local airport</p>	No	per booking	<b>300,00 €</b>



 **WEBSITE**  
www.plujeme.cz

 **E-MAIL**  
info@plujeme.cz

 **PHONE**  
+420 720 755 085

 **PLUJEME RÁDI S.R.O.**  
Dlouhá 730/35, 11000 Praha 1 – Staré Město, Czech Republic

 **MOBILE**  
+420 777 170 276

## ADDITIONAL EXTRAS

EXTRA	OBLIGATORY	PAYMENT TYPE	PRICE
<b>Automatic Inflatable Life Jacket</b> (Payable at the base) <i>Season: 2026. Payable at the base</i>	No	per week/ person	<b>20,00 €</b>
<b>Beach towel</b> (Payable at the base) <i>Season: 2026. Payable at the base</i>	No	per piece	<b>10,00 €</b>
<b>Extra bedlinen</b> (Payable at the base) <i>Season: 2026. Payable at the base</i>	No	per set	<b>10,00 €</b>
<b>Fishing equipment</b> (Payable at the base) <i>Season: 2026. fishing rod &amp; reel - Payable at the base</i>	No	per week	<b>30,00 €</b>
<b>Grill/Barbecue/Plancha</b> (Payable at the base) <i>Season: 2026. portable, 1x gas bottle included - Payable at the base</i>	No	per week	<b>80,00 €</b>
<b>Kayak</b> (Payable at the base) <i>Season: 2026. Payable at the base</i>	No	per week	<b>100,00 €</b>
<b>Railing net (Safety net)</b> (Payable at the base) <i>Season: 2026. installed - Payable at the base</i>	No	per booking	<b>200,00 €</b>
<b>Stand up paddle (SUP)</b> (Payable at the base) <i>Season: 2026. Payable at the base</i>	No	per week	<b>100,00 €</b>



**WEBSITE**  
www.plujeme.cz



**E-MAIL**  
info@plujeme.cz



**PHONE**  
+420 720 755 085



**MOBILE**  
+420 777 170 276



**PLUJEME RÁDI S.R.O.**  
Dlouhá 730/35, 11000 Praha 1 – Staré Město, Czech Republic

## PRICE AND AVAILABILITY

25.04. - 02.05.2026 2.660 € 3.800 €	02.05. - 09.05.2026 NOT AVAILABLE	09.05. - 16.05.2026 NOT AVAILABLE	16.05. - 23.05.2026 NOT AVAILABLE
23.05. - 06.06.2026 NOT AVAILABLE	06.06. - 13.06.2026 NOT AVAILABLE	13.06. - 20.06.2026 NOT AVAILABLE	20.06. - 27.06.2026 ON OPTION
27.06. - 04.07.2026 NOT AVAILABLE	04.07. - 11.07.2026 NOT AVAILABLE	11.07. - 18.07.2026 NOT AVAILABLE	18.07. - 25.07.2026 7.065 € 7.850 €
25.07. - 01.08.2026 NOT AVAILABLE	01.08. - 08.08.2026 8.415 € 9.350 €	08.08. - 15.08.2026 8.415 € 9.350 €	15.08. - 22.08.2026 8.415 € 9.350 €
22.08. - 29.08.2026 8.415 € 9.350 €	29.08. - 05.09.2026 NOT AVAILABLE	05.09. - 12.09.2026 7.380 € 8.200 €	12.09. - 19.09.2026 NOT AVAILABLE
19.09. - 26.09.2026 6.390 € 7.100 €	26.09. - 03.10.2026 NOT AVAILABLE	03.10. - 10.10.2026 4.950 € 5.500 €	10.10. - 17.10.2026 NOT AVAILABLE
17.10. - 24.10.2026 3.510 € 3.900 €	24.10. - 31.10.2026 3.510 € 3.900 €	31.10. - 07.11.2026 3.510 € 3.900 €	07.11. - 14.11.2026 3.510 € 3.900 €
14.11. - 21.11.2026 3.510 € 3.900 €	21.11. - 31.12.2026 NOT AVAILABLE		



WEBSITE

[www.plujeme.cz](http://www.plujeme.cz)



E-MAIL

[info@plujeme.cz](mailto:info@plujeme.cz)



PHONE

+420 720 755 085



MOBILE

+420 777 170 276



PLUJEME RÁDI S.R.O.

Dlouhá 730/35, 11000 Praha 1 – Staré Město, Czech Republic

## PRICE AND AVAILABILITY

02.01. - 09.01.2027 2.790 € 3.100 €	09.01. - 16.01.2027 2.790 € 3.100 €	16.01. - 23.01.2027 2.790 € 3.100 €	23.01. - 30.01.2027 2.790 € 3.100 €
30.01. - 06.02.2027 2.790 € 3.100 €	06.02. - 13.02.2027 2.790 € 3.100 €	13.02. - 20.02.2027 2.790 € 3.100 €	20.02. - 27.02.2027 2.790 € 3.100 €
27.02. - 06.03.2027 2.790 € 3.100 €	06.03. - 13.03.2027 2.790 € 3.100 €	13.03. - 20.03.2027 2.790 € 3.100 €	20.03. - 27.03.2027 2.790 € 3.100 €
27.03. - 03.04.2027 2.790 € 3.100 €	03.04. - 10.04.2027 2.790 € 3.100 €	10.04. - 17.04.2027 2.790 € 3.100 €	17.04. - 24.04.2027 2.790 € 3.100 €
24.04. - 01.05.2027 3.420 € 3.800 €	01.05. - 08.05.2027 3.870 € 4.300 €	08.05. - 15.05.2027 3.870 € 4.300 €	15.05. - 22.05.2027 4.140 € 4.600 €
22.05. - 29.05.2027 4.950 € 5.500 €	29.05. - 05.06.2027 4.950 € 5.500 €	05.06. - 12.06.2027 5.715 € 6.350 €	12.06. - 19.06.2027 5.715 € 6.350 €
19.06. - 26.06.2027 7.065 € 7.850 €	26.06. - 03.07.2027 7.065 € 7.850 €	03.07. - 10.07.2027 7.065 € 7.850 €	10.07. - 17.07.2027 7.065 € 7.850 €
17.07. - 24.07.2027 7.065 € 7.850 €	24.07. - 31.07.2027 7.065 € 7.850 €	31.07. - 07.08.2027 8.415 € 9.350 €	



WEBSITE

[www.plujeme.cz](http://www.plujeme.cz)



E-MAIL

[info@plujeme.cz](mailto:info@plujeme.cz)



PHONE

+420 720 755 085



MOBILE

+420 777 170 276



PLUJEME RÁDI S.R.O.

Dlouhá 730/35, 11000 Praha 1 – Staré Město, Czech Republic

## PRICE AND AVAILABILITY

07.08. - 14.08.2027 <b>8.415 €</b> 9.350 €	14.08. - 21.08.2027 <b>8.415 €</b> 9.350 €	21.08. - 28.08.2027 <b>8.415 €</b> 9.350 €	28.08. - 04.09.2027 <b>7.380 €</b> 8.200 €
04.09. - 11.09.2027 <b>7.380 €</b> 8.200 €	11.09. - 18.09.2027 <b>7.380 €</b> 8.200 €	18.09. - 25.09.2027 <b>6.390 €</b> 7.100 €	25.09. - 02.10.2027 <b>5.850 €</b> 6.500 €
02.10. - 09.10.2027 <b>4.950 €</b> 5.500 €	09.10. - 16.10.2027 <b>4.050 €</b> 4.500 €	16.10. - 23.10.2027 <b>3.510 €</b> 3.900 €	23.10. - 30.10.2027 <b>3.510 €</b> 3.900 €
30.10. - 06.11.2027 <b>3.510 €</b> 3.900 €	06.11. - 13.11.2027 <b>3.510 €</b> 3.900 €	13.11. - 20.11.2027 <b>3.510 €</b> 3.900 €	20.11. - 27.11.2027 <b>3.510 €</b> 3.900 €
27.11. - 04.12.2027 <b>3.510 €</b> 3.900 €	04.12. - 11.12.2027 <b>3.510 €</b> 3.900 €	11.12. - 18.12.2027 <b>3.510 €</b> 3.900 €	18.12. - 25.12.2027 <b>3.510 €</b> 3.900 €



### WEBSITE

[www.plujeme.cz](http://www.plujeme.cz)



### E-MAIL

[info@plujeme.cz](mailto:info@plujeme.cz)



### PHONE

+420 720 755 085



### MOBILE

+420 777 170 276



### PLUJEME RÁDI S.R.O.

Dlouhá 730/35, 11000 Praha 1 – Staré Město, Czech Republic